

**EXHIBIT A
LAND DESCRIPTION FOR
PARTIAL ABANDONMENT
OF
SOUTH 21ST STREET**

All that certain real property situate within a portion of the Northwest One-Quarter (NW 1/4) of Section Eight (8), Township Nineteen (19) North, Range Twenty (20) East, Mount Diablo Base Meridian, City of Sparks, County of Washoe, State of Nevada, being a portion of South 21st Street as shown on Parcel Map No. 956, recorded October 1, 1979, as File No. 632863, Official Records of Washoe County, Nevada, and being more particularly described as follows:

BEGINNING at the northwest corner of Parcel A as shown on Parcel 5221, recorded February 18, 2016, as File No. 4561670, Official Records of Washoe County, Nevada;

THENCE southerly coincident with the westerly line of said Parcel A the following three (3) courses and distances:

- 1) South 00°16'41" West, 161.62 feet;
- 2) South 81°36'06" East, 14.12 feet;
- 3) South 00°45'00" West, 449.27 feet to the southwest corner of said Parcel A;

THENCE departing said westerly line, North 89°15'00" West, 24.93 feet;

THENCE North 00°30'43" East, 455.06 feet;

THENCE North 00°16'41" East, 159.26 feet;

THENCE South 81°36'06" East, 13.13 feet to the **POINT OF BEGINNING** and end of this description.

Containing 13,861 square feet of land, more or less.

SEE EXHIBIT B attached hereto and made a part hereof.

BASIS OF BEARINGS for this description is based on the Nevada State Plane Coordinate System of 1983, West Zone, NAD 83/94.

Prepared By:

ODYSSEY ENGINEERING, INC.
Justin M. Moore, P.L.S.
Nevada Certificate No. 22362
895 Roberta Lane, Suite 104,
Sparks, NV 89431

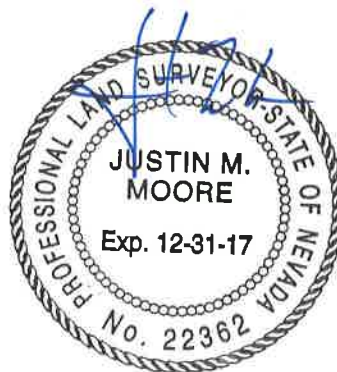

UNNAMED ALLEY
 (DEDICATED TO THE CITY OF SPARKS PER
 T.M. 117, T.M. 4080, DOC #567634, & DOC #2724406)

S 81°36'06" E
 13.13'

30'
 P.O.B.

S 81°36'06" E 490.51'

SOUTH 21ST STREET
 (PER DOC NO. 219876 & P.M. 956)

159.26'
 N 0°16'41" E

S 0°16'41" W
 161.62'

S 81°36'06" E
 14.12'

SOUTH 21ST STREET
 ABANDONMENT
 ±13,861 S.F.

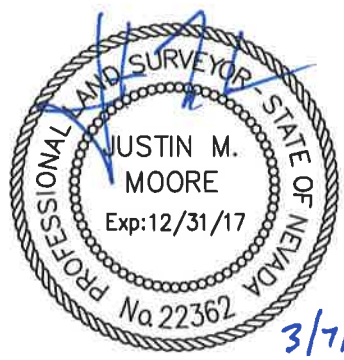

PARCEL A
 P.M. 5221
 TRIPLE D PROPERTIES, LLC.



N 0°30'43" E 455.06'
 N 0°16'41" E 159.26'
 S 0°45'00" W 449.27'
 17'

Line Table		
Line #	Direction	Length
L1	N48°18'00"E	26.60'
L2	N81°36'06"W	39.77'

N 89°15'00" W
 24.93'

N 89°15'00" W
 PARCEL A
 P.M. 956
 JSH PROPERTIES

DOCUMENT
 #2843872
 ALLEGIANCE PROPERTIES

SCALE: 1" = 100'

EXHIBIT B
 WWW.ODYSSEY-CIVIL-ENGINEERING.COM
ODYSSEY ENGINEERING INCORPORATED

**PARTIAL ABANDONMENT OF
 SOUTH 21ST STREET**
 LOCATED WITHIN THE NORTHWEST 1/4 OF
 SECTION 8, T.19N., R.20E., M.D.M.
 SPARKS WASHOE COUNTY NEVADA

EXHIBIT C
LAND DESCRIPTION FOR
PUBLIC UTILITY AND DRAINAGE EASEMENT

All that certain real property situate within a portion of the Northwest One-Quarter (NW 1/4) of Section Eight (8), Township Nineteen (19) North, Range Twenty (20) East, Mount Diablo Base Meridian, City of Sparks, County of Washoe, State of Nevada, being a portion of South 21st Street as shown on Parcel Map No. 956, recorded October 1, 1979, as File No. 632863, Official Records of Washoe County, Nevada, and being more particularly described as follows:

BEGINNING at the northwest corner of Parcel A as shown on Parcel 5221, recorded February 18, 2016, as File No. 4561670, Official Records of Washoe County, Nevada;

THENCE southerly coincident with the westerly line of said Parcel A the following three (3) courses and distances:

- 1) South 00°16'41" West, 161.62 feet;
- 2) South 81°36'06" East, 14.12 feet;
- 3) South 00°45'00" West, 449.27 feet to the southwest corner of said Parcel A;

THENCE departing said westerly line, North 89°15'00" West, 24.93 feet;

THENCE North 00°30'43" East, 455.06 feet;

THENCE North 00°16'41" East, 159.26 feet;

THENCE South 81°36'06" East, 13.13 feet to the **POINT OF BEGINNING** and end of this description.

Containing 13,861 square feet of land, more or less.

SEE EXHIBIT D attached hereto and made a part hereof.

BASIS OF BEARINGS for this description is based on the Nevada State Plane Coordinate System of 1983, West Zone, NAD 83/94.

Prepared By:

ODYSSEY ENGINEERING, INC.
Justin M. Moore, P.L.S.
Nevada Certificate No. 22362
895 Roberta Lane, Suite 104,
Sparks, NV 89431

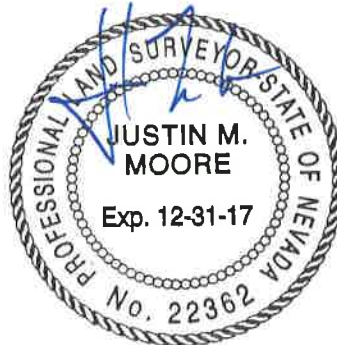

3/7/16

UNNAMED ALLEY
 (DEDICATED TO THE CITY OF SPARKS PER
 T.M. 117, T.M. 4080, DOC #567634, & DOC #2724406)

S 81°36'06" E
 13.13'

30'
 P.O.B.
 S 81°36'06" E 490.51'

N 0°16'41" E
 159.26'

S 0°16'41" W
 161.62'

S 81°36'06" E
 14.12'

PUBLIC UTILITY AND
 DRAINAGE EASEMENT
 ±13,861 S.F.

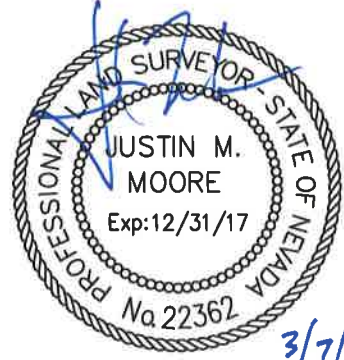

SOUTH 21ST STREET
 (PER DOC NO. 219876 & P.M. 956)

N 0°30'43" E 455.06'

S 0°45'00" W 449.27'

PARCEL A
 P.M. 5221

TRIPLE D PROPERTIES, LLC.



Line Table		
Line #	Direction	Length
L1	N48°18'00"E	26.60'
L2	N81°36'06"W	39.77'

N 89°15'00" W
 24.93'

N 89°15'00" W
 PARCEL A
 P.M. 956
 JSH PROPERTIES

DOCUMENT
 #2843872
 ALLEGIANCE PROPERTIES

128.18'

SCALE: 1" = 100'



EXHIBIT D
 WWW.ODYSSEY-CIVIL-ENGINEERING.COM

odyssey ENGINEERING INCORPORATED

PUBLIC UTILITY AND DRAINAGE
 EASEMENT

LOCATED WITHIN THE NORTHWEST 1/4 OF
 SECTION 8, T.19N., R.20E., M.D.M.
 SPARKS WASHOE COUNTY NEVADA