



ADDENDUM #1
POULAKIDAS PARK PLAYGROUND IMPROVEMENTS
BID# 19/20-009 PWP# WA-2020-074
BIDS DUE NO LATER THAN: 1:45 P.M. ON DECEMBER 4, 2019
PUBLIC BID OPENING: 2:00 PM ON DECEMBER 4, 2019

This addendum is to notify all potential proposers of clarifications made to the Bid documents as stated below.

A) Reminder to Bidders:

Due to issues discovered in previous bids for this and similar construction projects, the City wishes to direct bidders to re-read and observe the following items:

- a. **Bid Document Page 9 (Subcontractor Detail)** – Potential bidders are reminded that Nevada State Law REQUIRES bidders to list all subcontractors that will be paid an amount exceeding 5% of their bid price. This requirement extends to the bidder as well. Bidders MUST list themselves on this form with the description of work they will self-perform under any contract resulting from this bid. Bidders failing to list themselves on this form will be found “non-responsive” and cannot be considered in the evaluation of bids.
- b. **Bid Document Page 43** – Section 28: Play Equipment – All play equipment shall be installed/erected by a Certified Playground Installer. Must be certified by a manufacturer.

B) Bid Item Clarification Changes

- a. The original language found describing Bid Item 7.0 (Page 45 of the Bid document) shall be deleted and replaced with the following:

Bid Item 7.0 – Concrete ADA Playground Ramps

The unit price bid to construct new PCC ADA playground ramps as indicated on the plans. The work comprising the unit bid price for this item shall include all labor, equipment, materials, concrete, base and incidentals necessary to construct concrete as indicated on the plans, including, but not limited to; removal/replacement of approximately fifteen (15) feet of existing curb for each ramp as necessary to facilitate new ramps, removal/replacement of four (4) square feet of PCC sidewalk, construction of PCC ADA ramp and placement and preparation/compaction of new aggregate base, per details on the plans. Payment for this item will be per square each.

C) Playground footing drawings

- a.** Drawings for the playground footings attached. Cost of the footings should be included in Bid Item 4.0 as outlined in the Bid Item Clarifications on page 45 of the Bid Documents.

Please note and adjust your bid according to the revisions, additions, deletions, clarifications or modifications as presented on this Addendum #1, which are made a part of this bid. NOTE: To avoid disqualification, this Addendum 1 (and any other addenda) must be signed by an authorized representative of the bidding firm in the space provided and must be submitted with your firm's sealed proposal. Failure to return this addendum, duly signed, may be cause for rejection of the bid. ALL ADDENDA SHOULD BE SIGNED AND PLACED IN SEQUENTIAL ORDER AND ATTACHED TO THE FRONT OF THE BID PACKAGE, COMPLETE WITH ALL REQUIRED DOCUMENTS.

CONTRACTOR BUSINESS NAME

X _____
Authorized Signature

Printed Name of Person Signing

Dan Marran, C.P.M., CPPO
Contracts and Risk Manager

November 25, 2019

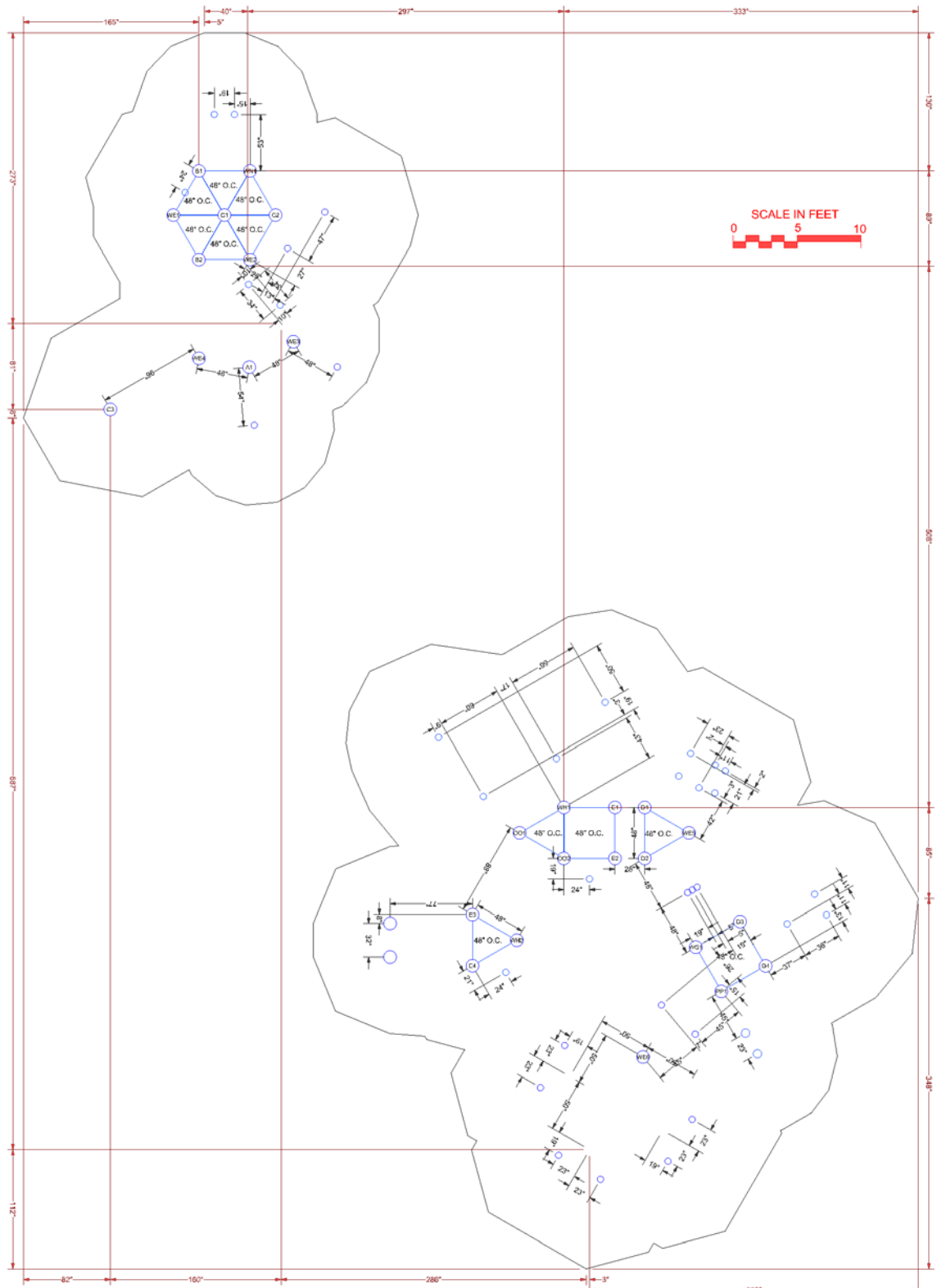

SCALE IN FEET
0 5 10



- A1** Support Post Identifier & Footing
- NP1** Nature Play Tree House Post Identifier
- Component Footing

FOOTING LEGEND

NOTES:
 1.) Dimensions are for locations for footing holes, not exact placement of equipment.
 2.) Assemble, plumb, and level equipment before pouring concrete.

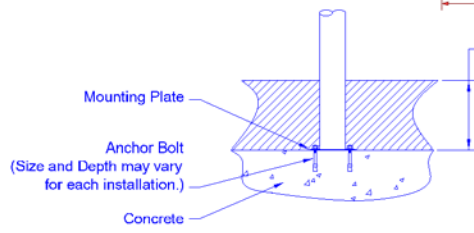

Surface Mount Detail

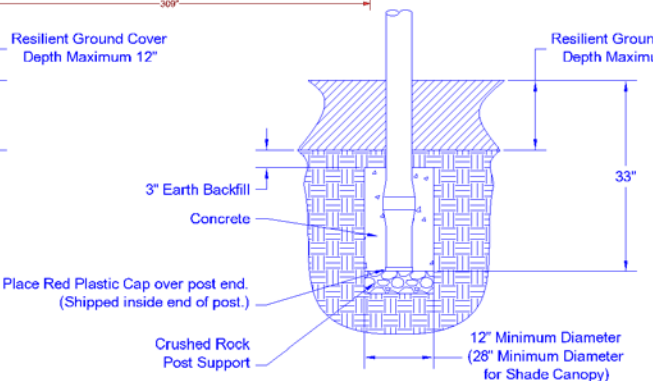

Support Post Footing Detail

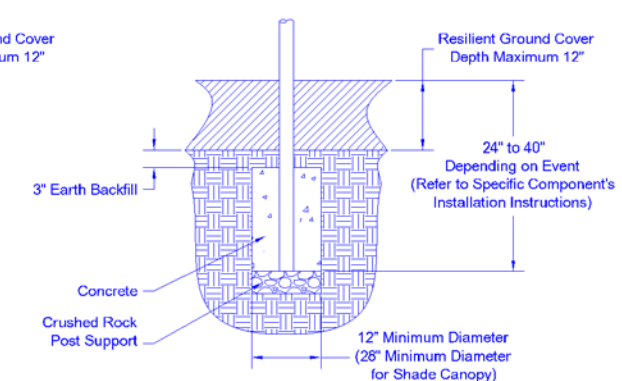

Component Footing Detail

Burke

SERIES: Basics, Intensity, Nucleus
 SITE PLAN
 DRAWN BY: Pa Der Vang

BCI Burke Company, LLC PO Box 549 Fond du Lac, Wisconsin 54936-0549 Telephone 920-921-9220

Poulakidas Park
 530 4th St
 Sparks, NV 89431

Buell Recreation
 907-122778-1

November 25, 2019

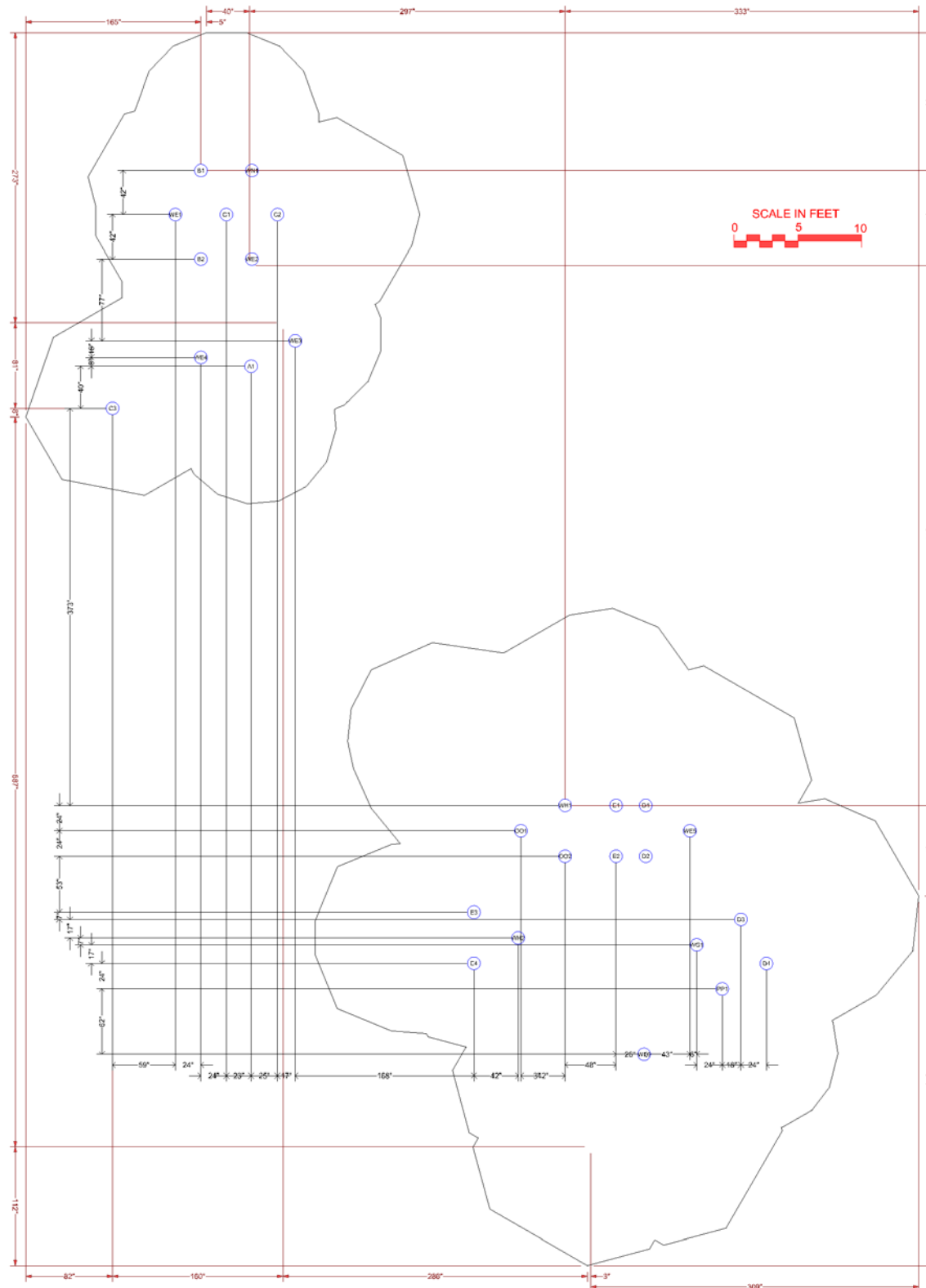

- FOOTING LEGEND**
- A1 Support Post Identifier & Footing
 - NP1 Nature Play Tree House Post Identifier
 - Component Footing

NOTES:
 1.) Dimensions are for locations for footing holes, not exact placement of equipment.
 2.) Assemble, plumb, and level equipment before pouring concrete.
 3.) Dimensions are rounded to nearest whole inch.

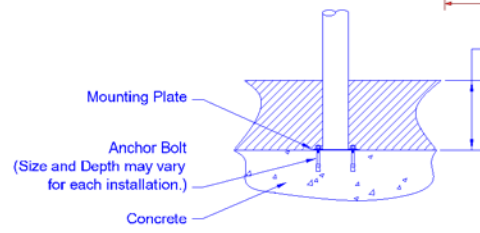

Surface Mount Detail

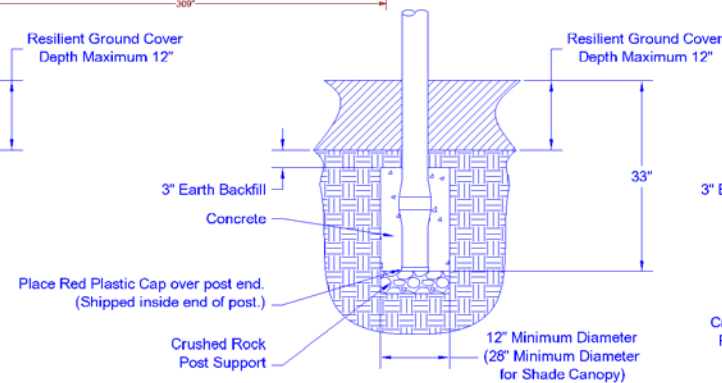

Support Post Footing Detail

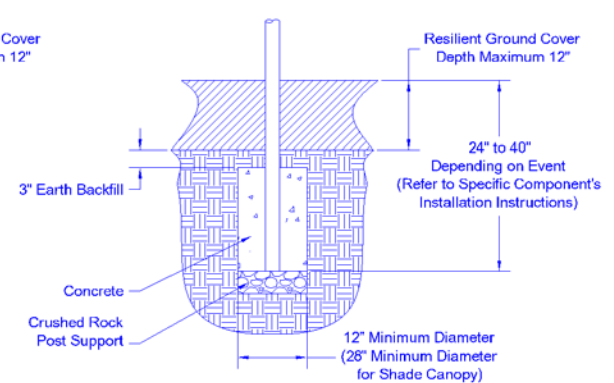

Component Footing Detail

November 25, 2019

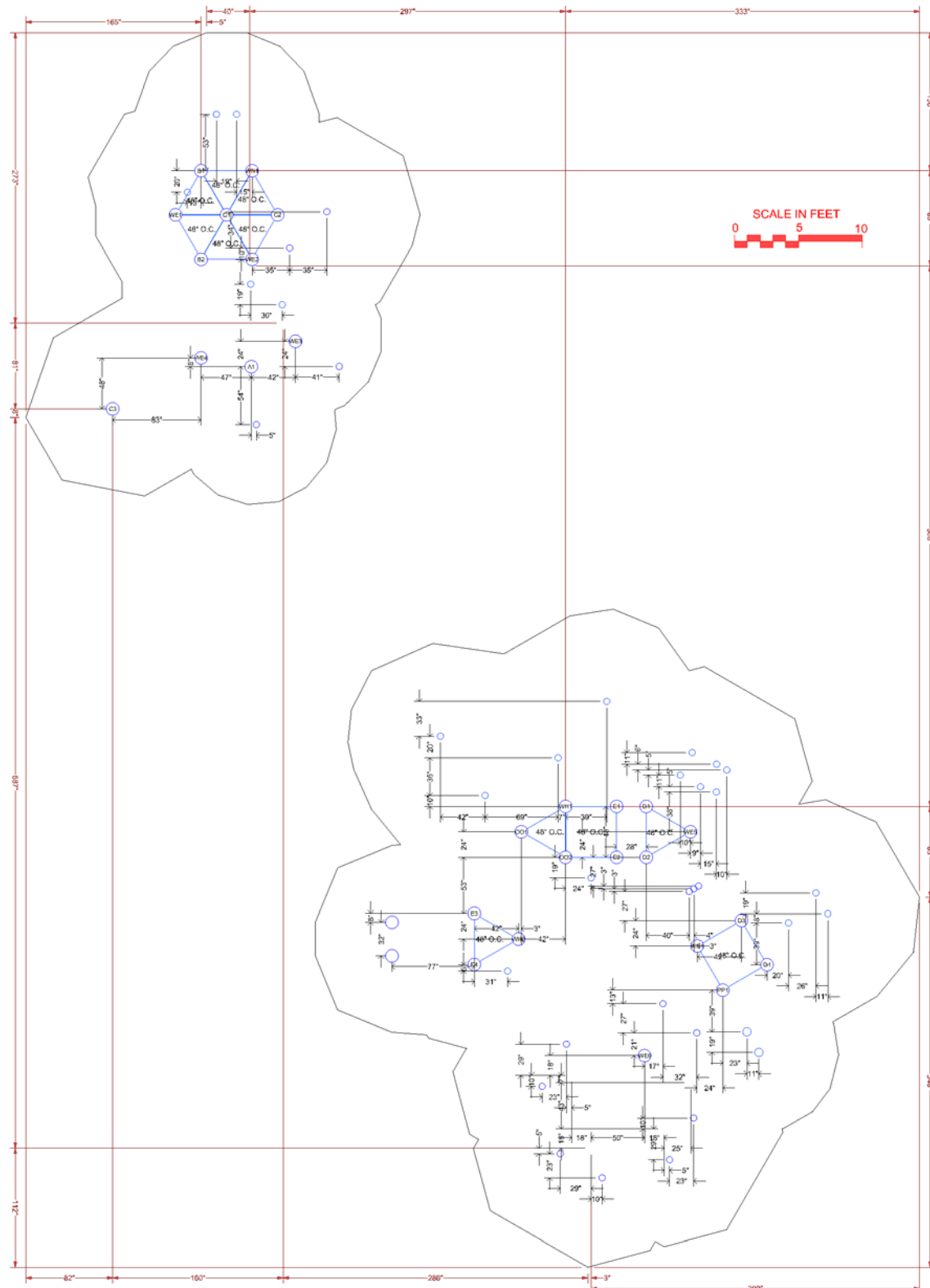

A1

Support Post Identifier & Footing

NP1

Nature Play Tree House Post Identifier

○

Component Footing

FOOTING LEGEND

NOTES:

- 1.) Dimensions are for locations for footing holes, not exact placement of equipment.
- 2.) Assemble, plumb, and level equipment before pouring concrete.
- 3.) Dimensions are rounded to nearest whole inch.

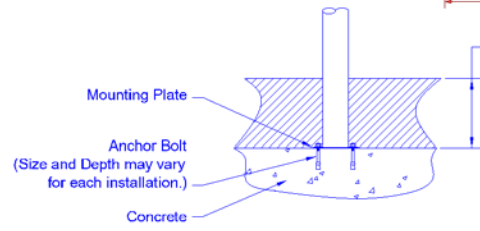

Surface Mount Detail

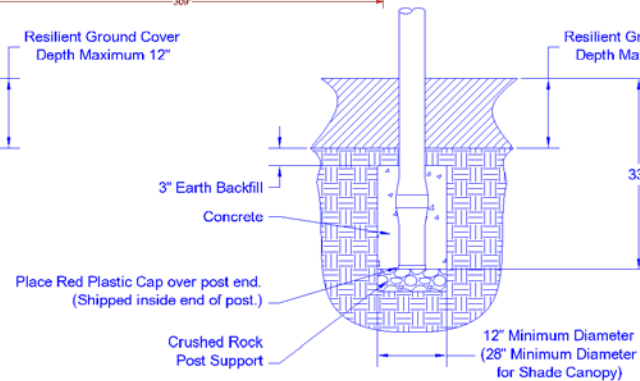

Support Post Footing Detail

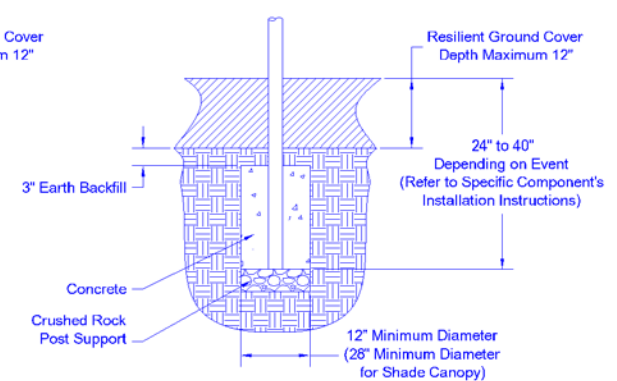

Component Footing Detail

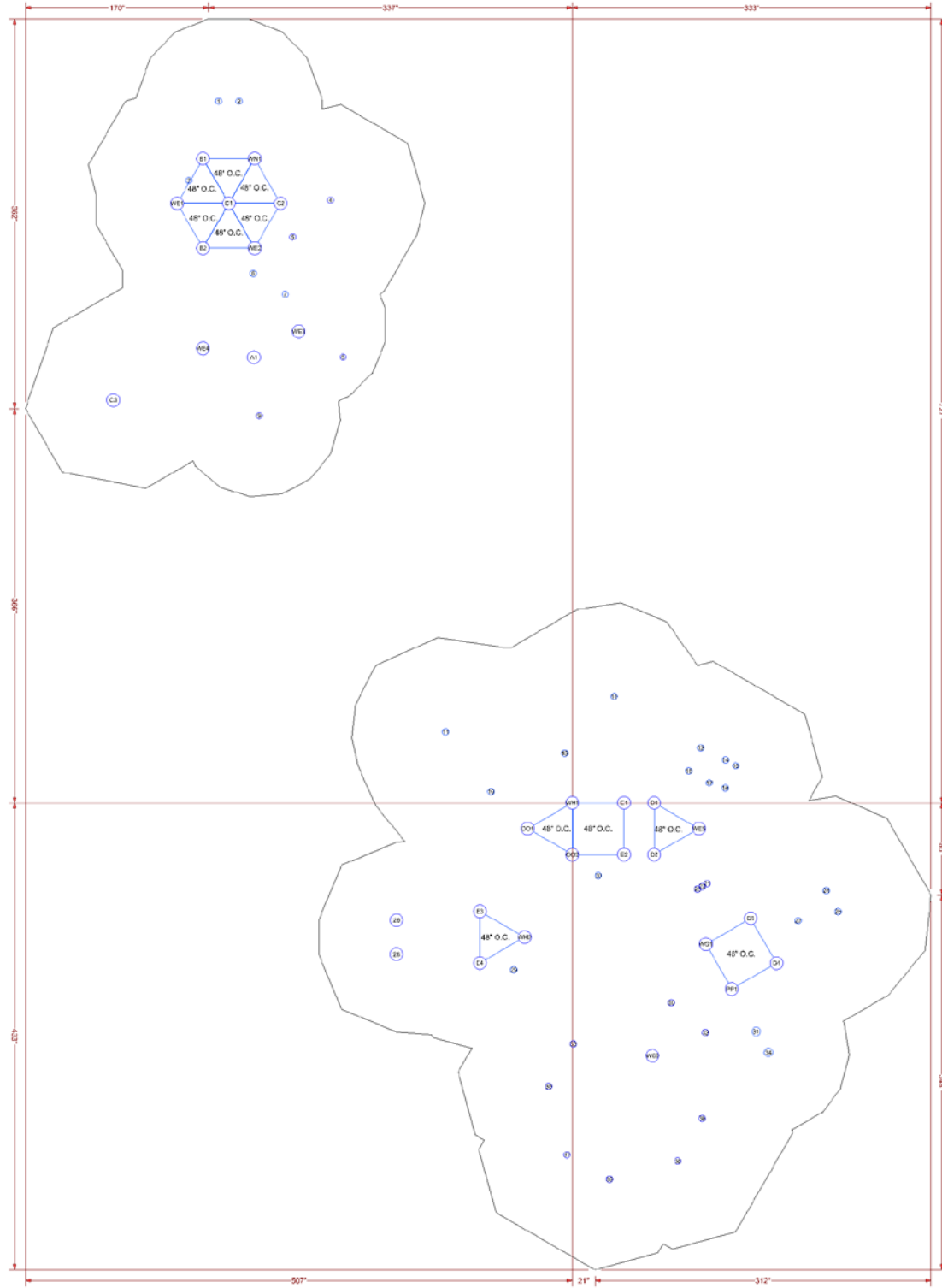

Type	Label	X	Y	Hyp/Diag
Post	A1	-24'-7 1/2"	34'-5"	42'-3 7/8"
Post	B1	-28'-6 3/4"	49'-9 3/8"	57'-4 5/8"
Post	B2	-28'-6 3/4"	42'-10 1/8"	51'-6"
Post	C1	-26'-6 3/4"	46'-3 3/4"	53'-4 5/8"
Post	C2	-22'-6 3/4"	46'-3 3/4"	51'-6 1/4"
Post	C3	-35'-5 7/8"	31'-1 3/8"	47'-2 3/8"
Post	D1	6'-3 7/8"	0"	6'-3 7/8"
Post	D2	6'-3 7/8"	-4'-0"	7'-5 3/4"
Post	D3	13'-9 1/2"	-8'-11 1/8"	16'-5 1/8"
Post	D4	15'-9 1/2"	-12'-4 3/4"	20'-0 7/8"
Post	E1	4'-0"	0"	4'-0"
Post	E2	4'-0"	-4'-0"	5'-7 7/8"
Post	E3	-7'-1 3/4"	-8'-4 5/8"	11'-0 1/4"
Post	E4	-7'-1 3/4"	-12'-4 5/8"	14'-3 5/8"
Post	OO1	-3'-5 5/8"	-2'-0"	4'-0"
Post	OO2	0"	-4'-0"	4'-0"
Post	PF1	12'-3 7/8"	-14'-4 3/4"	18'-11 3/8"
Post	WE1	-30'-6 3/4"	46'-3 3/4"	55'-5 7/8"
Post	WE2	-24'-6 3/4"	42'-10 1/8"	49'-4 5/8"
Post	WE3	-21'-1 7/8"	36'-5"	42'-1 3/8"
Post	WE4	-28'-6 3/4"	35'-1 3/8"	45'-3 1/8"
Post	WE5	9'-9 1/2"	-2'-0"	9'-11 7/8"
Post	WE6	6'-2 3/8"	-19'-6 3/8"	20'-5 7/8"
Post	WG1	10'-3 7/8"	-10'-11 1/8"	15'-0 3/8"
Post	WH1	0"	0"	0"
Post	WH2	-3'-8 1/4"	-10'-4 5/8"	11'-0 1/4"
Post	WN1	-24'-6 3/4"	49'-9 3/8"	55'-6 1/8"
Non-Post	1	-27'-4 3/8"	54'-2 1/2"	60'-8 5/8"
Non-Post	2	-25'-9 3/8"	54'-2 1/2"	60'-0 1/4"
Non-Post	3	-29'-7 5/8"	48'-1"	56'-5 3/4"
Non-Post	4	-18'-8 1/2"	46'-6 5/8"	50'-2 1/8"
Non-Post	5	-21'-7 3/8"	43'-8 1/2"	48'-9 1/4"
Non-Post	6	-24'-8 1/8"	40'-10 7/8"	47'-9 1/4"
Non-Post	7	-22'-2 1/2"	39'-3 1/2"	45'-1 5/8"
Non-Post	8	-17'-8 3/4"	34'-5 1/4"	38'-8 7/8"
Non-Post	9	-24'-2 3/4"	29'-10 7/8"	38'-5 7/8"
Non-Post	10	3'-2 3/4"	8'-2 1/2"	8'-9 7/8"
Non-Post	11	-9'-9 5/8"	5'-5 3/4"	11'-2 3/4"
Non-Post	12	9'-11"	4'-2 3/4"	10'-9 3/8"
Non-Post	13	-7"	3'-9 7/8"	3'-10 3/8"
Non-Post	14	11'-10 1/8"	3'-3 7/8"	12'-3 1/2"
Non-Post	15	12'-7 5/8"	2'-10 3/8"	12'-11 1/2"
Non-Post	16	8'-11 7/8"	2'-5 1/2"	9'-3 7/8"
Non-Post	17	10'-6 7/8"	1'-6 1/2"	10'-8 1/4"
Non-Post	18	11'-9 3/4"	1'-1 5/8"	11'-10 3/8"
Non-Post	19	-6'-3 5/8"	10 1/4"	6'-4 3/8"
Non-Post	20	2'-0"	-5'-7 3/8"	5'-11 1/2"
Non-Post	21	10'-5"	-6'-3"	12'-1 7/8"
Non-Post	22	10'-0 5/8"	-6'-5 5/8"	11'-11 1/2"
Non-Post	23	9'-8 1/4"	-6'-8 1/8"	11'-9 1/4"
Non-Post	24	19'-7 1/2"	-6'-9 1/2"	20'-9 1/8"
Non-Post	25	20'-6 5/8"	-8'-4 7/8"	22'-2 1/2"
Non-Post	26	-13'-7 1/4"	-9'-0 7/8"	16'-4 1/4"
Non-Post	27	17'-5 5/8"	-9'-1 3/8"	19'-8 1/2"
Non-Post	28	-13'-7 1/4"	-11'-8 3/8"	17'-11 3/8"
Non-Post	29	-4'-6 1/2"	-12'-10 3/4"	13'-8 1/8"
Non-Post	30	7'-7 1/2"	-15'-5 1/2"	17'-2 7/8"
Non-Post	31	14'-2 1/2"	-17'-8"	22'-8"
Non-Post	32	10'-3 3/8"	-17'-9"	20'-6 1/8"
Non-Post	33	3/4"	-18'-7 5/8"	18'-7 5/8"
Non-Post	34	15'-1 3/4"	-19'-3 1/2"	24'-6 1/4"
Non-Post	35	-1'-10"	-21'-11"	21'-11 7/8"
Non-Post	36	10'-0 1/2"	-24'-4 3/4"	26'-4 5/8"
Non-Post	37	-5"	-27'-2 3/8"	27'-2 1/2"
Non-Post	38	8'-1 3/4"	-27'-8 1/8"	28'-10 1/4"
Non-Post	39	2'-10 3/8"	-29'-1 1/8"	29'-2 3/4"

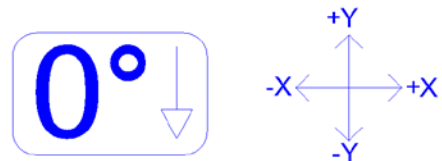

- FOOTING LEGEND**
- A1 Support Post Identifier & Footing
 - NP1 Nature Play Tree House Post Identifier
 - Component Footing

NOTES:

- Dimensions are for locations for footing holes, not exact placement of equipment.
- Assemble, plumb, and level equipment before pouring concrete.

