

POULAKIDAS PARK PLAYGROUND IMPROVEMENT PROJECT

CITY OF SPARKS, NEVADA



CITY OF SPARKS
98 RICHARDS WAY
SPARKS, NV 89431

CITY OF SPARKS OFFICIALS

Ron Smith	Mayor
Donald Abbott	Council Member Ward 1
Ed Lawson	Council Member Ward 2
Paul Anderson	Council Member Ward 3
Charlene Bybee	Council Member Ward 4
Kristopher Dahir	Council Member Ward 5
Neil C. Krutz	City Manager

DESIGNED FOR:

CITY OF SPARKS
98 RICHARDS WAY
SPARKS, NV 89431



SHEET INDEX

- L1 TITLE SHEET
- L2 EXISTING CONDITIONS AND DEMO PLAN
- L3 PLAYGROUND IMPROVEMENT PLAN

LANDSCAPE ARCHITECT AND CPSI

GREIG JAMESON
J & A DESIGN STUDIO
PO BOX 6780
RENO, NV 89513
gjameson@jadesignreno.com

POULAKIDAS PARK PLAYGROUND
IMPROVEMENT PROJECT

TITLE PAGE

DRAFTED: G&J
REVIEWED: G&J

J & A JOB NUMBER:
17-105-05

PLAN SET:
FOR BIDDING SET

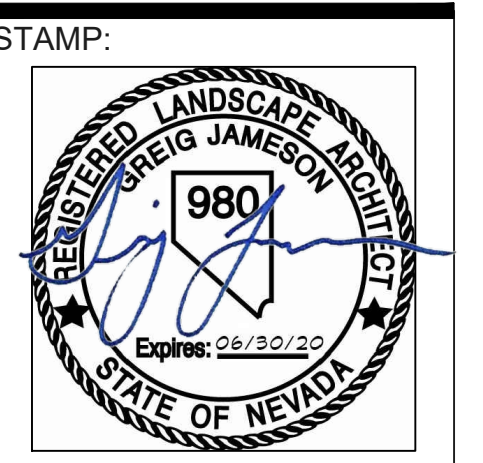

PLAN DATE: 11/08/19

REVISIONS:

#	DATE

SCALE: N.T.S.
SHEET:

L1
of 3

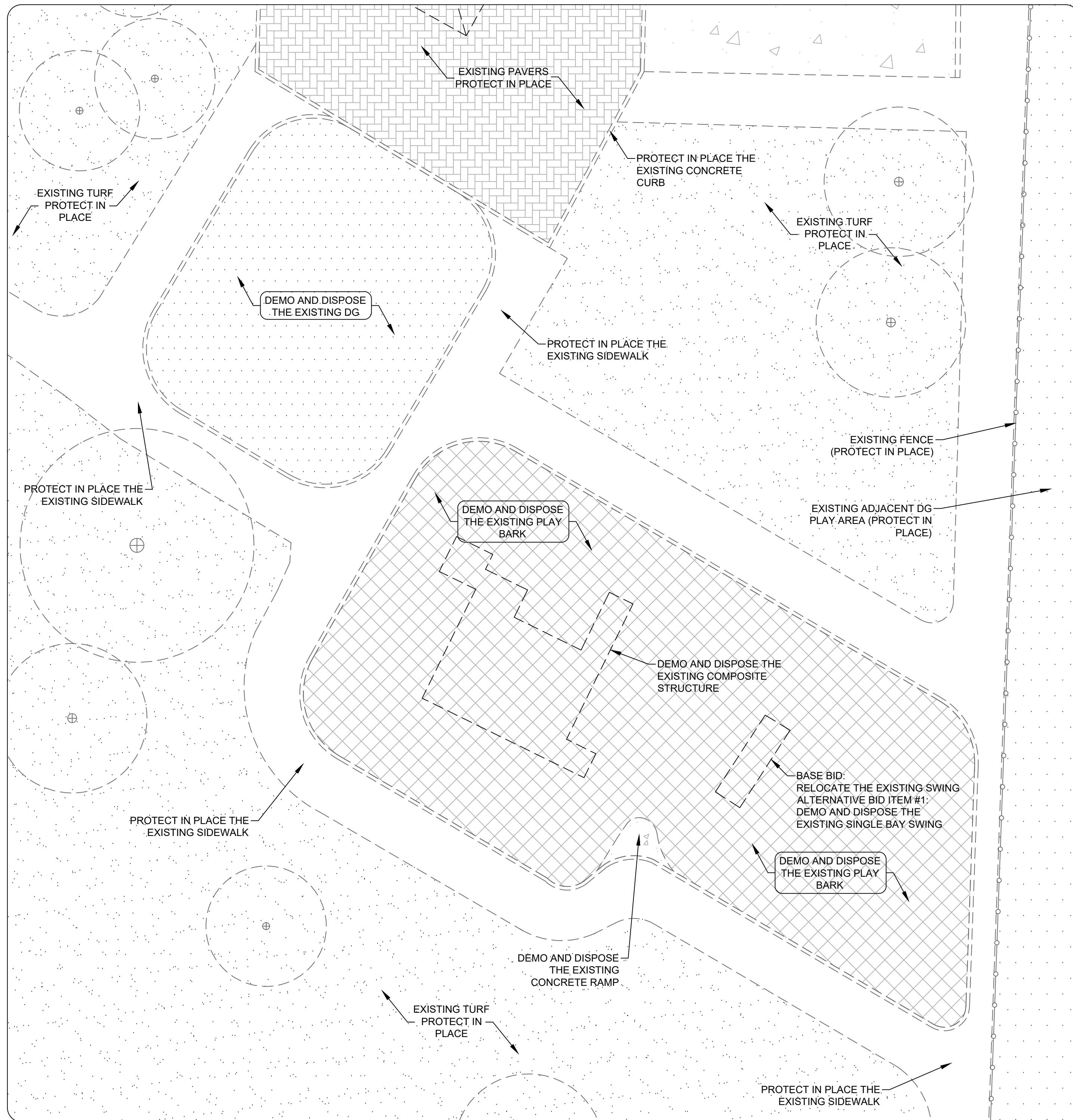

EXISTING CONDITIONS AND DEMOLITION PLAN:

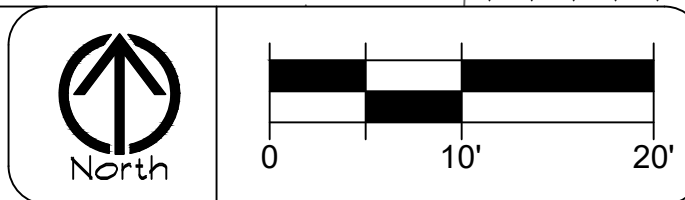

DEMOLITION LEGEND:

	EXISTING TURF: PROTECT IN PLACE
	EXISTING PAVERS: PROTECT IN PLACE
	EXISTING CONCRETE SIDEWALK: PROTECT IN PLACE
	EXISTING BARK FALL SAFETY SURFACE: DEMO AND DISPOSE OF ALL OF THE PLAY BARK DOWN TO THE SUBGRADE SOILS
	EXISTING DG SURFACE: DEMO AND DISPOSE OF ALL OF THE DG DOWN TO THE SUBGRADE SOILS. CONTRACTOR TO EXCAVATE AND REMOVE ANY SOIL AS NEEDED TO ENSURE A 16" DEPTH FROM THE ADJACENT CONCRETE HARDSCAPE FINISH GRADE.

- GENERAL NOTES:**
- ALL WORK SHALL BE COMPLETED IN COMPLIANCE WITH THE LATEST EDITION OF THE MOST CURRENT CITY OF SPARKS STANDARDS.
 - INSTALLATION OF PLAYGROUND EQUIPMENT AND/OR PROTECTIVE FALL SAFETY SURFACE TO CONFORM TO ALL PLAY AREA SAFETY RECOMMENDATIONS PER THE LATEST ADA DESIGN STANDARDS, CONSUMER PRODUCT SAFETY COMMISSION, AND ASTM STANDARDS.
 - 2010 ADA STANDARDS FOR ACCESSIBLE DESIGN
 - U.S. CONSUMER PRODUCT SAFETY COMMISSION - "PUBLIC PLAYGROUND SAFETY HANDBOOK"
 - ASTM F1292-11 IMPACT ATTENUATION OF SURFACING MATERIALS WITHIN THE USE ZONE OF PLAYGROUND EQUIPMENT
 - ASTM F1981-11 TEST METHOD FOR ACCESSIBILITY ON SAFETY SURFACING FOR PLAYGROUNDS
 - ASTM F2223-11 GUIDE FOR ASTM STANDARDS ON PLAYGROUND SURFACING
 - IT IS THE RESPONSIBILITY OF THE CONTRACTOR TO OBSERVE AND VERIFY ALL CONDITIONS PRIOR TO INSTALLATION OF FALL SAFETY PROTECTIVE SURFACING. ANY DISCREPANCIES ARE TO BE BROUGHT TO THE ATTENTION OF THE CITY PRIOR TO INSTALLATION AND SHALL BE CORRECTED BY THE CONTRACTOR PRIOR TO FINAL LAYOUT OF FALL SAFETY PROTECTIVE SURFACING. ANY DISCREPANCIES NOT CORRECTED WILL BE THE RESPONSIBILITY OF THE CONTRACTOR TO CORRECT AT NO ADDITIONAL COST TO THE CITY.

- PLAY EQUIPMENT NOTES:**
- CONTRACTOR TO INSTALL 6" TEMPORARY CHAIN LINK FENCING AROUND THE ENTIRE AREA AFFECTED BY CONSTRUCTION PRIOR TO START OF CONSTRUCTION. CONTRACTOR TO INSTALL SIGNAGE THAT STATES "PLAYGROUND IS TEMPORARILY CLOSED FOR CONSTRUCTION - DO NOT ENTER."
 - ALL PLAY EQUIPMENT INSTALLATION AND/OR REPAIRS SHALL BE INSTALLED BY A CURRENT NEVADA LICENSED CONTRACTOR THAT HOLDS A CURRENT CSR LICENSE FOR PLAYGROUND INSTALLATIONS.
 - INSTALL ALL PLAYGROUND EQUIPMENT OR REPLACEMENT PARTS PER MANUFACTURER'S SPECIFICATIONS AND INSTALLATION GUIDELINES.
 - CONTRACTOR TO NOTIFY CITY OF SPARKS REPRESENTATIVE OF FINAL PLAYGROUND USE ZONE LAYOUT 48 HOURS PRIOR TO CONCRETE INSTALLATION FOR REVIEW AND APPROVAL. IF THERE IS NO WRITTEN APPROVAL FROM A CITY REPRESENTATIVE AND ANY DISCREPANCIES ARE FOUND, IT WILL BE THE RESPONSIBILITY OF THE CONTRACTOR TO REMEDY THE ITEMS AT NO EXPENSE TO THE CITY.
 - SEE PROJECT SPECIFICATIONS FOR ADDITIONAL NOTES.
 - ALL NEW PLAY EQUIPMENT IS TO BE DIRECT BOLT SYSTEM AND WILL BE PROVIDED BY THE CITY. PURCHASING OF PLAY EQUIPMENT IS NOT A PART OF THE SCOPE OF WORK. CONTRACTOR TO COORDINATE UNLOADING, STORAGE AND INSTALLATION AS PART OF THE SCOPE OF WORK.

- GENERAL DIMENSIONING NOTES:**
- LAYOUT OF PLAY AREA PROTECTIVE FALL SAFETY SURFACE TO CONFORM TO ALL PLAY AREA SAFETY RECOMMENDATIONS PER THE FOLLOWING LATEST ADA DESIGN STANDARDS, CONSUMER PRODUCT SAFETY COMMISSION, AND ASTM STANDARDS:
 - 2010 ADA STANDARDS FOR ACCESSIBLE DESIGN
 - U.S. CONSUMER PRODUCT SAFETY COMMISSION - "PUBLIC PLAYGROUND SAFETY HANDBOOK"
 - ASTM F1292-11 IMPACT ATTENUATION OF SURFACING MATERIALS WITHIN THE USE ZONE OF PLAYGROUND EQUIPMENT
 - ASTM F1981-11 TEST METHOD FOR ACCESSIBILITY ON SAFETY SURFACING FOR PLAYGROUNDS
 - ASTM F2223-11 GUIDE FOR ASTM STANDARDS ON PLAYGROUND SURFACING
 - IT IS THE RESPONSIBILITY OF THE CONTRACTOR TO OBSERVE AND VERIFY ALL CONDITIONS PRIOR TO INSTALLATION OF FALL SAFETY PROTECTIVE SURFACING. ANY DISCREPANCIES ARE TO BE BROUGHT TO THE ATTENTION OF THE CITY PRIOR TO INSTALLATION AND SHALL BE CORRECTED BY THE CONTRACTOR PRIOR TO FINAL LAYOUT OF FALL SAFETY PROTECTIVE SURFACING. ANY DISCREPANCIES NOT CORRECTED WILL BE THE RESPONSIBILITY OF THE CONTRACTOR TO CORRECT AT NO ADDITIONAL COST TO THE CITY.



RENO • NEVADA
 PO BOX 0980
 RENO, NV 89513
 (775) 741-2505

CITY OF SPARKS
 98 RICHARDS WAY
 SPARKS, NV 89431

POULAKIDAS PARK PLAYGROUND
 IMPROVEMENT PROJECT
 EXISTING CONDITION AND DEMOLITION PLAN

DRAFTED: GSJ
 REVIEWED: GSJ

J & A JOB NUMBER:
 17-105-05

PLAN SET:
 FOR BIDDING SET

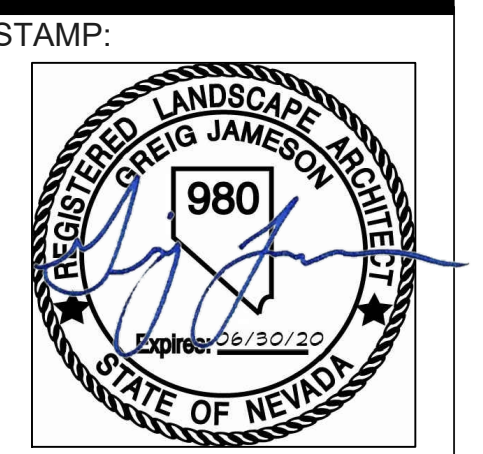

PLAN DATE: 11/08/19

REVISIONS:

#	DATE

SCALE: 1:10
 SHEET:

CITY OF SPARKS

98 RICHARDS WAY
SPARKS, NV 89431

**POULAKIDAS PARK PLAYGROUND
IMPROVEMENT PROJECT**

PLAYGROUND IMPROVEMENT PLAN

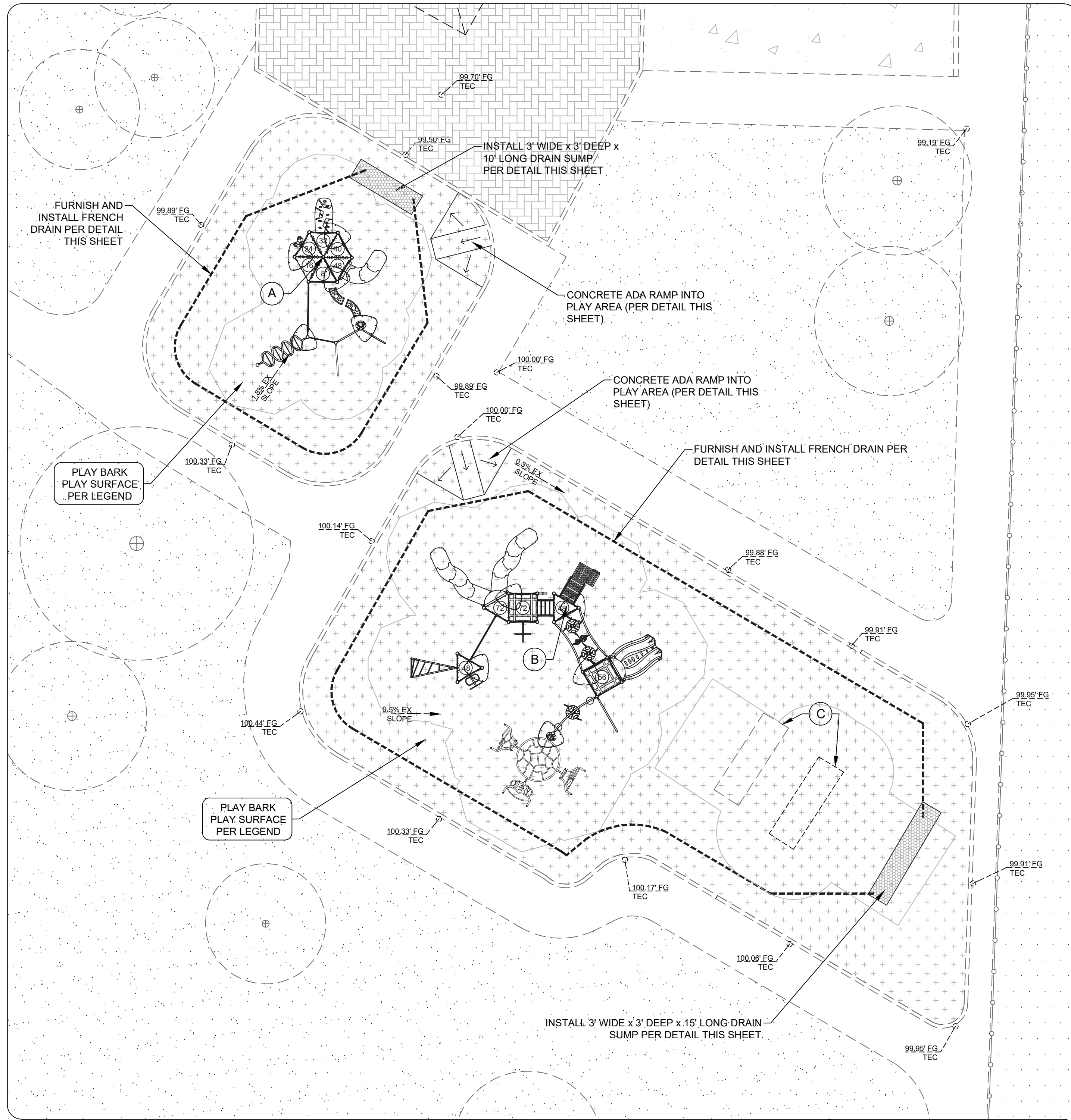

PLAYGROUND IMPROVEMENT PLAN:

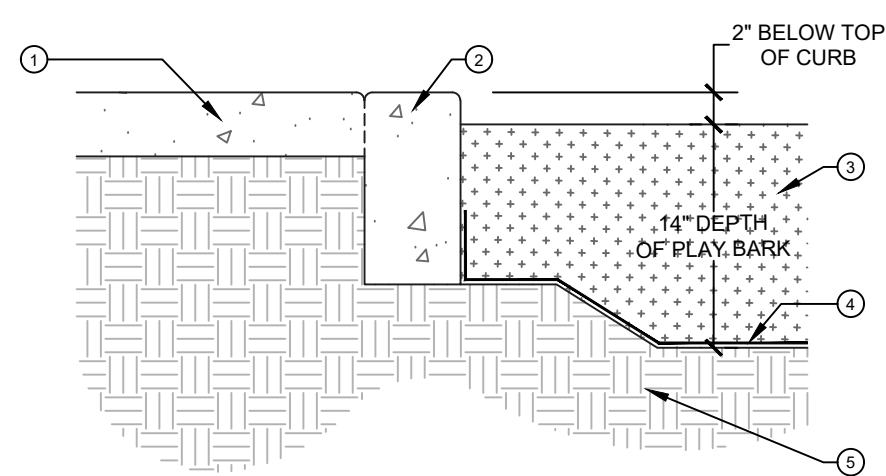
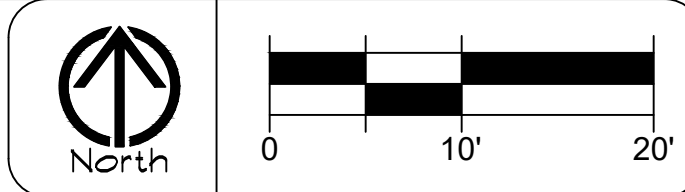

- 1 EXISTING SIDEWALK (PROTECT IN PLACE)
- 2 EXISTING CURB (PROTECT IN PLACE)
- 3 CONTRACTOR TO FURNISH AND INSTALL 14" DEPTH OF ENGINEERED WOOD FIBER PLAY BARK. INSTALL PER MANUFACTURER RECOMMENDATION
- 4 FABRIC: INSTALL LANDSCAPE FABRIC BETWEEN THE PLAY BARK AND THE NATIVE SUBGRADE SOILS
- 5 NATIVE SOILS

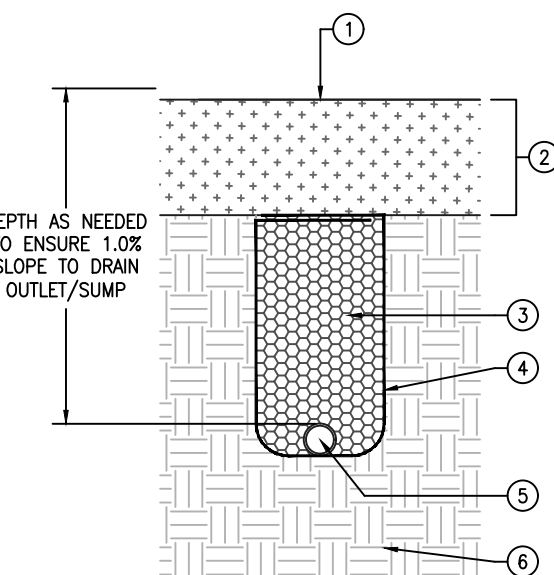

- 1 FINISH GRADE OF PLAY BARK SURFACE (TYPICAL)
- 2 ENGINEERED PLAY BARK PER DETAIL THIS SHEET
- 3 DRAIN ROCK: 1-1/2" DRAIN ROCK BACKFILL MATERIAL. COMPACTED IN PLACE.
- 4 FABRIC: WRAP ALL SIDES OF THE FRENCH DRAIN IN LANDSCAPE FABRIC
- 5 DRAIN PIPE: 4" ADS PERFORATED DRAIN PIPE
- 6 NATIVE SOILS (TYPICAL)

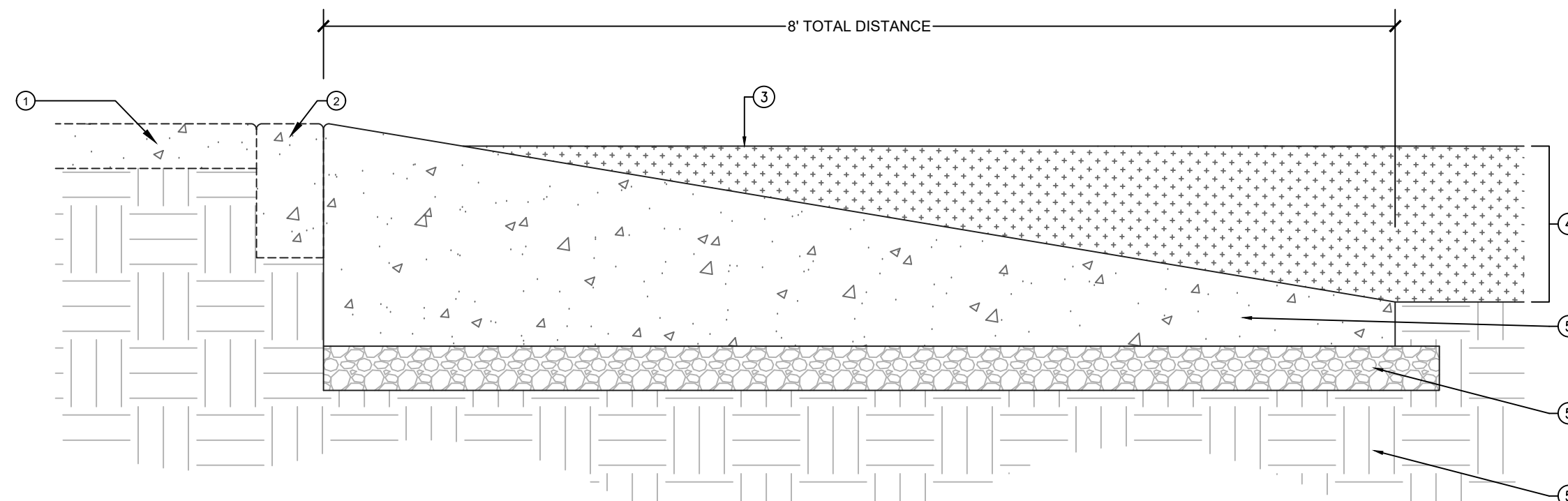

- 1 EXISTING CONCRETE SIDEWALK
- 2 EXISTING CONCRETE CURB
- 3 FINISH GRADE OF PLAY BARK
- 4 ENGINEERED PLAY BARK PER DETAIL THIS SHEET
- 5 CONCRETE ADA RAMP
- 6 BASE AGGREGATE: 4" MINIMUM DEPTH OF TYPE II COMPACTED BASE AGGREGATE. INSTALL IN 4" LIFTS AND COMPACT TO 95% RELATIVE COMPACTION.

1 PLAY BARK INSTALLATION DETAIL:
NOT TO SCALE

2 FRENCH DRAIN DETAIL:
NOT TO SCALE

3 ADA RAMP DETAIL:
NOT TO SCALE

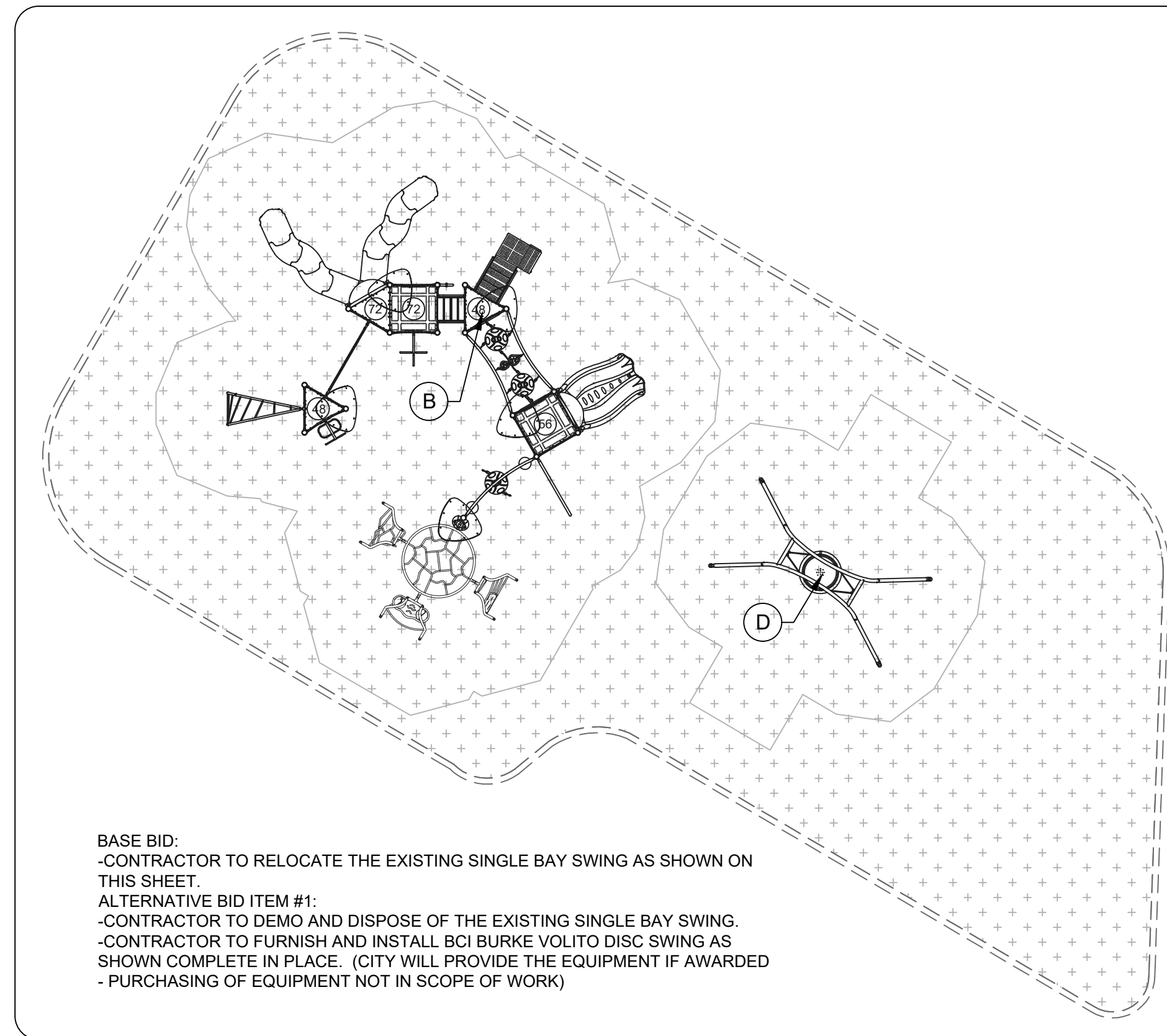

ALTERNATIVE BID ITEM #1:

BASE BID:
-CONTRACTOR TO RELOCATE THE EXISTING SINGLE BAY SWING AS SHOWN ON THIS SHEET.
ALTERNATIVE BID ITEM #1:
-CONTRACTOR TO DEMO AND DISPOSE OF THE EXISTING SINGLE BAY SWING.
-CONTRACTOR TO FURNISH AND INSTALL BCI BURKE VOLITO DISC SWING AS SHOWN COMPLETE IN PLACE. (CITY WILL PROVIDE THE EQUIPMENT IF AWARDED)
-PURCHASING OF EQUIPMENT NOT IN SCOPE OF WORK

PLAYGROUND IMPROVEMENT LEGEND:

- A INSTALL BCI BURKE CUSTOM 2-5 YEAR OLD STRUCTURE PER DESIGN #907-122778-1 (CITY TO PROVIDE ALL PLAY EQUIPMENT)
- B INSTALL BCI BURKE CUSTOM 5-12 YEAR OLD STRUCTURE PER DESIGN #907-122778-1 (CITY TO PROVIDE ALL PLAY EQUIPMENT)
- C BASE BID: RELOCATE THE EXISTING SINGLE BAY SWING AS SHOWN (CITY TO PROVIDE ALL PLAY EQUIPMENT)
- D ALT BID ITEM #1: INSTALL BCI BURKE VOLITO DISC SWING (CITY TO PROVIDE ALL PLAY EQUIPMENT)
- ++ PLAY SURFACE: CONTRACTOR TO INSTALL A 14" DEPTH OF ENGINEERED PLAY BARK FALL SAFETY SURFACE. INSTALL PER MANUFACTURER RECOMMENDATION.
- FRENCH DRAIN: CONTRACTOR TO FURNISH AND INSTALL 4" ADS PERFORATED DRAIN PIPE WITH 1-1/2" DRAIN ROCK BACKFILL. WRAP ALL SIDES OF THE FRENCH DRAIN WITH LANDSCAPE FABRIC. INSTALL PIPE WITH MINIMUM 1.0% SLOPE TO DRAIN SUMP LOCATION.
- FG - EXISTING FINISH GRADE
TEC - TOP OF EXISTING CONCRETE

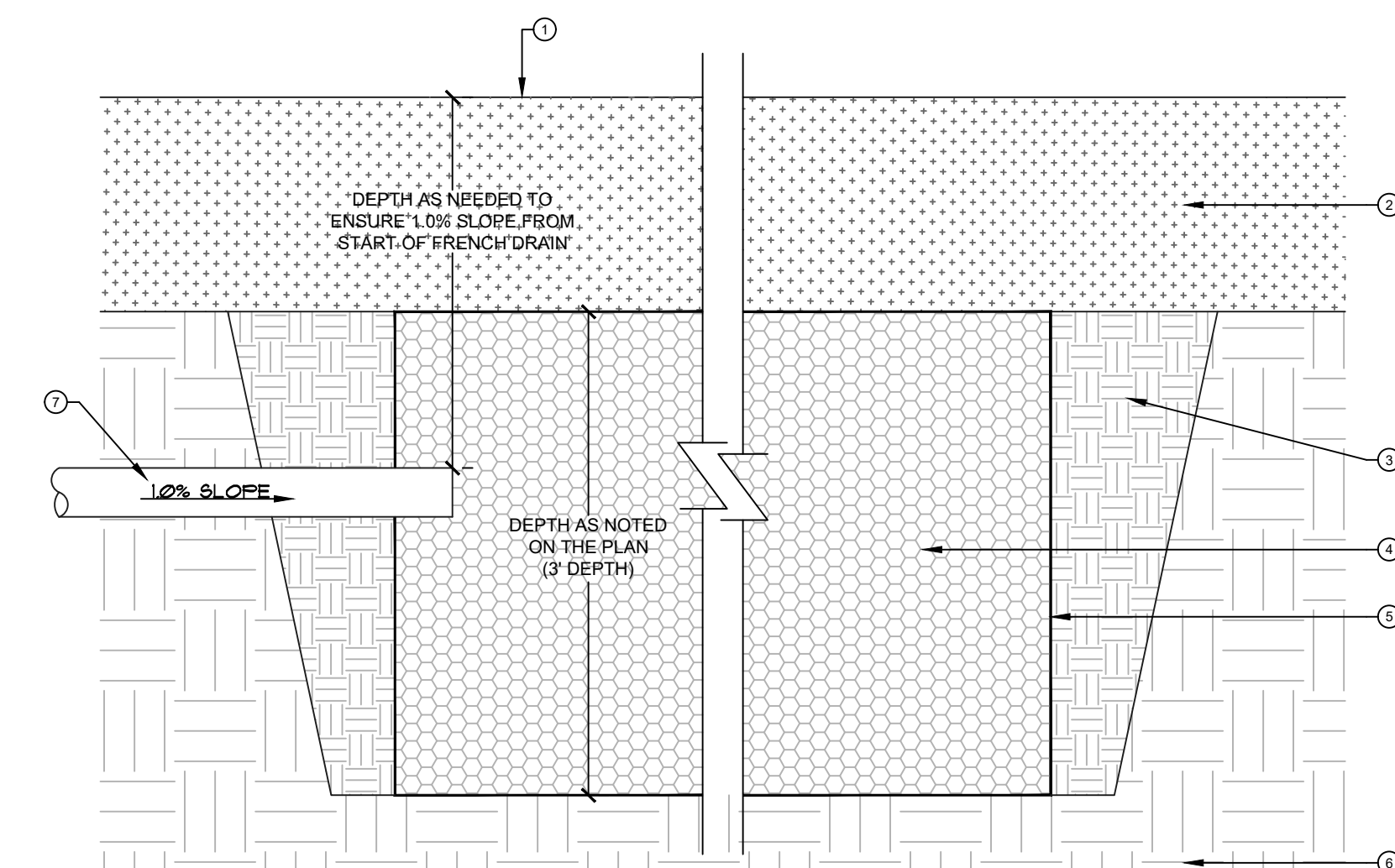

- 1 FINISH GRADE OF PLAY BARK
- 2 PLAY BARK PER INSTALLATION DETAIL THIS SHEET
- 3 COMPACTED NATIVE SOILS BACKFILL MATERIAL
- 4 DRAIN SUMP: CONTRACTOR TO FILL WITH 1-1/2" DRAIN ROCK COMPACTED TO 90% RELATIVE COMPACTION. SIZE NOTED ON THE PLAN ABOVE.
- 5 FABRIC: WRAP THE ENTIRE DRAIN SUMP IN LANDSCAPE FABRIC
- 6 NATIVE SOILS
- 7 FRENCH DRAIN: CONTRACTOR TO INSTALL END OF THE FRENCH DRAIN IN THE DRAIN SUMP AS SHOWN.

4 DRAIN SUMP DETAIL:
NOT TO SCALE

DRAFTED: G&J
REVIEWED: G&J

J & A JOB NUMBER:
17-105-05

PLAN SET:
FOR BIDDING SET

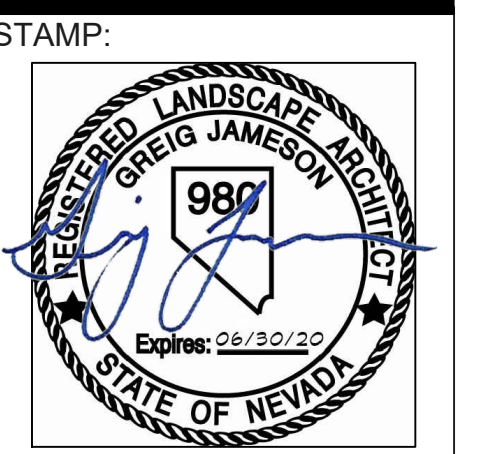

PLAN DATE: 11/08/19

#	DATE

SCALE: 1:10
SHEET: