

# CIVIL IMPROVEMENT PLANS FOR VICTORIAN SQUARE INFRASTRUCTURE-PHASE 2A CITY OF SPARKS, WASHOE COUNTY, NEVADA BID NO. 18-19-015 NEVADA PWP-WA-2019-075

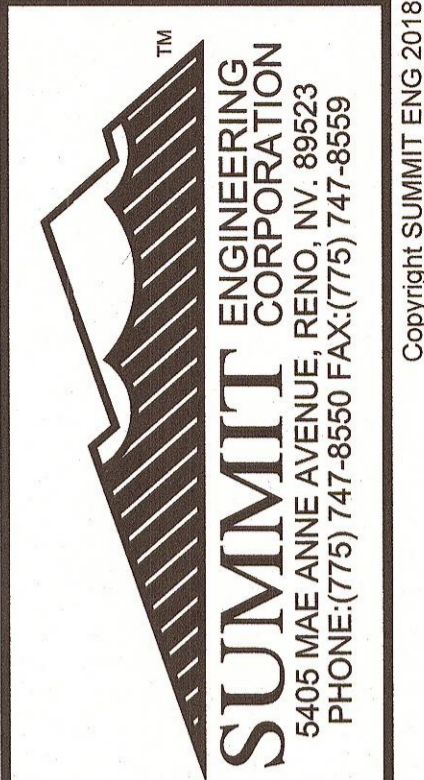

Copyright SUMMIT ENG 2018

## APPROVALS



CITY OF SPARKS  
431 PRATER WAY  
SPARKS, NV 89431  
PHONE: (775) 353-2300

RON SMITH .....	MAYOR
STEVE DRISCOLL .....	CITY MANAGER
ED LAWSON .....	CITY COUNCILMAN, WARD 1
CHARLENE BYBEE .....	CITY COUNCILMAN, WARD 2
KRISTOPHER DAHIR .....	CITY COUNCILMAN, WARD 3
	CITY COUNCILMAN, WARD 4
	CITY COUNCILMAN, WARD 5

JON ERICSON, PE, PTOE  
CITY ENGINEER

*[Signature]* 12/6/18

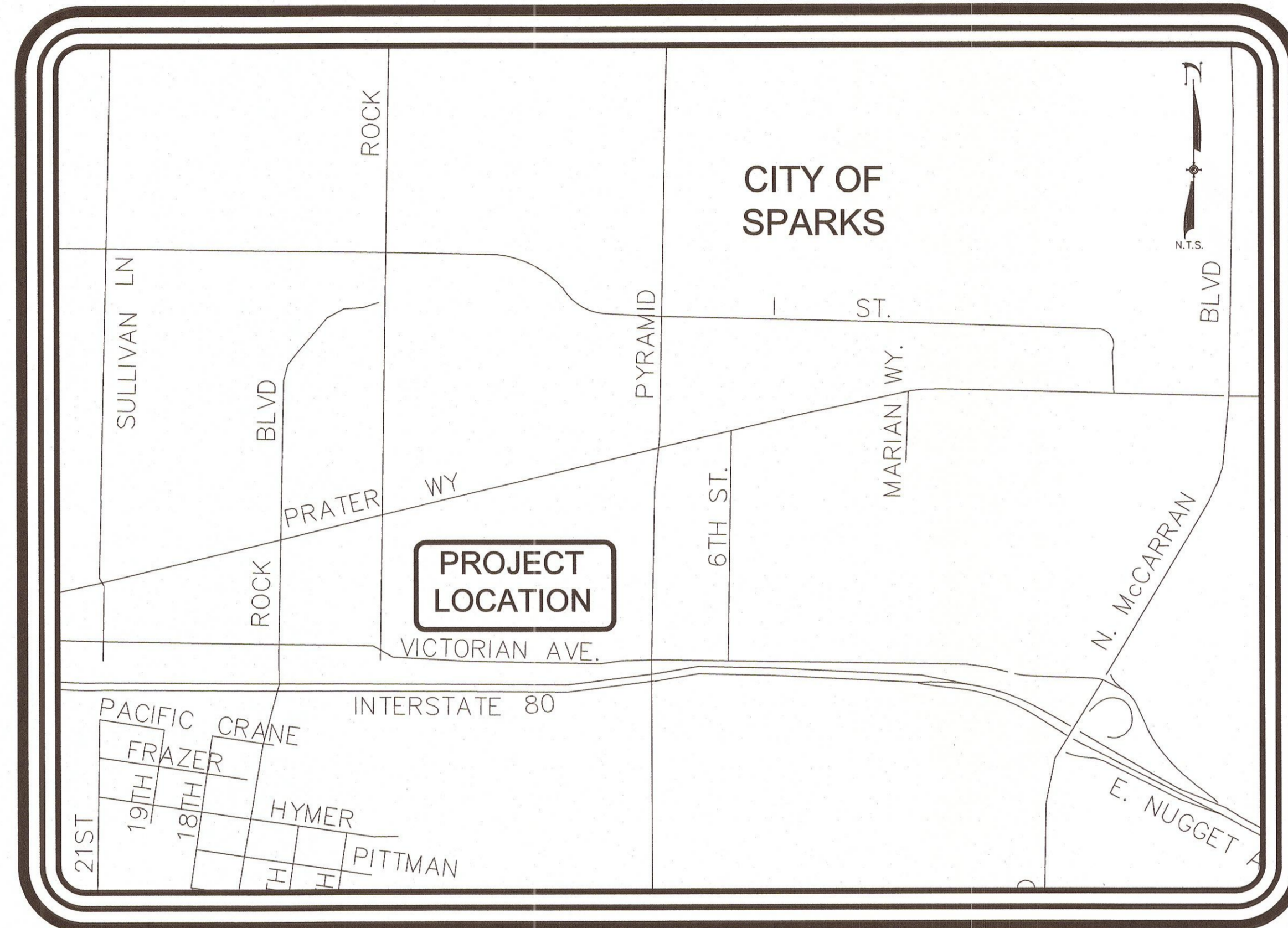

**VICINITY MAP**  
N.T.S.

## ENGINEER:



## SHEET INDEX

C0.1	TITLE SHEET
C0.2	KEY MAP
C1.1A	DEMOLITION PLAN
C1.2A	DEMOLITION PLAN
C2.1A	SITE AND GRADING PLAN
C2.2A	SITE AND GRADING PLAN
C2.3A	FENCE INSTALLATION PLAN
C3.1	DETAIL SHEET
C3.2	DETAIL SHEET

## BASIS OF BEARINGS

NORTH AMERICAN DATUM OF 1983 AS BASED ON FEDERAL BASE NETWORK/COOPERATIVE BASE NETWORK OBSERVATIONS IN 1994 (AKA NAD83/94), NEVADA STATE PLANE WEST ZONE AS DETERMINED WITH REAL TIME KINEMATIC (RTK) GPS OBSERVATIONS WITH CORRECTIONS TRANSMITTED BY WASHOE COUNTY CONTINUOUSLY OPERATING REFERENCE STATION (CORS) STATION "NWRENO". GROUND COORDINATES HEREON REFLECT GRID COORDINATES MULTIPLIED BY A COMBINED GRID TO GROUND FACTOR OF 1.000197939.

## BASIS OF ELEVATION

NORTH AMERICAN VERTICAL DATUM OF 1988 (NAVD88) PER CITY OF SPARKS BENCHMARK NUMBER 77 TAKEN AS THE PUBLISHED ELEVATION OF 4407.56 BEING A 1.5" DIAMETER STEEL CAP SET IN THE TOP OF CURB AT THE NORTHEAST CORNER OF THE INTERSECTION OF EAST PRATER WAY AND STANDARD WAY BEING 2' EASTERLY OF THE SOUTH RETURN ON EAST PRATER WAY

## SPECIFICATIONS

ALL CONSTRUCTION SHALL CONFORM TO THE LATEST EDITION OF THE STANDARD SPECIFICATIONS FOR PUBLIC WORKS CONSTRUCTION (AND ANY APPURTENANT SUPPLEMENTS), SPONSORED AND DISTRIBUTED BY RENO, SPARKS, AND WASHOE COUNTY, AND THE SPECIAL PROVISIONS, GENERAL CONDITIONS, TECHNICAL SPECIFICATIONS, AND OTHER CONTRACT DOCUMENTS.

## ENGINEER'S STATEMENT

THESE PLANS HAVE BEEN PREPARED IN ACCORDANCE WITH ACCEPTED ENGINEERING PROCEDURES AND GUIDELINES, AND ARE IN SUBSTANTIAL COMPLIANCE WITH APPLICABLE STATUTES, CITY ORDINANCES, AND CODES. IN THE EVENT OF CONFLICT BETWEEN ANY PORTION OF THESE PLANS AND CITY CODES, THE CITY CODES SHALL PREVAIL.

*[Signature]*  
CLINT THIESSE, P.E.

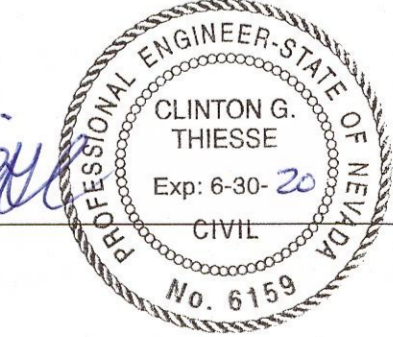

## GENERAL NOTES

- THE CONTRACTOR SHALL BE RESPONSIBLE FOR ANY DAMAGE TO EXISTING ROADS, BUILDINGS, OR OTHER STRUCTURES RESULTING FROM OR THROUGH CONSTRUCTION ACTIVITIES. REPAIRS SHALL BE MADE TO THE SATISFACTION OF THE AGENCY AND AT NO COST TO THE OWNER. THE CONTRACTOR IS ALSO RESPONSIBLE FOR REPAIRS TO EXISTING LANDSCAPING OR SPECIAL HARDSCAPE FEATURES (I.E., STAMPED CONCRETE, BRICK, DURASTONE, ETC.) DAMAGED BY OR THROUGH CONSTRUCTION ACTIVITIES. REPAIRS SHALL BE MADE TO THE SATISFACTION OF THE DESIGN ENGINEER. THE CONTRACTOR SHALL CONFINE HIS ACTIVITIES TO WITHIN THE LIMITS OF CONSTRUCTION. ALL AREAS DISTURBED BY THE CONTRACTOR OR THROUGH HIS/HER CONSTRUCTION ACTIVITIES SHALL BE RESTORED TO THEIR NATURAL OR BETTER CONDITION. THE CONTRACTOR SHALL RECEIVE NO PAYMENT FOR SUCH RESTORATION.
- THE CONTRACTOR SHALL IMMEDIATELY NOTIFY THE DESIGN ENGINEER OF DISCREPANCIES BETWEEN THE INFORMATION SHOWN ON THESE DRAWINGS AND THE CONDITIONS EXISTING IN THE FIELD. ANYTHING MENTIONED IN THE SPECIFICATIONS AND NOT SHOWN ON THESE DRAWINGS, OR SHOWN ON THE DRAWINGS AND NOT MENTIONED IN THE SPECIFICATIONS SHALL BE OF LIKE EFFECT AS IF SHOWN OR MENTIONED IN BOTH. IF THE CONTRACTOR FAILS TO NOTIFY THE DESIGN ENGINEER IN A TIMELY MANNER OF ANY APPARENT ERROR OR OMISSION ON THE PLANS OR IN THE SPECIFICATIONS, THE CONTRACTOR WILL BE RESPONSIBLE FOR CORRECTING WORK INCORRECTLY DONE AT THE CONTRACTOR'S EXPENSE.
- ALL CONSTRUCTION MATERIALS AND PRACTICES SHALL CONFORM TO THE STANDARD SPECIFICATIONS FOR PUBLIC WORKS CONSTRUCTION (LATEST EDITION THROUGH 2012 UPDATES), STANDARD DETAILS FOR PUBLIC WORKS CONSTRUCTION, SPECIAL PROVISIONS AND THESE PLANS AND SPECIFICATIONS, AND ALL SAFETY REGULATIONS AND CODES PERTINENT TO THE PROJECT CONSTRUCTION.
- PAYMENT FOR WORK SHOWN ON THESE PLANS EITHER SPECIFIED OR INFERRED, BUT NOT INCLUDED IN THE BID PROPOSAL SHALL BE CONSIDERED AS INCLUDED IN THE PRICE PAID FOR OTHER ITEMS OF WORK.
- THE CONTRACTOR SHALL BE RESPONSIBLE FOR ENSURING THAT ALL MANHOLE RIMS, UTILITY COVERS, AND SURVEY MONUMENTS WITHIN THE CONSTRUCTION LIMITS ARE SET IN ACCORDANCE WITH MANHOLE COLLAR, UTILITY VALVE, AND SURVEY MONUMENT DETAILS.
- THE CONTRACTOR SHALL BE RESPONSIBLE FOR OBTAINING WATER FOR HIS NEEDS, AS WELL AS STAGING AREA LOCATIONS. THE CONTRACTOR SHALL BE RESPONSIBLE FOR JOB SITE SECURITY FOR MATERIALS, SUPPLIES, EQUIPMENT, ETC., THROUGHOUT THE DURATION OF THE CONTRACT. ALL MATERIALS, WHETHER IN TRANSIT, STORED ON SITE OR INSTALLED AWAITING FINAL ACCEPTANCE ARE THE PROPERTY OF THE CONTRACTOR. ALL LOSS OR DAMAGE TO THE MATERIALS, UNTIL ACCEPTANCE, IS THE RESPONSIBILITY OF THE CONTRACTOR AND MUST BE REPAIRED OR REPLACED AT THE CONTRACTOR'S EXPENSE.
- THE LOCATION OF EXISTING UTILITIES SHOWN ON THE PLANS ARE APPROXIMATE ONLY AND INDICATE GENERALLY THEIR LOCATION ACCORDING TO THE BEST KNOWLEDGE OF THE DESIGN ENGINEER. THE CONTRACTOR SHALL NOTIFY UTILITY COMPANIES NOT LESS THAN FIVE WORKING DAYS PRIOR TO THE START OF CONSTRUCTION TO VERIFY THE LOCATION AND DEPTHS OF UTILITIES. THE CONTRACTOR SHALL CALL UNDERGROUND SERVICES ALERT AT 1-800-227-2600 PRIOR TO COMMENCING ANY EXCAVATION ACTIVITIES FOR UTILITY LOCATION. ANY DAMAGE TO UTILITIES CAUSED BY OPERATIONS OF THE CONTRACTOR SHALL BE REPAIRED BY THE CONTRACTOR AT NO COST TO THE OWNER. THE CONTRACTOR SHALL SUBMIT TO THE DESIGN ENGINEER, A LIST OF UTILITY APPURTENANCES ENCOUNTERED DURING CONSTRUCTION INDICATING STATION AND OFFSET.
- SUBSURFACE UTILITIES ARE DEPICTED BY THEIR QUALITY LEVELS IN ACCORDANCE AMERICAN SOCIETY OF CIVIL ENGINEERS STANDARD GUIDELINES FOR THE COLLECTION AND DEPICTION OF EXISTING SUBSURFACE UTILITY DATE (CI/ASCE 38-02). ALL UTILITY INFORMATION SHOWN HEREON IS DEPICTED TO QUALITY "C" UNLESS OTHERWISE NOTED.
- DESIGN GRADES SHOWN FOR PEDESTRIAN RAMPS ARE BASED UPON THE BEST INFORMATION AVAILABLE TO THE ENGINEER, BUT MUST BE CONSIDERED APPROXIMATE. THE CONTRACTOR IS RESPONSIBLE FOR VERIFYING THAT PEDESTRIAN RAMP SLOPES WITHIN THE LIMITS OF CONSTRUCTION OF THIS PROJECT ARE COMPLIANT WITH THE APPLICABLE DETAILS. AT ALL POINTS WHERE PEDESTRIAN RAMPS TIE-IN TO EXISTING FACILITIES, GRADES SHALL MATCH TO PROVIDE SMOOTH, CONTINUOUS TRANSITIONS FROM RECONSTRUCTED IMPROVEMENTS TO EXISTING IMPROVEMENTS. DISCREPANCIES BETWEEN ACTUAL FIELD CONDITIONS AND THESE PLANS WHICH MAY PREVENT COMPLIANT STRUCTURES FROM BEING CONSTRUCTED SHALL BE CALLED TO THE ATTENTION OF THE DESIGN ENGINEER IMMEDIATELY.
- DURING THE ENTIRE DURATION OF THIS CONSTRUCTION CONTRACT, THE CONTRACTOR SHALL IMPLEMENT STRINGENT DUST CONTROL MEASURES IN ACCORDANCE WITH CITY OF SPARKS AND WASHOE COUNTY HEALTH DEPARTMENT RULES AND REGULATIONS. THE CONTRACTOR IS REQUIRED TO SUPPRESS DUST AT ALL TIMES, 24 HOURS A DAY, REGARDLESS OF WHEN CONSTRUCTION ACTIVITIES ARE OCCURRING. THE CONTRACTOR IS REQUIRED TO HAVE AN APPROVED SWPPP PRIOR TO START OF CONSTRUCTION.
- PLANTMIX BITUMINOUS PAVEMENT IS TO BE LAID IN LIFTS NOT TO EXCEED THREE INCHES PER LIFT UNLESS OTHERWISE SPECIFIED OR APPROVED BY ENGINEER.
- THE CONTRACTOR SHALL BE RESPONSIBLE FOR ALL DEWATERING OPERATIONS, IF REQUIRED, INCLUDING EXPLORATION, DESIGN, ENGINEERING, PERMITTING, INSTALLATION, OPERATION AND CLOSURE METHODS AND OPERATION SHALL BE SUBJECT TO THE ENGINEER'S APPROVAL AND ANY CONDITIONS OR REVIEWING AND PERMITTING AGENCIES.
- THE CONTRACTOR SHALL BE RESPONSIBLE FOR ALL NECESSARY EXCAVATION SUPPORT SYSTEMS INCLUDING SHORING. SHORING DESIGN SHALL BE PREPARED BY A NEVADA P.E. AND SHALL BE SUBJECT TO REVIEW AND APPROVAL BY THE ENGINEER.
- SHOULD ANY PREHISTORIC OR HISTORIC REMAINS/ARTIFACTS BE DISCOVERED DURING SITE DEVELOPMENT, WORK SHALL TEMPORARILY BE HALTED AT THE SPECIFIC SITE AND THE STATE HISTORIC PRESERVATION OFFICE OF THE DEPARTMENT OF MUSEUMS, LIBRARY, AND ARTS, SHALL BE NOTIFIED TO RECORD AND PHOTOGRAPH THE SITE. THE PERIOD OF TEMPORARY DELAY SHALL BE LIMITED TO A MAXIMUM OF TWO (2) WORKING DAYS FROM THE DATE OF NOTIFICATION.
- CONTRACTOR SHALL PROVIDE A "MANHOLE PROTECTION PLAN" PRIOR TO START OF PROJECT. PLAN SHALL INCLUDE DESCRIPTION AND METHOD OF SYSTEM AND/OR DEVICES TO BE INSTALLED IN ALL SEWER / STORM DRAIN / UTILITY MANHOLES AT ANY TIME THEY ARE EXPOSED (RAISING, LOWERING, ETC.) TO PREVENT AND CONTAIN ANY DEBRIS FROM ENTERING THE PIPING SYSTEM. CONTAINMENT DEVICE SHALL PROVIDE FOR COMPLETELY CAPTURING, AND RETRIEVING ALL DEBRIS, PRIOR TO REPLACING TEMPORARY OR PERMANENT MANHOLE COVERS. UPON PROJECT COMPLETION, ALL MANHOLES AND CATCH BASINS SHALL BE INSPECTED, AND VERIFIED BY INSPECTOR FOR APPROVAL.
- CONTRACTOR SHALL BE RESPONSIBLE FOR PROVIDING A SUITABLE SEWER VACUUM (VACUUM) TRUCK TO REMOVE CONSTRUCTION MATERIALS FROM MANHOLES, CATCH BASINS AND PIPES. EMERGENCY PHONE CONTACT NUMBER SHALL BE PROVIDED WITH EMERGENCY CONTACTS.
- ALL SURVEY MONUMENTS TO BE REPLACED. ANY SURVEY WELL MONUMENTS WITHIN PROJECT LIMITS SHALL BE REPLACED BY P.L.S., PER 334.0 ORANGE BOOK, NRS AND STANDARD DETAIL R-124. "ADJUST OR PROTECT IN PLACE" WILL NOT BE ALLOWED.

REV.	DATE	DESCRIPTION	BY	APP'D

CITY OF SPARKS  
VICTORIAN SQUARE INFRASTRUCTURE  
PHASE 2A IMPROVEMENTS  
SPARKS  
WASHOE COUNTY  
NEVADA

DESIGNED BY: MF  
CHECKED BY: CT  
SCALE  
HORIZ: N.T.S.  
VERT: N/A  
JOB NO: 30748

SHEET  
C0.1 OF 9

N:\DWG\30748\_VictorianAvePhase2\Civil\CP-PH2\_TITLE.DWG - 2:15 PM \* 05-DEC-2018

# CIVIL IMPROVEMENT PLANS FOR CITY OF SPARKS VICTORIAN SQUARE INFRASTRUCTURE - PHASE 2A

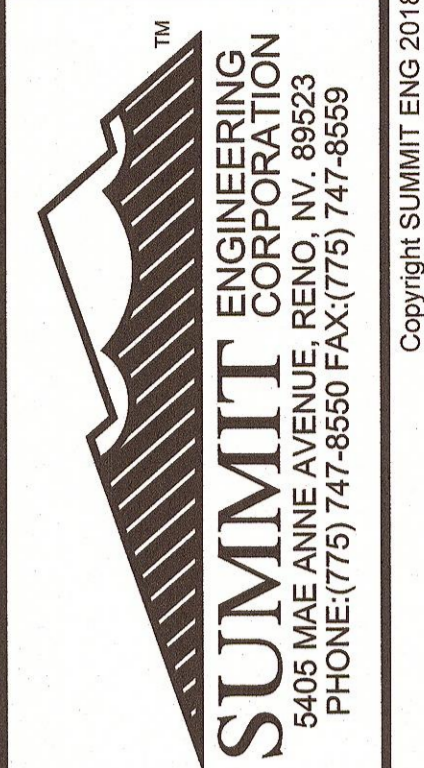

Copyright SUMMIT ENG 2018

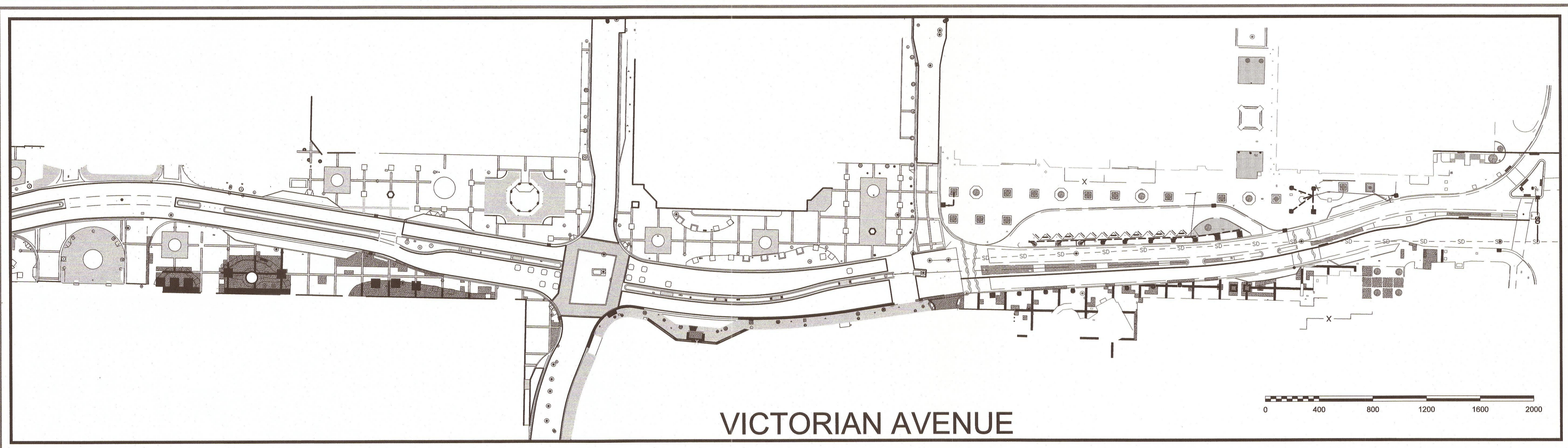

VICTORIAN AVENUE

### ABBREVIATIONS

±	APPROXIMATE	LT	LEFT
AC	ASPHALTIC CONCRETE	M.D.D.	MAXIMUM DRY DENSITY
ACP	ASBESTOS CEMENT PIPE	MISC.	MISCELLANEOUS
AP	ANGLE POINT	MH	MANHOLE
ASTM	AMERICAN SOCIETY PER TESTING & MATERIALS	NOS.	NUMBERS
BC	BEGIN CURVE	N.T.S.	NOT TO SCALE
BS	BACK OF SIDEWALK	O.D.	OUTSIDE DIAMETER
BVC	BEGIN VERTICAL CURVE	PROP.	PROPOSED
BW	BACK OF SIDEWALK	P	PAD ELEVATION
CAP	CAPACITY	PB	PULL BOX
CB	CATCH BASIN	P.C.C	PORTLAND CEMENT CONCRETE
CH	CHORD	PED.	PEDESTRIAN
CI	CAST IRON	PI	POINT OF INTERSECTION
CL	CENTERLINE	PL	PROPERTY LINE
CMP	CORRUGATED METAL PIPE	P.L.C.	PROFESSIONAL LAND SURVEYOR
CONC	CONCRETE	PM	PARCEL MAP
CONST.	CONSTRUCT	POT	POINT OF TANGENT
C.O.S.	CITY OF SPARKS	PRC	POINT OF REVERSE CURVATURE
CP	CONCRETE PIPE	PROP.	PROPOSED
CR	CURB RETURN	PS	PARKING SPACE
DET	DETAIL	PUE	PUBLIC UTILITY EASEMENT
Ø	INSIDE DIAMETER	PVC	POLYVINYL CHLORIDE PIPE
DI	DROP INLET	Q	VOLUMETRIC FLOW RATE
DIA	DIAMETER	(P)	RADIAL
DIM.	DIMENSION	R	RADIUS
DWG	DRAWING	RCP	REINFORCED CONCRETE PIPE
DWY	DRIVEWAY	REF.	REFERENCE
E	ELECTRICAL	RET	CURB/SIDEWALK/WALL RETURN
EC	END OF CURVE	REQ	REQUIRED
EG	EXISTING GRADE	RP	REFERENCE POINT
ELEV	ELEVATION	RT	RIGHT
EVC	END OF VERTICAL CURVE	R/W	RIGHT-OF-WAY
(E)	EXISTING	S	SLOPE
EX.	EXISTING	SD	STORM DRAIN
EXIST.	EXISTING	SDMH	STORM DRAIN MANHOLE
FES	FLARED END SECTION	SHT	SHEET
FF	FINISHED FLOOR	S/O	STATION AND OFFSET LINE
FFC	FRONT FACE OF CURB	SS	SANITARY SEWER
FG	FINISHED GRADE	STA	STATION
FH	FIRE HYDRANT	STD	STANDARD
FL	FLOW LINE	SUB	SUB-BASIN
FW	FRONT OF SIDEWALK	SW	SIDEWALK
G	GAS	T	TANGENT
GB	GRADE BREAK	TEL	TELEPHONE
GV	GAS VALVE	TBC	TOP BACK OF CURB
HORIZ	HORIZONTAL	TC	TOP OF CURB
HPS	HANDICAP SPACE	TDC	TOP OF DEPRESSED CURB
HS	HOUSE SERVICE	THRU	THROUGH
IE	INVERT ELEVATION	TP	TEST PIT
ID	INSIDE DIAMETER	TW	TOP OF WALL
INT	INTERSECTION	TYP	TYPICAL
L	LENGTH	VC	VERTICAL CURVE
LF	LINEAL FEET	VG	VALLEY GUTTER
LIP	LIP OF GUTTER	VERT	VERTICAL
LOC	LIMITS OF CONSTRUCTION	VPI	VERTICAL POINT OF INTERSECTION
		W	WATER
		WV	WATER VALVE
		W	WITH

### LEGEND

--- X ---	EX. FENCE LINE	⊗	EX. CATCH BASIN / DROP INLET
--- W ---	EX. WATERLINE	■	PROP. CATCH BASIN
--- IRR ---	EX. IRRIGATION LINE	○	EX. POWER POLE
--- G ---	EX. GAS LINE	⊙	MANHOLE (HOLLOW IF EXISTING)
--- SS ---	EX. SANITARY SEWER LINE	●	SIGN
--- SD ---	EX. STORM DRAIN LINE	■	CONCRETE REMOVAL / PLACEMENT
--- SD ---	PROP. STORM DRAIN LINE	⊕	UTILITY VALVE (WATER AND GAS)
--- OE ---	EX. OVER HEAD POWER LINE	⊙	SURVEY MONUMENT
--- E ---	EX. UNDER GROUND ELECTRIC	●	CITY OF SPARKS BENCHMARK
--- FOC ---	EX. FIBER OPTICS LINE	□	EX. UTILITY VAULT
---	EX. RW AND PROPERTY LINE	⊕	EX. FIRE HYDRANT
---	CONSTRUCTION CENTERLINE	○	PROP. LIGHT POLE
---	FLOW LINE	○	EX. LIGHT POLE
////	SAW CUT / LIMITS	--- Fc=90.00	PROP. GRADE
---	EX. MINOR CONTOUR	--- Eg=(90.00)	EX. GRADE
---	EX. MAJOR CONTOUR	(1.00%)	EX. SLOPE AND DIRECTION
---	EX. FRONT/BACK CURB FACE	1.00%	PROP. SLOPE AND DIRECTION
---	EX. EDGE OF PAVEMENT		
---	EX. BACK OF WALK		
---	EX. LANDSCAPING		

### SWPPP NOTES

**STANDARD NOTE No. 1**  
THE CONTRACTOR AND/OR THEIR AUTHORIZED AGENTS SHALL EACH DAY REMOVE ALL SEDIMENT, MUD, CONSTRUCTION DEBRIS, OR OTHER POTENTIAL POLLUTANTS THAT MAY HAVE BEEN DISCHARGED TO, OR ACCUMULATED IN, THE PUBLIC RIGHTS OF WAYS AS A RESULT OF CONSTRUCTION ACTIVITIES ASSOCIATED WITH THIS SITE DEVELOPMENT OR CONSTRUCTION PROJECT. SUCH MATERIALS SHALL BE PREVENTED FROM ENTERING THE STORM SEWER SYSTEM.

**STANDARD NOTE No. 2**  
ADDITIONAL CONSTRUCTION SITE DISCHARGE BEST MANAGEMENT PRACTICES MAY BE REQUIRED OF THE CONTRACTOR AND HIS OR HER AGENTS DUE TO UNFORESEEN EROSION PROBLEMS OR IF THE SUBMITTED PLAN DOES NOT MEET THE PERFORMANCE STANDARDS SPECIFIED IN THE TRUCKEE MEADOWS CONSTRUCTION SITE BEST MANAGEMENT PRACTICES HANDBOOK.

**STANDARD NOTE No. 3**  
TEMPORARY OR PERMANENT STABILIZATION PRACTICES WILL BE INSTALLED ON DISTURBED AREAS AS SOON AS PRACTICABLE AND NO LATER THAN 14 DAYS AFTER THE CONSTRUCTION ACTIVITY IN THAT PORTION OF THE SITE HAS TEMPORARILY OR PERMANENTLY CEASED. SOME EXCEPTIONS MAY APPLY. REFER TO STORMWATER GENERAL PERMIT NVR100000.

**STANDARD NOTE No. 4**  
AT A MINIMUM, THE CONTRACTOR OR HIS AGENT SHALL INSPECT ALL DISTURBED AREAS. AREAS USED FOR STORAGE OF MATERIALS AND EQUIPMENT THAT AREA EXPOSED TO PRECIPITATION, VEHICLE ENTRANCE AND EXIT LOCATIONS AND ALL BMPs WEEKLY, PRIOR TO A FORECASTED RAIN EVENT AND WITHIN 24 HOURS AFTER ANY ACTUAL RAIN EVENT. THE CONTRACTOR OR HIS AGENT SHALL UPDATE OR MODIFY THE STORM WATER POLLUTION PREVENTION PLAN AS

NECESSARY. SOME EXCEPTIONS TO WEEKLY INSPECTIONS MAY APPLY, SUCH AS FROZEN GROUND CONDITIONS OR SUSPENSION OF LAND DISTURBANCE ACTIVITIES. REFER TO STORMWATER GENERAL PERMIT NVR100000.

**STANDARD NOTE No. 5**  
ACCUMULATED SEDIMENT IN BMPs SHALL BE REMOVED WITHIN SEVEN DAYS AFTER A STORMWATER RUNOFF EVENT OR PRIOR TO THE NEXT ANTICIPATED STORM EVENT WHICHEVER IS EARLIER. SEDIMENT MUST BE REMOVED WHEN BMP DESIGN CAPACITY HAS BEEN REDUCED BY 50 PERCENT OR MORE.

**ADDITIONAL NOTE No. 6**  
PRIOR TO THE START OF CONSTRUCTION, THE CONTRACTOR SHALL HAVE IN PLACE ALL NECESSARY BEST MANAGEMENT PRACTICES THAT SHALL BE USED TO MINIMIZE DUST, PREVENT EROSION, AND PREVENT POLLUTION LADEN RUNOFF FROM ENTERING THE ADJACENT STORM DRAIN FACILITIES. BMPs MAY INCLUDE, BUT NOT BE LIMITED TO, THE FOLLOWING BMPs: (1) SILT FENCING OR STRAW WADDLES AT THE DOWNHILL LIMITS OF GRADING, (2) STABILIZED CONSTRUCTION SITE ENTRY/EXIT, (3) PERMANENT SLOPE REVEGETATION ON ALL DISTURBED AREAS, (4) INLET PROTECTION AT EXISTING CATCH BASINS, (5) STOCKPILE MANAGEMENT BMPs, (6) DUST CONTROL BMPs, (7) AND A CONCRETE WASHOUT AREA. THE CONTRACTOR SHALL MAINTAIN, REPAIR, REPLACE, SUBSTITUTE, OR SUPPLEMENT BMPs AT THE CONSTRUCTION SITE AS CONDITIONS WARRANT DURING CONSTRUCTION.

**ADDITIONAL NOTE No. 7**  
ALL BEST MANAGEMENT PRACTICES (BMPs) SHALL BE IN ACCORDANCE WITH THE "THE TRUCKEE MEADOWS CONSTRUCTION SITE BEST MANAGEMENT PRACTICES HANDBOOK, DATED FEBRUARY 2015".

REV.	DATE	DESCRIPTION	BY	APPD

CITY OF SPARKS  
 VICTORIAN SQUARE INFRASTRUCTURE  
 KEY MAP  
 SPARKS WASHOE COUNTY NEVADA

DESIGNED BY: BB
CHECKED BY: CT
SCALE
HORIZ: 1"=400'
VERT: N/A
JOB NO: 30748
SHEET C0.2 OF 9

Avoid cutting underground utility lines. It's costly. Call before you Dig. 1-800-227-2600 UNDERGROUND SERVICE (USA)

N:\DWG\30748\_VictorianAvePhase2\Civil\CP-PH2\_TITLE.DWG - 11:47 AM \* 05-DEC-2018

REV.	DATE	DESCRIPTION	BY	APPD

**CITY OF SPARKS**  
 VICTORIAN SQUARE INFRASTRUCTURE  
 DEMOLITION PLAN PHASE 2A  
 WASHOE COUNTY SPARKS NEVADA

DESIGNED BY: MF  
 CHECKED BY: CT  
 SCALE  
 HORIZ: 1"=10'  
 VERT: N/A  
 JOB NO: 30748

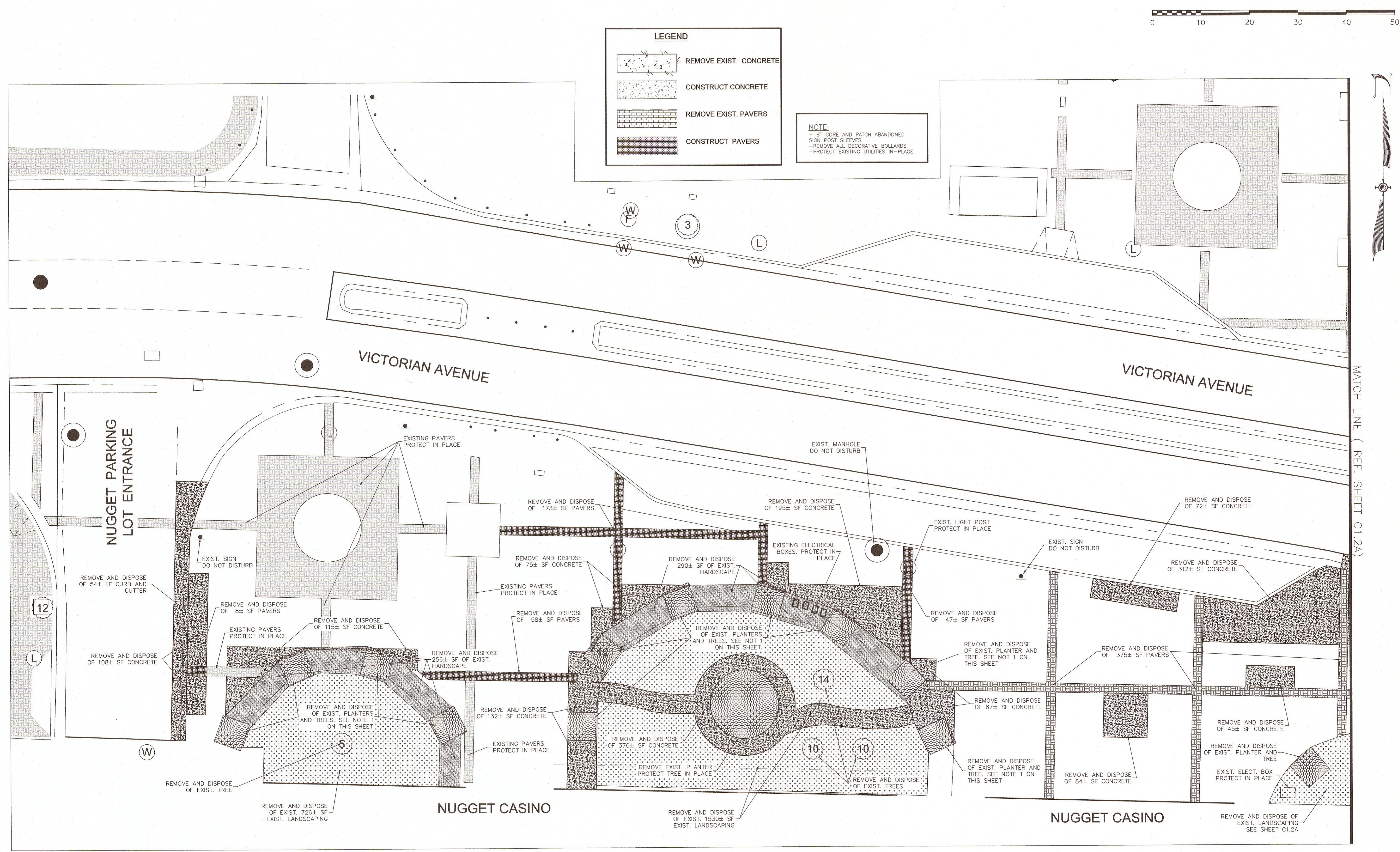
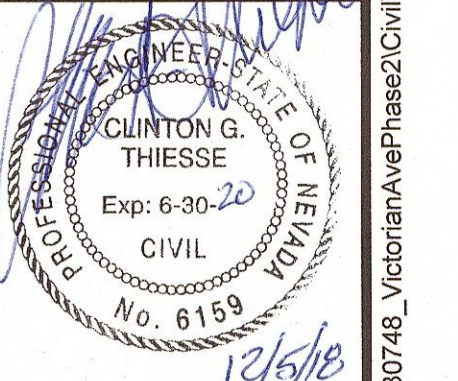

**LEGEND**

- REMOVE EXIST. CONCRETE
- CONSTRUCT CONCRETE
- REMOVE EXIST. PAVERS
- CONSTRUCT PAVERS

**NOTE:**  
 -SF CORE AND PATCH ABANDONED  
 -SIGN POST SLEEVES  
 -REMOVE ALL DECORATIVE BOLLARDS  
 -PROTECT EXISTING UTILITIES IN-PLACE

**NOTE:**  
 1. CONTRACTOR TO VERIFY AND MODIFY EXISTING IRRIGATION LINES AS REQUIRED. CONTRACTOR TO COORDINATE WITH THE CITY OF SPARKS BEFORE STARTING ANY IRRIGATION OR ELECTRICAL LINE MODIFICATIONS. ALL IRRIGATION AND ELECTRICAL WORK WILL BE PAID AS LUMP SUM AS INDICATED UNDER 'MISCELLANEOUS IRRIGATION' AND 'MISCELLANEOUS ELECTRICAL' IN THE BID CLARIFICATION DOCUMENTS.

Avoid cutting underground utility lines. It's costly.  
 before Call you Dig  
 1-800-227-2600  
 UNDERGROUND SERVICE (USA)

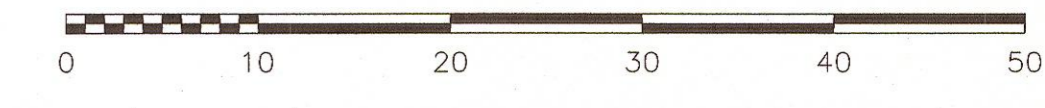

**SUMMIT ENGINEERING CORPORATION**  
 5405 MAE ANNE AVENUE, RENO, NV, 89523  
 PHONE: (775) 747-8550 FAX: (775) 747-8559

Copyright SUMMIT ENG 2018

REV.	DATE	DESCRIPTION	BY	APP'D

**CITY OF SPARKS**  
 VICTORIAN SQUARE INFRASTRUCTURE  
 DEMOLITION PLAN PHASE 2A  
 SPARKS WASHOE COUNTY NEVADA

DESIGNED BY: MF  
 CHECKED BY: CT  
 SCALE  
 HORIZ: 1"=10'  
 VERT: N/A  
 JOB NO: 30748

*(Signature)*  
 CLAYTON G. THIESSE  
 Exp: 6-30-20  
 CIVIL  
 No. 6159  
 12/1/18

SHEET C1.2A OF 9

MATCH LINE ( REF. SHEET C2.1A

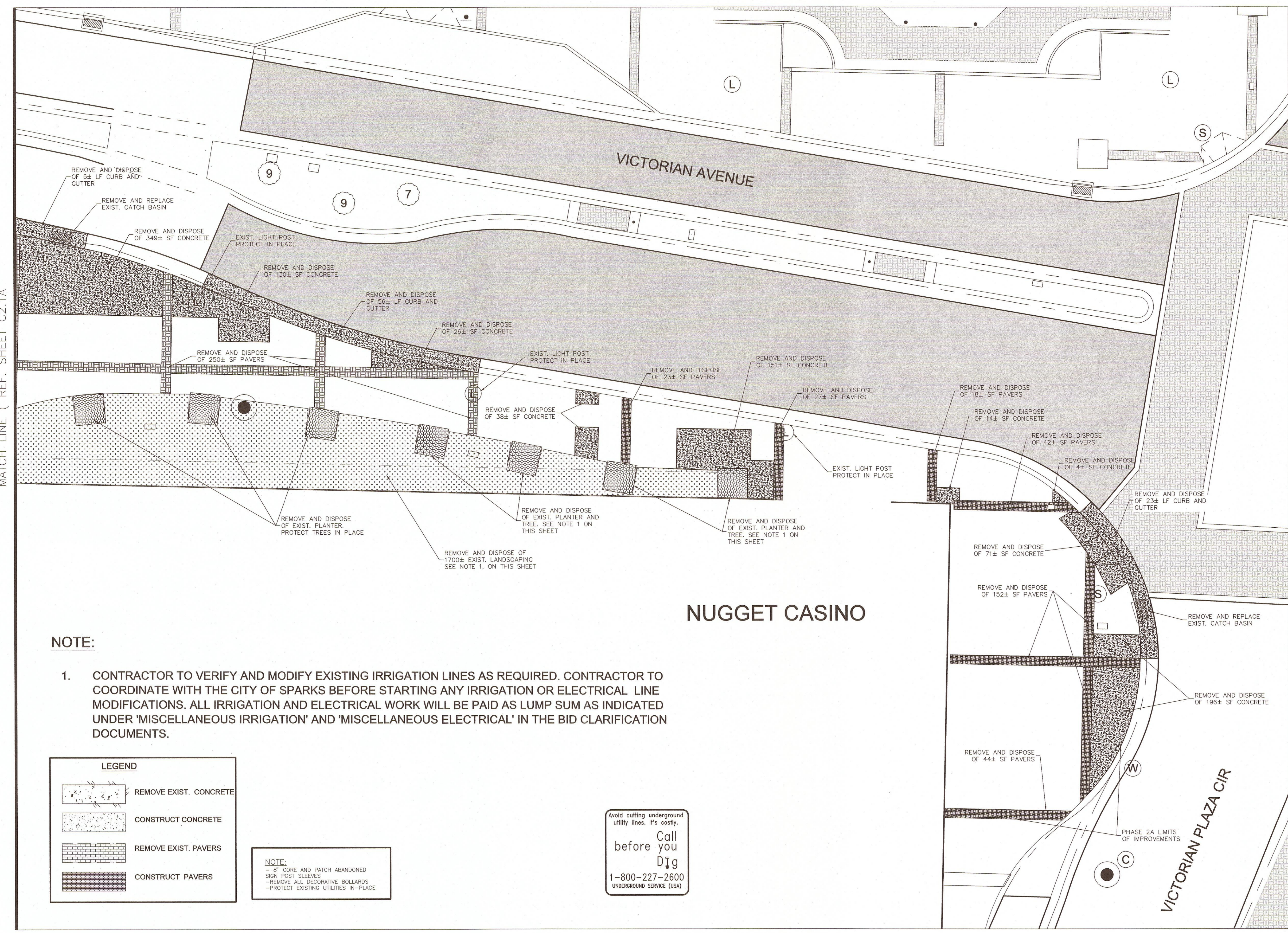

**NOTE:**

- CONTRACTOR TO VERIFY AND MODIFY EXISTING IRRIGATION LINES AS REQUIRED. CONTRACTOR TO COORDINATE WITH THE CITY OF SPARKS BEFORE STARTING ANY IRRIGATION OR ELECTRICAL LINE MODIFICATIONS. ALL IRRIGATION AND ELECTRICAL WORK WILL BE PAID AS LUMP SUM AS INDICATED UNDER 'MISCELLANEOUS IRRIGATION' AND 'MISCELLANEOUS ELECTRICAL' IN THE BID CLARIFICATION DOCUMENTS.

**LEGEND**

	REMOVE EXIST. CONCRETE
	CONSTRUCT CONCRETE
	REMOVE EXIST. PAVERS
	CONSTRUCT PAVERS

**NOTE:**  
 - 5' CORE AND PATCH ABANDONED SIGN POST SLEEVES  
 - REMOVE ALL DECORATIVE BOLLARDS  
 - PROTECT EXISTING UTILITIES IN-PLACE

Avoid cutting underground utility lines. It's costly.  
 Call before you Dig  
 1-800-227-2600  
 UNDERGROUND SERVICE (USA)

N:\DWG\30748\_VictorianAvePhase2\Civil\VC-Phase2\DEM.DWG - 11:53 AM - 05-DEC-2018

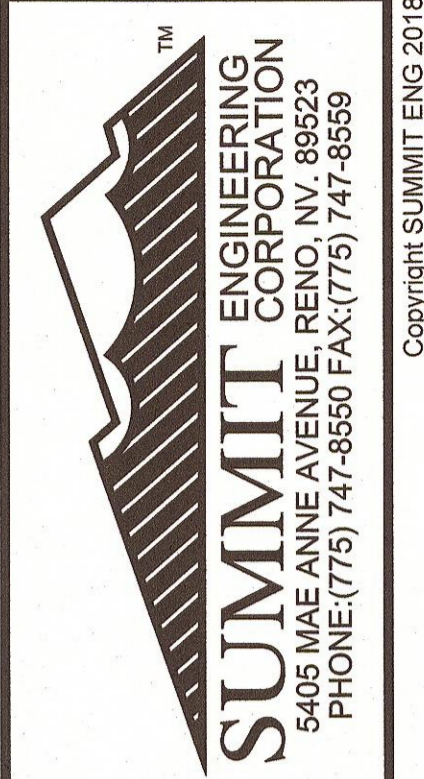
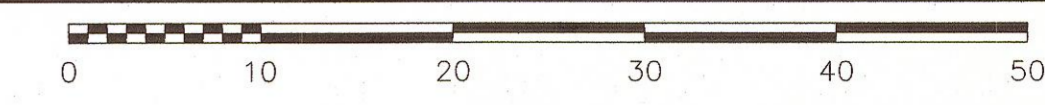

Copyright SUMMIT ENG 2018

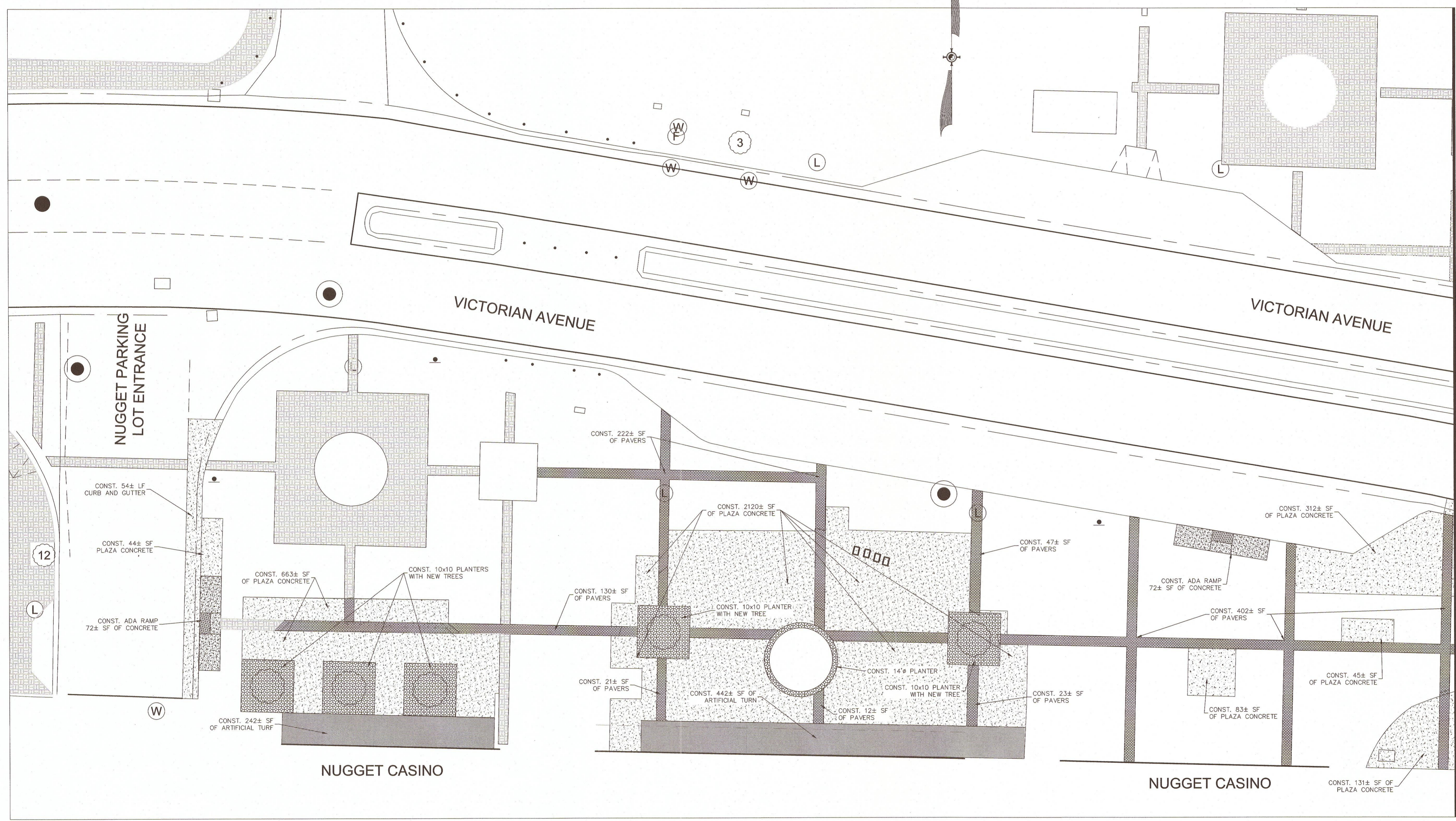

MATCH LINE ( REF. SHEET C2-2A)

REV.	DATE	DESCRIPTION	BY	APPD

**CITY OF SPARKS**  
**VICTORIAN SQUARE INFRASTRUCTURE**  
**SITE AND GRADING PLAN PH 2A**  
 SPARKS WASHOE COUNTY NEVADA

DESIGNED BY: MF  
 CHECKED BY: CT  
 SCALE  
 HORIZ: 1"=10'  
 VERT: N/A  
 JOB NO: 30748

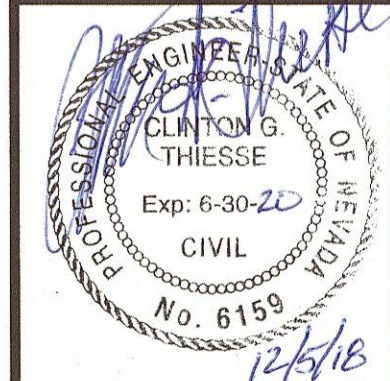

SHEET C2.1A OF 9

**LEGEND**

	REMOVE EXIST. CONCRETE
	CONSTRUCT CONCRETE
	REMOVE EXIST. PAVERS
	CONSTRUCT PAVERS

**NOTE:**  
 - 8" CORE AND PATCH ABANDONED  
 - SIGN POST SLEEVES  
 - REMOVE ALL DECORATIVE BOLLARDS  
 - PROTECT EXISTING UTILITIES IN-PLACE

Avoid cutting underground utility lines. It's costly.  
 before Call you Dig  
 1-800-227-2600  
 UNDERGROUND SERVICE (USA)

N:\DWGS\30748\_VictorianAve\Phase2\Civil\CP-PH2\_SITE.DWG - 11:55 AM \* 05-DEC-2018

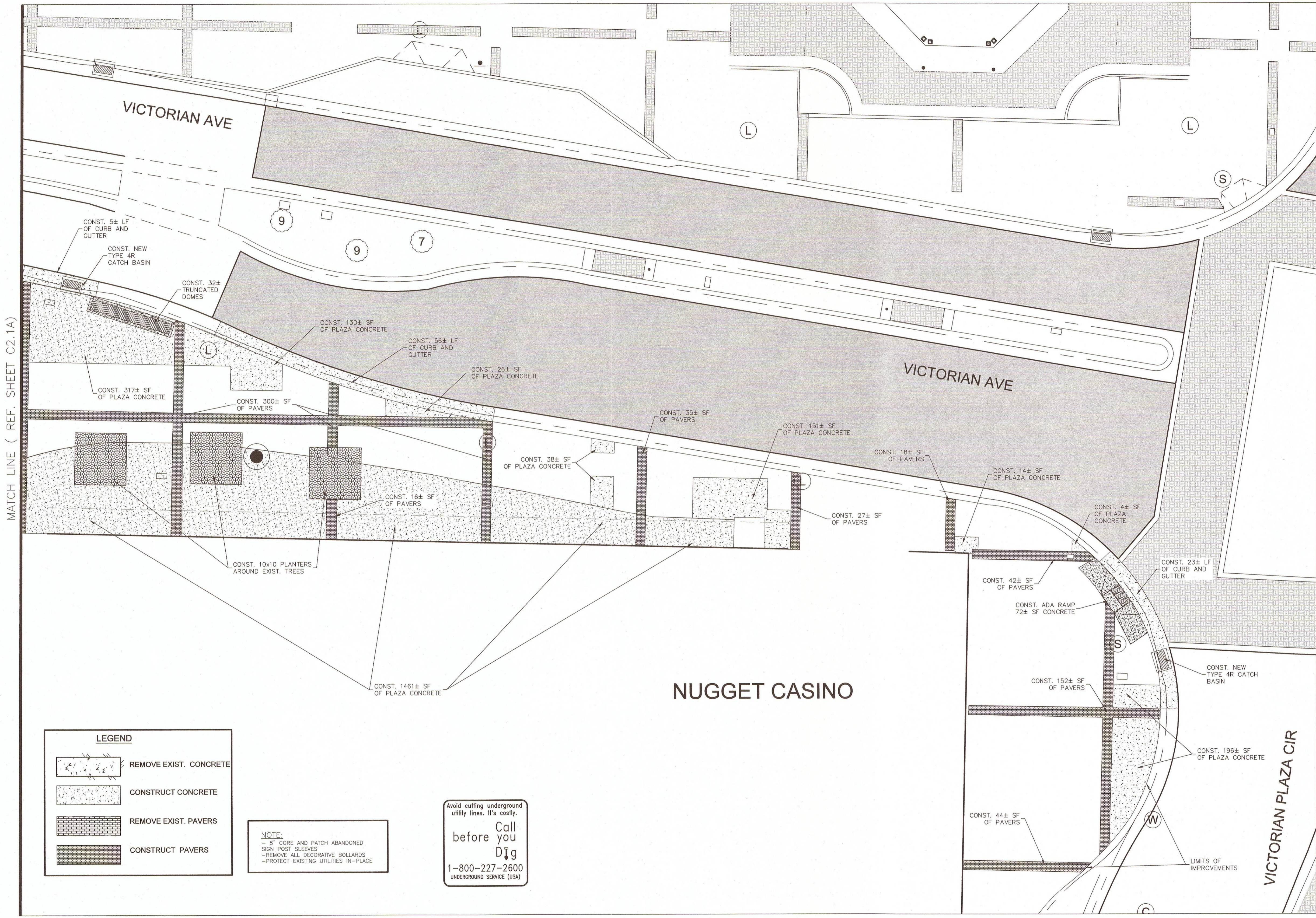
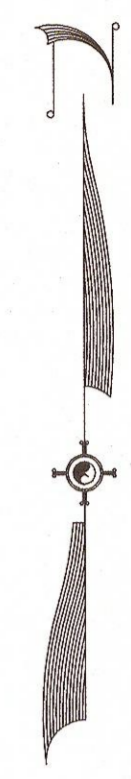

MATCH LINE ( REF. SHEET C2.1A)

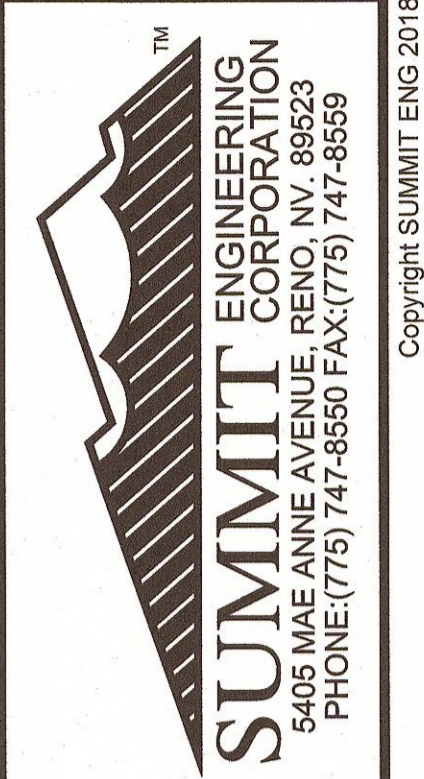

REV.	DATE	DESCRIPTION	BY	APP'D

**CITY OF SPARKS**  
**VICTORIAN SQUARE INFRASTRUCTURE**  
**SITE AND GRADING PLAN PH 2A**  
 SPARKS WASHOE COUNTY NEVADA

DESIGNED BY: MF  
 CHECKED BY: CT  
 SCALE  
 HORIZ: 1"=10'  
 VERT: N/A  
 JOB NO: 30748

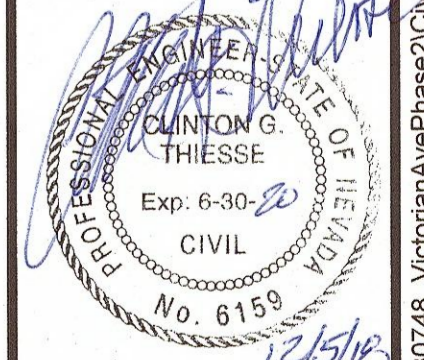

SHEET C2.2A OF 9

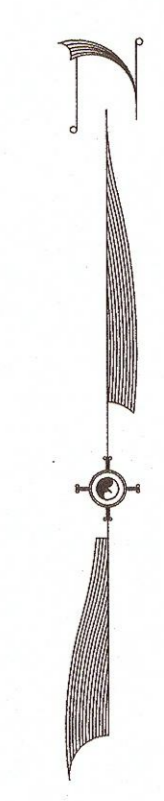

# FENCE INSTALLATION PLAN

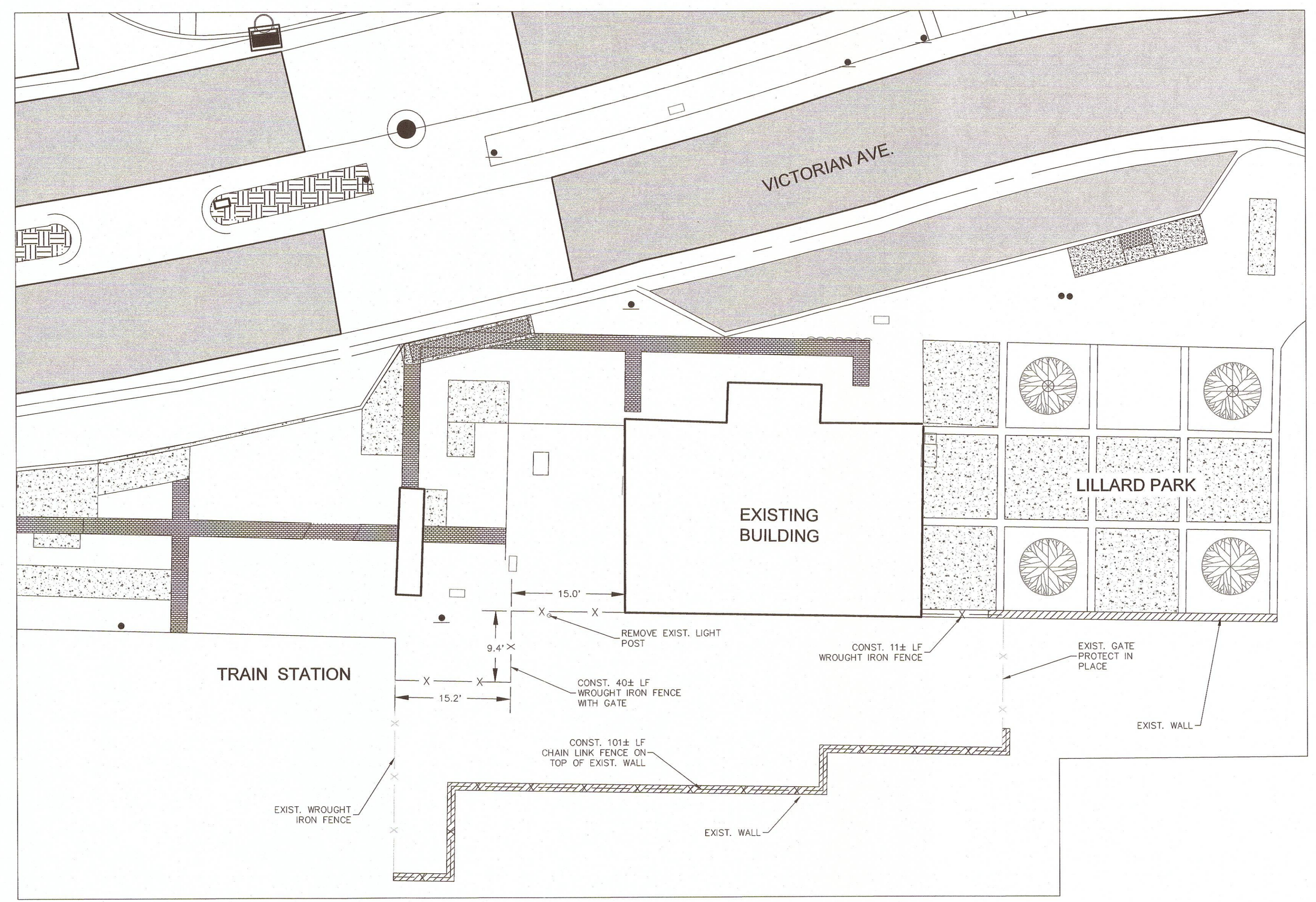

LEGEND	
	REMOVE EXIST. CONCRETE
	CONSTRUCT CONCRETE
	REMOVE EXIST. PAVERS
	CONSTRUCT PAVERS

**NOTE:**  
 - 8" CORE AND PATCH ABANDONED SIGN POST SLEEVES  
 - REMOVE ALL DECORATIVE BOLLARDS  
 - PROTECT EXISTING UTILITIES IN-PLACE

Avoid cutting underground utility lines. It's costly.  
 Call before you Dig  
 1-800-227-2600  
 UNDERGROUND SERVICE (USA)

REV.	DATE	DESCRIPTION	BY	APPD

**CITY OF SPARKS**  
**VICTORIAN SQUARE INFRASTRUCTURE**  
**FENCE INSTALLATION PLAN**  
 SPARKS WASHOE COUNTY NEVADA

DESIGNED BY: MF  
 CHECKED BY: CT  
 SCALE  
 HORIZ: 1"=10'  
 VERT: N/A  
 JOB NO: 30748

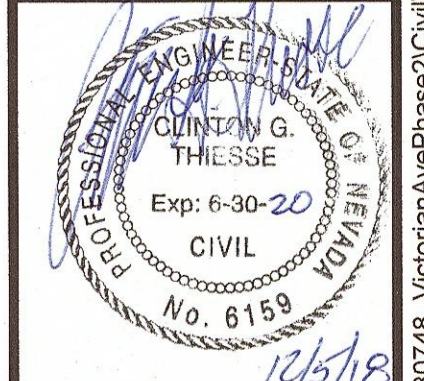

SHEET OF  
**C2.3A** OF **9**

**SUMMIT ENGINEERING CORPORATION**  
 5405 MAE ANNE AVENUE, RENO, NV. 89523  
 PHONE: (775) 747-8550 FAX: (775) 747-8559

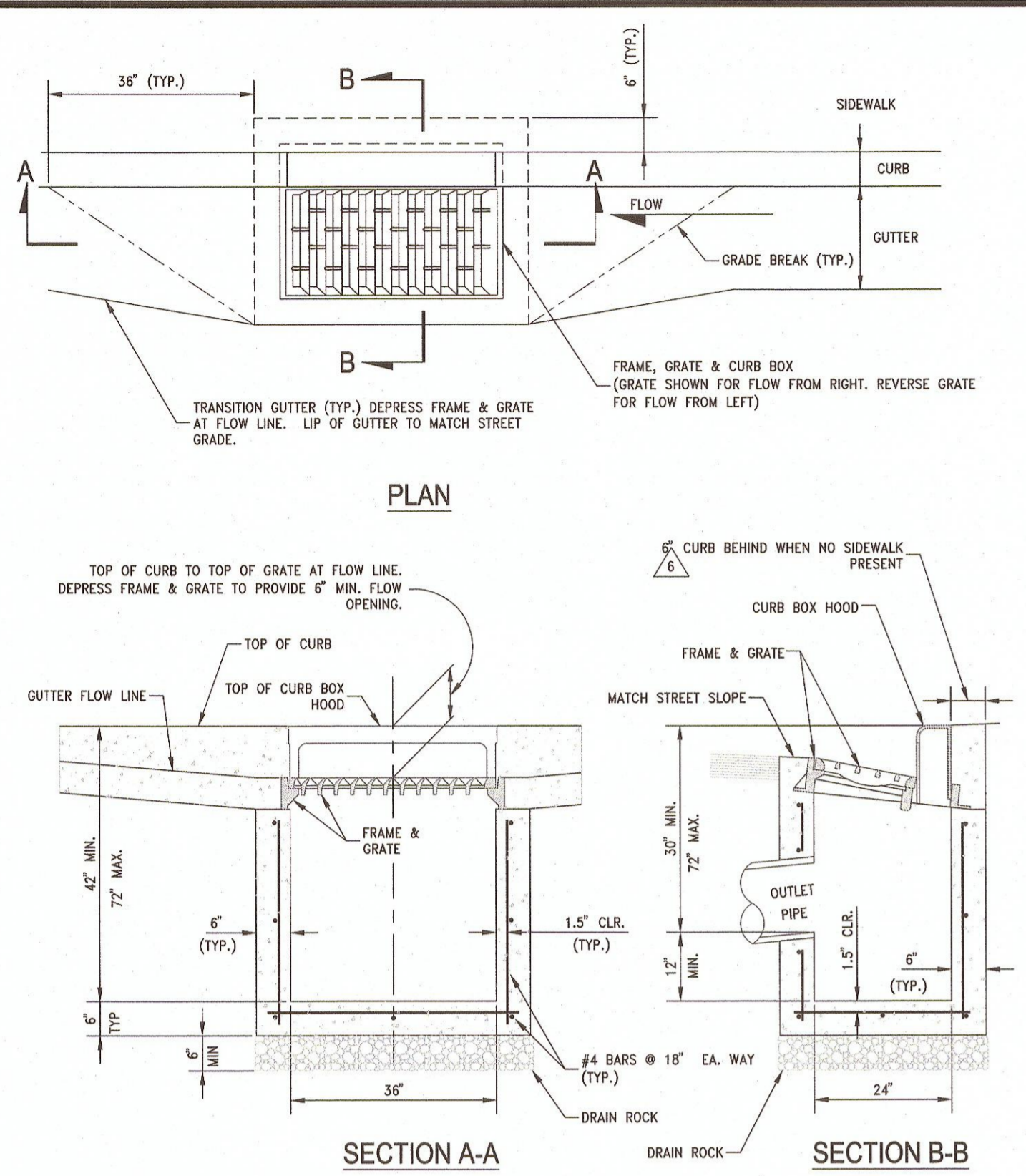

**TYPE 4R CATCH BASIN**  
N.T.S.

- NOTES:**
- P.C.C. CURB AND GUTTER TRANSITION SHALL BE FIBER-REINFORCED PORTLAND CEMENT CONCRETE (P.C.C.) AND SHALL HAVE THE FOLLOWING CHARACTERISTICS: 4000 PSI MIN. COMPRESSIVE STRENGTH AT 28 DAYS, MIN. 6 SACKS OF CEMENT PER CUBIC YARD WITH MAX. WATER-CEMENT RATIO OF 0.45, AIR ENTRAINMENT 6% ± 1.5%, SLUMP AT 1 TO 4 INCHES. MIX DESIGN SHALL CONFORM TO THE REQUIREMENTS OF SECTION 337 OF STANDARD SPECIFICATIONS OF PUBLIC WORKS CONSTRUCTION (SSPWC). CEMENT SHALL BE TYPE II. ALL CEMENT CONCRETE SHALL HAVE A COARSE AGGREGATE GRADATION CONFORMING TO SIZE NO. 57. POLYPROPYLENE OR CELLULOSE FIBERS SHALL BE ADDED TO THE P.C.C. AT 1.5 LBS. PER CUBIC YARD. ALL MATERIALS SHALL CONFORM TO SSPWC.
  - REINFORCING STEEL SHALL BE GRADE 40 AND HAVE 1.5" MINIMUM CLEAR COVER.
  - CONCRETE STRUCTURE MAY BE A PRE-CAST CONCRETE UNIT UPON APPROVAL OF THE CITY ENGINEER. BASE OF PRE-CAST CONCRETE UNIT SHALL BE PLACED ON 6" COMPACTED DRAIN ROCK.
  - FRAME, GRATE AND CURB BOX HOOD ASSEMBLY SHALL BE D&L I-3519 WITH TYPE L "VANE GRATE" OR APPROVED EQUAL. GRATE SHALL BE INSTALLED WITH PROPER FLOW DIRECTION. EACH CATCH BASIN SHALL BE CAST WITH A FISH IMAGE AND THE WORDS "NO DUMPING" DRAINS TO WATERWAYS" IN THE TOP OF EACH CURB HOOD.
  - SLIP FRAME & GRATE AS REQUIRED TO ATTAIN 6" MIN. FLOW OPENING & INSTALL DURABLE SHIMS BETWEEN THE CURB BOX & FRAME AS REQUIRED TO MATCH CURB BOX TO TOP OF CURB AND FACE OF CURB (SEE SECTION B-B).
  - WHEN SIDEWALK IS PRESENT CONCRETE BEHIND CURB BOX SHALL BE THICKENED TO THE FULL DEPTH OF THE CURB BOX. IF NO SIDEWALK IS PRESENT, POUR 6" CONCRETE CURB STRUCTURE BEHIND GRATE AND THE BEAM INTO BOX.
  - ALL CATCH BASINS, PUBLIC OR PRIVATE, SHALL BE PROVIDED WITH A "SUR-TRAP" OIL/WATER SEPARATOR OR APPROVED EQUAL.
  - FRAMES AND GRATES SHALL BE MATCHED TO ACHIEVE A CLOSE TOLERANCE FIT WITH MINIMAL GAPS.
  - CATCH BASIN SHALL NOT BE PLACED WITHIN THE RADIUS OF THE CURB.

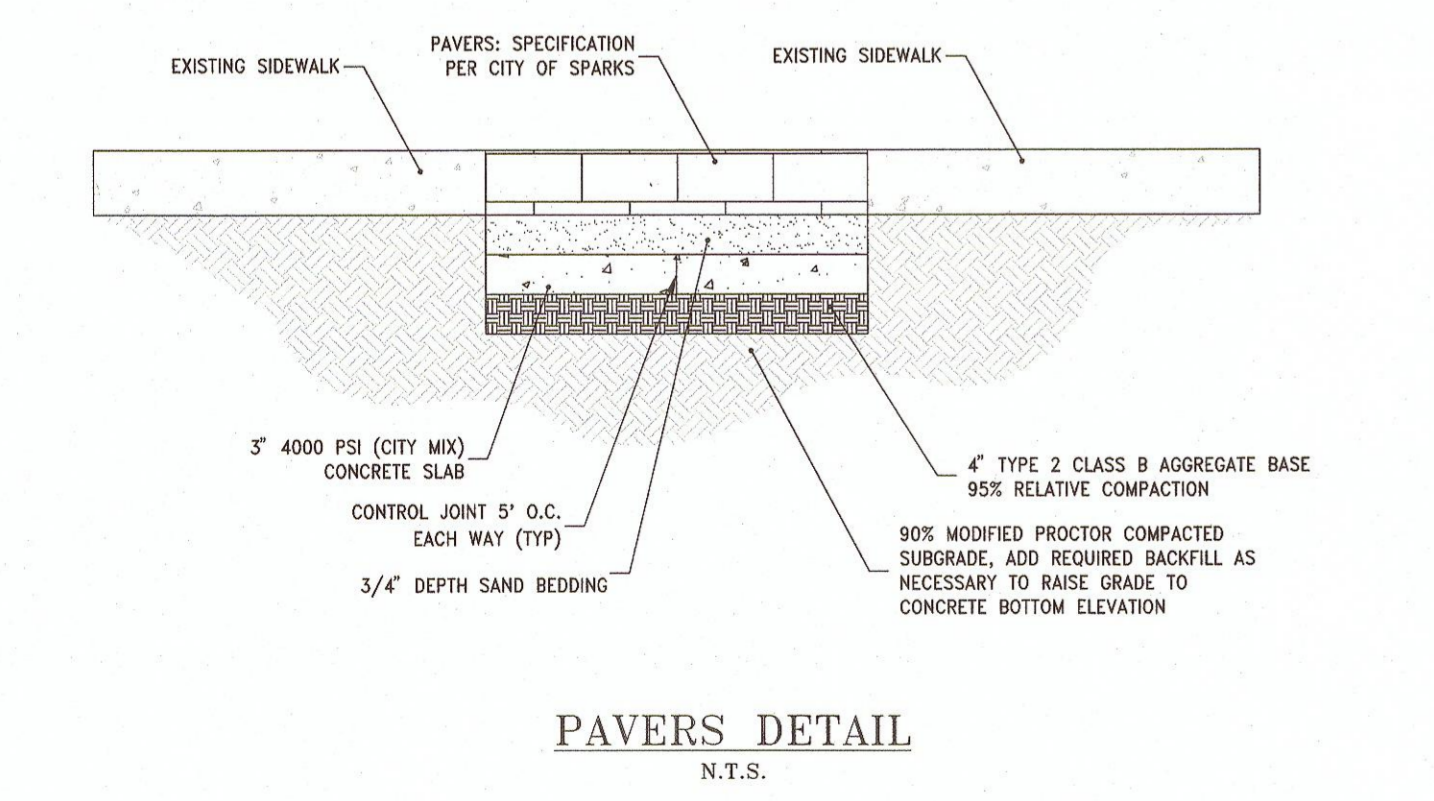

**PAVERS DETAIL**  
N.T.S.

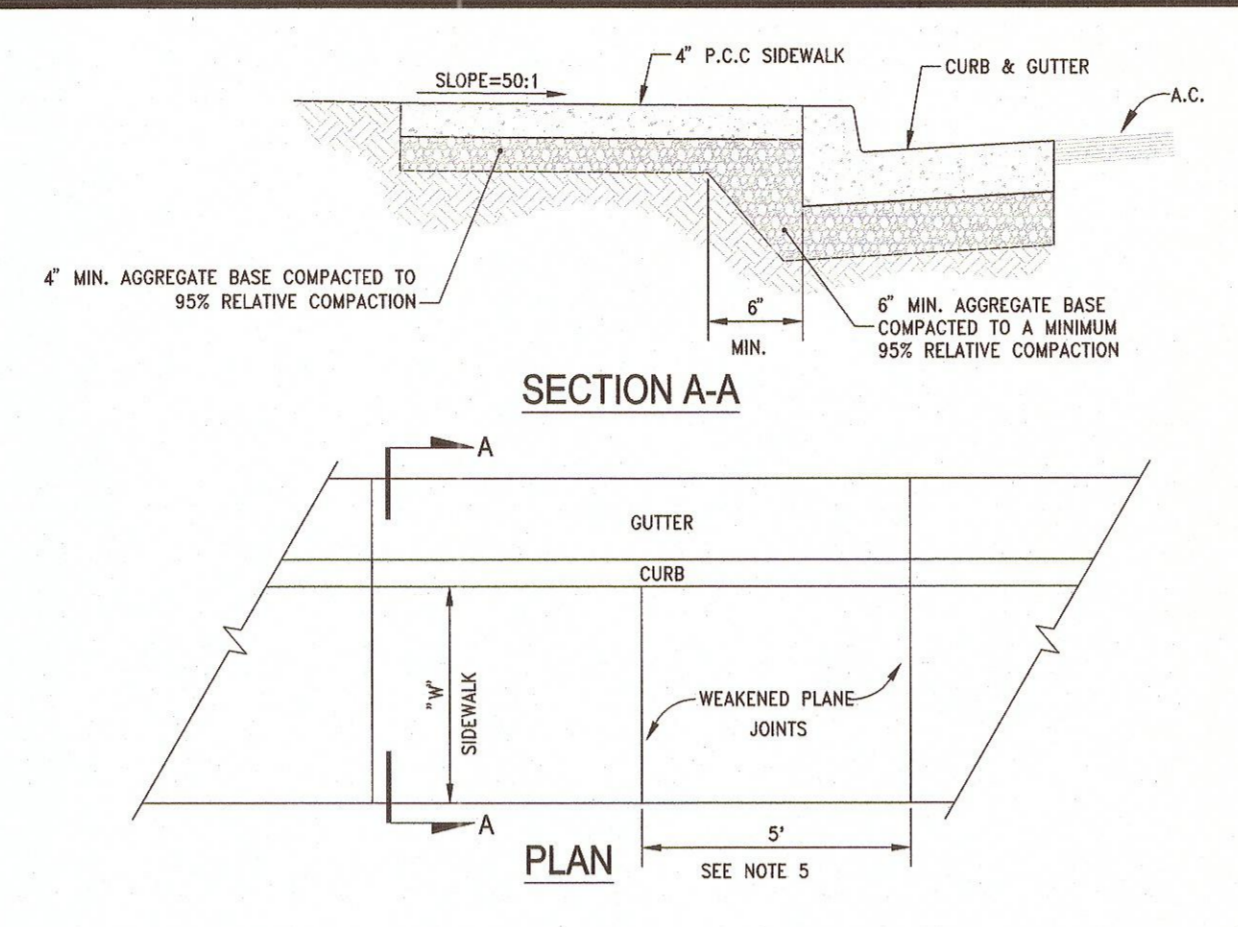

**TYPICAL P.C.C. SIDEWALK SECTION**  
N.T.S.

- NOTES:**
- FIBER-REINFORCED PORTLAND CEMENT CONCRETE (P.C.C.) SHALL HAVE THE FOLLOWING CHARACTERISTICS: 4000 PSI MIN. COMPRESSIVE STRENGTH AT 28 DAYS, MIN. 6 SACKS OF CEMENT PER CUBIC YARD WITH MAX. WATER-CEMENT RATIO OF 0.45, AIR ENTRAINMENT 6% ± 1.5%, SLUMP AT 1 TO 4 INCHES. MIX DESIGN SHALL CONFORM TO THE REQUIREMENTS OF SECTION 337 OF STANDARD SPECIFICATIONS OF PUBLIC WORKS CONSTRUCTION (SSPWC). CEMENT SHALL BE TYPE II. ALL CEMENT CONCRETE SHALL HAVE A COARSE AGGREGATE GRADATION CONFORMING TO SIZE NO. 57. POLYPROPYLENE OR CELLULOSE FIBERS SHALL BE ADDED TO THE P.C.C. AT 1.5 LBS. PER CUBIC YARD. ALL MATERIALS SHALL CONFORM TO SSPWC.
  - AGGREGATE BASE MATERIAL UNDER SIDEWALKS SHALL BE TYPE 2, CLASS B CRUSHED AGGREGATE BASE. MATERIALS SHALL CONFORM TO SSPWC SECTION 200.
  - SIDEWALK WIDTH "W" SHALL BE 4 FT. MIN. ON RESIDENTIAL STREETS AND 6 FT. MIN. ON COLLECTOR AND ARTERIAL STREETS.
  - WEAKENED PLANE JOINTS SHALL BE CONSTRUCTED AT 5 FT INTERVALS AND ACCORDANCE WITH SECTION 312 OF THE SSPWC.
  - ALL ADJACENT CONCRETE REMOVAL SHALL BE TO NEAT SAW CUT LINES AT RIGHT ANGLES TO NEW SIDEWALK. DOWEL INTO EXISTING ADJACENT CONCRETE SIDEWALK WITH A MINIMUM OF TWO (2) NO. 4 REINFORCEMENT BARS EQUALLY SPACED ACROSS WIDTH "W". DOWELS SHALL PENETRATE A MINIMUM OF 4" INTO EXISTING CONCRETE.
  - SIDEWALKS SHALL NOT BE POURED MONOLITHICALLY WITH CURBS.
  - COLORS CONCRETE AND PAVERS ARE NOT ALLOWED.
  - TUNNELING AND/OR BORING IS NOT ALLOWED.

- NOTES:**
- AN EXCAVATION/ENCROACHMENT PERMIT MUST BE OBTAINED FROM CITY OF RENO PRIOR TO CUTTING ANY PUBLIC RIGHT-OF-WAY.
  - IF SAW CUT IS WITHIN 2 FEET OF AN EXISTING PAVEMENT EDGE OR EXISTING PAVEMENT PATCH, REMOVE EXISTING PAVEMENT TO THAT EDGE AND REPLACE ENTIRE SECTION.
  - ALL PERMANENT PATCH REPLACEMENT REQUIREMENTS ARE MINIMUM WIDTHS ONLY AND INCLUDES ALL AREAS WHERE THE ASPHALT PAVEMENT HAS BEEN UNDERMINED. THE CITY ENGINEER MAY REQUIRE WIDER PATCH SECTIONS OR OTHERWISE ALTER THESE REQUIREMENTS.
  - AGGREGATE BASE MATERIAL UNDER BITUMINOUS PAVEMENT PATCH SHALL BE TYPE 2, CLASS B CRUSHED AGGREGATE BASE. MATERIALS SHALL CONFORM TO SSPWC SECTION 200.
  - CONTRACTOR SHALL BE RESPONSIBLE FOR REPLACEMENT OF LOOP DETECTORS, ADJUSTMENT OF UTILITIES AND SURVEY MONUMENTS TO GRADE AND INSTALLATION OF PERMANENT PAVEMENT MARKINGS.
  - FOR P.C.C. CURB REPLACEMENT, SAW CUT EXISTING PAVEMENT 18 INCHES MIN. FROM GUTTER LIP LINE, REMOVE AND REPLACE PAVEMENT TO SAW CUT EDGES. CONCRETE MAY BE POURED NEAT AGAINST EXISTING EDGE OF ASPHALT IF APPROVED BY CITY ENGINEER.

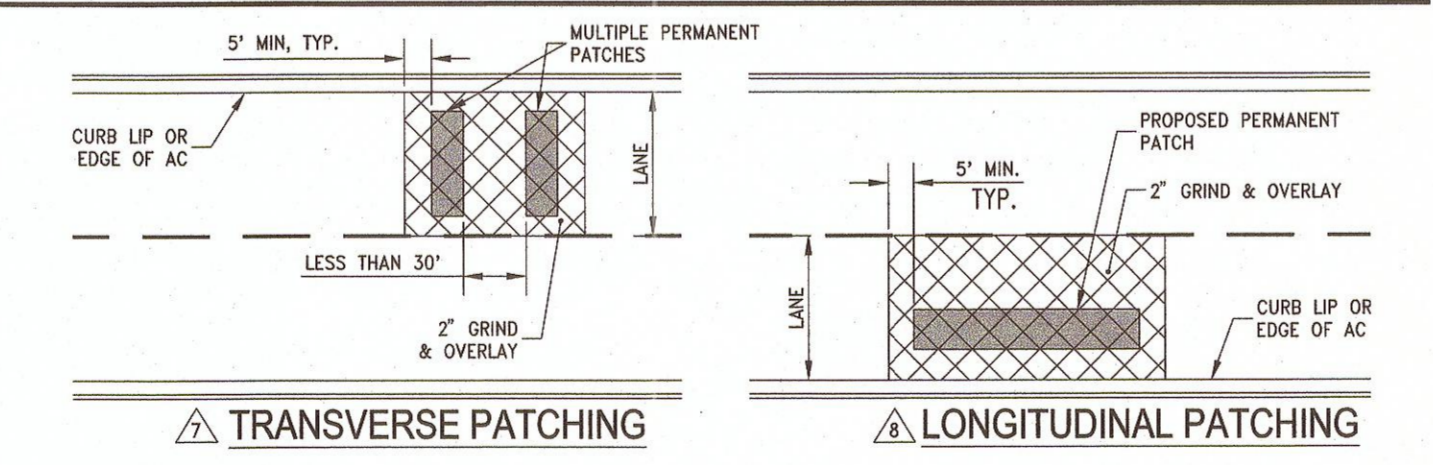

**TYPICAL PERMANENT PAVEMENT PATCH**  
N.T.S.

- ALL STREETS WITH PAVEMENT CONDITION INDEX (PCI) GREATER THAN 65:
- TRANSVERSE PATCHES SHALL INCLUDE A 2" GRIND AND OVERLAY WHEREVER THERE ARE MULTIPLE PATCHES WITHIN 30 FEET OF EACH OTHER.
  - LONGITUDINAL PATCHES SHALL INCLUDE 2" GRIND AND OVERLAY TO THE LANE LINES (BIKE, PARKING, OR TRAVEL).

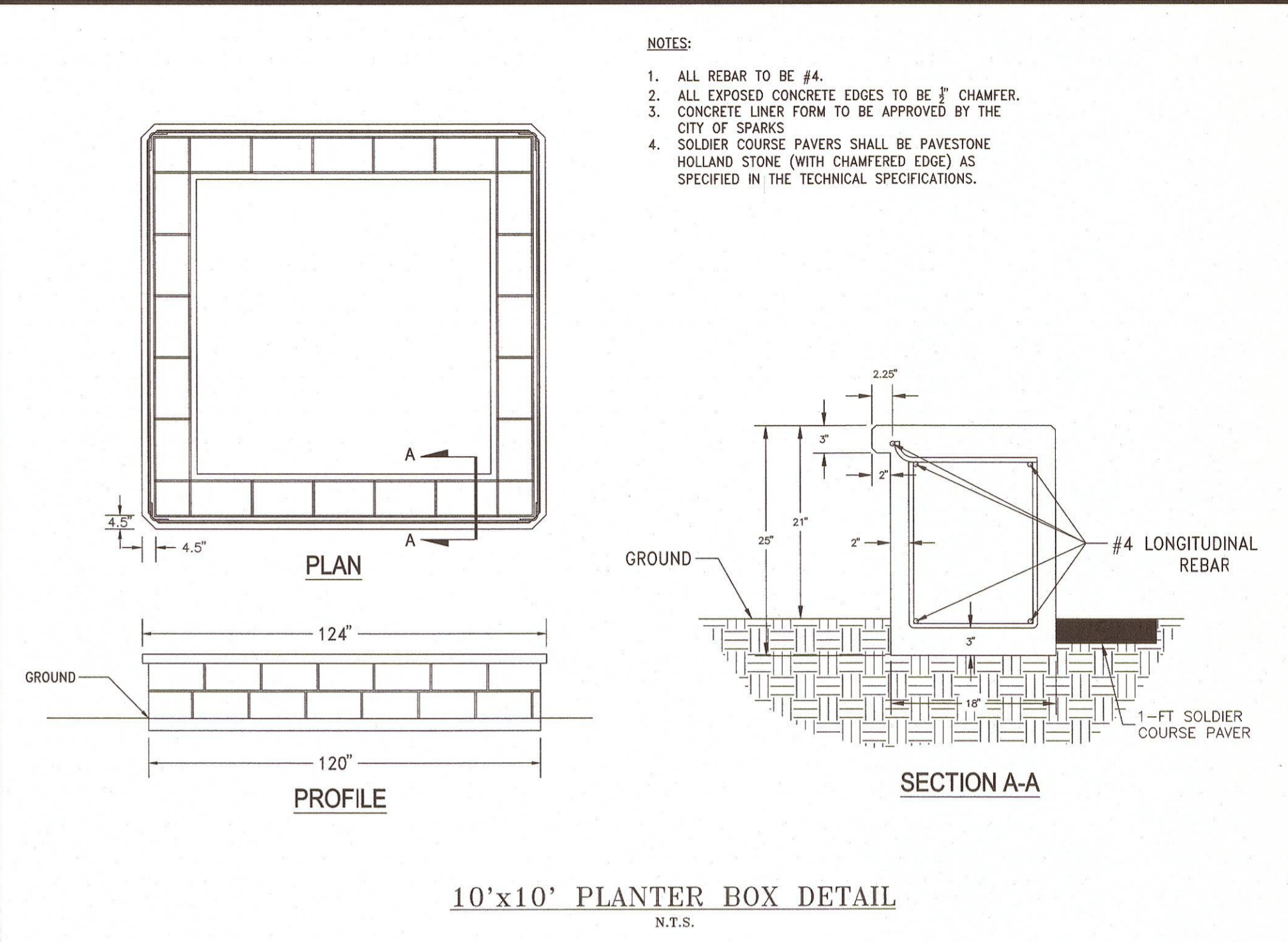

**10'x10' PLANTER BOX DETAIL**  
N.T.S.

- NOTES:**
- ALL REBAR TO BE #4.
  - ALL EXPOSED CONCRETE EDGES TO BE 3" CHAMFER.
  - CONCRETE LINER FORM TO BE APPROVED BY THE CITY OF SPARKS.
  - SOLDIER COURSE PAVERS SHALL BE PAVESTONE HOLLAND STONE (WITH CHAMFERED EDGE) AS SPECIFIED IN THE TECHNICAL SPECIFICATIONS.

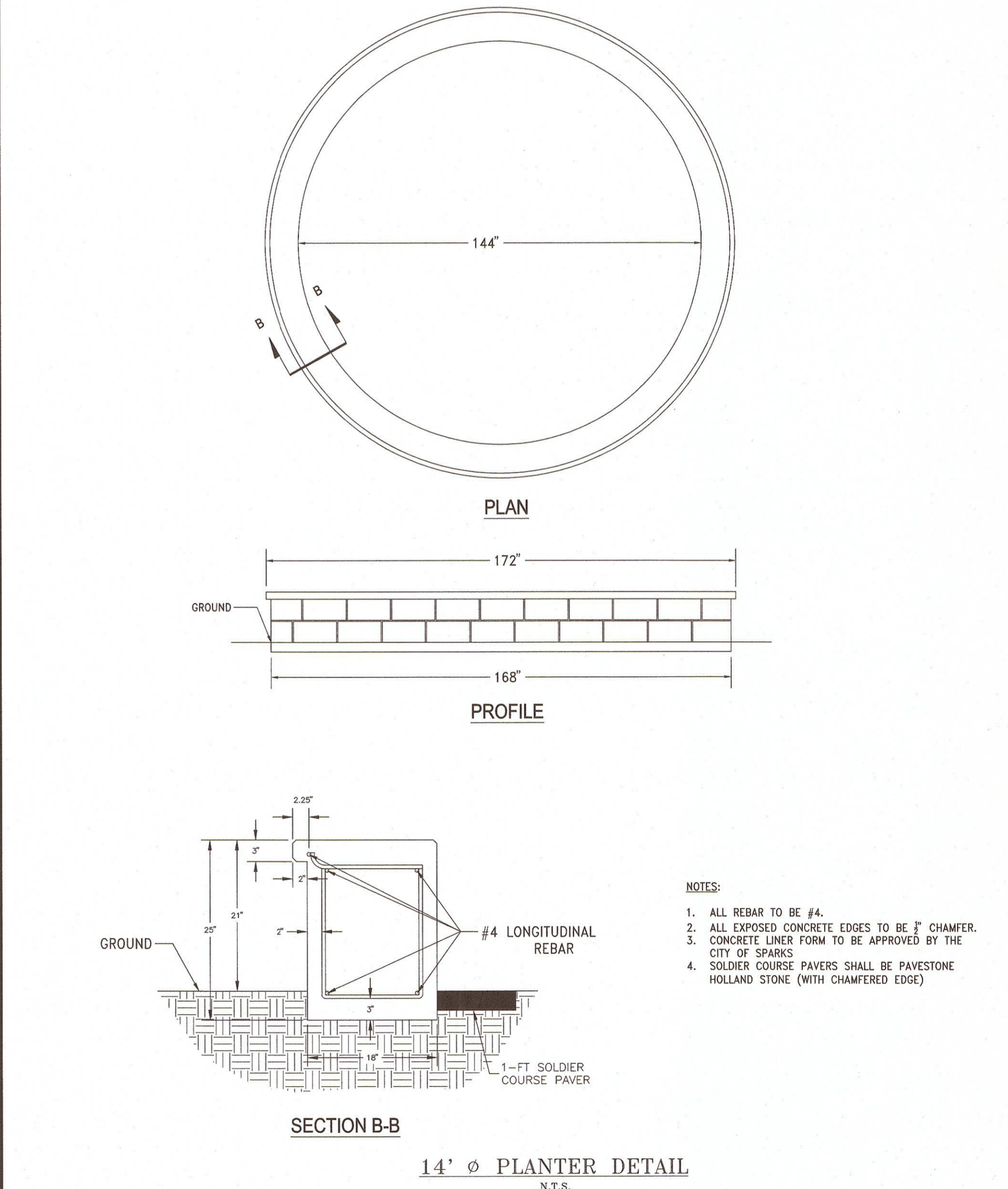

**14' Ø PLANTER DETAIL**  
N.T.S.

- NOTES:**
- ALL REBAR TO BE #4.
  - ALL EXPOSED CONCRETE EDGES TO BE 3" CHAMFER.
  - CONCRETE LINER FORM TO BE APPROVED BY THE CITY OF SPARKS.
  - SOLDIER COURSE PAVERS SHALL BE PAVESTONE HOLLAND STONE (WITH CHAMFERED EDGE)

**SUMMIT ENGINEERING CORPORATION**  
5405 MAE ANNE AVENUE, RENO, NV, 89523  
PHONE: (775) 747-8550 FAX: (775) 747-8559

REV.	DATE	DESCRIPTION	BY	APP'D

CITY OF SPARKS  
VICTORIAN SQUARE INFRASTRUCTURE  
PHASE 2 DETAIL SHEET  
SPARKS WASHOE COUNTY NEVADA

DESIGNED BY: BB  
CHECKED BY: CT  
SCALE: HORIZ: N/A VERT: N/A  
JOB NO: 38748  
SHEET C3.1 OF 9

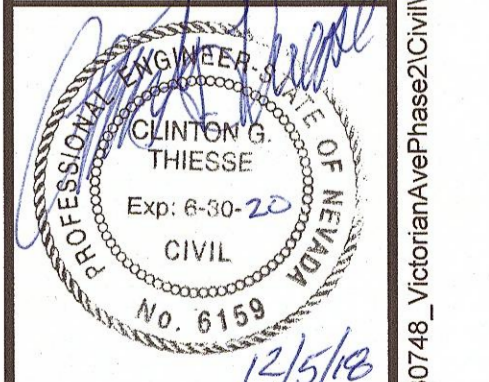



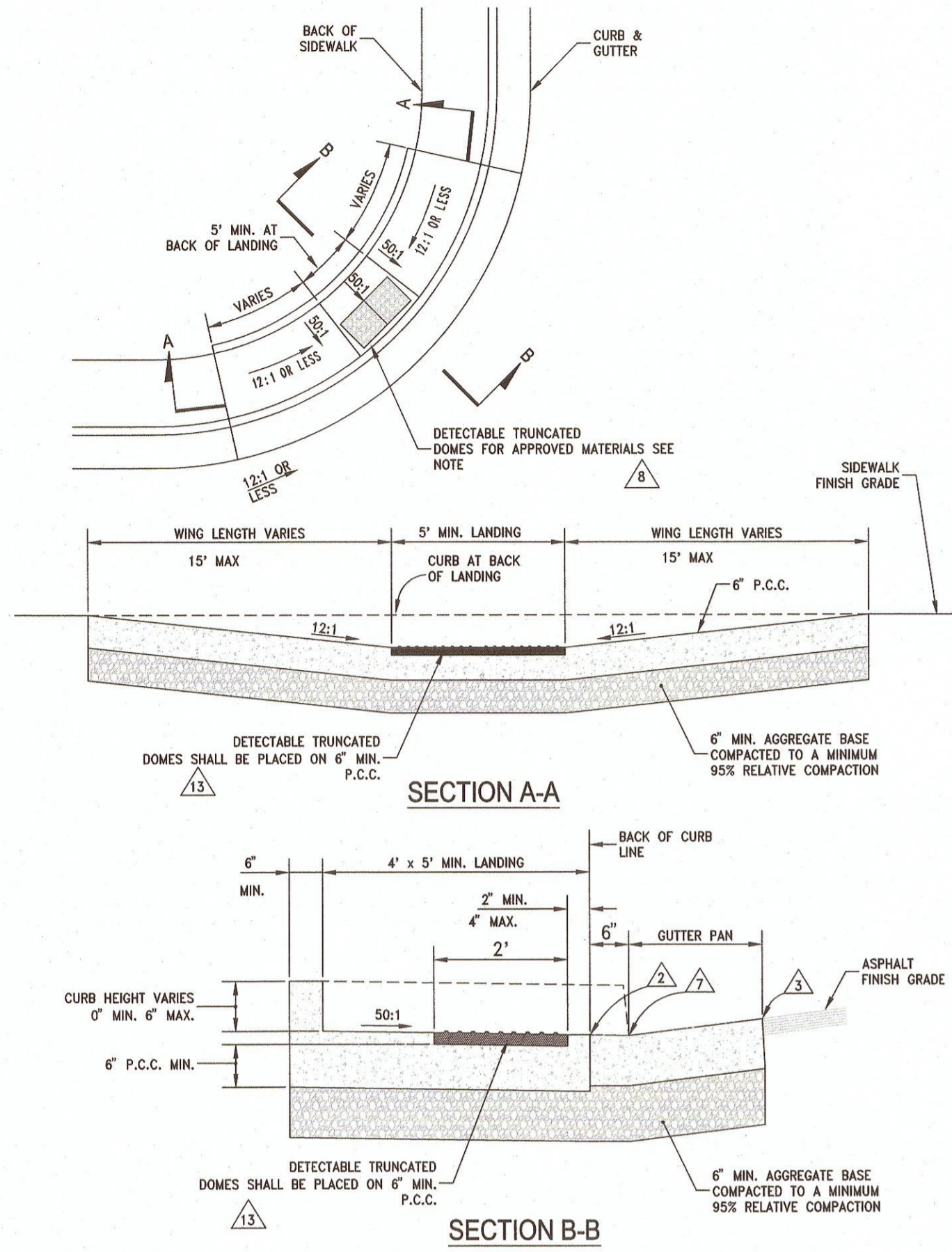

**PEDESTRIAN RAMPS TYPE 1:  
EXISTING SIDEWALKS**  
N.T.S.

DATE: 1/2013

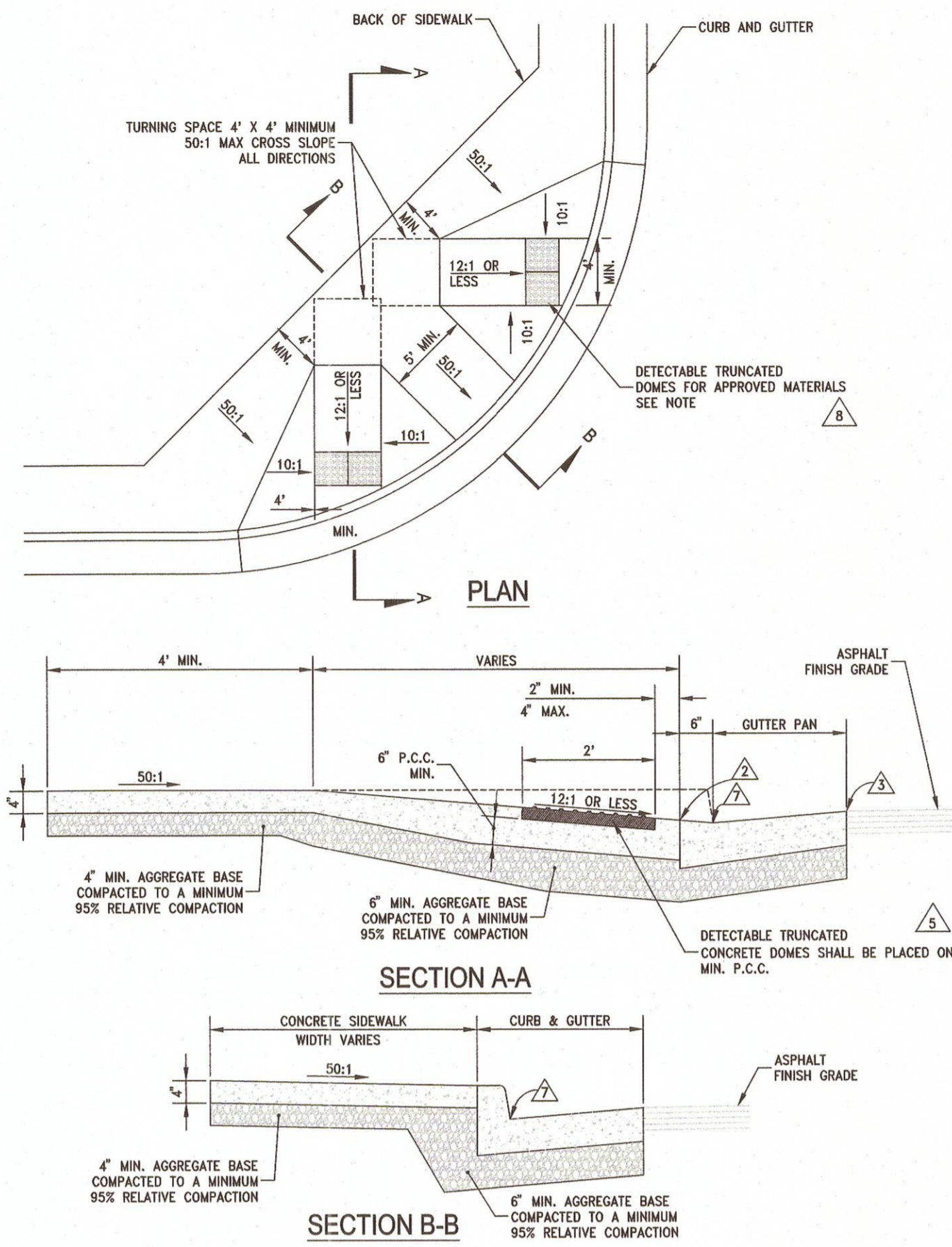

**PEDESTRIAN RAMP TYPE 2:  
NARROW AND  
OFFSET SIDEWALKS**  
N.T.S.

DATE: 1/2013

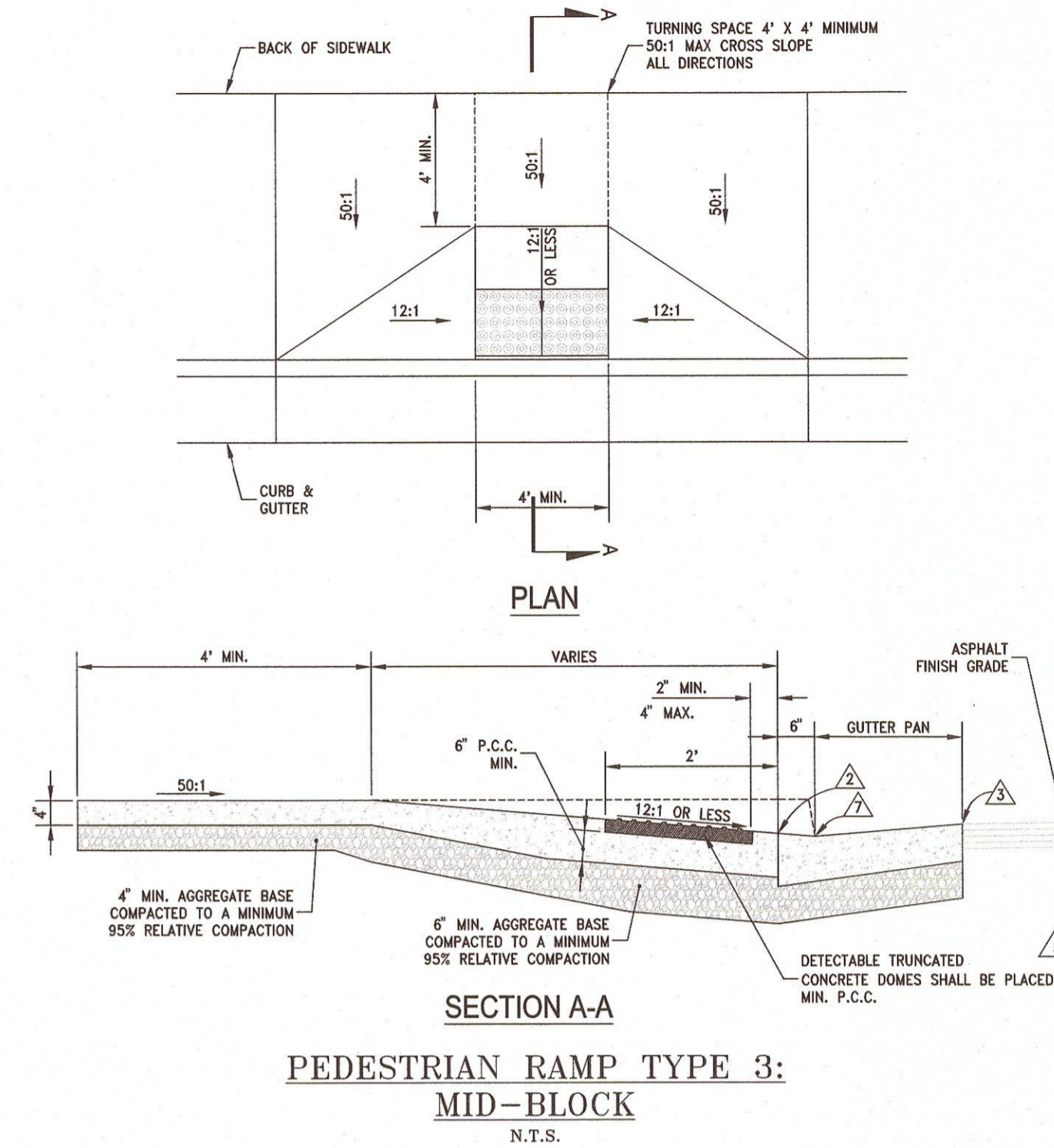

**PEDESTRIAN RAMP TYPE 3:  
MID-BLOCK**  
N.T.S.

DATE: 1/2013

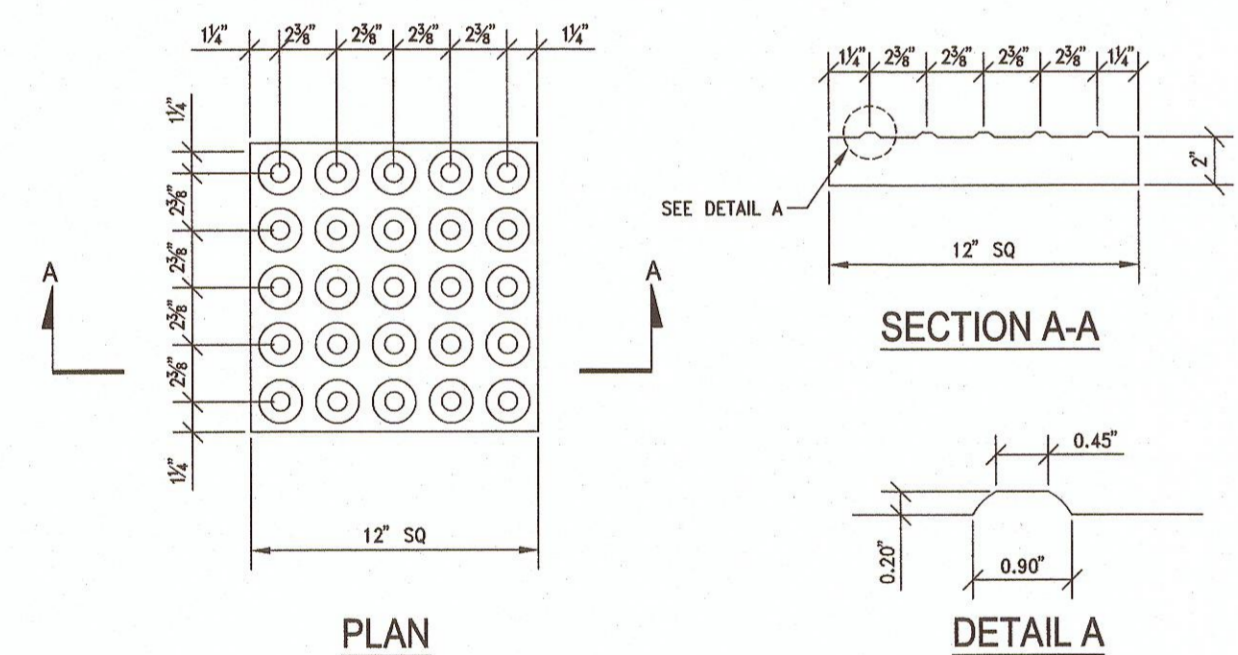

**TYPICAL TRUNCATED  
DOMES DETAIL**  
N.T.S.

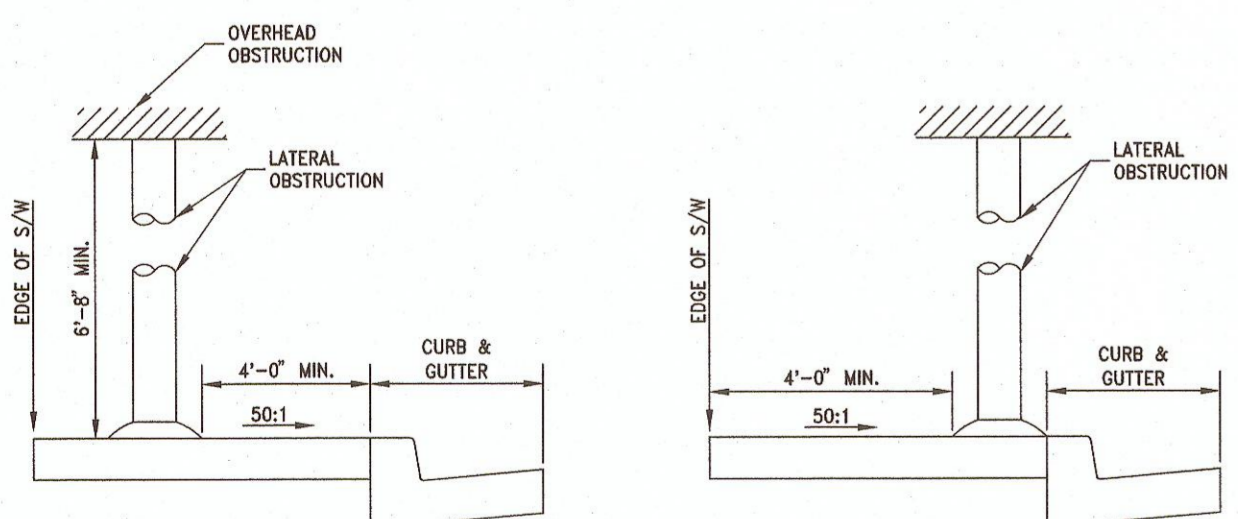

**TYPICAL SIDEWALK vs  
OBSTRUCTION CLEARANCE DETAIL**  
N.T.S.

DATE: 1/2013

1. STORM DRAIN INLETS OR SIMILAR ACCESSES SHALL NOT BE LOCATED IN THE AREA AT THE BASE OF THE CURB RAMP OR LANDING AREA. IF OBSTRUCTIONS SUCH AS INLETS, UTILITY POLES, PULL BOXES, FIRE HYDRANTS, ETC. ARE ENCOUNTERED, THE LOCATION AND DIMENSIONS MAY BE ADJUSTED UPON APPROVAL OF THE ENGINEER.
2. NO LIP SHALL BE PERMITTED AT THE CURB RAMP SLOPE TO GUTTER PAN.
3. PLANTMIX BITUMINOUS SURFACE SHALL BE FLUSH WITH THE EDGE OF THE GUTTER PAN IN THE AREA OF THE CURB RAMP.
4. ROUGH BROOM TEXTURE ON CURB RAMPS AND WINGS.
5. DETECTABLE WARNING SHALL BE INSTALLED PER MANUFACTURER'S RECOMMENDATIONS AND SHALL BE PLACED ON MIN. SIX (6") INCHES OF P.C.C.
6. ALL SLOPE RATES ARE RELATIVE TO LEVEL AND SHALL COMPLY WITH THE PUBLIC RIGHT-OF-WAY ACCESSIBILITY GUIDELINES (PROWAG) STANDARDS, CURRENT VERSION.
7. GUTTER SHALL MAINTAIN POSITIVE DRAINAGE TO PREVENT PONDING.
8. DETECTABLE WARNING SHALL CONSIST OF PRECAST WETSET TILES WITH MIN. SIZE OF 2' X 2', COLOR DARK RED. APPROVED PRODUCTS INCLUDE: "CASTRACT", "TERWAY DOME-TILES", "ARMOR CAST WET SET TILES", AND "ARCIS WET SET TILES". DETECTABLE WARNING SHALL BE CONSTRUCTED PER MANUFACTURER'S INSTALLATION GUIDELINES AND CONFORM TO ADAAG.
9. CONCRETE REMOVAL SHALL BE TO NEAT SAW CUT LINES.
10. AGGREGATE BASE MATERIAL UNDER PEDESTRIAN RAMPS SHALL BE TYPE 2, CLASS B CRUSHED AGGREGATE BASE. MATERIALS SHALL CONFORM TO SSPWC SECTION 200.
11. FIBER-REINFORCED PORTLAND CEMENT CONCRETE (P.C.C.) SHALL HAVE THE FOLLOWING CHARACTERISTICS: 4000 PSI MIN. COMPRESSIVE STRENGTH AT 28 DAYS, MIN. 6 SACKS OF CEMENT PER CUBIC YARD WITH MAX. WATER-CEMENT RATIO OF 0.45, AIR ENTRAINMENT 6% ± 1.5%, SLUMP AT 1 TO 4 INCHES. MAX DESIGN SHALL CONFORM TO THE REQUIREMENTS OF SECTION 337 OF STANDARD SPECIFICATIONS OF PUBLIC WORKS CONSTRUCTION (SSPWC). CEMENT SHALL BE TYPE II. ALL CEMENT CONCRETE SHALL HAVE A COARSE AGGREGATE GRADATION CONFORMING TO SIZE NO. 67. POLYPROPYLENE OR CELLULOSE FIBERS SHALL BE ADDED TO THE P.C.C. AT 1.5 LBS. PER CUBIC YARD. ALL MATERIALS SHALL CONFORM TO SSPWC.
12. CONTRACTORS SHALL CORRECT ANY GRADE CONFLICT WITH EXISTING BOXES. THE ENGINEER SHALL MAKE THE FINAL DETERMINATION REGARDING THE DEGREE OF MODIFICATIONS REQUIRED BY THE CONTRACTOR FOR GRADE CONFLICTS BETWEEN EXISTING BOXES AND NEW PEDESTRIAN RAMPS.
13. SIDEWALK AT BOTH SIDES OF RAMP MAY BE RECONSTRUCTED TO MINIMIZE THE GRADE AT A HORIZONTAL DISTANCE TO BE DETERMINED IN THE FIELD, UPON APPROVAL OF THE ENGINEER, SUBJECT TO PROWAG REQUIREMENTS. CURB AT THE BACK OF WALK MAY BE NEEDED. A TRANSITION SECTION OF SIDEWALK MAY BE NECESSARY TO MATCH CROSS SLOPE OF EXISTING SIDEWALK TO PEDESTRIAN RAMP IMPROVEMENTS. TRANSITION SECTIONS SHALL BE APPROVED BY THE ENGINEER PRIOR TO INSTALLATION.
14. CONTRACTOR SHALL CONSTRUCT ROUNDED CURBS WHERE THEY INTERSECT. RADIUS SHALL BE 1 FT MINIMUM MEASURED FROM FACE OF CURB. CURBS THAT INTERSECT AT A POINT SHALL NOT BE ALLOWED.

**PEDESTRIAN RAMP NOTES**

DATE: 1/2013

**Basic Synthetic Turf Installation  
Guidelines**

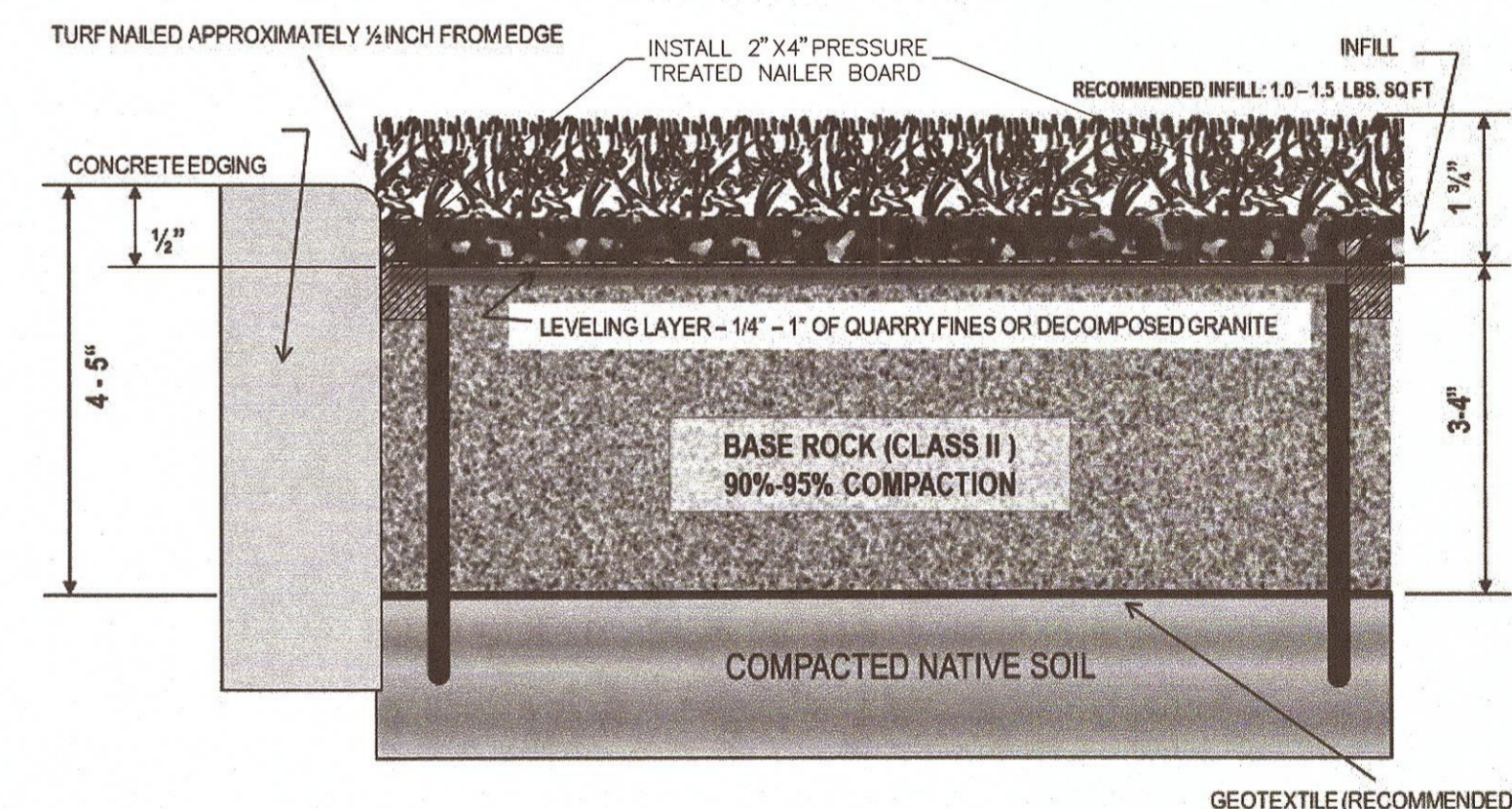

**Basic Installation Method**

*This grass is being installed next to a hard concrete edge.*

1. Excavate 3-5 inches of the native soil; an optional weed barrier may be laid down on top of the excavated area.
2. Fill in 3-4 inches with a crushed rock base, compacted to 90%-95% compaction, leaving 3/4 inch before reaching the height of the concrete edge.
3. Lay 1/4 inch of decomposed granite on top of the crushed rock base and make sure to compact this evenly.
4. Now that the sub-base is complete, you can roll out and attach your grass. If there are any seams, be sure to use seam tape and glue to attach the two pieces, and secure into place with 5 inch non-galvanized nails every 6 inches on both sides of the seam. Secure the turf by using 5 inch non-galvanized nails every 6 inches around the perimeter, about 1/2 inch away from the hard concrete edge, as well as every 3 square feet within the interior.
5. Now that the grass is laid out flat and attached, evenly spread 1 - 1.5 pound(s) of infill per square foot, raking it into the thatch of the turf.

**ARTIFICIAL TURF DETAIL**  
N.T.S.

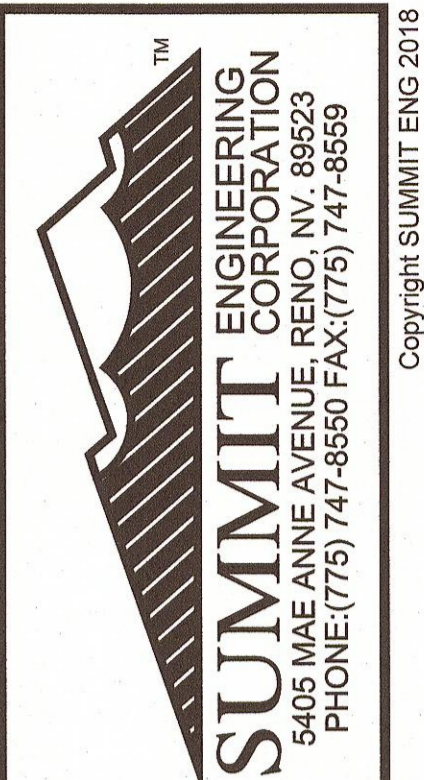

**SUMMIT  
ENGINEERING  
CORPORATION**  
5405 MAE ANNE AVENUE, RENO, NV, 89523  
PHONE: (775) 747-8550 FAX: (775) 747-8559

Copyright SUMMIT ENG 2013

REV.	DATE	DESCRIPTION	BY	APP'D

**CITY OF SPARKS**  
VICTORIAN SQUARE INFRASTRUCTURE  
PHASE 2 DETAIL SHEET  
SPARKS WASHOE COUNTY NEVADA

DESIGNED BY: MF  
CHECKED BY: CT  
SCALE  
HORIZ: N/A  
VERT: N/A  
JOB NO: 30748  
CLINTON G. THIESSE  
CIVIL  
No. 6159  
12/5/13

SHEET **C3.2** OF **9**

N:\DWG\30748\_Victorian\Phase2\Civil\VCP\_PHR2\_DETAIL\_S\_1\_25889\_4551.DWG - 12:26 PM - 05-DEC-2013