

STANDARD ENGINEERING NOTES

1. THESE PLANS ARE SUBJECT TO THE INTERPRETATION OF INTENT BY THE ENGINEER. ALL QUESTIONS REGARDING THESE PLANS MUST BE PRESENTED TO THE ENGINEER. ANYONE WHO TAKES THE INTERPRETATION OF THE DRAWINGS UPON THEMSELVES OR MAKES REVISIONS TO THE SAME WITHOUT CONFERRING WITH THE DESIGN ENGINEER SHALL BE RESPONSIBLE FOR THE CONSEQUENCES THEREOF.
2. PRIOR TO BIDDING THE WORK, THE CONTRACTOR MUST THOROUGHLY SATISFY HIMSELF AS TO THE ACTUAL CONDITIONS, REQUIREMENTS OF THE WORK AND EXCESS OR DEFICIENCY IN QUANTITIES. NO CLAIMS CAN BE MADE AGAINST THE OWNER/DEVELOPER OR ENGINEER FOR ANY EXCESS OR DEFICIENCY THEREIN, ACTUAL OR RELATIVE.
3. THE ENGINEER SHALL NOT BE RESPONSIBLE FOR CONSTRUCTION MEANS, METHODS, TECHNIQUES, SEQUENCES, PROCEDURES OR SAFETY PRECAUTIONS OR PROGRAMS UTILIZED IN CONNECTION WITH THE WORK, AND WILL NOT BE RESPONSIBLE FOR THE CONTRACTOR'S FAILURE TO CARRY OUT THE WORK IN ACCORDANCE WITH THE CONTRACT DOCUMENTS.
4. THE ENGINEER SHALL NOT BE RESPONSIBLE FOR COORDINATING THE RELOCATION OF UTILITIES, LIGHTS, IRRIGATION ETC.
5. THE CONTRACTOR MUST VERIFY THE LOCATION, ELEVATION, CONDITION, AND PAVEMENT CROSS-SLOPE OF ALL EXISTING SURFACES AT POINTS OF TIE-IN AND MATCHING, PRIOR TO COMMENCEMENT OF CONSTRUCTION. SHOULD EXISTING LOCATIONS, ELEVATIONS, CONDITION, OR PAVEMENT CONFLICT WITH ADA OR PLAYING FIELD REQUIREMENTS, THE CONTRACTOR MUST NOTIFY THE OWNER'S AGENT IMMEDIATELY FOR DIRECTION ON HOW TO PROCEED PRIOR TO COMMENCEMENT OF CONSTRUCTION. THE CONTRACTOR ACCEPTS RESPONSIBILITY FOR ALL COSTS ASSOCIATED WITH CORRECTIVE ACTION IF THESE PROCEDURES ARE NOT FOLLOWED.
6. EXISTING UTILITIES SHOWN ARE BASED ON SURVEY LOCATIONS. ADDITIONAL UTILITIES MAY EXIST THAT ARE NOT SHOWN ON PLANS. CALL UNDERGROUND SERVICE ALERT PRIOR TO CONSTRUCTION. THE CONTRACTOR MUST PROTECT AND MAINTAIN ALL EXISTING UTILITIES ON THE SITE. ANY DAMAGE TO EXISTING UTILITIES, WHETHER SHOWN OR NOT ON THESE PLANS, MUST BE REPAIRED/REPLACED AT THE CONTRACTOR'S EXPENSE IF DAMAGED BY CONTRACTOR. EXISTING SURFACE FEATURES AND FENCING MUST BE REPLACED IN KIND.
7. THE ENGINEER AND APPLICABLE AGENCY MUST APPROVE, PRIOR TO CONSTRUCTION, ANY ALTERATION, OR VARIATIONS FROM THESE PLANS. ANY VARIATIONS FROM THESE PLANS MUST BE PROPOSED ON CONSTRUCTION FIELD PRINTS AND TRANSMITTED TO THE ENGINEER.
8. ANY INSPECTION BY ANY JURISDICTIONAL AGENCY, SHALL NOT, IN ANY WAY, RELIEVE THE CONTRACTOR FROM ANY OBLIGATION TO PERFORM THE WORK IN STRICT COMPLIANCE WITH THESE PLANS, SPECIFICATIONS, APPLICABLE CODES AND AGENCY REQUIREMENTS.
9. ANY HAULING PERMITS REQUIRED ARE TO BE OBTAINED BY THE CONTRACTOR AT NO ADDITIONAL COST TO THE OWNER.
10. ANY CONSTRUCTION WATER ACCESS IS TO BE OBTAINED BY THE CONTRACTOR AT NO ADDITION COST TO THE OWNER. FIRE HYDRANT ACCESS MUST BE PERMITTED AND METERED BY THE LOCAL WATER UTILITY AT NO ADDITIONAL COST TO THE OWNER.
11. CONTRACTOR IS RESPONSIBLE FOR PROTECTING ALL STORM DRAIN PIPES AND DRAINAGE FACILITIES FROM DAMAGE DURING ALL STAGES OF CONSTRUCTION.
12. THE CONTRACTOR SHALL PROVIDE AND INSTALL EROSION CONTROL ITEMS SUCH AS SILT FENCING, HAY BALES, STABILIZED CONSTRUCTION ENTRANCES, AND INLET SEDIMENT TRAPS AS REQUIRED. THE CONTRACTOR IS RESPONSIBLE TO PROVIDE ANY EROSION CONTROL PLANS REQUIRED BY GOVERNMENT AGENCIES, AND OBTAIN ANY REQUIRED PERMITS.

CITY OF SPARKS

GOLDEN EAGLE REGIONAL PARK

SYNTHETIC TURF REPLACEMENT - GERP FIELDS 10-14 INFIELDS

BID NO. 18/19-014 PWP NO. #WA-2019-071

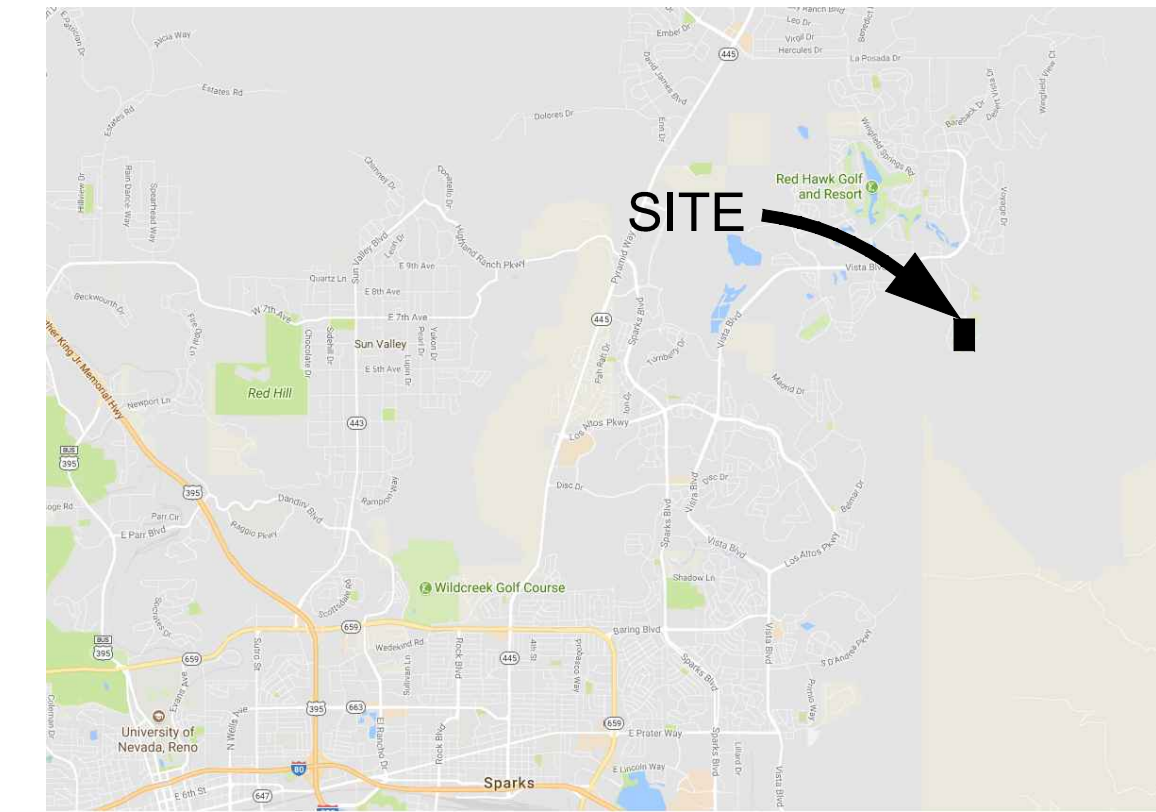

VICINITY MAP
N.T.S.



LOCATION MAP
N.T.S.

SCOPE OF WORK

THE PROJECT SCOPE OF WORK INCLUDES IMPROVEMENTS TO EXISTING SYNTHETIC TURF FIELD FACILITIES.

EXISTING SYNTHETIC TURF SOFTBALL FIELDS WILL HAVE EXISTING INFIELD MATERIAL REMOVED AND NEW SHOCK PAD, SYNTHETIC TURF AND INFILL PRODUCT INSTALLED.

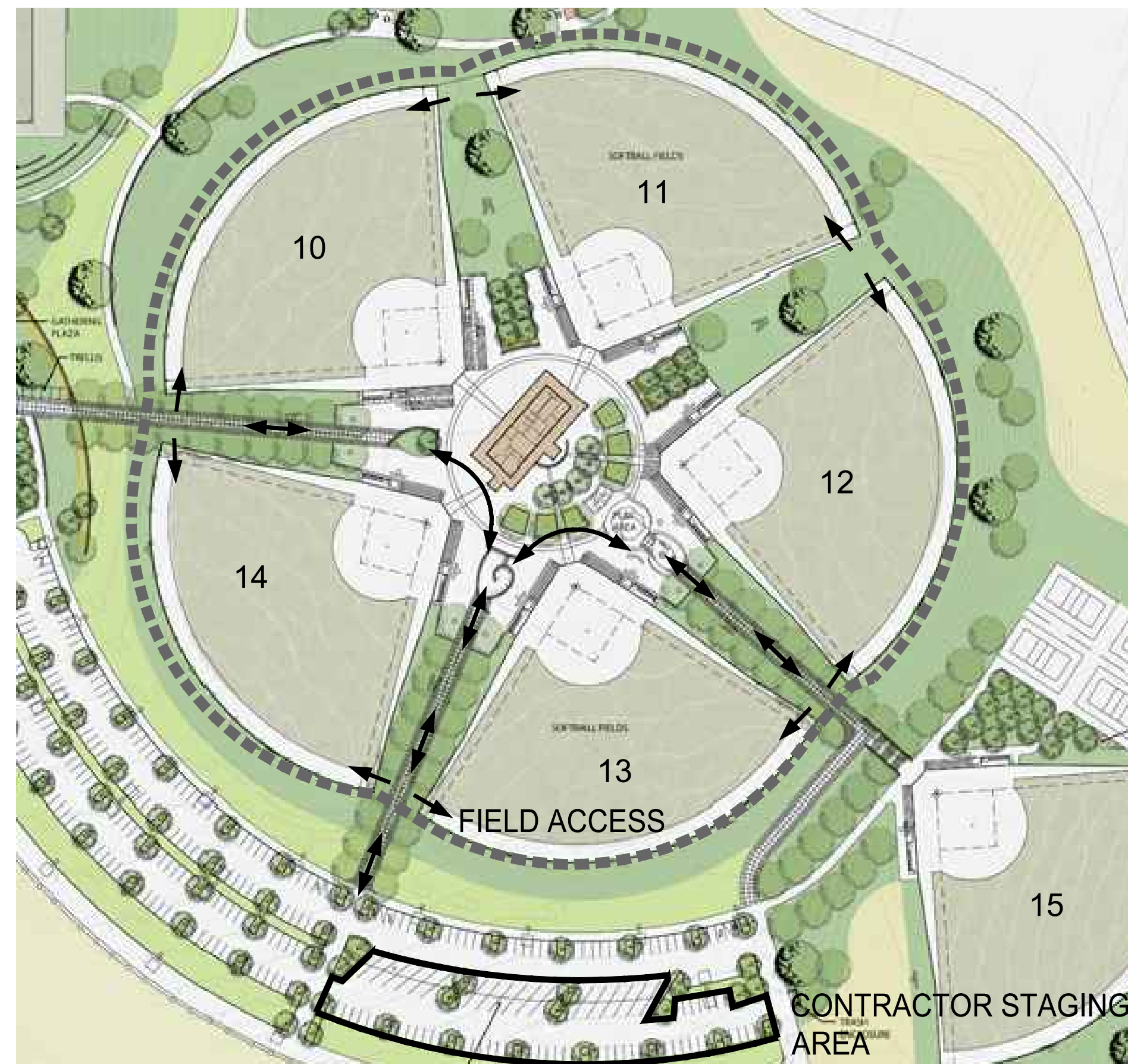

SITE ACCESS AND LOGISTICS
N.T.S.

BENCHMARK

THE BASIS OF ELEVATIONS FOR THIS SURVEY IS THE NORTH AMERICAN VERTICAL DATUM OF 1988 (NAVD88) BASED UPON CITY OF SPARKS BENCHMARK #10 BEING A 2' ALUMINUM WASHER IN THE TOP OF CURB AT THE NORTHEAST CORNER OF NORTH WINGFIELD PARKWAY AND VISTA BOULEVARD WITH AN ELEVATION OF 4509.99 FEET.

BASIS OF BEARING

THE BASIS OF BEARINGS FOR THIS SURVEY IS NEVADA STATE PLANE, WEST ZONE NAD83(94) BASED ON REAL TIME KINEMATIC (RTK) GPS OBSERVATIONS UTILIZING CORRECTIONS FROM THE NORTHERN NEVADA COOPERATIVE REAL TIME NETWORK. COORDINATES AND DISTANCES HEREON ARE AT GROUND LEVEL BASED ON A COMBINED GRID TO GROUND FACTOR OF 1.000197939.

SHEET INDEX

- PF-01 COVER SHEET
- PF-02 EXISTING CONDITIONS & DEMOLITION PLAN
- PF-03 SURFACING PLAN
- PF-04 SURFACING PLAN (FIELD 12)
- PF-05 TURF GRAPHICS PLAN
- PF-06 DETAILS

ENGINEER

ANTHONY STEVENSON
LLOYD CIVIL & SPORTS ENGINEERING, LLC
7349 N. VIA PASEO DEL SUR
SUITE 515-324
SCOTTSDALE, AZ 85258
(602) 635-4226
EMAIL: astevenson@lloydengineers.com

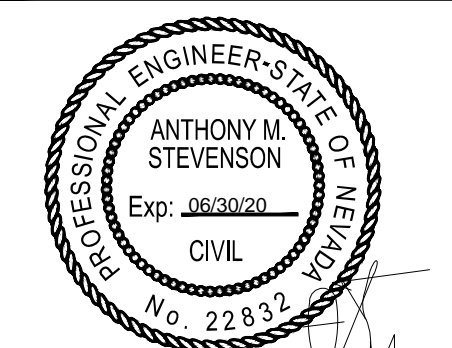

REV.

**GERP FIELDS 10-14
INFIELD RESURFACING**

City of Sparks, NV

SCALE:	AS NOTED
DESIGNED:	
DATE:	12/06/18
DRAWN:	ZTP
PROJ.	18140
APPROVED:	

COVER SHEET

DWG. NO.
PF-01

This plan document set is the sole property of Lloyd Consulting Group, LLC. No alterations to these plans, other than adding "as-built" information, are allowed by anyone other than authorized Lloyd Consulting Group, LLC employees.

DEMOLITION NOTES:

- 1 REMOVE EXISTING SYNTHETIC TURF AND INFILL. DISPOSE OF TURF AND INFILL PER LOCAL CODES AND REQUIREMENTS.
- 2 REMOVE AND DISPOSE OF EXISTING HOME PLATE AND CONCRETE FOOTING. PREPARE BACKFILL TO COMPACT AND LEVEL WITH AGGREGATE BASE.
- 3 REMOVE EXISTING NAILER BOARD IN ZONE OF RESURFACING IN PREPARATION FOR THE INSTALLATION OF NEW NAILER BOARD.
- 4 THE LIMITS OF DEMOLITION SHALL ALIGN WITH THE EXISTING DUGOUT/FENCE STRUCTURE SO THAT THE NEW TURF ALIGNS WITH A LOGICALLY AND VISUALLY CORRECT TERMINATION FROM EXISTING TO NEW.



GENERAL NOTES:

- 1. CONTRACTOR MUST REMOVE AND DISPOSE OF ALL WEEDS AND LOOSE MATERIALS
- 2. EXISTING STORM DRAIN FACILITIES WITHIN THE LIMITS OF CONSTRUCTION MUST BE PROTECTED FROM CONSTRUCTION DEBRIS INTRUSION AND MUST BE FLUSHED OUT AND CLEANED BY THE CONTRACTOR AT THE END OF CONSTRUCTION.
- 3. THE CONTRACTOR MUST PROTECT IN PLACE ALL EXISTING UTILITIES. THE CONTRACTOR IS RESPONSIBLE FOR REPAIR OR REPLACEMENT OF UTILITIES DAMAGED DURING CONSTRUCTION.
- 4. CONTRACTOR MUST PROTECT EXISTING TURF TO REMAIN THAT WILL BE USED AS ACCESS AND TRAVEL WAY FROM MAINTENANCE GATES TO INFIELD ZONE WORK AREAS. OWNER MUST REVIEW AND APPROVE LOGISTICS AND PROTECTION PLAN TO AVOID DAMAGE TO PLAYING FIELD SURFACES THAT ARE REMAINING.
- 5. LIMITS OF DEMOLITION ARE TO BE 4' OUTSIDE INFIELD SKIN AREA ON ARC AND EXPANDING TO 12' AT FOUL LINE AS SHOWN ON ALL FIELDS.

PROTECT IN PLACE NOTES:

- 10 CONTRACTOR MUST PROTECT IN PLACE EXISTING CONCRETE CURBS, FLATWORK, FOUNDATIONS. WHERE DAMAGED SECTIONS ARE FOUND, THE CONTRACTOR MUST REPLACE TO MATCH EXISTING CONDITIONS.
- 11 EXISTING FIELD SUBGRADE MUST BE PROTECTED IN PLACE.
- 12 PROTECT IN PLACE EXISTING SYNTHETIC TURF IN OUTFIELD.
- 13 CONTRACTOR MUST VERIFY ALL DRAINAGE LOCATIONS AND ADD TO AS-BUILT PLANS.
- 14 PROTECT IN PLACE EXISTING FIELD ACCESS GATES.

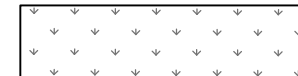
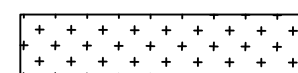
LEGEND:

-  EXISTING SYNTHETIC TURF SURFACE TO REMAIN
-  EXISTING SYNTHETIC TURF SURFACE TO BE REMOVED
-  LIMITS OF CONSTRUCTION

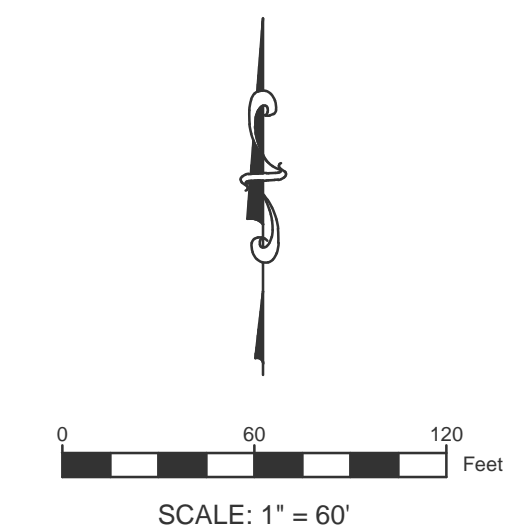

This plan document set is the sole property of Lloyd Consulting Group, LLC. No alterations to these plans, other than adding "as-built" information, are allowed by anyone other than authorized Lloyd Consulting Group, LLC employees.

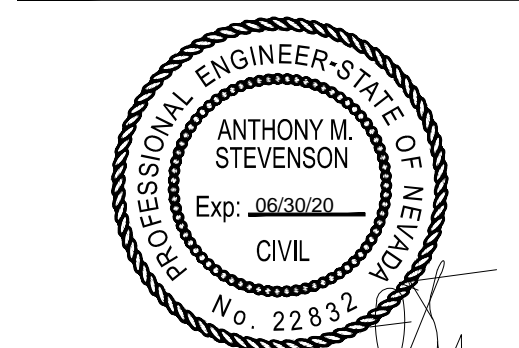
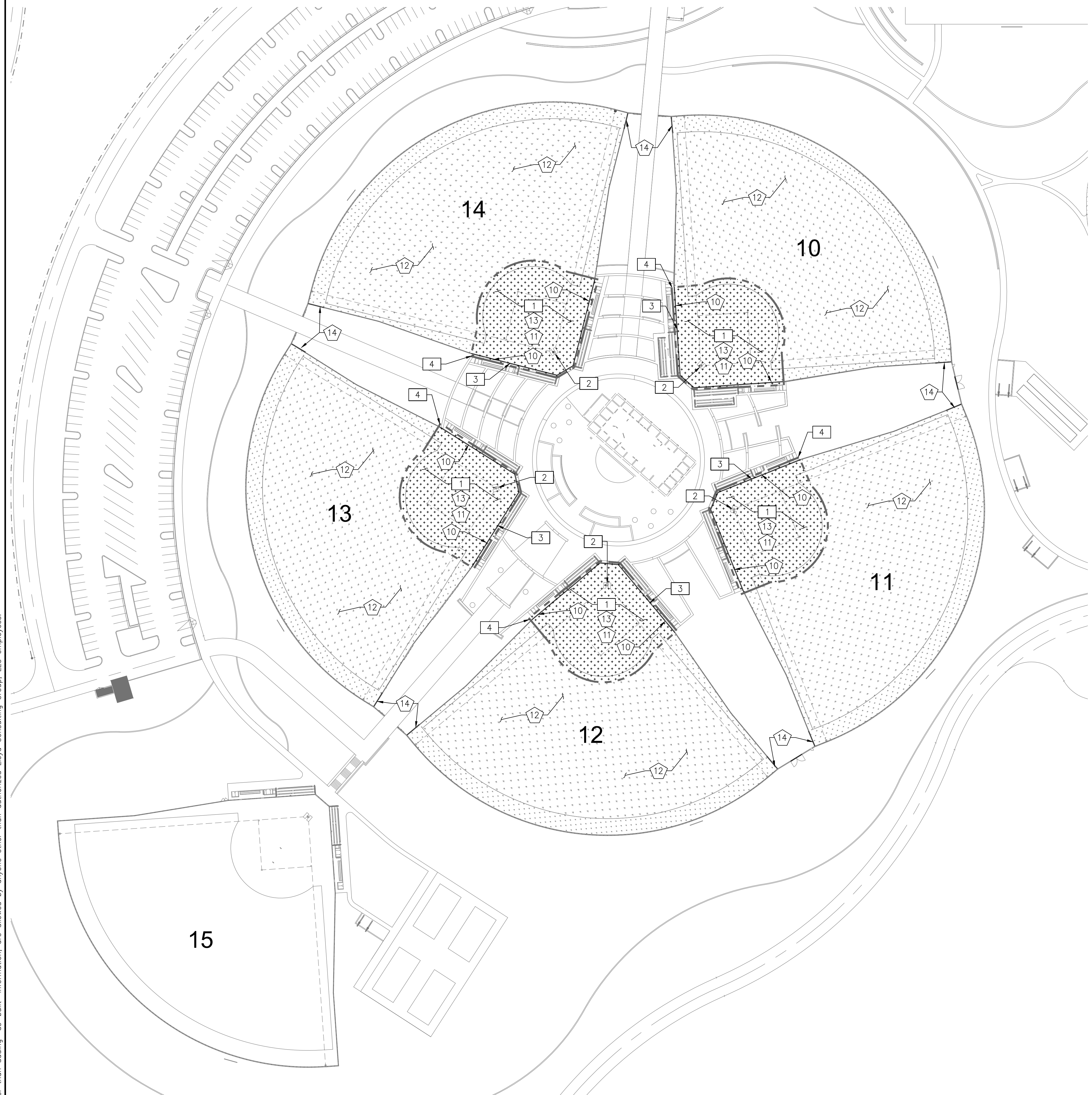

REV.	

**GERP FIELDS 10-14
 INFIELD RESURFACING**

City of Sparks, NV

SCALE:	1"=60'
DESIGNED:	
DATE:	12/06/18
DRAWN:	TML
PROJ.	18140
APPROVED:	

**EXISTING CONDITIONS
 & DEMOLITION**

DWG. NO.
PF-02



SURFACING NOTES:

- ① ADJUST PLAYING FIELD BASE ELEVATIONS AT FIELD PERIMETER AND TO NEWLY INSTALLED NAILER BOARD TO MAINTAIN SMOOTH/FLUSH TRANSITION BETWEEN TURF AND CONCRETE CURB/SIDEWALK WITH NO GRADING GAP OR LIP. SEE DETAIL 02 ON SHEET PF-06.
- ② ATTACH SYNTHETIC TURF TO NAILER BOARD PER DETAIL 02 ON SHEET PF-06.
- ③ THE CONTRACTOR MUST ATTACH INFILL SYNTHETIC TURF TO EDGE OF ALL EXISTING IRRIGATION, COMMUNICATION OR OTHER UTILITY BOX EDGES WITHIN TURF AREA. ALL BOXES MUST HAVE TURF WITH FOAM BACKING GLUED TO LIDS AND BE RAISED OR LOWERED AS REQUIRED TO PROVIDE SMOOTH PLAYING SURFACE.
- ④ PRIOR TO SHOCK PAD INSTALLATION THE CONTRACTOR MUST CORRECT ANY RIDGES OR DEPRESSIONS IN PLAYING FIELD BASE THAT DO NOT MEET GRADING TOLERANCES PER THE SPECIFICATIONS.
- ⑤ THE CONTRACTOR MUST INSTALL NEW SHOCK PAD AND SYNTHETIC TURF PER DETAIL 01 ON THIS SHEET.
- ⑥ BACKFILL, COMPACT AND LEVEL WITH AGGREGATE BASE. SPECIFIC ATTENTION MUST BE GIVEN TO HOME PLATE AREAS, PITCHING AREAS AND BASES, AS WELL AS DUGOUT AND GATE ENTRIES.

GENERAL NOTES:

1. ALL COMPETITION REQUIRED STRIPES AND MARKINGS MUST BE INLAID AND MUST MEET THE LATEST REQUIREMENTS OF USA SOFTBALL.
2. GENERAL CONTRACTOR IS RESPONSIBLE FOR PREPARATION OF THE BASE IN THE TURF AREAS AND FOR COORDINATION WITH THE TURF INSTALLER'S WORK. TURF INSTALLER MUST SUBMIT COMPLETE SHOP DRAWINGS AND COLOR SAMPLES FOR REVIEW AND APPROVAL PRIOR TO INSTALLATION OF SYNTHETIC TURF. SUBMITTALS FOR SHOP DRAWINGS AND COLOR SAMPLES MUST BE IN ACCORDANCE WITH THE SPECIFICATIONS.
3. THE EXISTING DRAINAGE SYSTEM AND PERIMETER TRENCH DRAINS MUST BE MAINTAINED OR REPAIRED WHERE EVER DAMAGE IS DISCOVERED

LEGEND:

-  SYNTHETIC TURF SURFACE – INFIELD SKIN COLOR TBD BY OWNER DURING SUBMITTAL PROCESS
-  LIMITS OF CONSTRUCTION

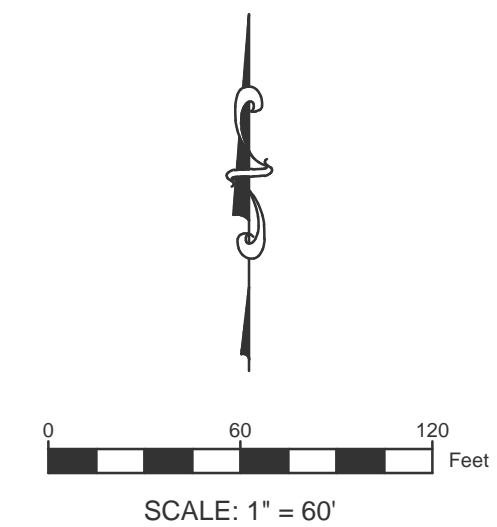

This plan document set is the sole property of Lloyd Consulting Group, LLC. No alterations to these plans, other than adding "as-built" information, are allowed by anyone other than authorized Lloyd Consulting Group, LLC employees.

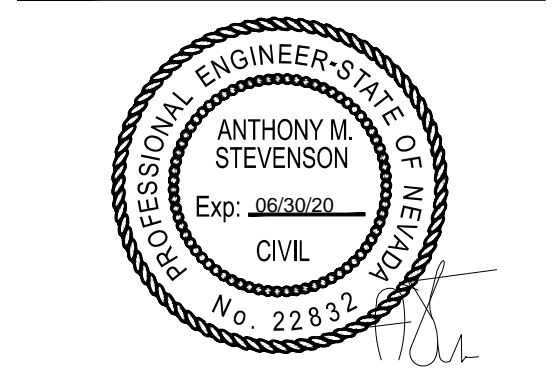
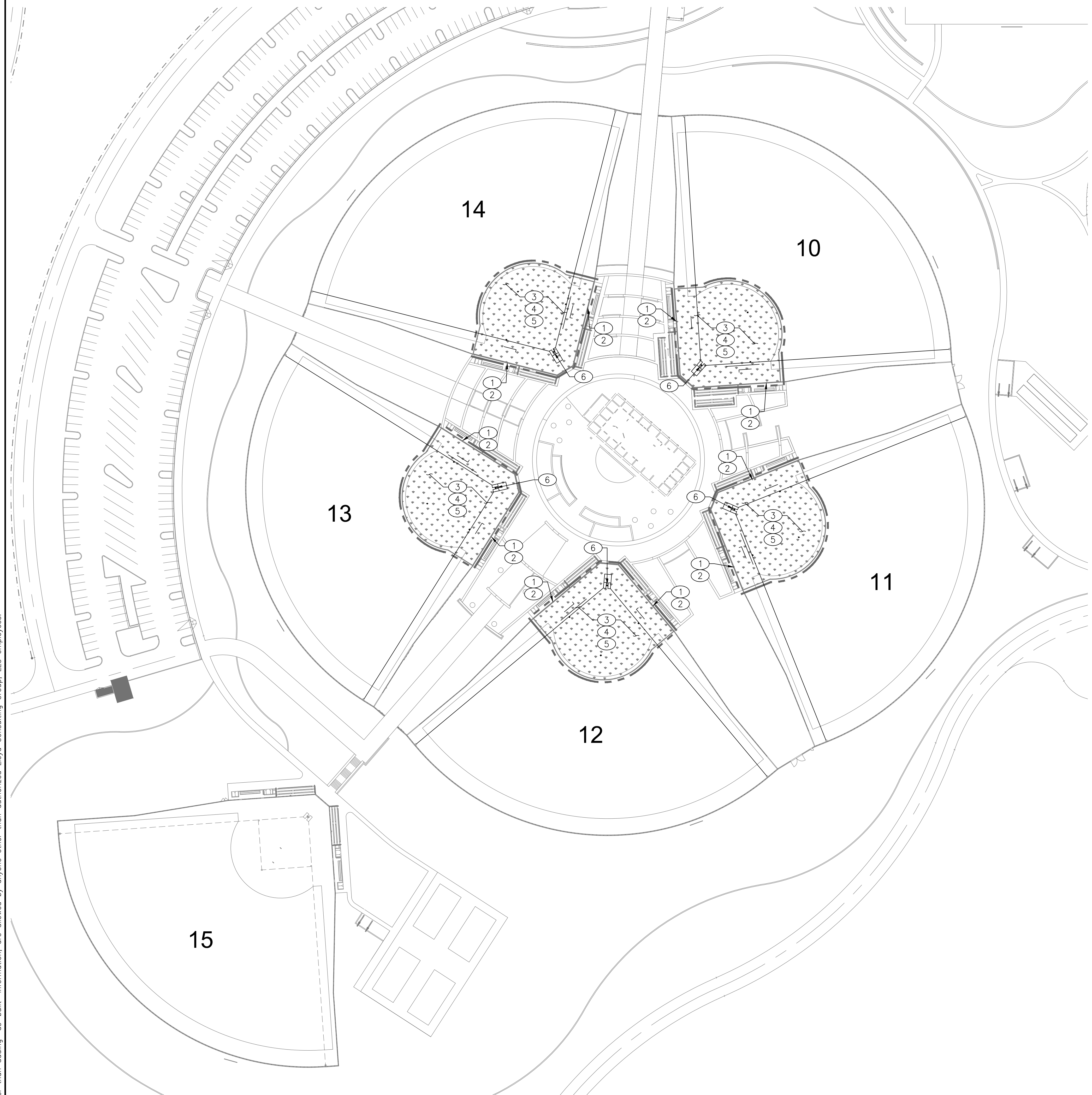

REV.	

**GERP FIELDS 10-14
 INFIELD RESURFACING**

City of Sparks, NV

SCALE:	1"=60'
DESIGNED:	
DATE:	12/06/18
DRAWN:	TML
PROJ.	18140
APPROVED:	

SURFACING

DWG. NO.
PF-03



SURFACING NOTES:

- ① ADJUST PLAYING FIELD BASE ELEVATIONS AT FIELD PERIMETER AND NAILER BOARD ELEVATIONS TO MAINTAIN SMOOTH/FLUSH TRANSITION BETWEEN TURF AND CONCRETE CURB/SIDEWALK WITH NO GRADING GAP OR LIP. SEE DETAIL 02 ON SHEET PF-06.
- ② ATTACH SYNTHETIC TURF TO NAILER BOARD PER DETAIL 02 ON SHEET PF-06.
- ③ THE CONTRACTOR MUST ATTACH INFILL SYNTHETIC TURF TO EDGE OF ALL EXISTING IRRIGATION, COMMUNICATION OR OTHER UTILITY BOX EDGES WITHIN TURF AREA. ALL BOXES MUST HAVE TURF WITH FOAM BACKING GLUED TO LIDS AND BE RAISED OR LOWERED AS REQUIRED TO PROVIDE SMOOTH PLAYING SURFACE.
- ④ PRIOR TO SHOCK PAD INSTALLATION THE CONTRACTOR MUST CORRECT ANY RIDGES OR DEPRESSIONS IN PLAYING FIELD BASE THAT DO NOT MEET GRADING TOLERANCES PER THE SPECIFICATIONS.
- ⑤ THE CONTRACTOR MUST INSTALL NEW SHOCK PAD AND SYNTHETIC TURF PER DETAIL 01 ON THIS SHEET.
- ⑥ BACKFILL, COMPACT AND LEVEL WITH AGGREGATE BASE

GENERAL NOTES:

1. ALL COMPETITION REQUIRED STRIPES AND MARKINGS MUST BE INLAID AND MUST MEET THE LATEST REQUIREMENTS OF USA SOFTBALL.
2. GENERAL CONTRACTOR IS RESPONSIBLE FOR PREPARATION OF THE BASE IN THE TURF AREAS AND FOR COORDINATION WITH THE TURF INSTALLER'S WORK. TURF INSTALLER MUST SUBMIT COMPLETE SHOP DRAWINGS AND COLOR SAMPLES FOR REVIEW AND APPROVAL PRIOR TO INSTALLATION OF SYNTHETIC TURF. SUBMITTALS FOR SHOP DRAWINGS AND COLOR SAMPLES MUST BE IN ACCORDANCE WITH THE SPECIFICATIONS.
3. THE EXISTING DRAINAGE SYSTEM AND PERIMETER TRENCH DRAINS MUST BE MAINTAINED OR REPAIRED WHERE EVER DAMAGE IS DISCOVERED

LEGEND:

-  SYNTHETIC TURF
-  LIMITS OF CONSTRUCTION

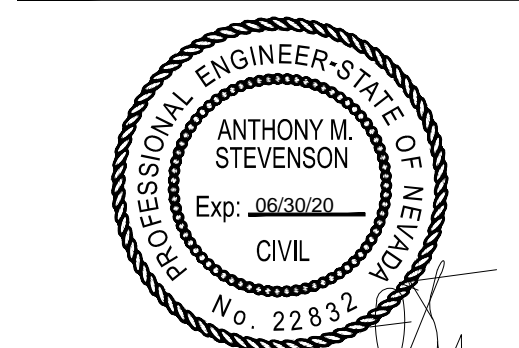
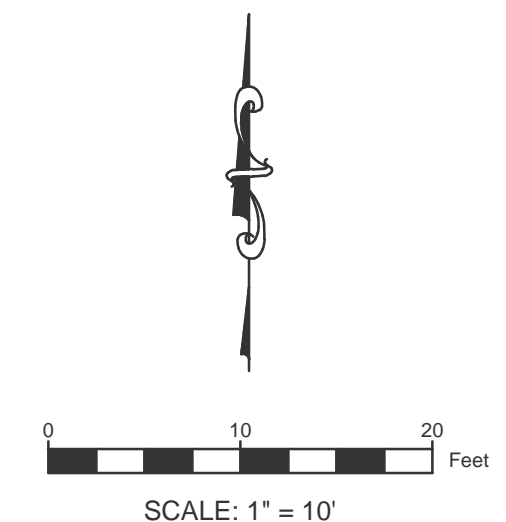

REV.	

**GERP FIELDS 10-14
 INFIELD RESURFACING**

City of Sparks, NV	
SCALE:	1" = 10'
DESIGNED:	
DATE:	12/06/18
DRAWN:	TML
PROJ.	18140
APPROVED:	

**SURFACING
 FIELD 12
 DWG. NO.
 PF-04**

This plan document set is the sole property of Lloyd Consulting Group, LLC. No alterations to these plans, other than adding "as-built" information, are allowed by anyone other than authorized Lloyd Consulting Group, LLC employees.

GRAPHICS PLAN NOTES

1. THIS GRAPHICS PLAN IS FOR REFERENCE ONLY. THE TURF MANUFACTURER AND INSTALLER MUST SUBMIT FOR REVIEW SHOP DRAWINGS PER SPECIFICATIONS.
2. ALL LINE WORK MUST BE IN ACCORDANCE WITH ASA SOFTBALL RULES AND REGULATIONS.
3. TURF MAY NOT BE PURCHASED UNTIL SHOP DRAWINGS AND PHYSICAL SAMPLES ARE APPROVED IN WRITING BY THE OWNER.

BASELINE DETAIL

(TYPICAL FOR ALL BASE INDICATORS 1ST, 2ND, 3RD)

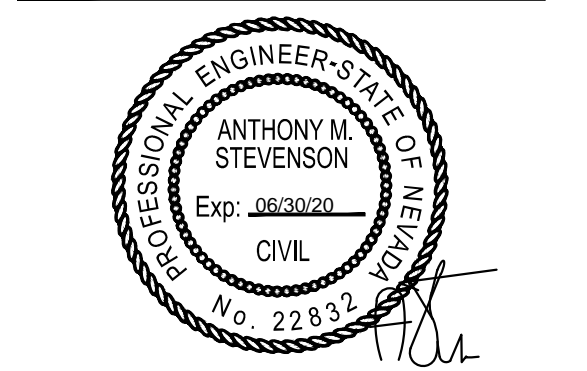
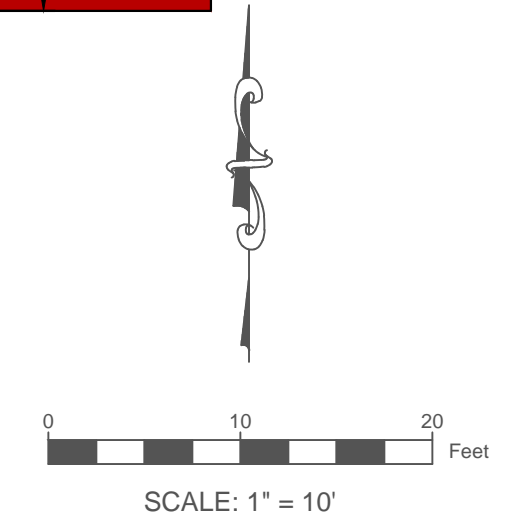
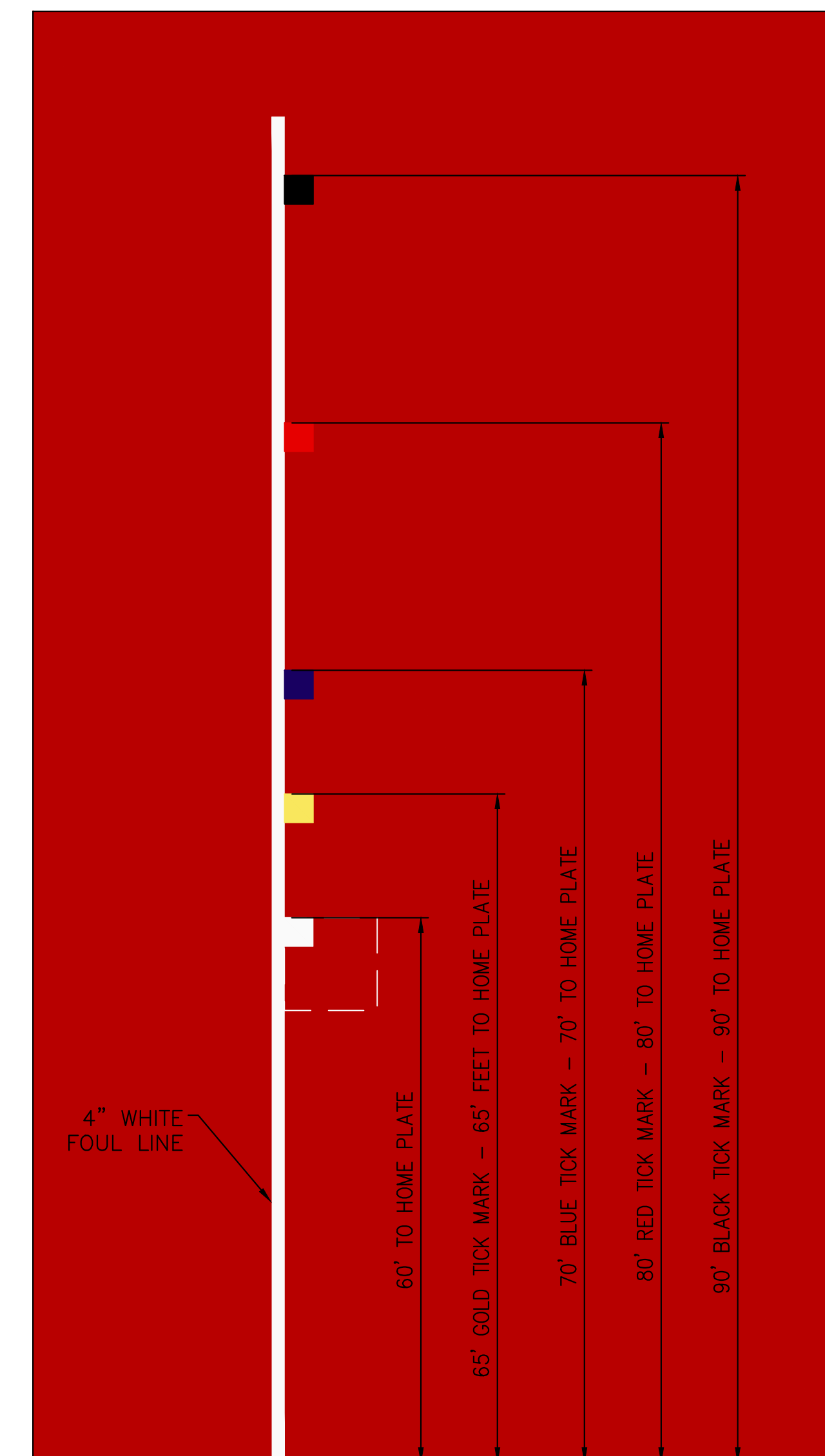

REV.	

**GERP FIELDS 10-14
 INFIELD RESURFACING**
 City of Sparks, NV
 SCALE: 1"=60'
 DESIGNED:
 DATE: 12/06/18
 DRAWN: TML
 PROJ. 18140
 APPROVED:

COLOR GRAPHICS
 DWG. NO.
PF-05

This plan document set is the sole property of Lloyd Consulting Group, LLC. No alterations to these plans, other than adding "as-built" information, are allowed by anyone other than authorized Lloyd Consulting Group, LLC employees.

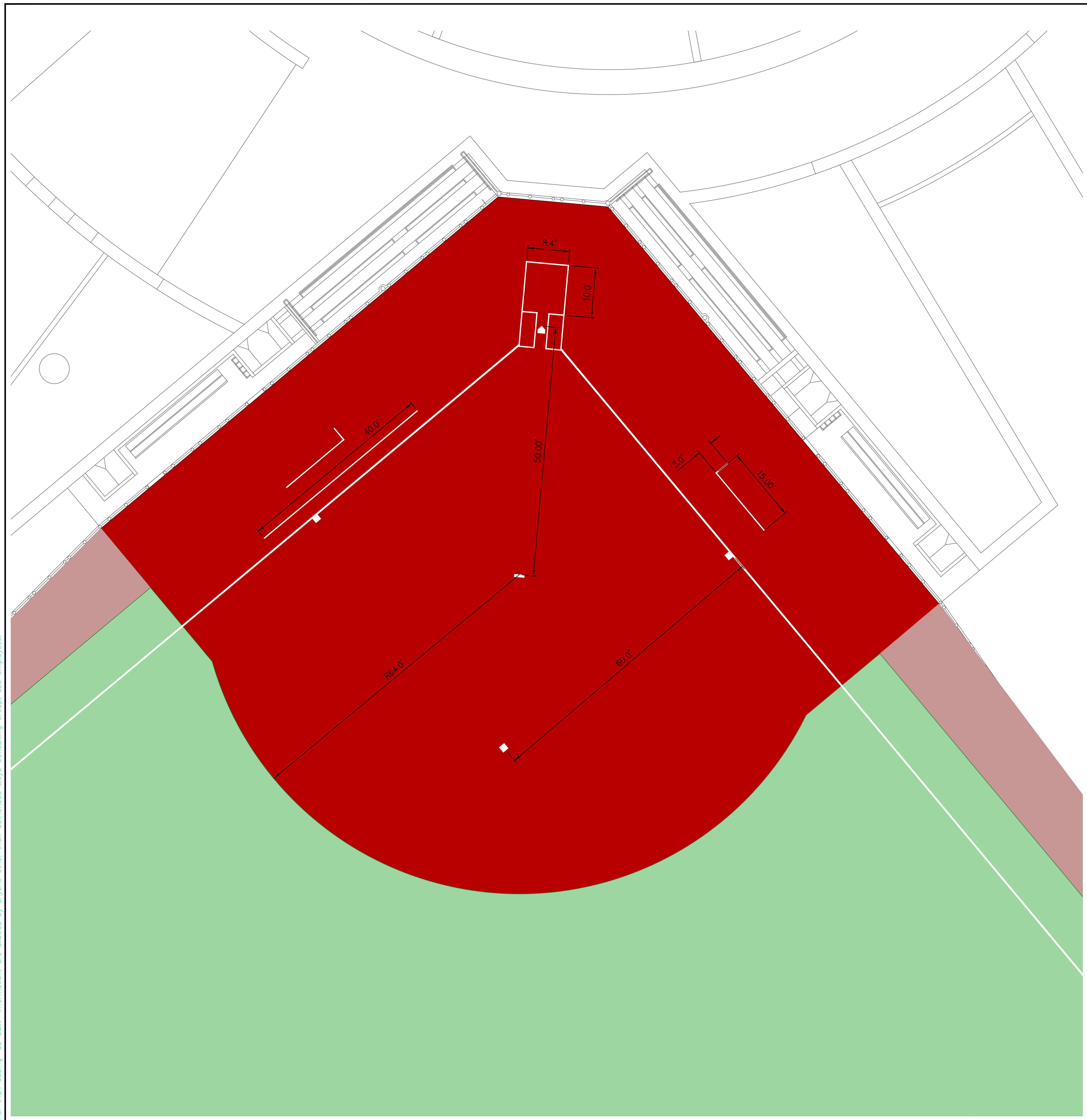

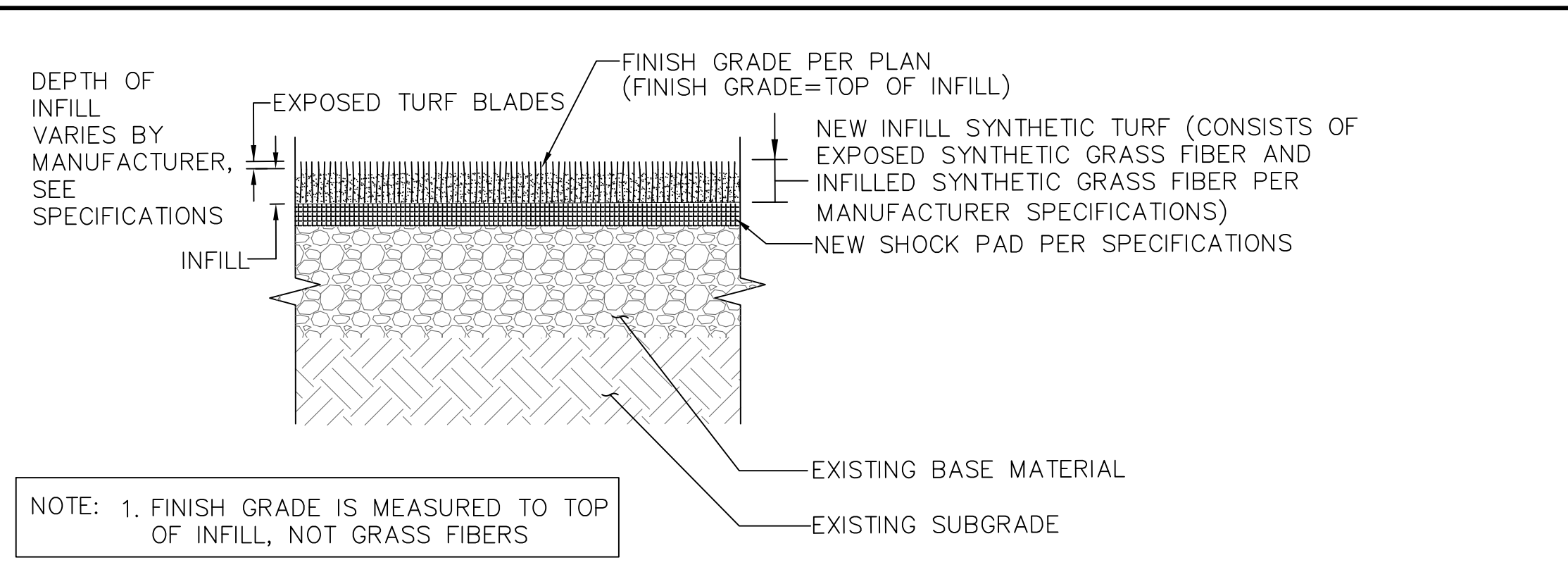

01 TYPICAL SYNTHETIC TURF SECTION
 SCALE: NTS

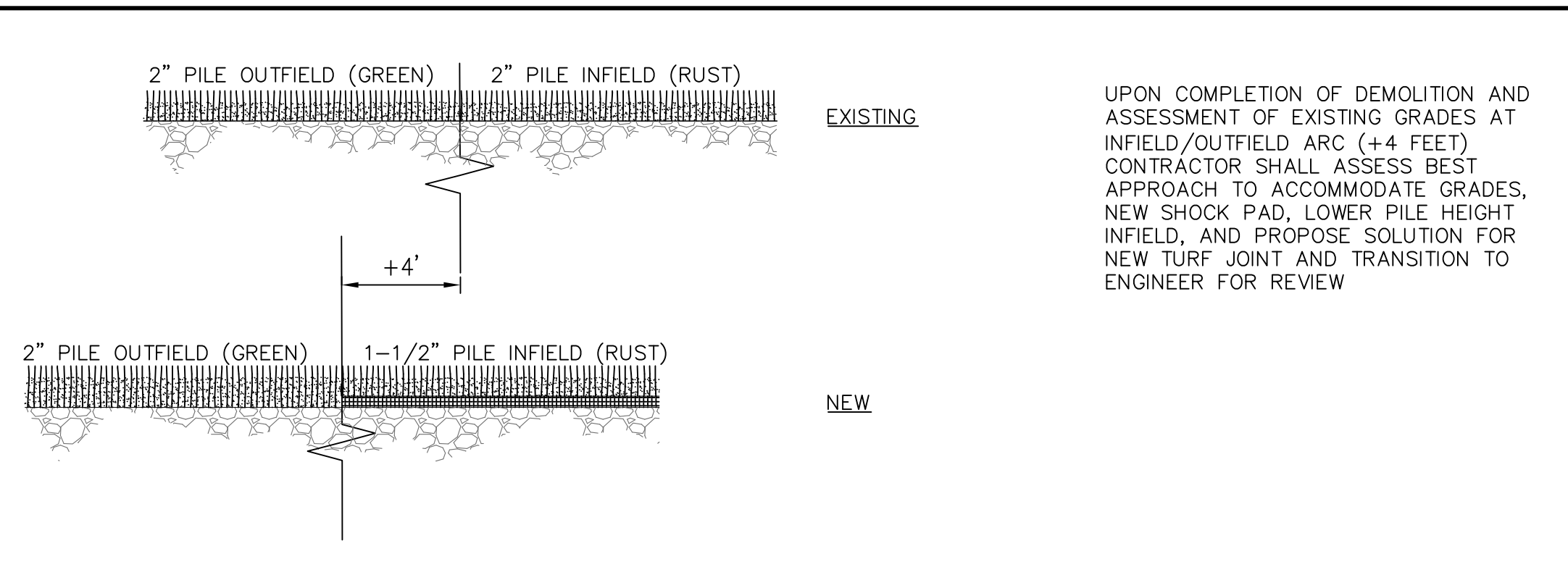

03 SYNTHETIC TURF TRANSITION AT OUTFIELD ARC
 SCALE: NTS

UPON COMPLETION OF DEMOLITION AND ASSESSMENT OF EXISTING GRADES AT INFIELD/OUTFIELD ARC (+4 FEET) CONTRACTOR SHALL ASSESS BEST APPROACH TO ACCOMMODATE GRADES, NEW SHOCK PAD, LOWER PILE HEIGHT INFIELD, AND PROPOSE SOLUTION FOR NEW TURF JOINT AND TRANSITION TO ENGINEER FOR REVIEW

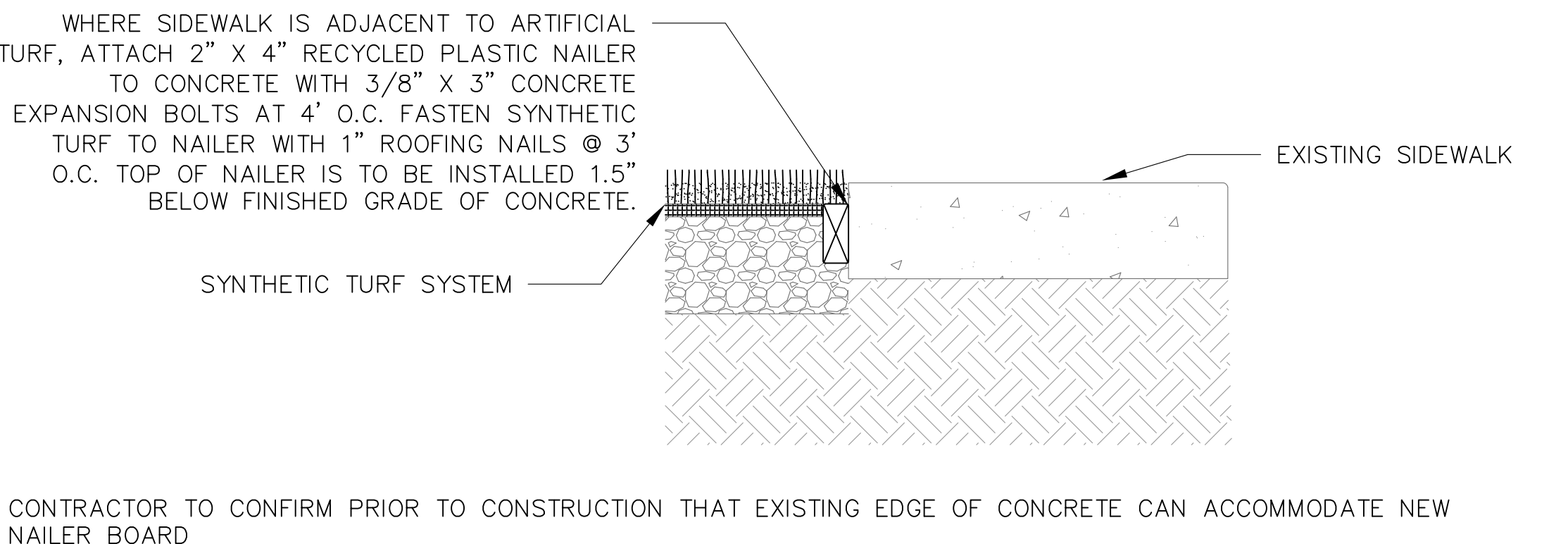

02 SIDEWALK AND SYNTHETIC TURF WITH NAILER BOARD
 SCALE: NTS

WHERE SIDEWALK IS ADJACENT TO ARTIFICIAL TURF, ATTACH 2" X 4" RECYCLED PLASTIC NAILER TO CONCRETE WITH 3/8" X 3" CONCRETE EXPANSION BOLTS AT 4' O.C. FASTEN SYNTHETIC TURF TO NAILER WITH 1" ROOFING NAILS @ 3' O.C. TOP OF NAILER IS TO BE INSTALLED 1.5" BELOW FINISHED GRADE OF CONCRETE.

CONTRACTOR TO CONFIRM PRIOR TO CONSTRUCTION THAT EXISTING EDGE OF CONCRETE CAN ACCOMMODATE NEW NAILER BOARD

This plan document set is the sole property of Lloyd Consulting Group, LLC. No alterations to these plans, other than adding as-built information, are allowed by anyone other than authorized Lloyd Consulting Group, LLC employees.



REV.	

**GERP FIELDS 10-14
 INFIELD RESURFACING**

City of Sparks, NV

SCALE:	AS NOTED
DESIGNED:	
DATE:	12/06/18
DRAWN:	TML
PROJ.	18140
APPROVED:	

DETAILS

DWG. NO.
PF-06

