



**ADDENDUM #1**

**VICTORIAN SQUARE INFRASTRUCTURE**

**BID #17/18-008 / PWP #WA-2018-010**

**BIDS DUE NO LATER THAN: 1:45 PM ON OCTOBER 18, 2017**

**PUBLIC BID OPENING: 2:00 PM ON OCTOBER 18, 2017**

This addendum is to notify all potential proposers of clarifications made to the Bid documents as stated below.

- 1) **SPECIAL PROVISIONS:** Section 5: Notice to Proceed and Time Schedule (Last Sentence of Section) to be modified as follows:  
**“All work described in this document shall be completed from Dec 18, 2017 – March 2, 2018”**
  
- 2) 3 additional sheets (Electrical Sheets) are included with this addendum and shall be included as an addition to the original plan set drawings for use in determining the total scope of work and cost for the project.

Please note and adjust your bid according to the revisions, additions, deletions, clarifications or modifications as presented on this Addendum #1, which are made a part of this bid. NOTE: To avoid disqualification, this Addendum 1 (and any other addenda) must be signed by an authorized representative of the bidding firm in the space provided and must be submitted with your firm’s sealed proposal. Failure to return this addendum, duly signed, may be cause for rejection of the bid. ALL ADDENDA SHOULD BE SIGNED AND PLACED IN SEQUENTIAL ORDER AND ATTACHED TO THE FRONT OF THE BID PACKAGE, COMPLETE WITH ALL REQUIRED DOCUMENTS.

\_\_\_\_\_  
CONTRACTOR BUSINESS NAME

X \_\_\_\_\_  
Authorized Signature

\_\_\_\_\_  
Printed Name of Person Signing

\_\_\_\_\_  
Dan Marran, C.P.M., CPPO  
Contracts and Risk Manager

September 29, 2017



**GENERAL NOTES**

- SHIFT EXISTING CIRCUITS IN GAZEBO PANEL AS REQUIRED TO ACCOMMODATE NEW LOADS.
- CONTRACTOR SHALL PROVIDE AND INSTALL NEW 20A, 120V CIRCUIT BREAKERS IN EXISTING GAZEBO PANEL AS REQUIRED FOR CONNECTION OF NEW LOADS. PROVIDE ALL MOUNTING HARDWARE REQUIRED AND MATCH EXISTING TYPES AND AIC RATING. CONNECT NEW LIGHTING (UP TO 3 CIRCUITS TOTAL) USING #10 CONDUCTORS IN CONDUIT INDICATED ON PLAN.

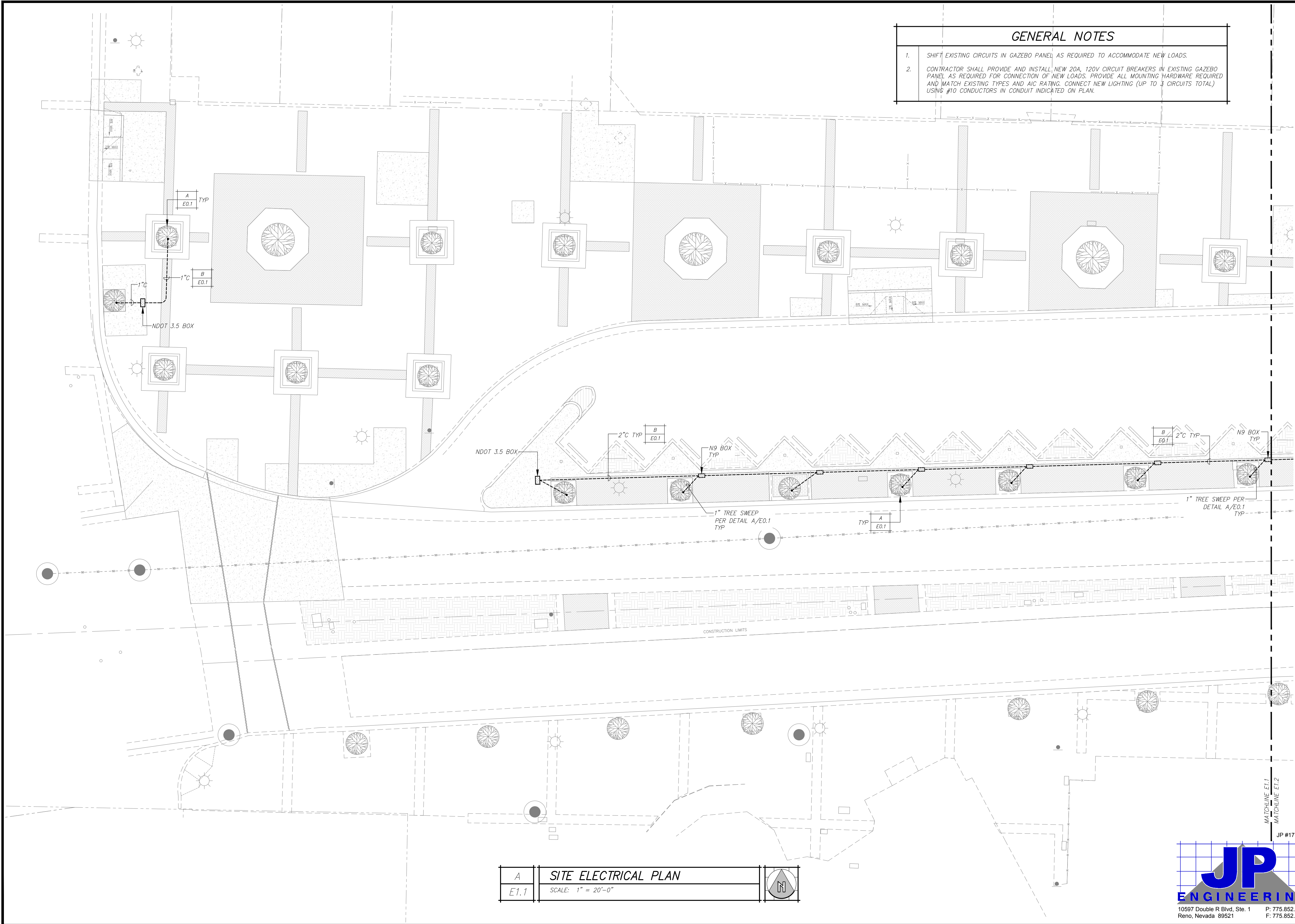

REV.	DATE	DESCRIPTION	BY	APPD

CITY OF SPARKS  
VICTORIAN SQUARE INFRASTRUCTURE-PHASE 1  
SITE ELECTRICAL PLAN  
SPARKS WASHOE COUNTY NEVADA

DESIGNED BY: JPS  
CHECKED BY: JPS  
SCALE  
HORIZ: AS NOTED  
VERT: N/A  
JOB NO: 30263

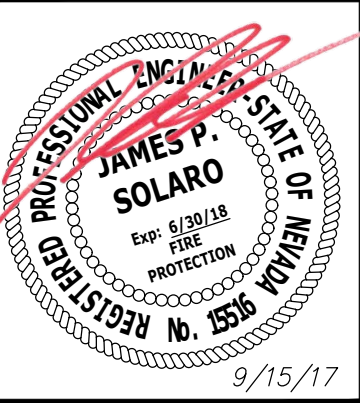

SHEET E1.1 OF 14

**A**  
**E1.1** **SITE ELECTRICAL PLAN**  
SCALE: 1" = 20'-0"

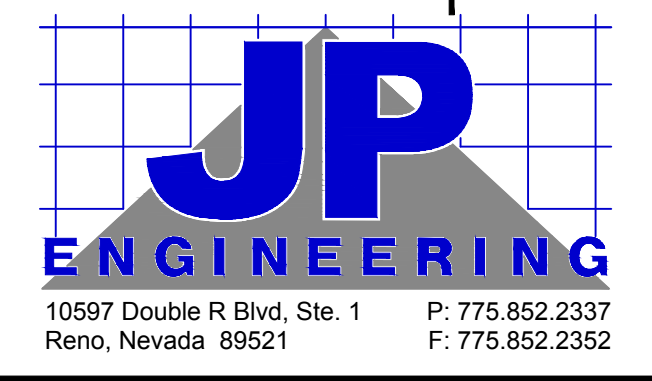

**GENERAL NOTES**

- SHIFT EXISTING CIRCUITS IN GAZEBO PANEL AS REQUIRED TO ACCOMMODATE NEW LOADS.
- CONTRACTOR SHALL PROVIDE AND INSTALL NEW 20A, 120V CIRCUIT BREAKERS IN EXISTING GAZEBO PANEL AS REQUIRED FOR CONNECTION OF NEW LOADS. PROVIDE ALL MOUNTING HARDWARE REQUIRED AND MATCH EXISTING TYPES AND AIC RATING. CONNECT NEW LIGHTING (UP TO 3 CIRCUITS TOTAL) USING #10 CONDUCTORS IN CONDUIT INDICATED ON PLAN.

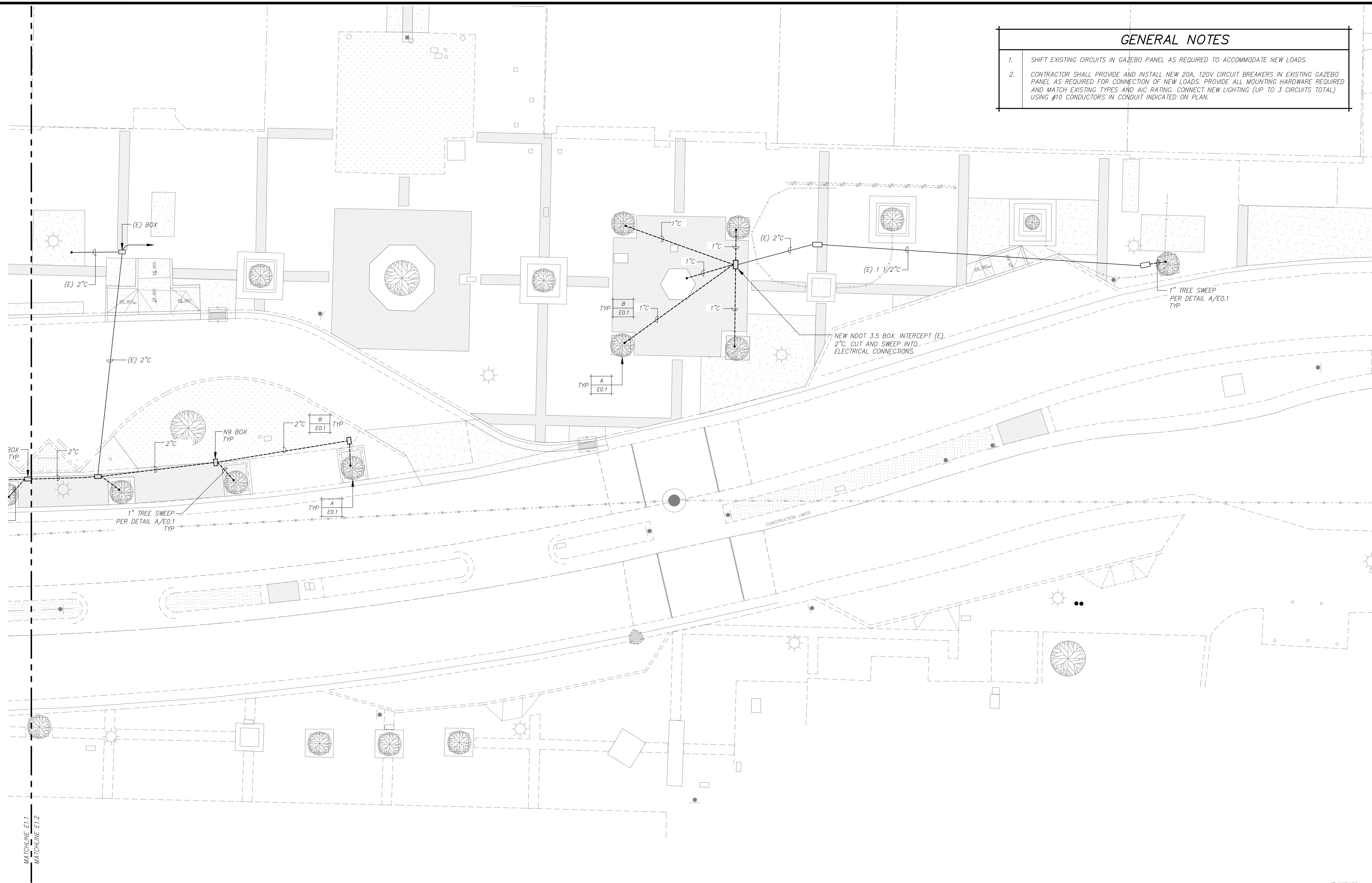

REV.	DATE	DESCRIPTION	BY	APP'D

CITY OF SPARKS  
VICTORIAN SQUARE INFRASTRUCTURE-PHASE 1  
SITE ELECTRICAL PLAN  
SPARKS WASHOE COUNTY NEVADA

DESIGNED BY: JPS  
CHECKED BY: JPS  
SCALE  
HORIZ: AS NOTED  
VERT: N/A  
JOB NO: 30263

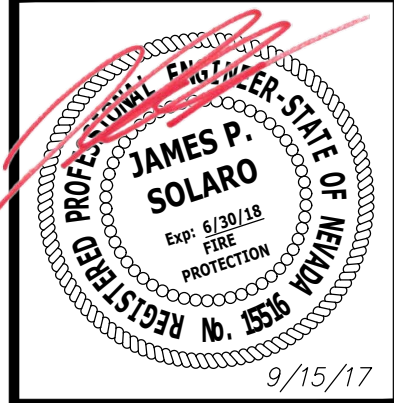

SHEET E1.2 OF 14

MATCHLINE E1.1  
MATCHLINE E1.2

A  
E1.2  
**SITE ELECTRICAL PLAN**  
SCALE: 1" = 20'-0"

