

# CIVIL IMPROVEMENT PLANS FOR CITY OF SPARKS PARKING LOT PROJECTS SPARKS WASHOE COUNTY NEVADA

## OWNER:



CITY OF SPARKS  
431 PRATER WAY  
SPARKS, NV 89431  
PHONE: (775) 353-2300

|                |       |                         |
|----------------|-------|-------------------------|
| GENO MARTINI   | ..... | MAYOR                   |
| STEVE DRISCOLL | ..... | CITY MANAGER            |
| JULIA RATTI    | ..... | CITY COUNCILMAN, WARD 1 |
| ED LAWSON      | ..... | CITY COUNCILMAN, WARD 2 |
| RON SMITH      | ..... | CITY COUNCILMAN, WARD 3 |
| CHARLENE BYBEE | ..... | CITY COUNCILMAN, WARD 4 |
| RON SCHMITT    | ..... | CITY COUNCILMAN, WARD 5 |

## SWPPP NOTES

**STANDARD NOTE No. 1**  
THE CONTRACTOR AND/OR THEIR AUTHORIZED AGENTS SHALL EACH DAY REMOVE ALL SEDIMENT, MUD, CONSTRUCTION DEBRIS, OR OTHER POTENTIAL POLLUTANTS THAT MAY HAVE BEEN DISCHARGED TO, OR ACCUMULATED IN, THE PUBLIC RIGHTS OF WAYS AS A RESULT OF CONSTRUCTION ACTIVITIES ASSOCIATED WITH THIS SITE DEVELOPMENT OR CONSTRUCTION PROJECT. SUCH MATERIALS SHALL BE PREVENTED FROM ENTERING THE STORM SEWER SYSTEM.

**STANDARD NOTE No. 2**  
ADDITIONAL CONSTRUCTION SITE DISCHARGE BEST MANAGEMENT PRACTICES MAY BE REQUIRED OF THE CONTRACTOR AND HIS OR HER AGENTS DUE TO UNFORESEEN EROSION PROBLEMS OR IF THE SUBMITTED PLAN DOES NOT MEET THE PERFORMANCE STANDARDS SPECIFIED IN THE TRUCKEE MEADOWS CONSTRUCTION SITE BEST MANAGEMENT PRACTICES HANDBOOK.

**STANDARD NOTE No. 3**  
TEMPORARY OR PERMANENT STABILIZATION PRACTICES WILL BE INSTALLED ON DISTURBED AREAS AS SOON AS PRACTICABLE AND NO LATER THAN 14 DAYS AFTER THE CONSTRUCTION ACTIVITY IN THAT PORTION OF THE SITE HAS TEMPORARILY OR PERMANENTLY CEASED. SOME EXCEPTIONS MAY APPLY; REFER TO STORM WATER GENERAL PERMIT NVR100000, SECTION 1.B.1.b.(2).

**STANDARD NOTE No. 4**  
AT A MINIMUM, THE CONTRACTOR OR HIS AGENT SHALL INSPECT ALL DISTURBED AREAS, AREAS USED FOR STORAGE OF MATERIALS AND EQUIPMENT THAT ARE EXPOSED TO PRECIPITATION, VEHICLE ENTRANCES AND EXIT LOCATIONS AND ALL BMPs WEEKLY, PRIOR TO A FORECASTED RAIN EVENT AND WITHIN 24 HOURS AFTER ANY ACTUAL RAIN EVENT. THE CONTRACTOR OR HIS AGENT SHALL UPDATE OR MODIFY THE STORM WATER POLLUTION PREVENTION PLAN AS

NECESSARY. SOME EXCEPTIONS TO WEEKLY INSPECTIONS MAY APPLY, SUCH AS FROZEN GROUND CONDITIONS OR SUSPENSION OF LAND DISTURBANCE ACTIVITIES. REFER TO STORM WATER GENERAL PERMIT NVR100000, SECTION 1.B.1.g.

**STANDARD NOTE No. 5**  
ACCUMULATED SEDIMENT IN BMPs SHALL BE REMOVED WITHIN SEVEN DAYS AFTER A STORMWATER RUNOFF EVENT OR PRIOR TO THE NEXT ANTICIPATED STORM EVENT WHICH EVER IS EARLIER. SEDIMENT MUST BE REMOVED WHEN BMP DESIGN CAPACITY HAS BEEN REDUCED BY 50 PERCENT OR MORE.

**ADDITIONAL NOTE No. 8**  
PRIOR TO THE START OF CONSTRUCTION, THE CONTRACTOR SHALL HAVE IN PLACE ALL NECESSARY BEST MANAGEMENT PRACTICES THAT SHALL BE USED TO MINIMIZE DUST, PREVENT EROSION, AND PREVENT POLLUTION LADEN RUNOFF FROM ENTERING THE ADJACENT STORM DRAIN FACILITIES. BMPs MAY INCLUDE, BUT NOT BE LIMITED TO, THE FOLLOWING BMPs: (1) SILT FENCING OR STRAW WADDLES AT THE DOWNHILL LIMITS OF GRADING, (2) STABILIZED CONSTRUCTION SITE ENTRY/EXIT, (3) PERMANENT SLOPE REVEGETATION ON ALL DISTURBED AREAS, (4) INLET PROTECTION AT EXISTING CATCH BASINS, (5) STOCKPILE MANAGEMENT BMPs, (6) DUST CONTROL BMPs, (7) A CONCRETE WASHOUT AREA. THE CONTRACTOR SHALL MAINTAIN, REPAIR, REPLACE, SUBSTITUTE, OR SUPPLEMENT BMPs AT THE CONSTRUCTION SITE AS CONDITIONS WARRANT DURING CONSTRUCTION.

**ADDITIONAL NOTE No. 7**  
ALL BEST MANAGEMENT PRACTICES (BMPs) SHALL BE IN ACCORDANCE WITH THE "THE TRUCKEE MEADOWS CONSTRUCTION SITE BEST MANAGEMENT PRACTICES HANDBOOK, DATED JUNE 2008".

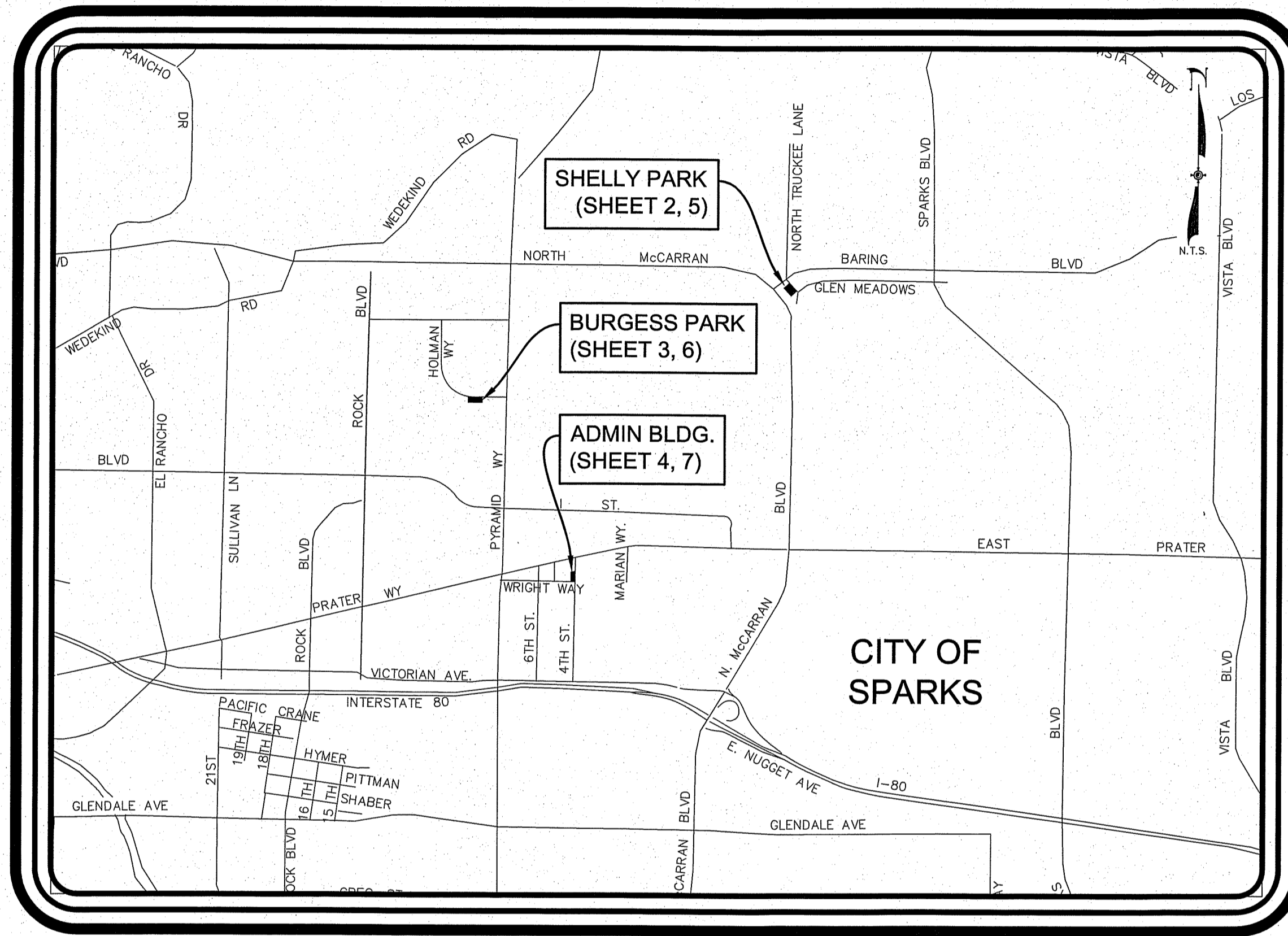

**VICINITY MAP**  
N.T.S.

## GENERAL NOTES

- THE CONTRACTOR SHALL BE RESPONSIBLE FOR ANY DAMAGE TO EXISTING ROADS, BUILDINGS, OR OTHER STRUCTURES RESULTING FROM OR THROUGH CONSTRUCTION ACTIVITIES. REPAIRS SHALL BE MADE TO THE SATISFACTION OF THE AGENCY AND AT NO COST TO THE OWNER. THE CONTRACTOR IS ALSO RESPONSIBLE FOR REPAIRS TO EXISTING LANDSCAPING OR SPECIAL HARDSCAPE FEATURES (I.E., STAMPED CONCRETE, BRICK, DURASTONE, ETC.) DAMAGED BY OR THROUGH CONSTRUCTION ACTIVITIES. REPAIRS SHALL BE MADE TO THE SATISFACTION OF THE DESIGN ENGINEER. THE CONTRACTOR SHALL CONFINE HIS ACTIVITIES TO WITHIN THE LIMITS OF CONSTRUCTION. ALL AREAS DISTURBED BY THE CONTRACTOR OR THROUGH HIS/HER CONSTRUCTION ACTIVITIES SHALL BE RESTORED TO THEIR NATURAL OR BETTER CONDITION. THE CONTRACTOR SHALL RECEIVE NO PAYMENT FOR SUCH RESTORATION.
- THE CONTRACTOR SHALL IMMEDIATELY NOTIFY THE DESIGN ENGINEER OF DISCREPANCIES BETWEEN THE INFORMATION SHOWN ON THESE DRAWINGS AND THE CONDITIONS EXISTING IN THE FIELD. ANYTHING MENTIONED IN THE SPECIFICATIONS AND NOT SHOWN ON THESE DRAWINGS, OR SHOWN ON THE DRAWINGS AND NOT MENTIONED IN THE SPECIFICATIONS SHALL BE OF LIKE EFFECT AS IF SHOWN OR MENTIONED IN BOTH. IF THE CONTRACTOR FAILS TO NOTIFY THE DESIGN ENGINEER IN A TIMELY MANNER OF ANY APPARENT ERROR OR OMISSION ON THE PLANS OR IN THE SPECIFICATIONS, THE CONTRACTOR WILL BE RESPONSIBLE FOR CORRECTING WORK INCORRECTLY DONE AT THE CONTRACTOR'S EXPENSE.
- ALL CONSTRUCTION MATERIALS AND PRACTICES SHALL CONFORM TO THE STANDARD SPECIFICATIONS FOR PUBLIC WORKS CONSTRUCTION (LATEST EDITION THROUGH 2012 UPDATES), STANDARD DETAILS FOR PUBLIC WORKS CONSTRUCTION, SPECIAL PROVISIONS AND THESE PLANS AND SPECIFICATIONS, AND ALL SAFETY REGULATIONS AND CODES PERTINENT TO THE PROJECT CONSTRUCTION.
- PAYMENT FOR WORK SHOWN ON THESE PLANS EITHER SPECIFIED OR INFERRED, BUT NOT INCLUDED IN THE BID PROPOSAL SHALL BE CONSIDERED AS INCLUDED IN THE PRICE PAID FOR OTHER ITEMS OF WORK.
- THE CONTRACTOR SHALL BE RESPONSIBLE FOR ENSURING THAT ALL MANHOLE RIMS, UTILITY COVERS, AND SURVEY MONUMENTS WITHIN THE CONSTRUCTION LIMITS ARE SET IN ACCORDANCE WITH MANHOLE COLLAR, UTILITY VALVE, AND SURVEY MONUMENT DETAILS.
- THE CONTRACTOR SHALL BE RESPONSIBLE FOR OBTAINING WATER FOR HIS NEEDS, AS WELL AS STAGING AREA LOCATIONS. THE CONTRACTOR SHALL BE RESPONSIBLE FOR JOB SITE SECURITY FOR MATERIALS, SUPPLIES, EQUIPMENT, ETC., THROUGHOUT THE DURATION OF THE CONTRACT. ALL MATERIALS, WHETHER IN TRANSIT, STORED ON SITE OR INSTALLED AWAITING FINAL ACCEPTANCE ARE THE PROPERTY OF THE CONTRACTOR. ALL LOSS OR DAMAGE TO THE MATERIALS, UNTIL ACCEPTANCE, IS THE RESPONSIBILITY OF THE CONTRACTOR AND MUST BE REPAIRED OR REPLACED AT THE CONTRACTOR'S EXPENSE.
- THE LOCATION OF EXISTING UTILITIES SHOWN ON THE PLANS ARE APPROXIMATE ONLY AND INDICATE GENERALLY THEIR LOCATION ACCORDING TO THE BEST KNOWLEDGE OF THE DESIGN ENGINEER. THE CONTRACTOR SHALL NOTIFY UTILITY COMPANIES NOT LESS THAN FIVE WORKING DAYS PRIOR TO THE START OF CONSTRUCTION TO VERIFY THE LOCATION AND DEPTHS OF UTILITIES. THE CONTRACTOR SHALL CALL UNDERGROUND SERVICES ALERT AT 1-800-227-2600 PRIOR TO COMMENCING ANY EXCAVATION ACTIVITIES FOR UTILITY LOCATION. ANY DAMAGE TO UTILITIES CAUSED BY OPERATIONS OF THE CONTRACTOR SHALL BE REPAIRED BY THE CONTRACTOR AT NO COST TO THE OWNER. THE CONTRACTOR SHALL SUBMIT TO THE DESIGN ENGINEER, A LIST OF UTILITY APPURTENANCES ENCOUNTERED DURING CONSTRUCTION INDICATING STATION AND OFFSET.
- SUBSURFACE UTILITIES ARE DEPICTED BY THEIR QUALITY LEVELS IN ACCORDANCE AMERICAN SOCIETY OF CIVIL ENGINEERS STANDARD GUIDELINES FOR THE COLLECTION AND DEPICTION OF EXISTING SUBSURFACE UTILITY DATE (CIASCE 38-02). ALL UTILITY INFORMATION SHOWN HEREON IS DEPICTED TO QUALITY "C" UNLESS OTHERWISE NOTED.
- DESIGN GRADES SHOWN FOR PEDESTRIAN RAMPS ARE BASED UPON THE BEST INFORMATION AVAILABLE TO THE ENGINEER, BUT MUST BE CONSIDERED APPROXIMATE. THE CONTRACTOR IS RESPONSIBLE FOR VERIFYING THAT PEDESTRIAN RAMP SLOPES WITHIN THE LIMITS OF CONSTRUCTION OF THIS PROJECT ARE COMPLIANT WITH THE APPLICABLE DETAILS. AT ALL POINTS WHERE PEDESTRIAN RAMPS TIE-IN TO EXISTING FACILITIES, GRADES SHALL MATCH TO PROVIDE SMOOTH, CONTINUOUS TRANSITIONS FROM RECONSTRUCTED IMPROVEMENTS TO EXISTING IMPROVEMENTS. DISCREPANCIES BETWEEN ACTUAL FIELD CONDITIONS AND THESE PLANS WHICH MAY PREVENT COMPLIANT STRUCTURES FROM BEING CONSTRUCTED SHALL BE CALLED TO THE ATTENTION OF THE DESIGN ENGINEER IMMEDIATELY.
- DURING THE ENTIRE DURATION OF THIS CONSTRUCTION CONTRACT, THE CONTRACTOR SHALL IMPLEMENT STRINGENT DUST CONTROL MEASURES IN ACCORDANCE WITH CITY OF SPARKS AND WASHOE COUNTY HEALTH DEPARTMENT RULES AND REGULATIONS. THE CONTRACTOR IS REQUIRED TO SUPPRESS DUST AT ALL TIMES, 24 HOURS A DAY, REGARDLESS OF WHEN CONSTRUCTION ACTIVITIES ARE OCCURRING. THE CONTRACTOR IS REQUIRED TO HAVE AN APPROVED SWPPP PRIOR TO START OF CONSTRUCTION.
- PLANTMIX BITUMINOUS PAVEMENT IS TO BE LAID IN LIFTS NOT TO EXCEED THREE INCHES PER LIFT.
- THE CONTRACTOR SHALL BE RESPONSIBLE FOR ALL Dewatering OPERATIONS, IF REQUIRED, INCLUDING EXPLORATION, DESIGN, ENGINEERING, PERMITTING, INSTALLATION, OPERATION AND CLOSURE METHODS AND OPERATION SHALL BE SUBJECT TO THE ENGINEER'S APPROVAL AND ANY CONDITIONS OR REVIEWING AND PERMITTING AGENCIES.
- THE CONTRACTOR SHALL BE RESPONSIBLE FOR ALL NECESSARY EXCAVATION SUPPORT SYSTEMS INCLUDING SHORING. SHORING DESIGN SHALL BE PREPARED BY A NEVADA P.E. AND SHALL BE SUBJECT TO REVIEW AND APPROVAL BY THE ENGINEER.
- SHOULD ANY PREHISTORIC OR HISTORIC REMAINS/ARTIFACTS BE DISCOVERED DURING SITE DEVELOPMENT, WORK SHALL TEMPORARILY BE HALTED AT THE SPECIFIC SITE AND THE STATE HISTORIC PRESERVATION OFFICE OF THE DEPARTMENT OF MUSEUMS, LIBRARY, AND ARTS, SHALL BE NOTIFIED TO RECORD AND PHOTOGRAPH THE SITE. THE PERIOD OF TEMPORARY DELAY SHALL BE LIMITED TO A MAXIMUM OF TWO (2) WORKING DAYS FROM THE DATE OF NOTIFICATION.
- CONTRACTOR SHALL PROVIDE A "MANHOLE PROTECTION PLAN" PRIOR TO START OF PROJECT. PLAN SHALL INCLUDE DESCRIPTION AND METHOD OF SYSTEM AND/OR DEVICES TO BE INSTALLED IN ALL SEWER / STORM DRAIN / UTILITY MANHOLES AT ANY TIME THEY ARE EXPOSED (RAISING, LOWERING, ETC.) TO PREVENT AND CONTAIN ANY DEBRIS FROM ENTERING THE PIPING SYSTEM. CONTAINMENT DEVICE SHALL PROVIDE FOR COMPLETELY CAPTURING, AND RETRIEVING ALL DEBRIS, PRIOR TO REPLACING TEMPORARY OR PERMANENT MANHOLE COVERS. UPON PROJECT COMPLETION, ALL MANHOLES AND CATCH BASINS SHALL BE INSPECTED, AND VERIFIED BY INSPECTOR FOR APPROVAL.
- CONTRACTOR SHALL BE RESPONSIBLE FOR PROVIDING A SUITABLE SEWER VACUUM (VACUUM) TRUCK TO REMOVE CONSTRUCTION MATERIALS FROM MANHOLES, CATCH BASINS AND PIPES. EMERGENCY PHONE CONTACT NUMBER SHALL BE PROVIDED WITH EMERGENCY CONTACTS.
- ALL SURVEY MONUMENTS TO BE REPLACED. ANY SURVEY WELL MONUMENTS WITHIN PROJECT LIMITS SHALL BE REPLACED BY P.L.S., PER 334.0 ORANGE BOOK, NRS AND STANDARD DETAIL R-124. "ADJUST OR PROTECT IN PLACE" WILL NOT BE ALLOWED.

## ENGINEER:



## SHEET INDEX

- TITLE SHEET
- SITE PLAN - SHELLY PARK
- SITE PLAN - BURGESS PARK
- SITE PLAN - ADMIN. BUILDING
- GRADING PLAN - SHELLY PARK
- GRADING PLAN - BURGESS PARK
- GRADING PLAN - ADMIN. BUILDING
- DETAIL SHEET
- DETAIL SHEET

## BASIS OF BEARINGS

NORTH AMERICAN DATUM OF 1983 AS BASED ON FEDERAL BASE NETWORK/COOPERATIVE BASE NETWORK OBSERVATIONS IN 1994 (AKA NAD83/94), NEVADA STATE PLANE WEST ZONE AS DETERMINED WITH REAL TIME KINEMATIC (RTK) GPS OBSERVATIONS WITH CORRECTIONS TRANSMITTED BY WASHOE COUNTY CONTINUOUSLY OPERATING REFERENCE STATION (CORS) STATION "NVRENO". GROUND COORDINATES HEREON REFLECT GRID COORDINATES MULTIPLIED BY A COMBINED GRID TO GROUND FACTOR OF 1.000197939.

## BASIS OF ELEVATION

NORTH AMERICAN VERTICAL DATUM OF 1988 (NAVD88) PER CITY OF SPARKS BENCHMARK NUMBER 77 TAKEN AS THE PUBLISHED ELEVATION OF 4407.56 BEING A 1.5" DIAMETER STEEL CAP SET IN THE TOP OF CURB AT THE NORTHEAST CORNER OF THE INTERSECTION OF EAST PRATER WAY AND STANDARD WAY BEING 2' EASTERLY OF THE SOUTH RETURN ON EAST PRATER WAY

## SPECIFICATIONS

ALL CONSTRUCTION SHALL CONFORM TO THE LATEST EDITION OF THE STANDARD SPECIFICATIONS FOR PUBLIC WORKS CONSTRUCTION (AND ANY APPURTENANT SUPPLEMENTS), SPONSORED AND DISTRIBUTED BY RENO, SPARKS, AND WASHOE COUNTY, AND THE SPECIAL PROVISIONS, GENERAL CONDITIONS, TECHNICAL SPECIFICATIONS, AND OTHER CONTRACT DOCUMENTS.

## ENGINEER'S STATEMENT

THESE PLANS HAVE BEEN PREPARED IN ACCORDANCE WITH ACCEPTED ENGINEERING PROCEDURES AND GUIDELINES, AND ARE IN SUBSTANTIAL COMPLIANCE WITH APPLICABLE STATUTES, CITY ORDINANCES, AND CODES. IN THE EVENT OF CONFLICT BETWEEN ANY PORTION OF THESE PLANS AND CITY CODES, THE CITY CODES SHALL PREVAIL.

CLINTON G. THIESSE  
P.E. #6159  
5/11/16

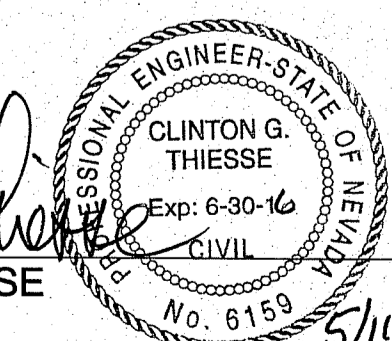

P.E. #6159

| REV. | DATE | DESCRIPTION | BY | APPD |
|------|------|-------------|----|------|
|      |      |             |    |      |
|      |      |             |    |      |
|      |      |             |    |      |
|      |      |             |    |      |
|      |      |             |    |      |
|      |      |             |    |      |
|      |      |             |    |      |
|      |      |             |    |      |
|      |      |             |    |      |

CIVIL IMPROVEMENT PLANS FOR  
CITY OF SPARKS PARKING LOT PROJECTS  
TITLE SHEET  
WASHOE COUNTY  
SPARKS  
NEVADA

DESIGNED BY: CGT  
CHECKED BY:  
SCALE  
HORIZ: N.T.S.  
VERT: N.T.S.  
JOB NO: 30302

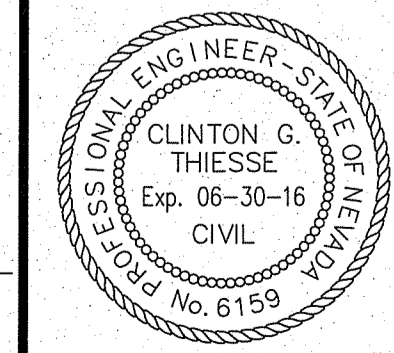

SHEET  
1 OF 9

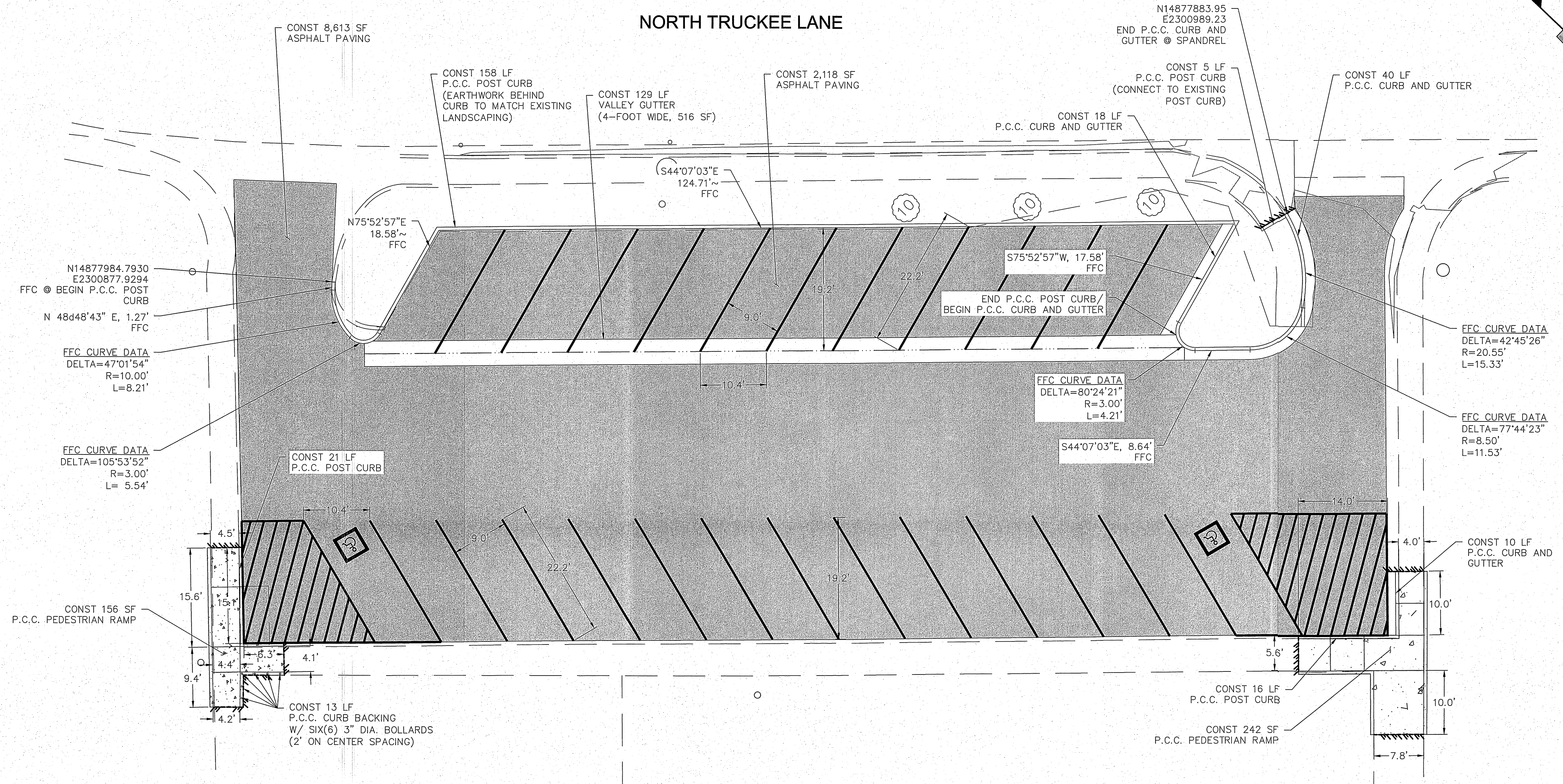
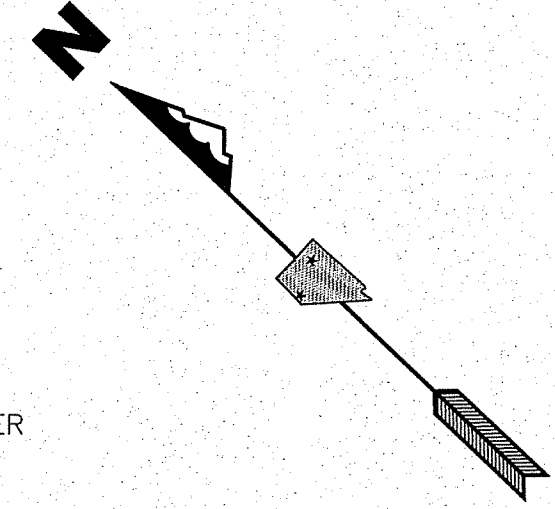

**ABBREVIATIONS**

|        |  |        |                            |      |                                |
|--------|--|--------|----------------------------|------|--------------------------------|
| ±      | APPROXIMATE                              | G      | GAS                        | RP   | REFERENCE POINT                |
| AC     | ASPHALTIC CONCRETE                       | GB     | GRADE BREAK                | RT   | RIGHT                          |
| ACP    | ASBESTOS CEMENT PIPE                     | GV     | GAS VALVE                  | RTW  | RIGHT-OF-WAY                   |
| AP     | ANGLE POINT                              | HORIZ  | HORIZONTAL                 | S    | SLOPE                          |
| ASTM   | AMERICAN SOCIETY PER TESTING & MATERIALS | HPS    | HANDICAP SPACE             | SD   | STORM DRAIN                    |
| BC     | BEGIN CURVE                              | HS     | HOUSE SERVICE              | SDMH | STORM DRAIN MANHOLE            |
| BS     | BACK OF SIDEWALK                         | IE     | INVERT ELEVATION           | SHT  | SHEET                          |
| BVC    | BEGIN VERTICAL CURVE                     | ID     | INSIDE DIAMETER            | S/O  | STATION AND OFFSET LINE        |
| BW     | BACK OF SIDEWALK                         | INT    | INTERSECTION               | SS   | SANITARY SEWER                 |
| CAP    | CAPACITY                                 | L      | LENGTH                     | STA  | STATION                        |
| CB     | CATCH BASIN                              | LF     | LINEAL FEET                | STD  | STANDARD                       |
| CH     | CHORD                                    | LIP    | LIP OF GUTTER              | SUB  | SUB-BASIN                      |
| CI     | CAST IRON                                | LOC    | LIMITS OF CONSTRUCTION     | SW   | SIDEWALK                       |
| CL     | CENTERLINE                               | LT     | LEFT                       | T    | TANGENT                        |
| CMP    | CORRUGATED METAL PIPE                    | M.D.D. | MAXIMUM DRY DENSITY        | TEL  | TELEPHONE                      |
| COND   | CONCRETE                                 | MISC.  | MISCELLANEOUS              | TBC  | TOP BACK OF CURB               |
| CONST. | CONSTRUCT                                | MH     | MANHOLE                    | TC   | TOP OF CURB                    |
| C.O.S. | CITY OF SPARKS                           | NOS.   | NUMBERS                    | TDC  | TOP OF DEPRESSED CURB          |
| CP     | CONCRETE PIPE                            | N.T.S. | NOT TO SCALE               | THRU | THROUGH                        |
| CR     | CURB RETURN                              | O.D.   | OUTSIDE DIAMETER           | TP   | TEST PIT                       |
| DET    | DETAIL                                   | PROP.  | PROPOSED                   | TW   | TOP OF WALL                    |
| DI     | DIAMETER                                 | P      | PAVEMENT                   | TYP  | TYPICAL                        |
| DIA    | DIAMETER                                 | PB     | PULL BOX                   | VC   | VERTICAL CURVE                 |
| DIM.   | DIMENSION                                | P.C.C. | PORTLAND CEMENT CONCRETE   | VG   | VALLEY GUTTER                  |
| DWG    | DRAWING                                  | PE     | PEDESTRIAN                 | VERT | VERTICAL                       |
| DWY    | DRIVEWAY                                 | PI     | POINT OF INTERSECTION      | VPI  | VERTICAL POINT OF INTERSECTION |
| E      | ELECTRICAL                               | PL     | PROPERTY LINE              | W    | WATER                          |
| EC     | END OF CURVE                             | P.L.C. | PROFESSIONAL LAND SURVEYOR | WV   | WATER VALVE                    |
| EG     | EXISTING GRADE                           | PM     | PARCEL MAP                 | WV   | WATER VALVE WITH               |
| ELEV   | ELEVATION                                | POT    | POINT OF TANGENT           |      |                                |
| EVC    | END OF VERTICAL CURVE                    | PRC    | POINT OF REVERSE CURVATURE |      |                                |
| (E)    | EXISTING                                 | PROP.  | PROPOSED                   |      |                                |
| EX.    | EXISTING                                 | PS     | PARKING SPACE              |      |                                |
| EXIST. | EXISTING                                 | PUE    | PUBLIC UTILITY EASEMENT    |      |                                |
| FES    | FLARED END SECTION                       | PVC    | POLYVINYL CHLORIDE PIPE    |      |                                |
| FF     | FINISHED FLOOR                           | Q      | VOLUMETRIC FLOW RATE       |      |                                |
| FFC    | FRONT FACE OF CURB                       | (R)    | RADIAL                     |      |                                |
| FG     | FINISHED GRADE                           | R      | RADIUS                     |      |                                |
| FH     | FIRE HYDRANT                             | RCP    | REINFORCED CONCRETE PIPE   |      |                                |
| FL     | FLOW LINE                                | REF.   | REFERENCE                  |      |                                |
| FW     | FRONT OF SIDEWALK                        | RET    | CURB/SIDEWALK/WALL RETURN  |      |                                |
|        |  | REQ    | REQUIRED                   |      |                                |

**LEGEND**

|     |     |                           |  |                               |
|-----|-----|---------------------------|--|-------------------------------|
| --- | X   | EX. FENCE LINE            |  | EX. CATCH BASIN / DROP INLET  |
| --- | W   | EX. WATERLINE             |  | PROP. CATCH BASIN             |
| --- | IRR | EX. IRRIGATION LINE       |  | EX. POWER POLE                |
| --- | G   | EX. GAS LINE              |  | MANHOLE (HOLLOW IF EXISTING)  |
| --- | SS  | EX. SANITARY SEWER LINE   |  | SIGN                          |
| --- | SD  | EX. STORM DRAIN LINE      |  | CONCRETE REMOVAL / PLACEMENT  |
| --- | SD  | PROP. STORM DRAIN LINE    |  | UTILITY VALVE (WATER AND GAS) |
| --- | OE  | EX. OVER HEAD POWER LINE  |  | SURVEY MONUMENT               |
| --- | E   | EX. UNDER GROUND ELECTRIC |  | CITY OF SPARKS BENCHMARK      |
| --- | FOC | EX. FIBER OPTICS LINE     |  | EX. UTILITY VAULT             |
| --- |     | EX. R/W AND PROPERTY LINE |  | EX. FIRE HYDRANT              |
| --- |     | CONSTRUCTION CENTERLINE   |  | PROP. LIGHT POLE              |
| --- |     | FLOW LINE                 |  | EX. LIGHT POLE                |
| --- |     | SAW CUT / LIMITS          |  | PROP. GRADE                   |
| --- |     | EX. MINOR CONTOUR         |  | EX. GRADE                     |
| --- |     | EX. MAJOR CONTOUR         |  | EX. SLOPE AND DIRECTION       |
| --- |     | EX. FRONT/BACK CURB FACE  |  | PROP. SLOPE AND DIRECTION     |
| --- |     | EX. EDGE OF PAVEMENT      |  |                               |
| --- |     | EX. BACK OF WALK          |  |                               |

**BID SET**

| REV. | DATE | DESCRIPTION | BY | APP'D |
|------|------|-------------|----|-------|
|      |      |             |    |       |
|      |      |             |    |       |
|      |      |             |    |       |
|      |      |             |    |       |

CIVIL IMPROVEMENT PLANS FOR  
 CITY OF SPARKS PARKING LOT PROJECTS  
 SITE PLAN ~ SHELLY PARK  
 SPARKS WASHOE COUNTY NEVADA

DESIGNED BY: CGT  
 CHECKED BY:  
 SCALE  
 HORIZ: 1"=10'  
 VERT: 1"=1'  
 JOB NO: 30302  
 CLINTON G. THIESSE  
 Exp. 06-30-16  
 CIVIL  
 No. 6159



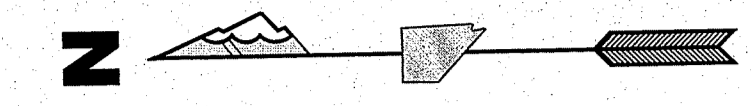

SCALE: 1"=10'

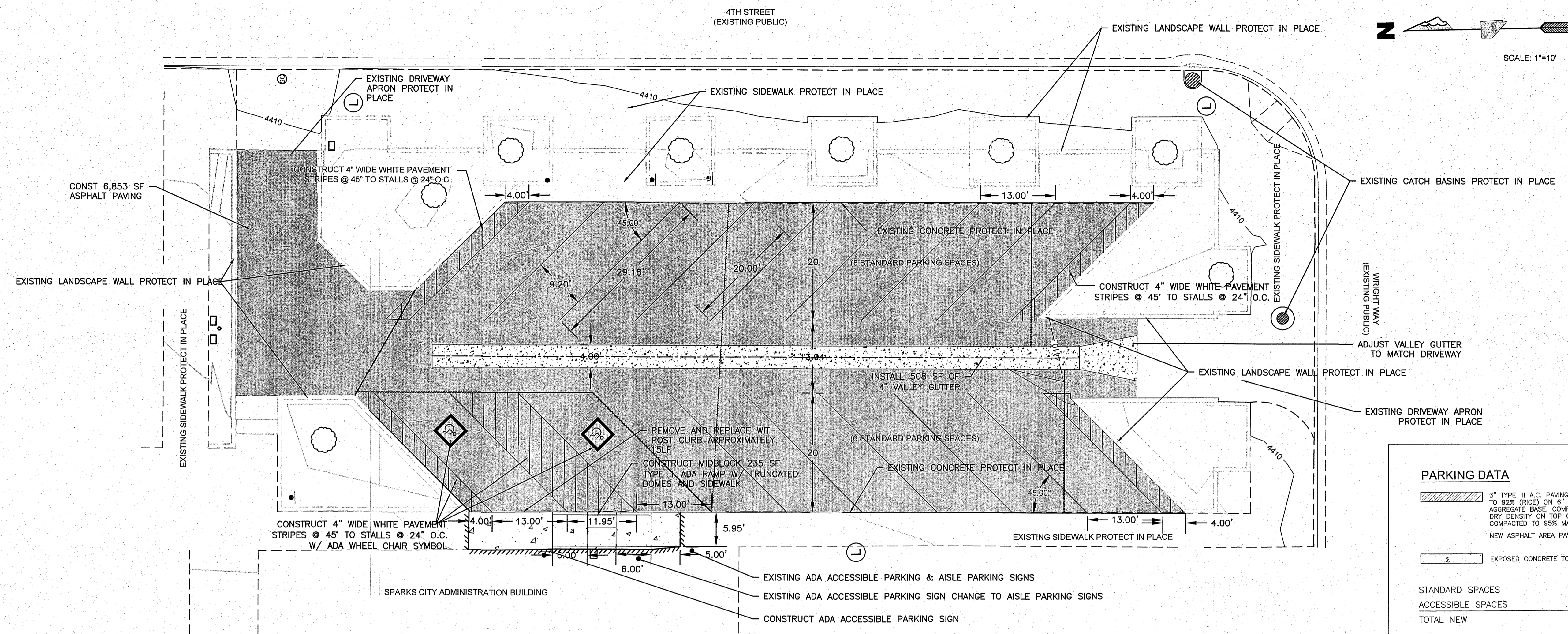

**PARKING DATA**

3" TYPE III A.C. PAVING COMPACTED TO 92% (RICE) ON 6" TYPE II CLASS B AGGREGATE BASE, COMPACTED TO 95% MAX DRY DENSITY ON TOP OF 6" OF SUBGRADE COMPACTED TO 95% MAX. DRY DENSITY  
 NEW ASPHALT AREA PAVING = 6,858 SQ. FT.

EXPOSED CONCRETE TO BE 4000 PSI

|                   |    |
|-------------------|----|
| STANDARD SPACES   | 14 |
| ACCESSIBLE SPACES | 2  |
| TOTAL NEW         | 16 |

BID SET

Avoid cutting underground utility lines. It's costly.  
 Call before you Dig  
 1-800-227-2600  
 UNDERGROUND SERVICE (USA)

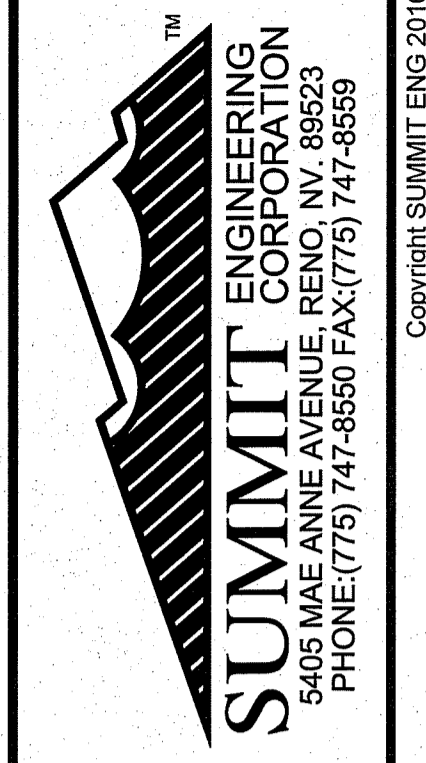

| REV. | DATE | DESCRIPTION | BY | APPD |
|------|------|-------------|----|------|
|      |      |             |    |      |
|      |      |             |    |      |
|      |      |             |    |      |
|      |      |             |    |      |

**CIVIL IMPROVEMENT PLANS FOR**  
**CITY OF SPARKS PARKING LOT PROJECTS**  
**SITE PLAN ~ ADMIN BUILDING**  
 SPARKS WASHOE COUNTY NEVADA

DESIGNED BY: CGT  
 CHECKED BY:  
 SCALE  
 HORIZ: 1"=10'  
 VERT: N/A  
 JOB NO: 30373

Copyright SUMMIT ENG 2016  
 N:\DWG\SL\30302\_SparkCity\ADMIN\SURVEY\TOPO\_20160216\_ACAD.DWG - 10:08 AM - 15-APR-2016

**NORTH TRUCKEE LANE**

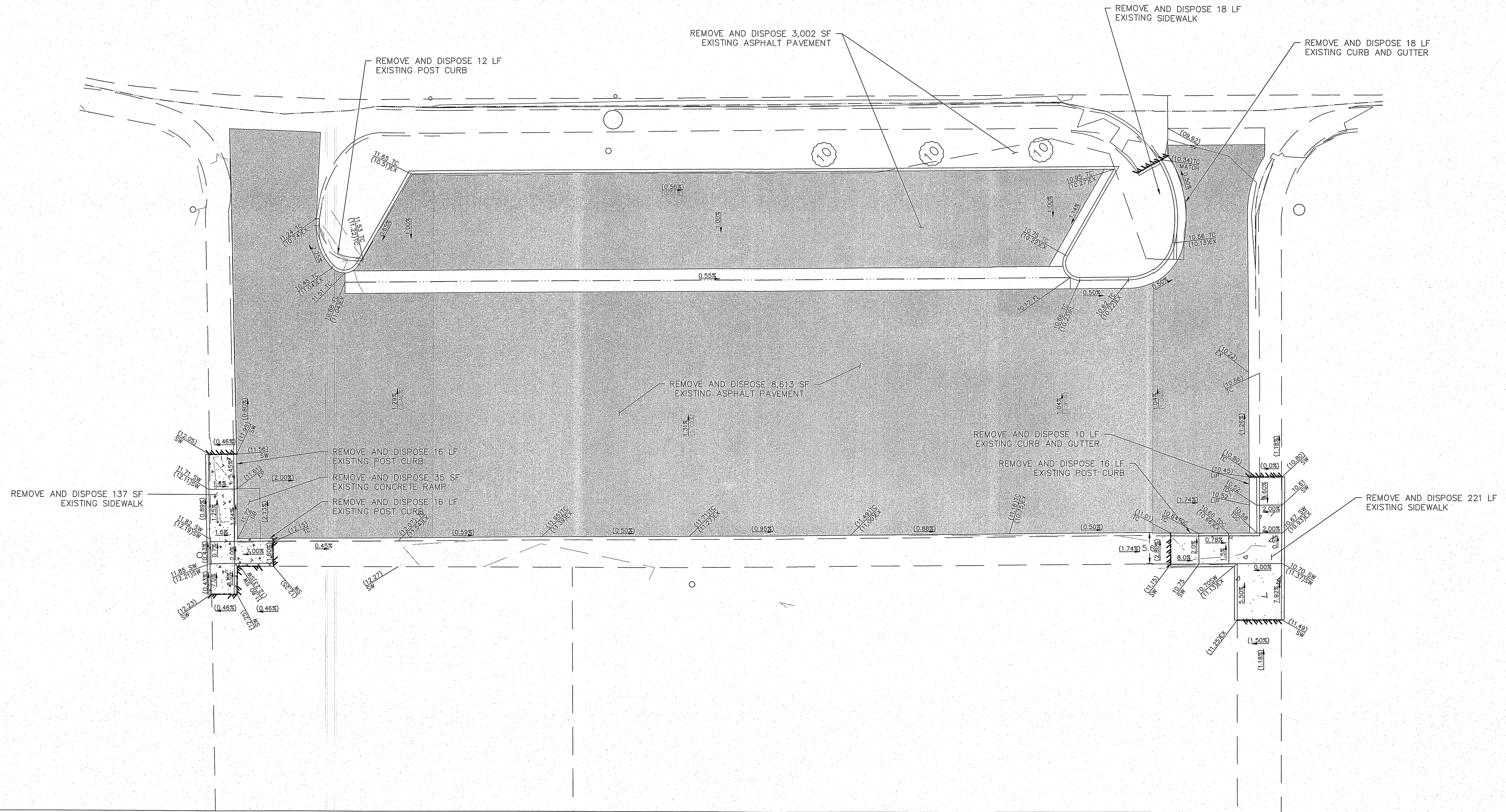

**BID SET**

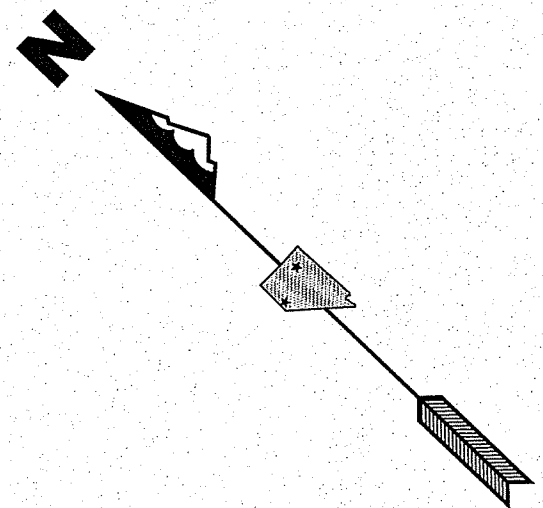

| REV. | DATE | DESCRIPTION | BY | APP'D |
|------|------|-------------|----|-------|
|      |      |             |    |       |
|      |      |             |    |       |
|      |      |             |    |       |
|      |      |             |    |       |
|      |      |             |    |       |
|      |      |             |    |       |
|      |      |             |    |       |
|      |      |             |    |       |
|      |      |             |    |       |

CIVIL IMPROVEMENT PLANS FOR  
CITY OF SPARKS PARKING LOT PROJECTS  
GRADING PLAN ~ SHELLY PARK  
SPARKS WASHOE COUNTY NEVADA

DESIGNED BY: CGT  
CHECKED BY:  
SCALE  
HORIZ: 1"=10'  
VERT: 1"=1'  
JOB NO: 30302

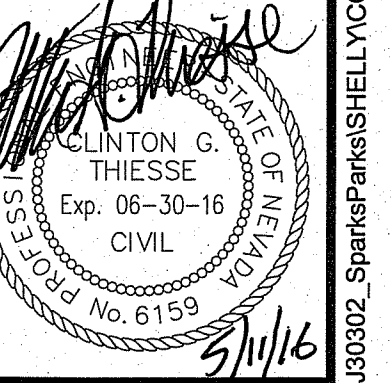

SHEET 5 OF 9

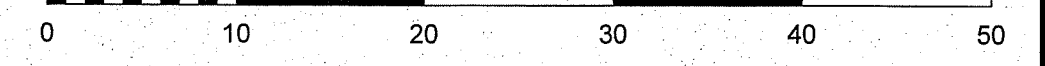

Copyright SUMMIT ENG 2016

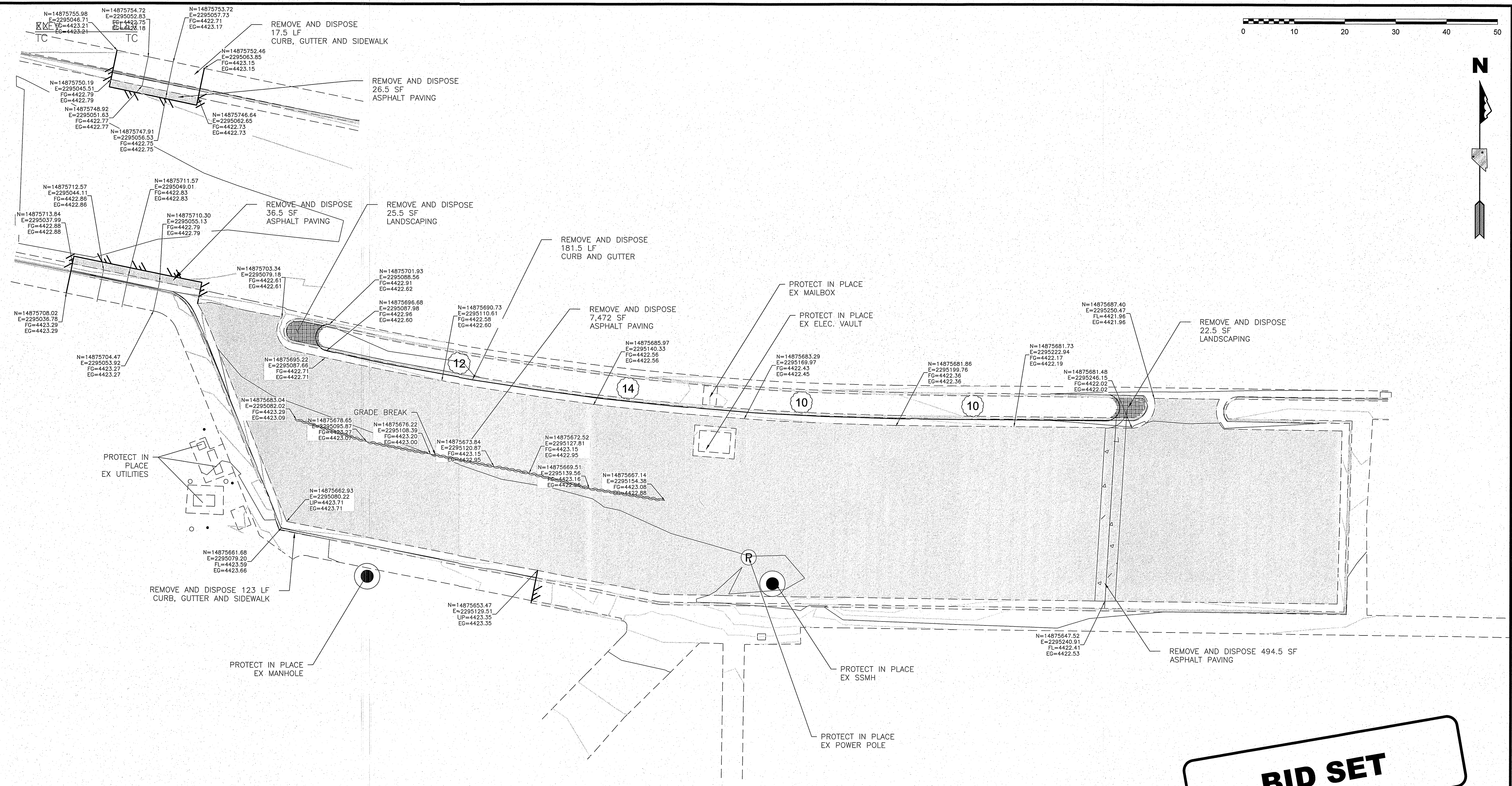

**BID SET**

| REV. | DATE | DESCRIPTION | BY | APPD |
|------|------|-------------|----|------|
|      |      |             |    |      |
|      |      |             |    |      |
|      |      |             |    |      |

CIVIL IMPROVEMENT PLANS FOR  
 CITY OF SPARKS PARKING LOT PROJECTS  
 GRADING PLAN ~ BURGESS PARK  
 SPARKS WASHOE COUNTY NEVADA

DESIGNED BY: MF  
 CHECKED BY: CGT  
 SCALE  
 HORIZ: 1"=10'  
 VERT: N/A

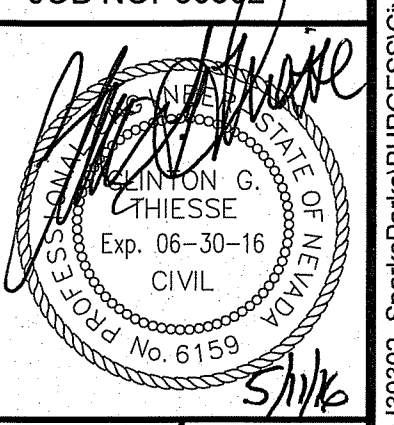

SHEET 6 OF 9

N:\DWGS\30302\_SparksPark\BURGESS\Civil\Burgess\_Emap.DWG - 1:12 PM 125-APR-2016



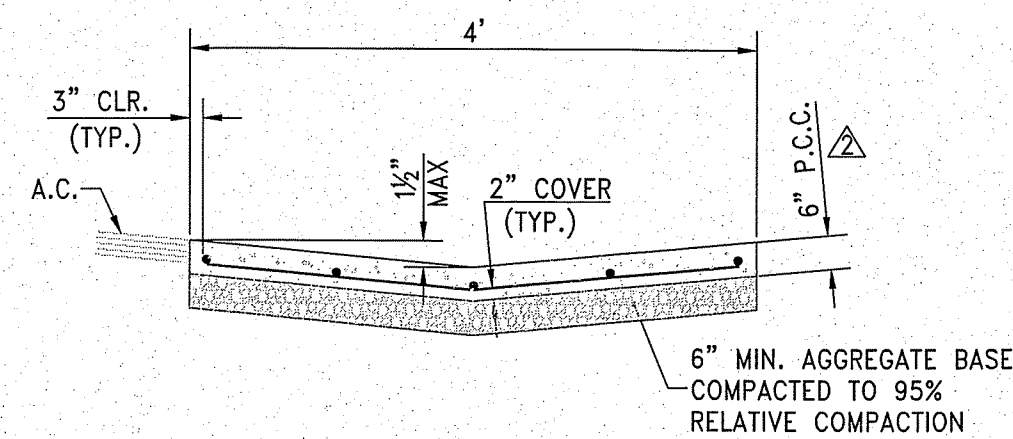

**NOTES:**

- FIBER-REINFORCED PORTLAND CEMENT CONCRETE (P.C.C.) SHALL HAVE THE FOLLOWING CHARACTERISTICS: 4000 PSI MIN. COMPRESSIVE STRENGTH AT 28 DAYS, MIN. 6 SACKS OF CEMENT PER CUBIC YARD WITH MAX. WATER-CEMENT RATIO OF 0.45, AIR ENTRAINMENT 6% ±1.5%, SLUMP CURB AT 1 TO 4 INCHES. MIX DESIGN SHALL CONFORM TO THE REQUIREMENTS OF SECTION 337 OF STANDARD SPECIFICATIONS OF PUBLIC WORKS CONSTRUCTION (SSPWC). CEMENT SHALL BE TYPE II. ALL CEMENT CONCRETE SHALL HAVE A COARSE AGGREGATE GRADATION CONFORMING TO SIZE NO. 67. POLYPROPYLENE OR CELLULOSE FIBERS SHALL BE ADDED TO THE P.C.C. AT 1.5 LBS. PER CUBIC YARD. ALL MATERIALS SHALL CONFORM TO SSPWC.
- AGGREGATE BASE MATERIAL UNDER SIDEWALKS SHALL BE TYPE 2, CLASS B CRUSHED AGGREGATE BASE. MATERIALS SHALL CONFORM TO SSPWC SECTION 200.

**LONGITUDINAL P.C.C. VALLEY GUTTER**

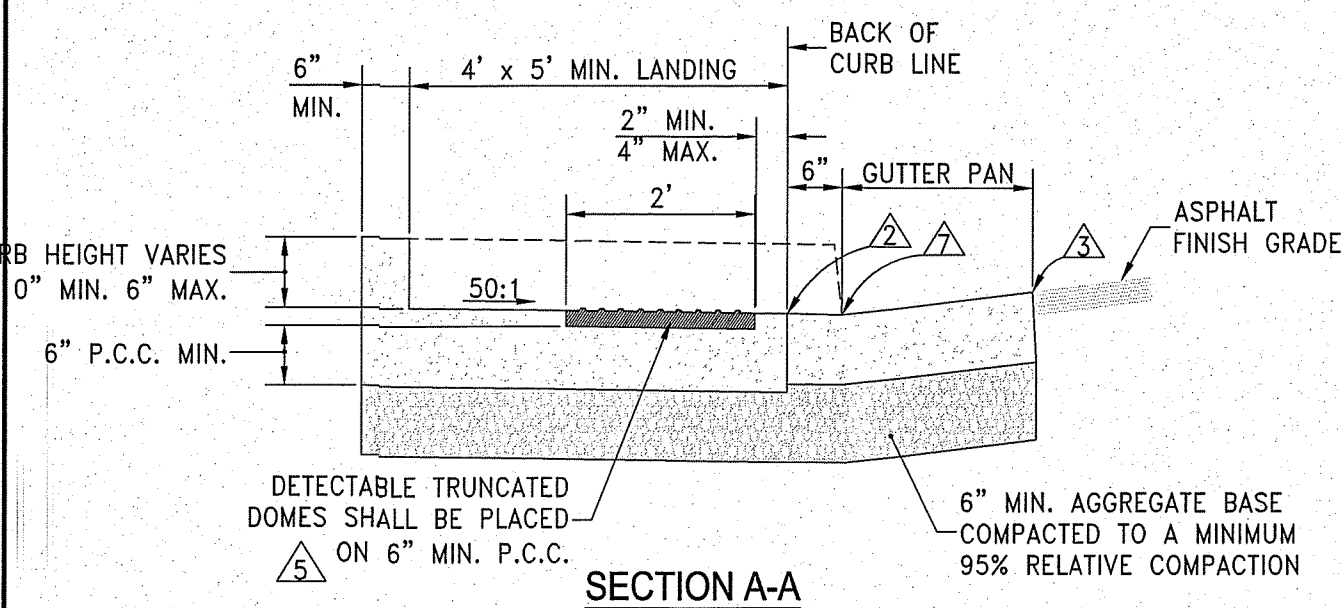
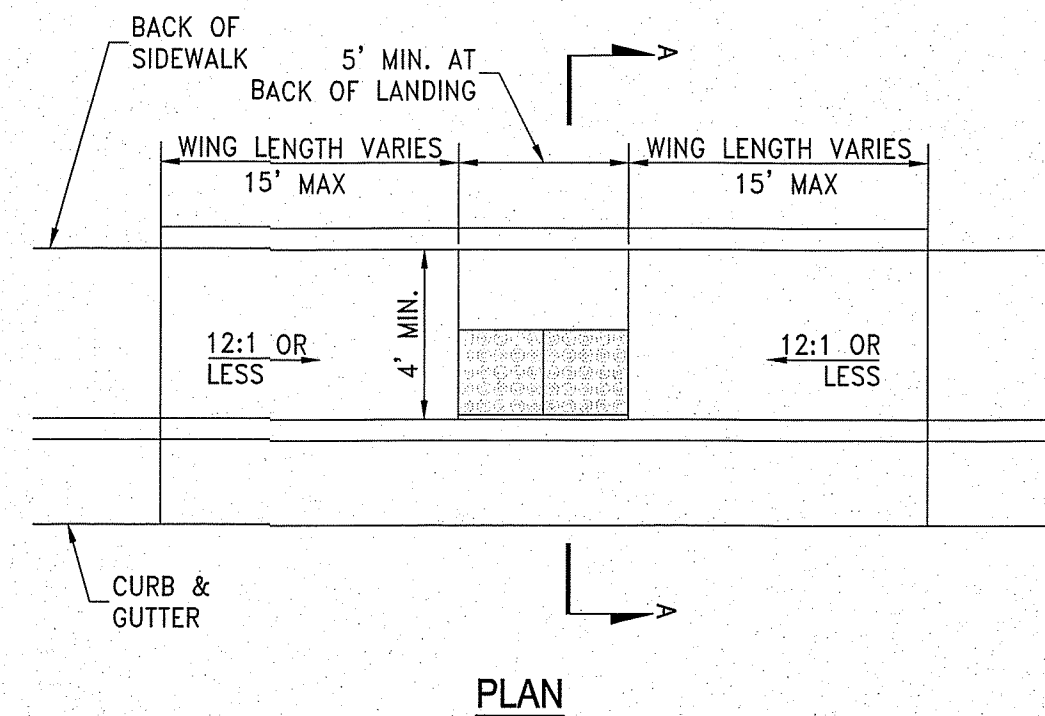

**PEDESTRIAN RAMP MIDBLOCK - TYPE 1**

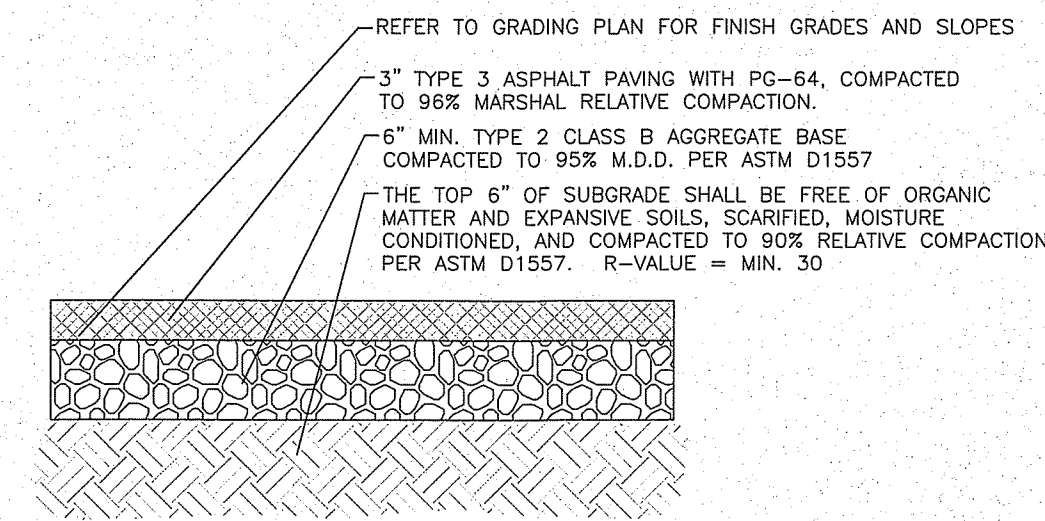

**PARKING LOT PAVING SECTION**

**NOTES:**

- ASPHALT PAVING SHALL BE TYPE 3 (1/2 INCH SIZE) PG64-28NV, 50 BLOW, MARSHALL MIX DESIGN, WITH 3 TO 5% AIR VOIDS, AND SHALL BE COMPACTED TO 98% MARSHALL RELATIVE COMPACTION. THE CONTRACTOR SHALL SUBMIT THE PROPOSED ASPHALT MIX DESIGN TO THE GEOTECHNICAL ENGINEER FOR APPROVAL, A MINIMUM OF 1 WEEK PRIOR TO PAVING.
- AGGREGATE BASE SHALL BE MOISTURE CONDITIONED TO WITHIN 2% OF OPTIMUM, PLACED IN ONE LIFT, AND COMPACTED TO 95% OF MAXIMUM DRY DENSITY PER ASTM D1557.
- THE SLOPE OF THE FINISH SURFACE SHALL BE IN ACCORDANCE WITH THE ELEVATIONS AND SLOPES ON THE GRADING PLAN.
- NEW ASPHALT PAVING FINISH SURFACE SHALL BE FLUSH WITH EXISTING ASPHALT PAVING SURFACE, MATCHING GRADE AT LIMITS OF REMOVAL AND REPLACEMENT.

**AC PAVING SECTION**  
N.T.S.

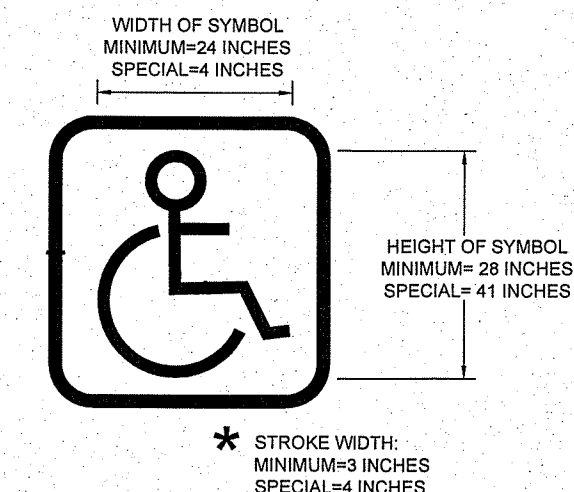

**ACCESSIBLE PARKING SYMBOL**  
N.T.S.

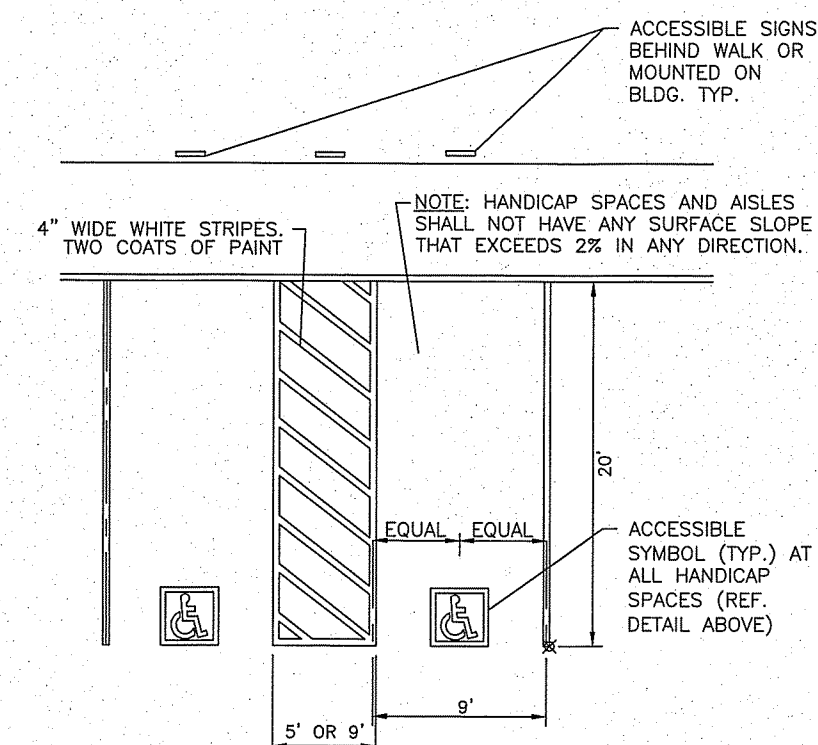

**ACCESSIBLE PARKING SPACE**  
**ADA PARKING SPACE AND SYMBOL**  
N.T.S.

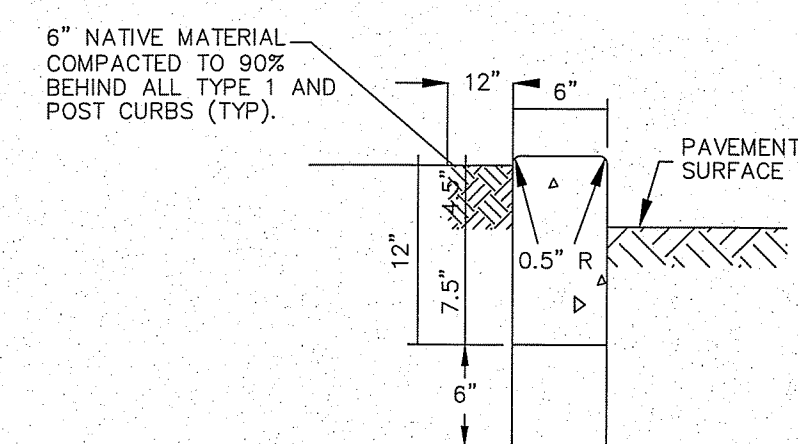
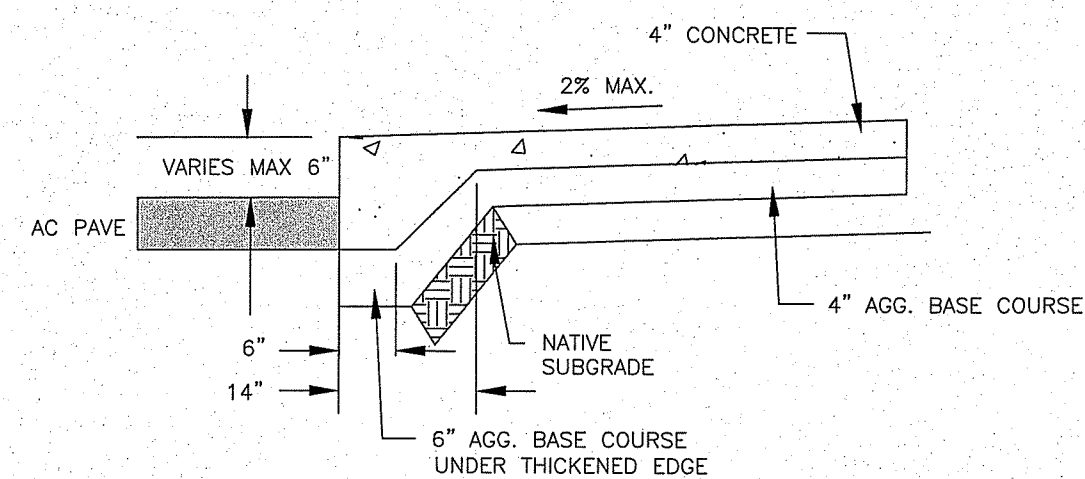

**NOTES:**

- CONCRETE SHALL MEET THE REQUIREMENTS OF SECTION 337.10 OF THE LATEST EDITION OF THE STANDARD SPECIFICATIONS FOR PUBLIC WORKS CONSTRUCTION.
- AGGREGATE BASE MATERIAL SHALL MEET THE REQUIREMENTS OF SECTIONS 302 & 308 OF THE LATEST EDITION OF THE STANDARD SPECIFICATIONS FOR PUBLIC WORKS CONSTRUCTION.
- ALL CONCRETE CURB SHALL HAVE 1" EXPANSION JOINTS EVERY 90 FEET AND AT ALL CURB RETURNS. WEAKENED PLANE JOINTS SHALL BE EVERY 10 FEET. FOR BARRIER CURB ONLY, PLACE WEAKENED PLANE JOINTS EVERY 5 FEET.
- GLUE DOWN THE TYPE 2 MEDIAN CURB TO THE PAVEMENT SURFACE USING EPOXY CEMENT.

**MEDIAN AND BARRIER CURB**  
N.T.S.

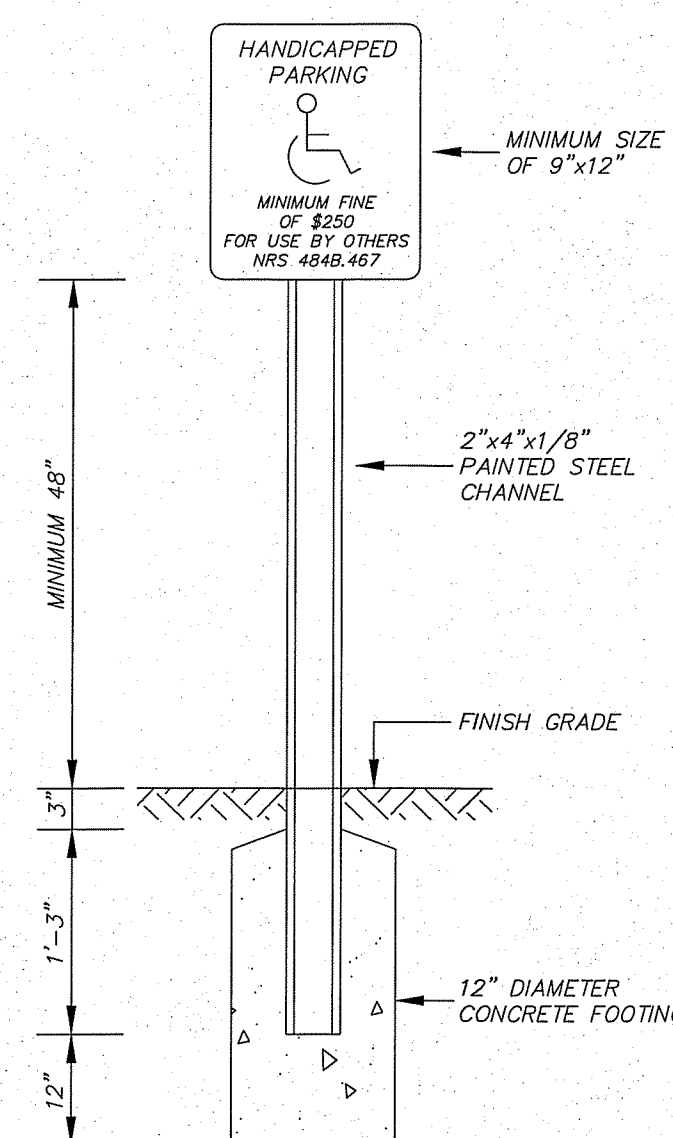

**NOTES:**

- IN LIEU OF PLACING POST AND FOOTING, SIGN MAY BE ATTACHED TO THE BUILDING WALL IN FRONT OF THE HANDICAP SPACE, PROVIDED IT IS NOT OBSCURED BY ANY STRUCTURES OR LANDSCAPING.
- ONE SIGN SHALL BE REQUIRED FOR EACH HANDICAP PARKING SPACE.

**HANDICAP PARKING SPACE SIGN**  
N.T.S.

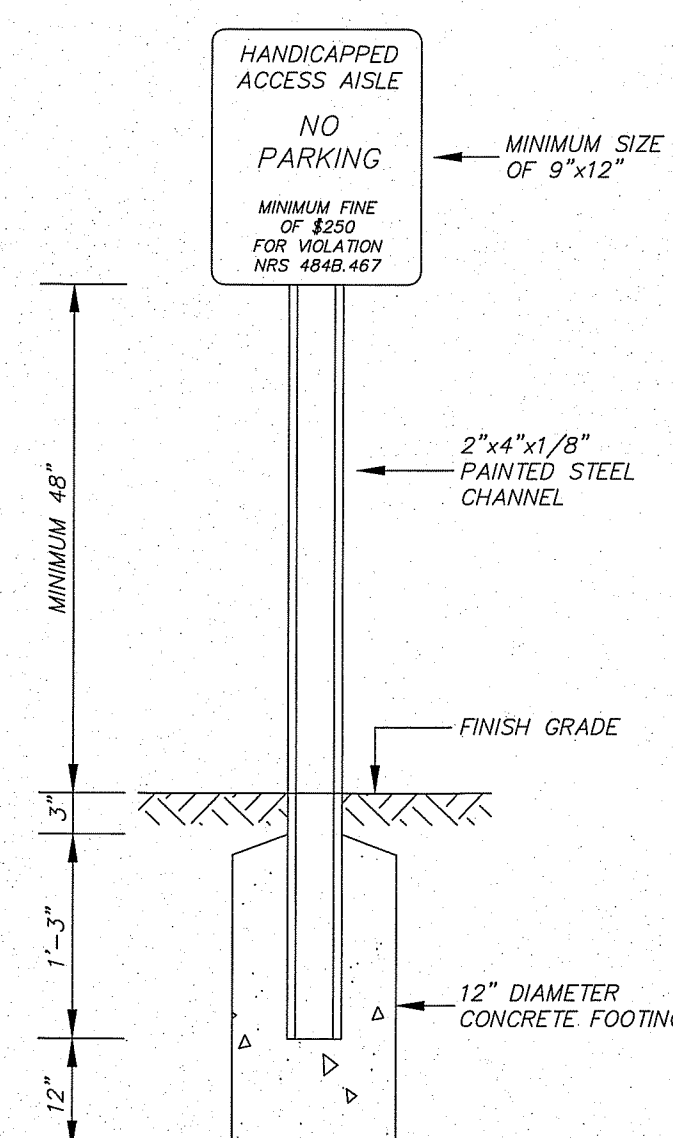

**NOTES:**

- IN LIEU OF PLACING POST AND FOOTING, SIGN MAY BE ATTACHED TO THE BUILDING WALL IN FRONT OF THE HANDICAP SPACE, PROVIDED IT IS NOT OBSCURED BY ANY STRUCTURES OR LANDSCAPING.
- ONE SIGN SHALL BE REQUIRED FOR EACH HANDICAP ACCESS AISLE.

**HANDICAP ACCESS AISLE SIGN**  
N.T.S.

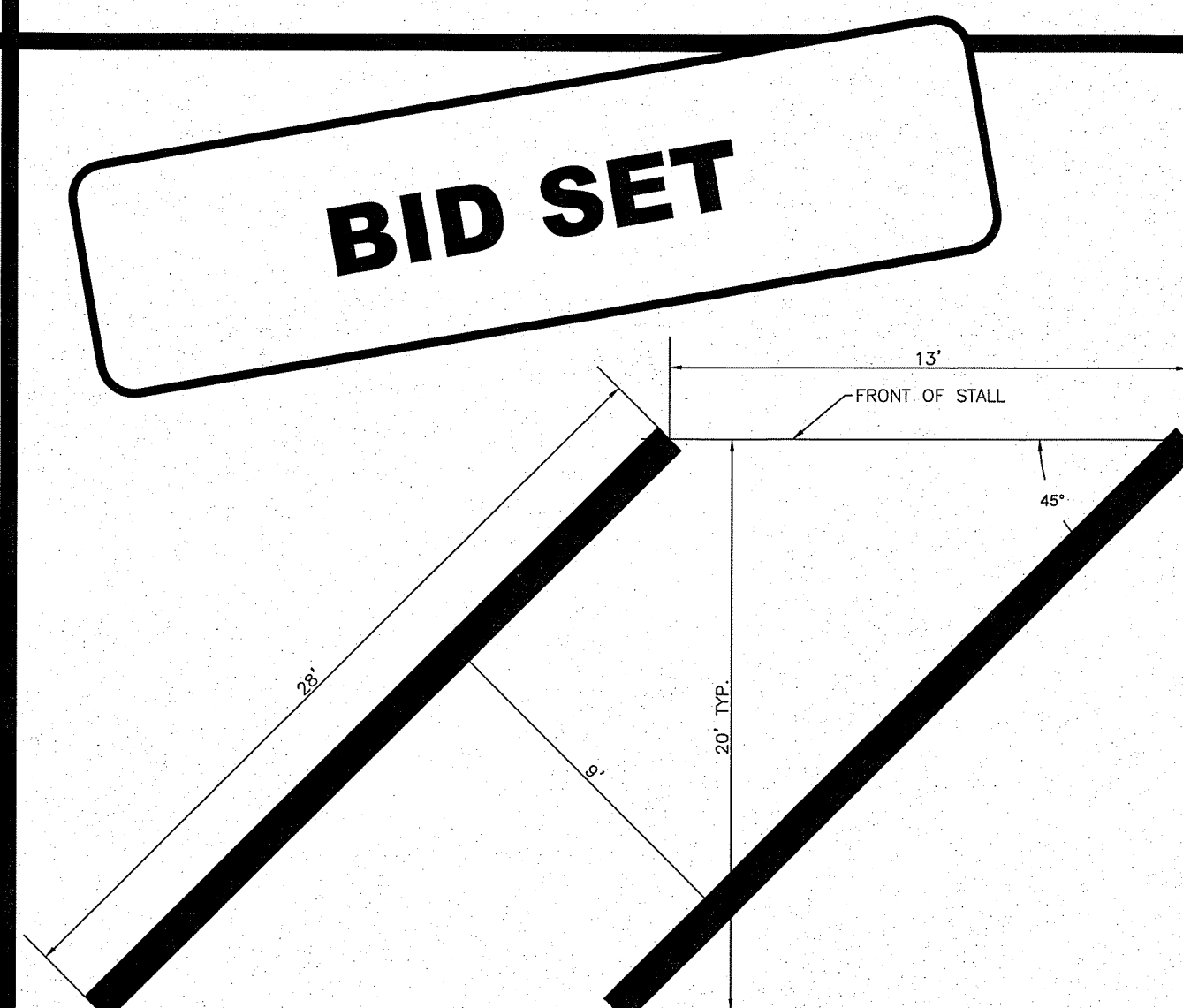

- NOTES:**
- ALL PAVEMENT MARKINGS SHALL BE APPLIED UPON CLEAN AND DRY SURFACE ACCORDING TO THE DIMENSIONS AND LAYOUT SHOWN ON THE SITE AND HORIZONTAL CONTROL PLANS.
  - PAINT SHALL BE 4" SOLID WHITE AND SHALL CONFORM TO SSPWC SECTION 214.00-1 THROUGH 214.00-11, AND SECTION 324.00-1 THROUGH 324.00-10.
- TYPICAL PARKING STALL STRIPING 45°**  
N.T.S.

| REV. | DATE | DESCRIPTION | BY | APPD |
|------|------|-------------|----|------|
|      |      |             |    |      |
|      |      |             |    |      |
|      |      |             |    |      |
|      |      |             |    |      |

CIVIL IMPROVEMENT PLANS FOR  
CITY OF SPARKS PARKING LOT PROJECTS  
DETAIL SHEET  
SPARKS WASHOE COUNTY NEVADA

DESIGNED BY: CGT  
CHECKED BY:  
SCALE  
HORIZ: 1"=10'  
VERT: N/A  
JOB NO: 30302

*[Professional Engineer Seal]*

SHEET 8 OF 9



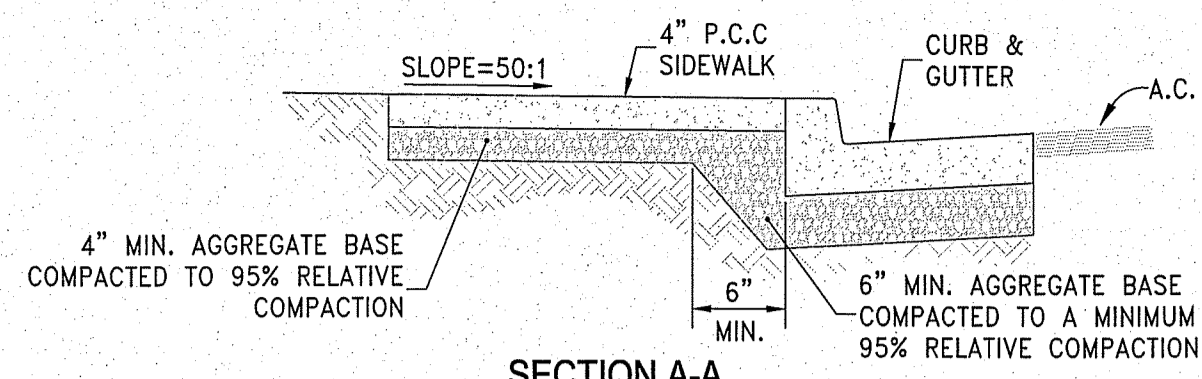

SECTION A-A

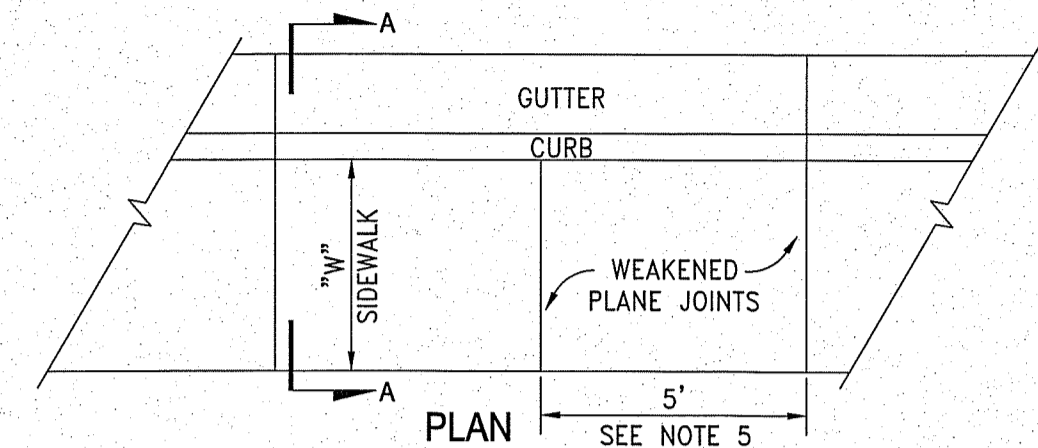

PLAN

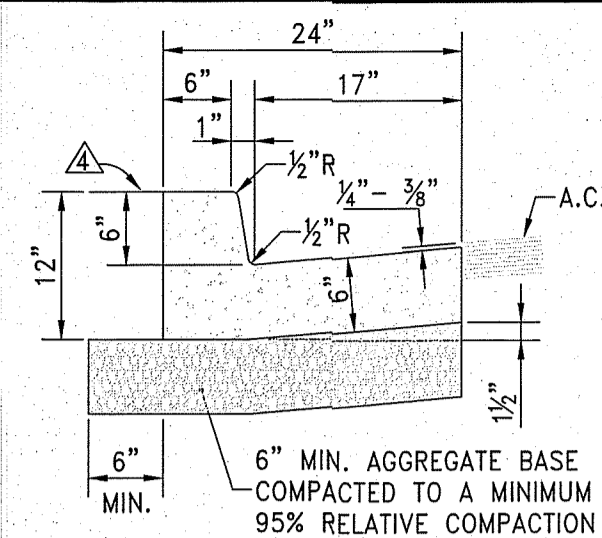

TYPE 1

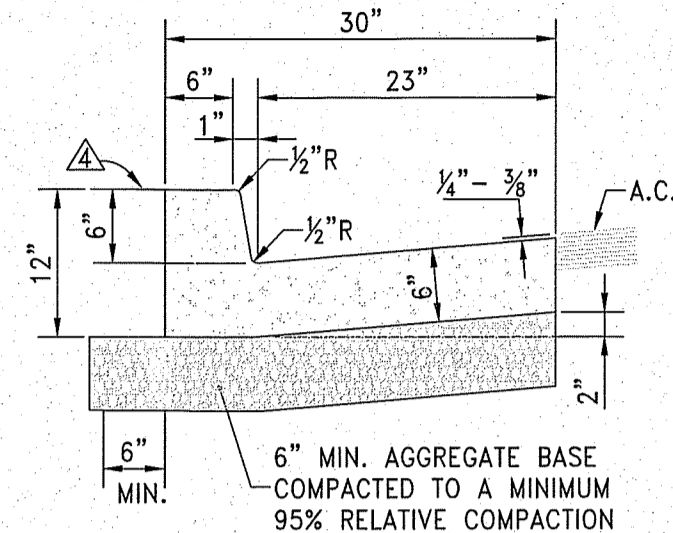

TYPE 1A

NOTES:

1. FIBER-REINFORCED PORTLAND CEMENT CONCRETE (P.C.C.) SHALL HAVE THE FOLLOWING CHARACTERISTICS: 4000 PSI MIN. COMPRESSIVE STRENGTH AT 28 DAYS, MIN. 6 SACKS OF CEMENT PER CUBIC YARD WITH MAX. WATER-CEMENT RATIO OF 0.45, AIR ENTRAINMENT 6% ±1.5%, SLUMP AT 1 TO 4 INCHES. MIX DESIGN SHALL CONFORM TO THE REQUIREMENTS OF SECTION 337 OF STANDARD SPECIFICATIONS OF PUBLIC WORKS CONSTRUCTION (SSPWC). CEMENT SHALL BE TYPE II. ALL CEMENT CONCRETE SHALL HAVE A COARSE AGGREGATE GRADATION CONFORMING TO SIZE No. 67. POLYPROPYLENE OR CELLULOSE FIBERS SHALL BE ADDED TO THE P.C.C. AT 1.5 LBS. PER CUBIC YARD. ALL MATERIALS SHALL CONFORM TO SSPWC.
2. AGGREGATE BASE MATERIAL UNDER SIDEWALKS SHALL BE TYPE 2, CLASS B CRUSHED AGGREGATE BASE. MATERIALS SHALL CONFORM TO SSPWC SECTION 200.
3. SIDEWALK WIDTH "W" SHALL BE 4 FT MIN. ON RESIDENTIAL STREETS AND 6 FT MIN. ON COLLECTOR AND ARTERIAL STREETS.
4. WEAKENED PLANE JOINTS SHALL BE CONSTRUCTED AT 5 FT INTERVALS AND ACCORDANCE WITH SECTION 312 OF THE SSPWC.
5. ALL ADJACENT CONCRETE REMOVAL SHALL BE TO NEAT SAW CUT LINES AT RIGHT ANGLES TO NEW SIDEWALK. DOWEL INTO EXISTING ADJACENT CONCRETE SIDEWALK WITH A MINIMUM OF TWO (2) No. 4 REINFORCEMENT BARS EQUALLY SPACED ACROSS WIDTH "W". DOWELS SHALL PENETRATE A MINIMUM OF 4" INTO EXISTING CONCRETE.
6. SIDEWALKS SHALL NOT BE POURED MONOLITHICALLY WITH CURBS.
7. COLORED CONCRETE AND PAVERS ARE NOT ALLOWED.
8. TUNNELING AND/OR BORING IS NOT ALLOWED.

SIDEWALK DETAIL

NOTES:

1. FIBER-REINFORCED PORTLAND CEMENT CONCRETE (P.C.C.) SHALL HAVE THE FOLLOWING CHARACTERISTICS: 4000 PSI MIN. COMPRESSIVE STRENGTH AT 28 DAYS, MIN. 6 SACKS OF CEMENT PER CUBIC YARD WITH MAX. WATER-CEMENT RATIO OF 0.45, AIR ENTRAINMENT 6% ±1.5%, SLUMP AT 1 TO 4 INCHES. MIX DESIGN SHALL CONFORM TO THE REQUIREMENTS OF SECTION 337 OF STANDARD SPECIFICATIONS OF PUBLIC WORKS CONSTRUCTION (SSPWC). CEMENT SHALL BE TYPE II. ALL CEMENT CONCRETE SHALL HAVE A COARSE AGGREGATE GRADATION CONFORMING TO SIZE No. 67. POLYPROPYLENE OR CELLULOSE FIBERS SHALL BE ADDED TO THE P.C.C. AT 1.5 LBS. PER CUBIC YARD. ALL MATERIALS SHALL CONFORM TO SSPWC.
2. AGGREGATE BASE MATERIAL UNDER AND BEHIND CURB AND GUTTER SHALL BE TYPE 2, CLASS B CRUSHED AGGREGATE BASE. MATERIALS SHALL CONFORM TO SSPWC SECTION 200.
3. WEAKENED PLANE JOINTS SHALL BE EVERY 10 FEET AND LOCATED ON THE BACK, TOP AND FACE OF THE CURB AND THE TOP OF THE GUTTER PAN.
4. CURB & GUTTER SECTIONS SHALL BE PLACED SEPARATELY FROM SIDEWALK SECTIONS. WHEN SIDEWALK IS NOT REQUIRED DIRECTLY BEHIND THE CURB, BACKFILL TO TOP OF CURB FOR A HORIZONTAL DISTANCE OF 12" FROM BACK FACE OF CURB AND COMPACT TO 90% RELATIVE COMPACTION.
5. FOR REPLACEMENT OF EXISTING CURB AND GUTTER, MATCH EXISTING TYPE.

P.C.C.  
CURB & GUTTER

**BID SET**

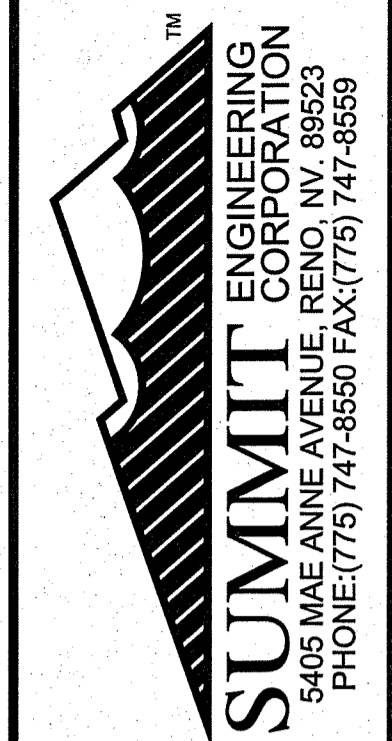

| REV. | DATE | DESCRIPTION | BY | APPD |
|------|------|-------------|----|------|
|      |      |             |    |      |
|      |      |             |    |      |
|      |      |             |    |      |
|      |      |             |    |      |
|      |      |             |    |      |
|      |      |             |    |      |
|      |      |             |    |      |
|      |      |             |    |      |
|      |      |             |    |      |

CIVIL IMPROVEMENT PLANS FOR  
CITY OF SPARKS PARKING LOT PROJECTS  
DETAIL SHEET  
SPARKS WASHOE COUNTY NEVADA

DESIGNED BY: CGT  
CHECKED BY:  
SCALE  
HORIZ: 1"=10'  
VERT: N/A  
JOB NO: 30302

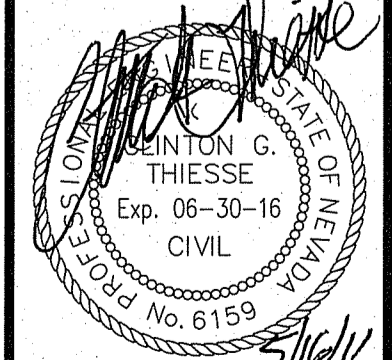

SHEET 9 OF 9