



**ADDENDUM #1
 ROCK PARK RESTROOM
 BID #15/16-005 – PWP# WA-2015-255
 BIDS DUE NO LATER THAN: 1:45 PM ON AUGUST 26, 2015
 PUBLIC BID OPENING: 2:00 PM ON AUGUST 26, 2015**

This addendum is to notify all potential proposers of clarifications made to the Bid documents as stated below.

A. Project Manual

SECTION-PAGE DESCRIPTION

102800-3	Add the following: 2.3.B Warm-Air Dryer B
	<ol style="list-style-type: none"> 1. Acceptable Substitution: Excel Dryer Inc., ThinAir Hand Dryer 2. Electrical Requirements: 120V, 8A.

B. Drawings

<u>SHEET</u>	<u>DESCRIPTION</u>
A401	Replace Details 4/A401 and 5/A401 with attached Addendum Drawing ADA001
E002	Added 30A circuit to Panel LA (22,24) for connection of sewer lift station.
E101	A/E101, New site background shown with electrical connections to sewer lift station (specified by Civil).

C. Attachments

<u>SHEET</u>	<u>DESCRIPTION</u>
ADA001	Revised Handrails Details
E002	Revised LA Panel
E101	Revised Electrical Site Plan and Sheet Notes

Please note and adjust your bid according to the revisions, additions, deletions, clarifications or modifications as presented on this Addendum #1, which are made a part of this bid. NOTE: To avoid disqualification, this Addendum 1 (and any other addenda) must be signed by an authorized representative of the bidding firm in the space provided and must be submitted with your firm’s sealed proposal (not later than 1:45 pm on August 26, 2015). Failure to return this addendum, duly signed, may

be cause for rejection of the bid. ALL ADDENDA SHOULD BE SIGNED AND PLACED IN SEQUENTIAL ORDER AND ATTACHED TO THE FRONT OF THE BID PACKAGE, COMPLETE WITH ALL REQUIRED DOCUMENTS.

CONTRACTOR BUSINESS NAME

X_____
Authorized Signature

Printed Name of Person Signing

Dan Marran, C.P.M., CPPO
Contracts and Risk Manager

August 18, 2015

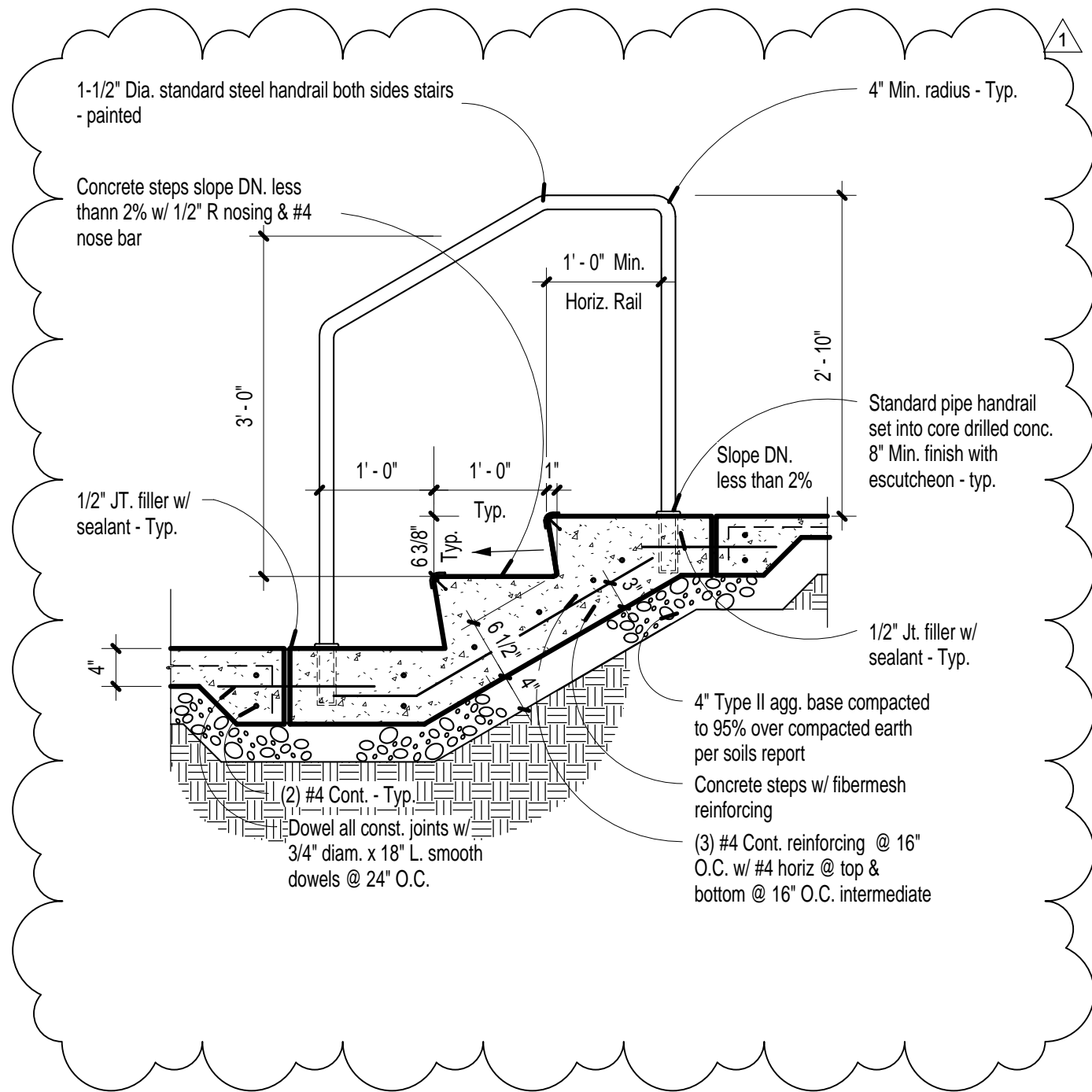

5 Typ. Concrete Steps on Grade - Addendum A001

3/4" = 1'-0"

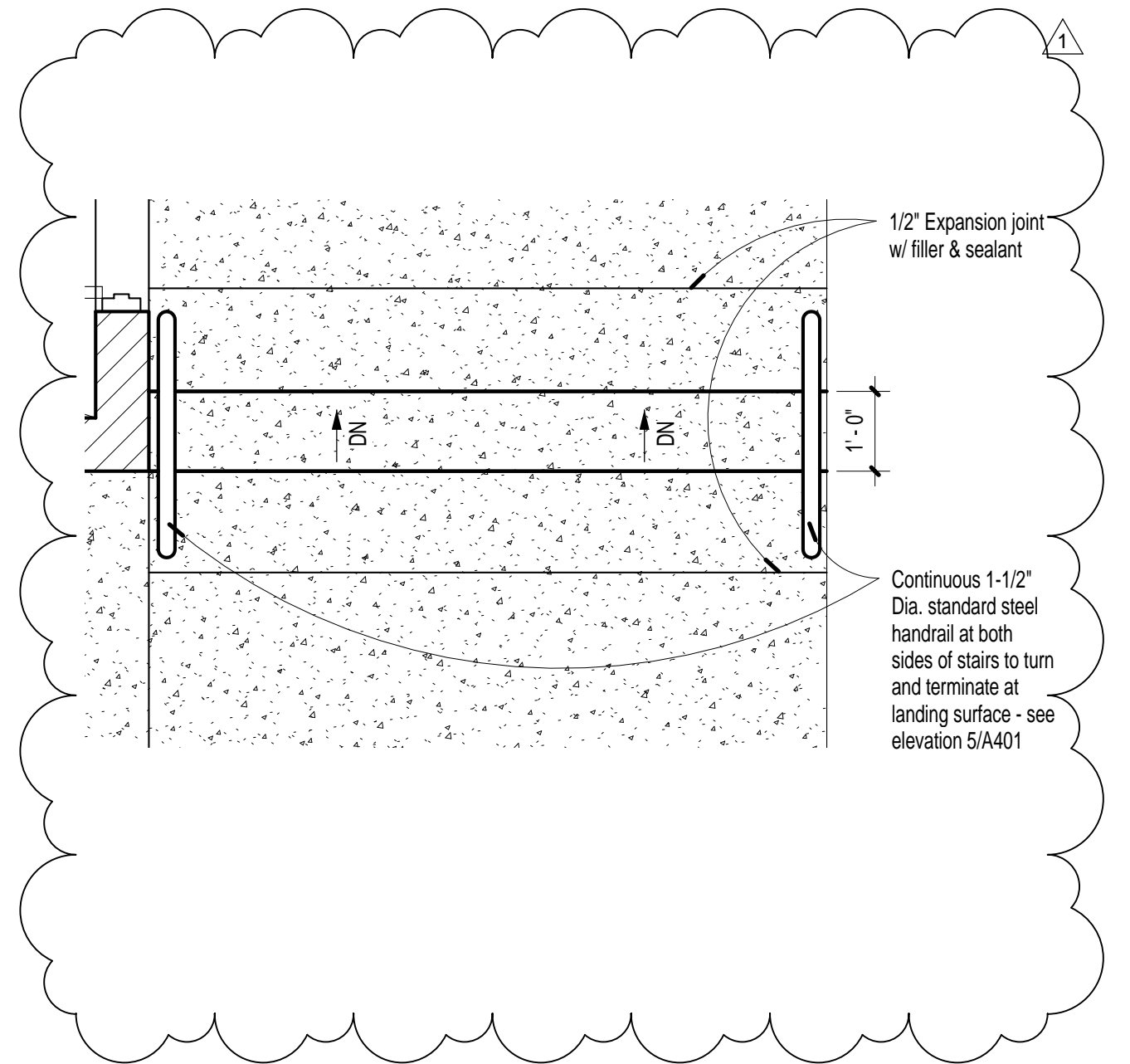

4 Enlarged Plan @ Handrail - Addendum A001 North

1/2" = 1'-0"

H+K ARCHITECTS

5485 Reno Corporate Drive, Suite 100
Reno, Nevada 89511-2262

P 775+332+6640
F 775+332+6642

hkarchitects.com

**Rock Park
Restroom and Storage Building**

Reference: See 4/A401 & 5/A401

Handrail at Stairs

August 17, 2015
H+K Project No.: 1504

ADA001



COMcheck Software Version 4.0.0 Interior Lighting Compliance Certificate

Section 1: Project Information

Energy Code: 2009 IECC
 Project Title: Rock Park Restrooms/Storage
 Project Type: New Construction

Construction Site: 1515 S. Rock Blvd Sparks, NV 89502
 Owner/Agent: James Sakano, PE JP Engineering, LLC 10597 Double R Blvd Reno, NV 89521 775-852-2337

Section 2: Interior Lighting and Power Calculation

A Area Category	B Floor Area (sq ft)	C Allowed Watts / sq ft	D Allowed Watts (B x C)
Restroom/Storage (Warehouse)	799	0.8	614
Total Allowed Watts =			614

Section 3: Interior Lighting Fixture Schedule

Fixture ID : Description / Lamp / Wattage Per Lamp / Ballast	B Lamp/ Fixture	C # of Fixtures	D E Fixture Watt. (C x D)
Restroom/Storage (Warehouse 769 sq.ft.)			
Linear Fluorescent 1: F1: See Fixture Schedule: 48" T8 32W: Electronic:	2	4	65 260
Linear Fluorescent 2: F2: See Fixture Schedule: 48" T8 32W: Electronic:	2	2	65 130
Linear Fluorescent 3: F3: See Fixture Schedule: 48" T8 32W: Electronic:	2	2	65 130
Linear Fluorescent 4: F4: See Fixture Schedule: 48" T8 32W: Electronic:	1	2	32 64
Total Proposed Watts =			584

Section 4: Requirements Checklist

- Lighting Wattage:**
- 1. Total proposed watts must be less than or equal to total allowed watts.

Allowed Watts	Proposed Watts	Complies
614	584	YES
- Controls, Switching, and Wiring:**
- 2. Daylight zones under skylights more than 15 feet from the perimeter have lighting controls separate from daylight zones adjacent to vertical fenestration.
 - 3. Daylight zones have individual lighting controls independent from that of the general area lighting.

Exception:

 - Contiguous daylight zones spanning no more than two orientations are allowed to be controlled by a single controlling device.
 - Daylight spaces enclosed by walls or ceiling height partitions and containing two or fewer light fixtures are not required to have a separate switch for general area lighting.
 - 4. Independent controls for each space (switch/occupancy sensor).
- Project Title: Rock Park Restrooms/Storage
 Date Issued: 1/20/15 15035 - Rock Park Restroom/7, Calculations 15035 IECC.doc
 Report date: 05/20/15
 Page 1 of 4

- Exceptions:
- Areas designated as security or emergency areas that must be continuously illuminated.
 - Lighting in stairways or corridors that are elements of the means of egress.
 - 5. Master switch at entry to hotel/motel guest room.
 - 6. Individual dwelling units separately metered.
 - 7. Medical task lighting or ambulatory display lighting claimed to be exempt from compliance has a control device independent of the control of the nonmedical lighting.
 - 8. Each space required to have a manual control also allows for reducing the connected lighting load by at least 50 percent by either controlling all luminaires, dual switching of alternate zones of luminaires, alternate luminaires, or alternate lamps, switching the middle lamp luminaires independently of other lamps, or switching each luminaire or each lamp.
- Exceptions:
- Only one luminaire in space.
 - An occupant sensing device controls the area.
 - The area is a corridor, storeroom, restroom, public lobby or sleeping unit.
 - Areas that use less than 0.6 Watts/sq.ft.
 - Automatic lighting shutoff control in buildings larger than 5,000 sq.ft.
- Exceptions:
- Sleeping units, patient care areas, and spaces where automatic shutoff would endanger safety or security.
 - 10. Photocell/astrolux/night switch on outdoor lights.
- Exceptions:
- Lighting intended for 24 hour use.
 - 11. Tandem wired one-lamp and three-lamp ballasted luminaires (No single-lamp ballasts).
- Exceptions:
- Electronic high-frequency ballasts; luminaires on emergency circuits or with no available power.

Section 5: Compliance Statement

Compliance Statement: The proposed lighting design represented in this document is consistent with the building plans, specifications and other calculations submitted with this permit application. The proposed lighting system has been designed to meet the 2009 IECC requirements in COMcheck Version 4.0.0 and to comply with the mandatory requirements in the Requirements Checklist.

Name - Title _____ Signature _____ Date _____

Project Title: Rock Park Restrooms/Storage
 Date Issued: 1/20/15 15035 - Rock Park Restroom/7, Calculations 15035 IECC.doc
 Report date: 05/20/15
 Page 2 of 4

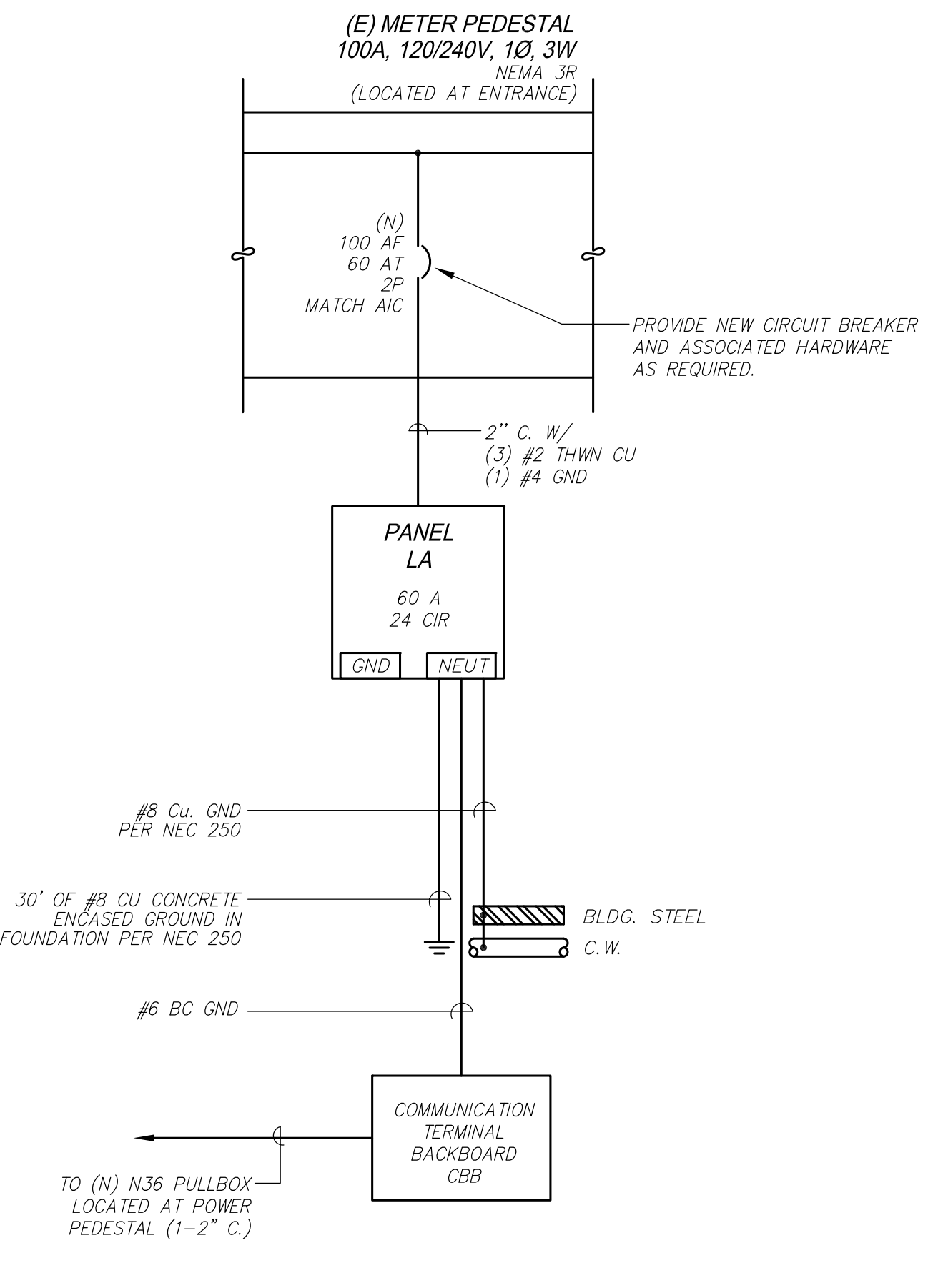

LIGHTING FIXTURE SCHEDULE

LIGHTING FIXTURE CATALOG NUMBERS ARE SERIES TYPE ONLY. PROVIDE TRIMS, BALLASTS, MOUNTING EQUIPMENT, FITTINGS AND LAMPS AS REQUIRED BY THE SPECIFICATIONS AND PROJECT CONDITIONS FOR A COMPLETE INSTALLATION. THIS IS NOT A STANDALONE SCHEDULE AND FIXTURES MUST INCORPORATE ALL WORK INDICATED OR IMPLIED THROUGHOUT THE DRAWINGS AND SPECIFICATIONS.

TYPE	SYMBOL	SKETCH	DESCRIPTION AND MANUFACTURER
F1	[Symbol]	[Sketch]	FLUORESCENT 2-LAMP SURFACE MOUNTED LUMINAIRE WITH ACRYLIC WRAPAROUND LENS AND ELECTRONIC BALLAST. MOUNTING HEIGHT: CEILING, SURFACE (2) F032 T8 4100K LAMP: MVOLT VOLTAGE: LITHONIA: VSL 2 32 MVOLT GEB10IS MANUFACTURER: OR EQUAL ● SUBJECT TO REVIEW ○ NO EQUAL SUBSTITUTIONS:
FIX	[Symbol]	[Sketch]	FLUORESCENT 2-LAMP SURFACE MOUNTED LUMINAIRE WITH ACRYLIC WRAPAROUND LENS AND ELECTRONIC BALLAST AND EMERGENCY BATTERY PACK. MOUNTING HEIGHT: CEILING, SURFACE (2) F032 T8 4100K LAMP: MVOLT VOLTAGE: LITHONIA: VSL 2 32 MVOLT GEB10IS ELDW MANUFACTURER: OR EQUAL ● SUBJECT TO REVIEW ○ NO EQUAL SUBSTITUTIONS:
F2	[Symbol]	[Sketch]	FLUORESCENT 2-LAMP SURFACE MOUNTED LUMINAIRE WITH ACRYLIC WRAPAROUND LENS AND ELECTRONIC BALLAST. MOUNTING HEIGHT: CEILING, SURFACE (2) F032 T8 4100K LAMP: MVOLT VOLTAGE: LITHONIA: LB 2 32 MVOLT GEB10IS MANUFACTURER: OR EQUAL ● SUBJECT TO REVIEW ○ NO EQUAL SUBSTITUTIONS:
F3	[Symbol]	[Sketch]	FLUORESCENT 4 FOOT, 1-LAMP OPEN STRIP FIXTURE WITH ELECTRONIC BALLAST AND WIRE GUARD. MOUNTING HEIGHT: CEILING (2) F032 T8 4100K LAMP: MVOLT VOLTAGE: LITHONIA: C 1 32 MVOLT GEB10IS WGCUN NST MANUFACTURER: OR EQUAL ● SUBJECT TO REVIEW ○ NO EQUAL SUBSTITUTIONS:
LI	[Symbol]	[Sketch]	LED, ARCHITECTURAL WALL SCONCE, DARK BRONZE FINISH, SELF CONTAINED, WET LOCATION LISTED. PROVIDE WITH VANDAL GUARD AS REQUIRED. MOUNTING HEIGHT: PER PLAN INCLUDED LAMP: 10A700/40K VOLTAGE: LITHONIA: WST LED 2 10A700/40K SR4 MVOLT VG DDBXD MANUFACTURER: OR EQUAL ● SUBJECT TO REVIEW ○ NO EQUAL SUBSTITUTIONS:
LIX	[Symbol]	[Sketch]	LED, ARCHITECTURAL WALL SCONCE, DARK BRONZE FINISH, SELF CONTAINED, WET LOCATION LISTED. 90 MINUTE BATTERY BACKUP. PROVIDE WITH VANDAL GUARD AS REQUIRED. MOUNTING HEIGHT: PER PLAN INCLUDED LAMP: 10A700/40K VOLTAGE: LITHONIA: WST LED 2 10A700/40K SR4 MVOLT ELCV VG DDBXD MANUFACTURER: OR EQUAL ● SUBJECT TO REVIEW ○ NO EQUAL SUBSTITUTIONS:

COMcheck Software Version 4.0.0 Exterior Lighting Compliance Certificate

Section 1: Project Information

Energy Code: 2009 IECC
 Project Title: Rock Park Restrooms/Storage
 Project Type: New Construction
 Exterior Lighting Zone: 2 (Residential mixed use area)

Construction Site: 1515 S. Rock Blvd Sparks, NV 89502
 Owner/Agent: James Sakano, PE JP Engineering, LLC 10597 Double R Blvd Reno, NV 89521 775-852-2337

Section 2: Exterior Lighting Area/Surface Power Calculation

A Exterior Area/Surface	B Quantity	C Allowed Watts / Unit	D Tradeable Watts (B x C)	E Allowed Watts (B x C)	F Proposed Watts
Restroom Site (Paved area)	1520 sq ft	0.14	Yes 213	270	270
Total Tradeable Watts =			213	270	
Total Allowed Supplemental Watts** =			600		

** Wattage tradeoffs are only allowed between tradeable areas/surfaces.
 ** A supplemental allowance equal to 600 watts may be applied toward compliance of both non-tradeable and tradeable areas/surfaces.

Section 3: Exterior Lighting Fixture Schedule

Fixture ID : Description / Lamp / Wattage Per Lamp / Ballast	B Lamp/ Fixture	C # of Fixtures	D E Fixture Watt. (C x D)
Restroom Site (Paved area 1520 sq ft): Tradeable Wattage			
LED 1: L1: See Fixture Schedule: LED Roadway-Parking Unit 54W:	1	3	54 162
LED 2: L2: See Fixture Schedule: LED Roadway-Parking Unit 54W:	1	2	54 108
Total Tradeable Proposed Watts =			270

Section 4: Requirements Checklist

- Lighting Wattage:**
- 1. Within each non-tradeable area/surface, total proposed watts must be less than or equal to total allowed watts. Across all tradeable areas/surfaces, total proposed watts must be less than or equal to total allowed watts. Compliance: Passes using supplemental allowance watts.
- Controls, Switching, and Wiring:**
- 2. All exemption claims are associated with fixtures that have a control device independent of the control of the nonexempt lighting.
 - 3. Lighting not designated for dusk-to-dawn operation is controlled by either a photo sensor (with time switch), or an astronomical time switch.
 - 4. Lighting designated for dusk-to-dawn operation is controlled by an astronomical time switch or photo sensor.
 - 5. All time switches are capable of retaining programming and the time setting during loss of power for a period of at least 10 hours.
- Exterior Lighting Efficacy:
- Project Title: Rock Park Restrooms/Storage
 Date Issued: 1/20/15 15035 - Rock Park Restroom/7, Calculations 15035 IECC.doc
 Report date: 05/20/15
 Page 3 of 4

- 6. All exterior building grounds luminaires that operate at greater than 100W have minimum efficacy of 80 lumens/watt.
- Exceptions:
- Lighting that has been claimed as exempt and is identified as such in Section 3 table above.
 - Lighting that is specifically designated as required by a health or life safety statute, ordinance, or regulation.
 - Emergency lighting that is automatically of during normal building operation.
 - Lighting that is controlled by motion sensor.

Section 5: Compliance Statement

Compliance Statement: The proposed exterior lighting design represented in this document is consistent with the building plans, specifications and other calculations submitted with this permit application. The proposed lighting system has been designed to meet the 2009 IECC requirements in COMcheck Version 4.0.0 and to comply with the mandatory requirements in the Requirements Checklist.

Name - Title _____ Signature _____ Date _____

Project Title: Rock Park Restrooms/Storage
 Date Issued: 1/20/15 15035 - Rock Park Restroom/7, Calculations 15035 IECC.doc
 Report date: 05/20/15
 Page 4 of 4

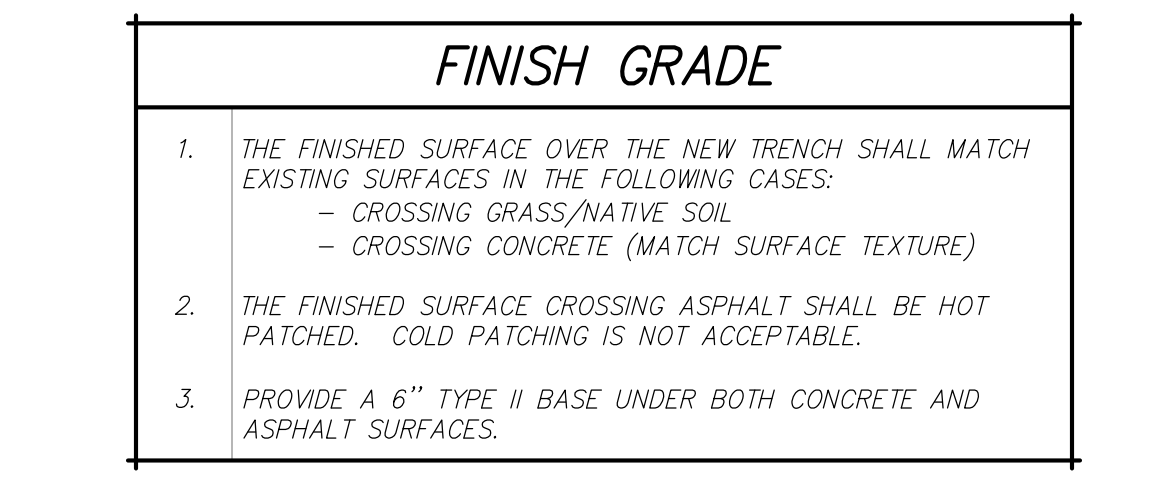

E-EQUIPMENT, K-KITCHEN, L-LIGHTING, H-HEAT, M-MOTOR, M-H MOTOR (LARGEST), R-RECEPTS	LOCATION	EQUIPMENT ROOM									
DF DESCRIPTION	LOAD	BKR	CIR	A	B	CIR	BKR	LOAD	DESCRIPTION	DF	
L EXTERIOR LIGHTING	100	20/1	1	1500			2	20/1	1400	HAND DRYER	E
L INTERIOR LIGHTING	1030	20/1	3		2430		4	20/1	1400	HAND DRYER	E
E EF-1	350	20/1	5	1250			6	20/1	900	STORAGE RECEPTS	R
E H-1	750	20/1	7		1450		8	20/1	700	CHASE / ATTIC	R
E SECURITRON PWR SPLY	500	20/1	9	500			10	20/1		SPARE	
SPARE			11			0	12	20/1		SPARE	
SPARE			13	0			14	20/1		SPARE	
SPACE			15			0	16			SPACE	
SPACE			17	0			18			SPACE	
SPACE			19			0	20			SPACE	
SPACE			21	2160			22	30	2160	LIFT STATION	E
SPACE			23			2160	24	2	2160		E
			25	0			26				
			27	0			28				
			29	0			30				
			31	0			32				
			33	0			34				
			35	0			36				
			37	0			38				
			39			0	40				
				5410			6040				
AMPS:	100	NEUTRAL BUS:	100%	CON. KVA:	11.5						
VOLTAGE:	240	GROUND BUS:	STANDARD	CON. AMPS:	47.7						
PHASE / WIRE:	1-PH .3W	AIC RATING:	10,000	NET KVA:	11.7						
MAIN:		NEMA RATING:	1	NET AMPS:	48.9						
LUGS:	MLO	PANEL				Notes:					
MOUNTING:	FLUSH	LA									
BUS:	COPPER										
DOOR:	STANDARD										

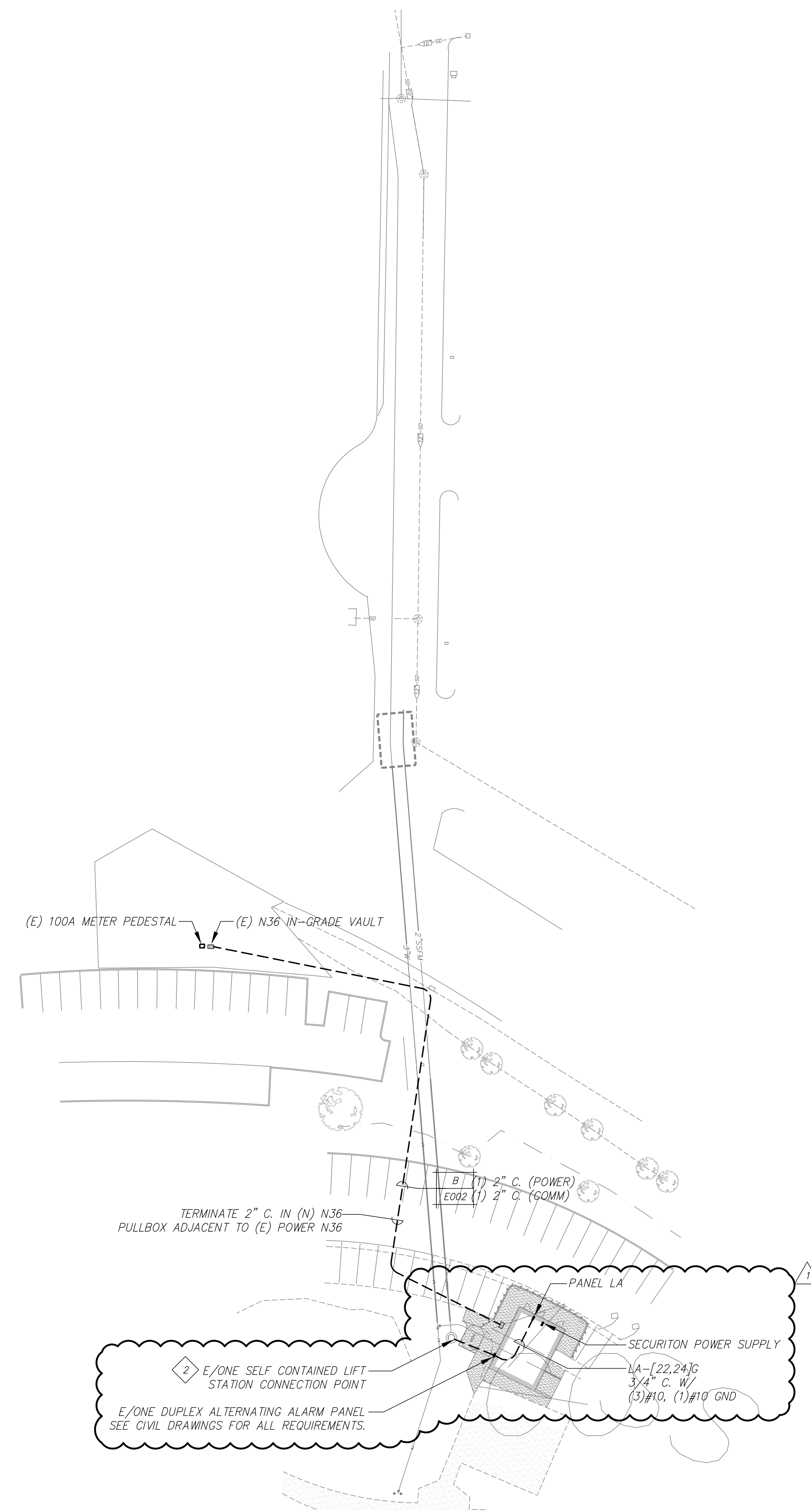

SHEET NOTES

1 CONTRACTOR SHALL PROVIDE (1) 1 1/4" PVC COATED THREADED RIGID METAL CONDUIT FROM NEW E/ONE DUPLEX ALARM PANEL TO NEW E/ONE SELF CONTAINED LIFT STATION AND ROUTE FACTORY PROVIDED ELECTRICAL SUPPLY CABLE (ESC) AS REQUIRED. SEAL CONDUIT PER NEC 300.5 & 300.7. COORDINATE ALL REQUIREMENTS WITH MANUFACTURER PRIOR TO CONSTRUCTION.

2 PENETRATION INTO LIFT STATION SHALL BE MADE INTO FACTORY SUPPLIED FEED-THRU CABLE CONNECTOR ON THE WALL OF THE SHROUD. COORDINATE ALL REQUIREMENTS WITH MANUFACTURER PRIOR TO ROUGH-IN.

A	ELECTRICAL SITE PLAN	
E101	SCALE: 1"=40'-0"	

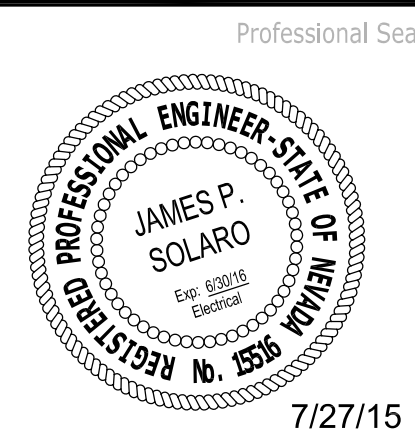

Professional Seal
 Date Revision
 8/17/15 Addendum 001
 © Copyright H + K Architects

#15035

10597 Double R Blvd. P: 775.852.2337
 Reno, Nevada 89521 F: 775.852.2352

Consultant

H+K ARCHITECTS
 5485 Reno Corporate Drive, Suite 100
 Reno, Nevada 89511-2262
 P 775+332+6640
 F 775+332+6642
 hkarchitects.com

**Rock Park
 Restroom and Storage Building**

1515 S. Rock Blvd.
 Sparks, NV 89502

Electrical Site Plan

July 27, 2015
 H+K Project No.: 1504

E101

