



ADDENDUM #1

4TH STREET SEWER REHABILITATION

BID #13/14-019 – PWP# WA-2014-165

BIDS DUE NO LATER THAN: 1:45 PM ON APRIL 30, 2014

PUBLIC BID OPENING: 2:00 PM ON APRIL 30, 2014

This addendum is to notify all potential proposers of clarifications made to the Bid documents as stated below.

Clarification of Dimensions:

The labeled quantities (identified with a Delta 1) on revised plan sheets C-2 and C-3 (following this page) are clarified to correspond with the pipe segments. The total plan and bid quantity of CIPP Liner does not change for the project.

Please note and adjust your bid according to the revisions, additions, deletions, clarifications or modifications as presented on this Addendum #1, which are made a part of this bid. NOTE: To avoid disqualification, this Addendum 1 (and any other addenda) must be signed by an authorized representative of the bidding firm in the space provided and must be submitted with your firm's sealed proposal (not later than 1:45 pm on April 30, 2014). Failure to return this addendum, duly signed, may be cause for rejection of the bid. ALL ADDENDA SHOULD BE SIGNED AND PLACED IN SEQUENTIAL ORDER AND ATTACHED TO THE FRONT OF THE BID PACKAGE, COMPLETE WITH ALL REQUIRED DOCUMENTS.

CONTRACTOR BUSINESS NAME

Dan Marran, C.P.M., CPPO
Contracts and Risk Manager

X _____
Authorized Signature

April 25, 2014

Printed Name of Person Signing

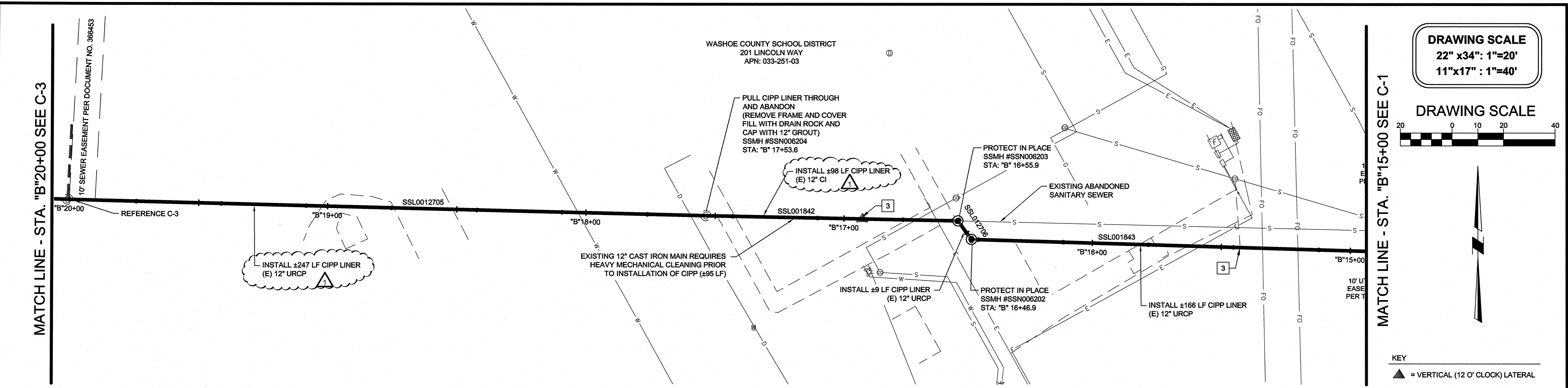

DRAWING SCALE
 22" x 34" : 1"=20'
 11" x 17" : 1"=40'

DRAWING SCALE

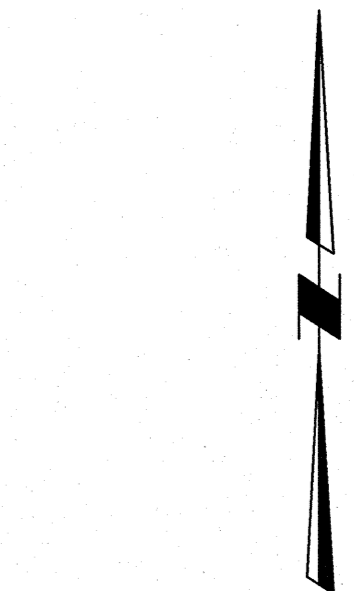
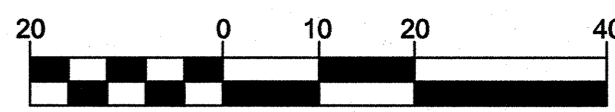

KEY
 ▲ = VERTICAL (12 O' CLOCK) LATERAL

CONSTRUCTION NOTES

1. INSTALL TMWA WATER SECTION REPLACEMENT. CONTRACTOR SHALL NOTIFY TMWA A MINIMUM OF 48 HOURS PRIOR TO SECTION REPLACEMENT. SECTION REPLACEMENTS MAY REQUIRE HORIZONTAL AND/OR VERTICAL REALIGNMENT. PRIOR TO CONSTRUCTION, CONTRACTOR SHALL POthOLE & COORDINATE WITH TMWA AND THE ENGINEER TO DETERMINE ALIGNMENT. DURING CONSTRUCTION, TMWA INSPECTOR MAY APPROVE TO PROTECT IN PLACE EXISTING WATER SECTION (REFERENCE TMWA NOTES ON PAGE 2).
2. VERIFY & INSTALL SANITARY SEWER LATERAL USING A FLEXIBLE WYE TAP SADDLE (REFERENCE DETAIL 5 ON SHEET D-2). "INSERT A TEE" CONNECTIONS WILL NOT BE USED. LATERALS SHOWN ARE APPROXIMATE LOCATIONS BASED ON PREVIOUS CCTV AND HAVE NOT BEEN VERIFIED AS ACTIVE LATERALS. CONTRACTOR SHALL VERIFY THAT ALL SANITARY SEWER LATERALS ARE ACTIVE OR INACTIVE PRIOR TO THE INSTALLATION OF ANY MAIN LINE SANITARY SEWER PIPE SEGMENT (MH TO MH). EACH ACTIVE SEWER LATERAL WHERE FLOW IS EVIDENT BY SIMPLE VISUAL INSPECTION SHALL BE RECONNECTED AND DYE TEST VERIFICATION IS REQUIRED TO IDENTIFY SERVICE ADDRESS.

 IF NO INDICATIONS OF FLOW ARE PRESENT THEN A PUSH TYPE CAMERA WITH VIDEO TAPE INSPECTION CAPABILITY SHALL BE USED IN CONJUNCTION WITH CCTV & DYE/SMOKE TESTING TO CONFIRM IF LATERAL IS ACTIVE OR INACTIVE. THE CONTRACTOR SHALL MAINTAIN A LOG OF ALL INACTIVE AND ACTIVE LATERALS PRIOR TO RECONNECTION OR ABANDONMENT PER THE SPECIFICATIONS AND AN INSPECTOR SHALL BE PRESENT DURING ALL LATERAL VERIFICATIONS AND CONNECTIONS TO PROVIDE LOCATION MARK UP FOR GPS.

 LATERAL DIRECTION IS UNKNOWN FOR 12 O' CLOCK LATERALS. CONTRACTOR SHALL VERIFY DIRECTION PRIOR TO INSTALLATION.

 EXCAVATING CLOSER THAN 5 FEET FROM POWER POLE OR ANCHOR WILL REQUIRE THE CONTRACTOR TO NOTIFY AN NV ENERGY INSPECTOR AT 834-7824 SO A DETERMINATION CAN BE MADE IN REGARDS TO SUPPORTING THE POLE UNTIL THE AREA CAN BE BACKFILLED. NVE WILL BE RESPONSIBLE FOR SECURING THE POLE OR HAVING SOMEONE PRESENT WHILE QUALIFIED PERSONNEL SECURE THE POLE, AND THERE MAY BE A COST ASSOCIATED WITH THIS WORK, WHICH WILL BE THE RESPONSIBILITY OF THE CONTRACTOR. NO DIRECT PAYMENT.
3. REINSTATE LATERAL USING TOP HAT CONNECTION (REFERENCE DETAIL 6 ON SHEET D-2).

GENERAL NOTES

- A. PIPE LENGTHS SHOWN WERE CALCULATED FROM CENTER OF MANHOLE TO CENTER OF MANHOLE.
- B. PROTECTION OF ALL UTILITIES IS THE RESPONSIBILITY OF THE CONTRACTOR. NOTE THAT THE LOCATION AND/OR ELEVATION OF EXISTING UTILITIES AND FEATURES SHOWN ON THESE DRAWINGS IS APPROXIMATE AND NOT TO BE RELIED ON AS EXACT OR COMPLETE. IT IS THE CONTRACTOR'S RESPONSIBILITY TO POthOLE AND VERIFY THE LOCATIONS AND/OR ELEVATIONS PRIOR TO CONSTRUCTION. DISCREPANCIES BETWEEN THE EXISTING CONDITIONS IN THE FIELD AND THE INFORMATION SHOWN ON THESE DRAWINGS SHALL BE BROUGHT TO THE ATTENTION OF THE ENGINEER BEFORE PROCEEDING WITH CONSTRUCTION.
- C. CONTRACTOR SHALL USE DEBRIS CONTAINMENT DEVICES WHEN WORKING IN AND/OR AROUND ALL SANITARY SEWER MANHOLES, STORM DRAIN MANHOLES AND DROP INLETS.
- D. VERY LIMITED EXISTING UTILITY INFORMATION AVAILABLE FOR SCHOOL, PARK, AND PRIVATE PROPERTIES; CONTRACTOR TO WORK WITH PROPERTY OWNERS AND/OR MAINTENANCE PERSONNEL TO ASSIST WITH LOCATIONS.

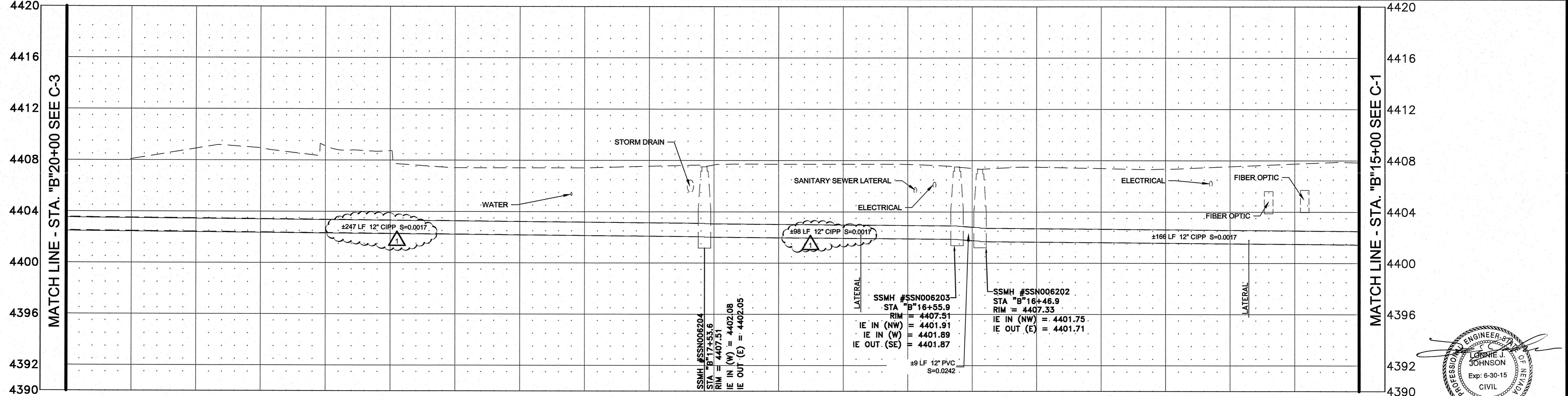

"B" 20+00 "B" 19+00 "B" 18+00 "B" 17+00 "B" 16+00 "B" 15+00

STA. "B" 15+00 TO STA. "B" 20+00

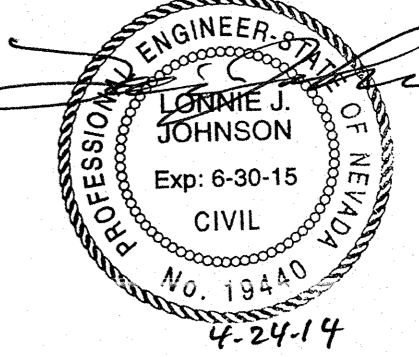

City of Sparks
Community Services

cfa
PLANNERS • ENGINEERS • LANDSCAPE ARCHITECTS
SURVEYORS • CONSTRUCTION OBSERVATION

1150 CORPORATE BLVD. RENO, NV 89502
(775) 856-1150 FAX: (775) 856-1160

SPARKS SANITARY SEWER REHABILITATION
4TH STREET
STA. "B" 15+00 TO "B" 20+00
SPARKS, NV
WASHOE COUNTY NEVADA

JOB NO. 12048.03
DESIGNED BY L.J.
DRAWN BY JDL
SHEET
C-2
15

MATCH LINE - STA. "B"24+00 SEE C-4

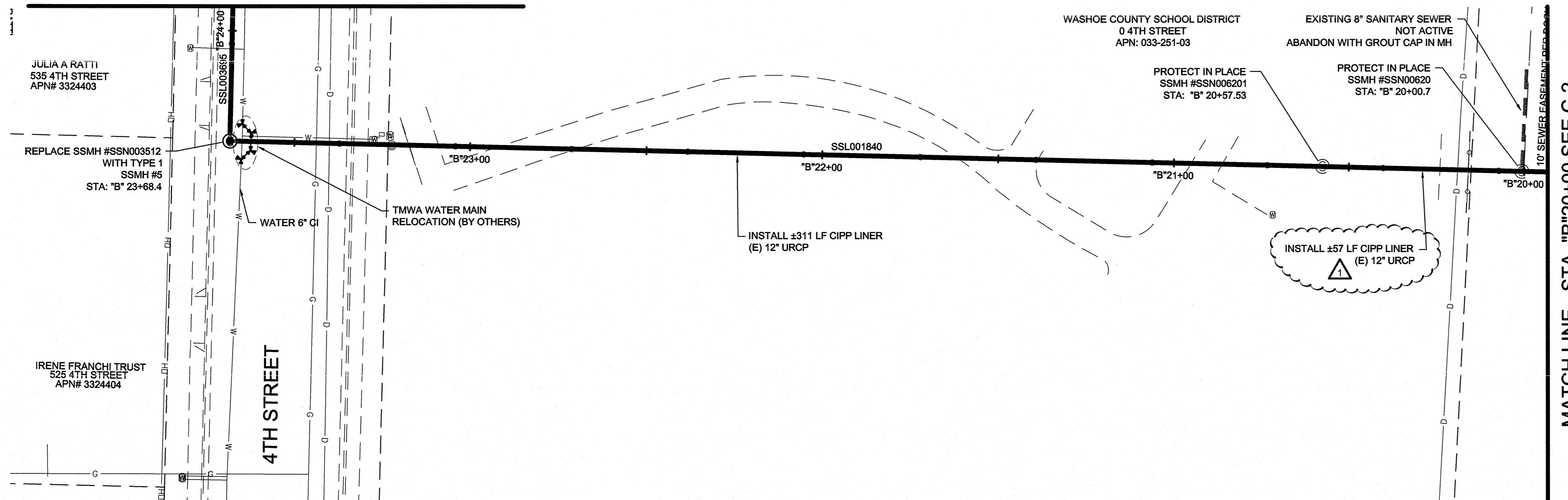

DRAWING SCALE
 22" x34": 1"=20'
 11"x17" : 1"=40'

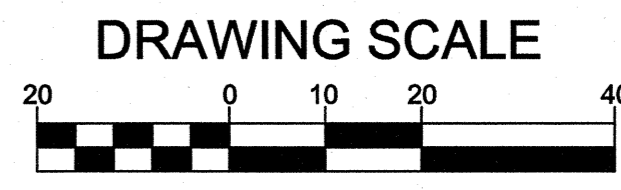

GENERAL NOTES

- A. PIPE LENGTHS SHOWN WERE CALCULATED FROM CENTER OF MANHOLE TO CENTER OF MANHOLE.
- B. PROTECTION OF ALL UTILITIES IS THE RESPONSIBILITY OF THE CONTRACTOR. NOTE THAT THE LOCATION AND/OR ELEVATION OF EXISTING UTILITIES AND FEATURES SHOWN ON THESE DRAWINGS IS APPROXIMATE AND NOT TO BE RELIED ON AS EXACT OR COMPLETE. IT IS THE CONTRACTOR'S RESPONSIBILITY TO POTHOLE AND VERIFY THE LOCATIONS AND/OR ELEVATIONS PRIOR TO CONSTRUCTION. DISCREPANCIES BETWEEN THE EXISTING CONDITIONS IN THE FIELD AND THE INFORMATION SHOWN ON THESE DRAWINGS SHALL BE BROUGHT TO THE ATTENTION OF THE ENGINEER BEFORE PROCEEDING WITH CONSTRUCTION.
- C. CONTRACTOR SHALL USE DEBRIS CONTAINMENT DEVICES WHEN WORKING IN AND/OR AROUND ALL SANITARY SEWER MANHOLES, STORM DRAIN MANHOLES AND DROP INLETS.
- D. VERY LIMITED EXISTING UTILITY INFORMATION AVAILABLE FOR SCHOOL, PARK, AND PRIVATE PROPERTIES; CONTRACTOR TO WORK WITH PROPERTY OWNERS AND/OR MAINTENANCE PERSONNEL TO ASSIST WITH LOCATIONS.

CONSTRUCTION NOTES

- 1] INSTALL TMWA WATER SECTION REPLACEMENT. CONTRACTOR SHALL NOTIFY TMWA A MINIMUM OF 48 HOURS PRIOR TO SECTION REPLACEMENT. SECTION REPLACEMENTS MAY REQUIRE HORIZONTAL AND/OR VERTICAL REALIGNMENT. PRIOR TO CONSTRUCTION, CONTRACTOR SHALL POTHOLE & COORDINATE WITH TMWA AND THE ENGINEER TO DETERMINE ALIGNMENT. DURING CONSTRUCTION, TMWA INSPECTOR MAY APPROVE TO PROTECT IN PLACE EXISTING WATER SECTION (REFERENCE TMWA NOTES ON PAGE 2).
- 2] VERIFY & INSTALL SANITARY SEWER LATERAL USING A FLEXIBLE WYE TAP SADDLE (REFERENCE DETAIL 5 ON SHEET D-2). "INSERT A TEE" CONNECTIONS WILL NOT BE USED. LATERALS SHOWN ARE APPROXIMATE LOCATIONS BASED ON PREVIOUS CCTV AND HAVE NOT BEEN VERIFIED AS ACTIVE LATERALS. CONTRACTOR SHALL VERIFY THAT ALL SANITARY SEWER LATERALS ARE ACTIVE OR INACTIVE PRIOR TO THE INSTALLATION OF ANY MAIN LINE SANITARY SEWER PIPE SEGMENT (MH TO MH). EACH ACTIVE SEWER LATERAL WHERE FLOW IS EVIDENT BY SIMPLE VISUAL INSPECTION SHALL BE RECONNECTED AND DYE TEST VERIFICATION IS REQUIRED TO IDENTIFY SERVICE ADDRESS.

 IF NO INDICATIONS OF FLOW ARE PRESENT THEN A PUSH TYPE CAMERA WITH VIDEO TAPE INSPECTION CAPABILITY SHALL BE USED IN CONJUNCTION WITH CCTV & DYE/SMOKE TESTING TO CONFIRM IF LATERAL IS ACTIVE OR INACTIVE. THE CONTRACTOR SHALL MAINTAIN A LOG OF ALL INACTIVE AND ACTIVE LATERALS PRIOR TO RECONNECTION OR ABANDONMENT PER THE SPECIFICATIONS AND AN INSPECTOR SHALL BE PRESENT DURING ALL LATERAL VERIFICATIONS AND CONNECTIONS TO PROVIDE LOCATION MARK UP FOR GPS.

 LATERAL DIRECTION IS UNKNOWN FOR 12 O' CLOCK LATERALS. CONTRACTOR SHALL VERIFY DIRECTION PRIOR TO INSTALLATION.

 EXCAVATING CLOSER THAN 5 FEET FROM POWER POLE OR ANCHOR WILL REQUIRE THE CONTRACTOR TO NOTIFY AN NV ENERGY INSPECTOR AT 834-7824 SO A DETERMINATION CAN BE MADE IN REGARDS TO SUPPORTING THE POLE UNTIL THE AREA CAN BE BACKFILLED. NVE WILL BE RESPONSIBLE FOR SECURING THE POLE OR HAVING SOMEONE PRESENT WHILE QUALIFIED PERSONNEL SECURE THE POLE, AND THERE MAY BE A COST ASSOCIATED WITH THIS WORK, WHICH WILL BE THE RESPONSIBILITY OF THE CONTRACTOR. NO DIRECT PAYMENT.
- 3] REINSTATE LATERAL USING TOP HAT CONNECTION (REFERENCE DETAIL 6 ON SHEET D-2).

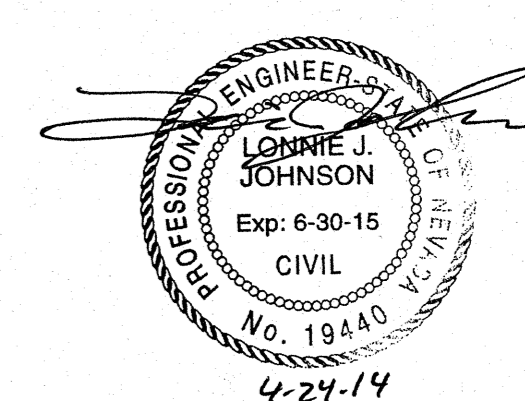
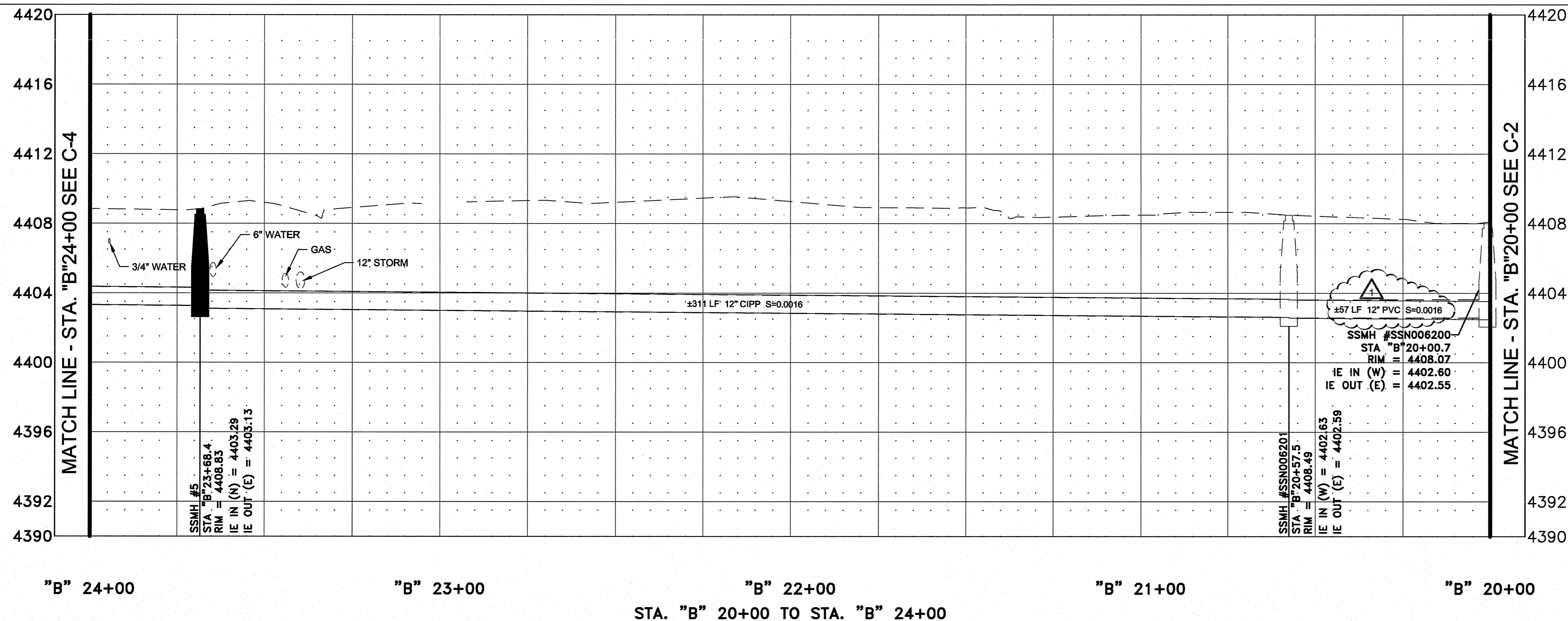

BY: _____
 REVISIONS: _____
 DATE: _____
 MARK: _____

ADENDUM #1
 4-24-14

City of Sparks
 Community Services

cfa
 PLANNERS • ENGINEERS • LANDSCAPE ARCHITECTS
 SURVEYORS • CONSTRUCTION OBSERVATION
 1150 CORPORATE BLVD., RENO, NV 89502
 (775) 856-1150 FAX: (775) 856-1180

NEVADA

SPARKS SANITARY SEWER REHABILITATION
 4TH STREET
 STA. "B"20+00 TO "B"24+00
 SPARKS, NV

WASHOE COUNTY

JOB NO. 12048.03
 DESIGNED BY: L.J.
 DRAWN BY: JDL

SHEET
C-3
 15