

CITY OF SPARKS SPRINGLAND SEWER IMPROVEMENT PLANS PWP #WA-2025-080, BID#24/25-007 JANUARY 2025

ENGINEER

CITY OF SPARKS OFFICIALS

ED LAWSON	MAYOR
DONALD ABBOTT	COUNCIL MEMBER WARD 1
DIAN VANDERWELL	COUNCIL MEMBER WARD 2
PAUL ANDERSON	COUNCIL MEMBER WARD 3
CHARLENE BYBEE	COUNCIL MEMBER WARD 4
JOE RODRIGUEZ	COUNCIL MEMBER WARD 5
DION LOUTHAN	CITY MANAGER

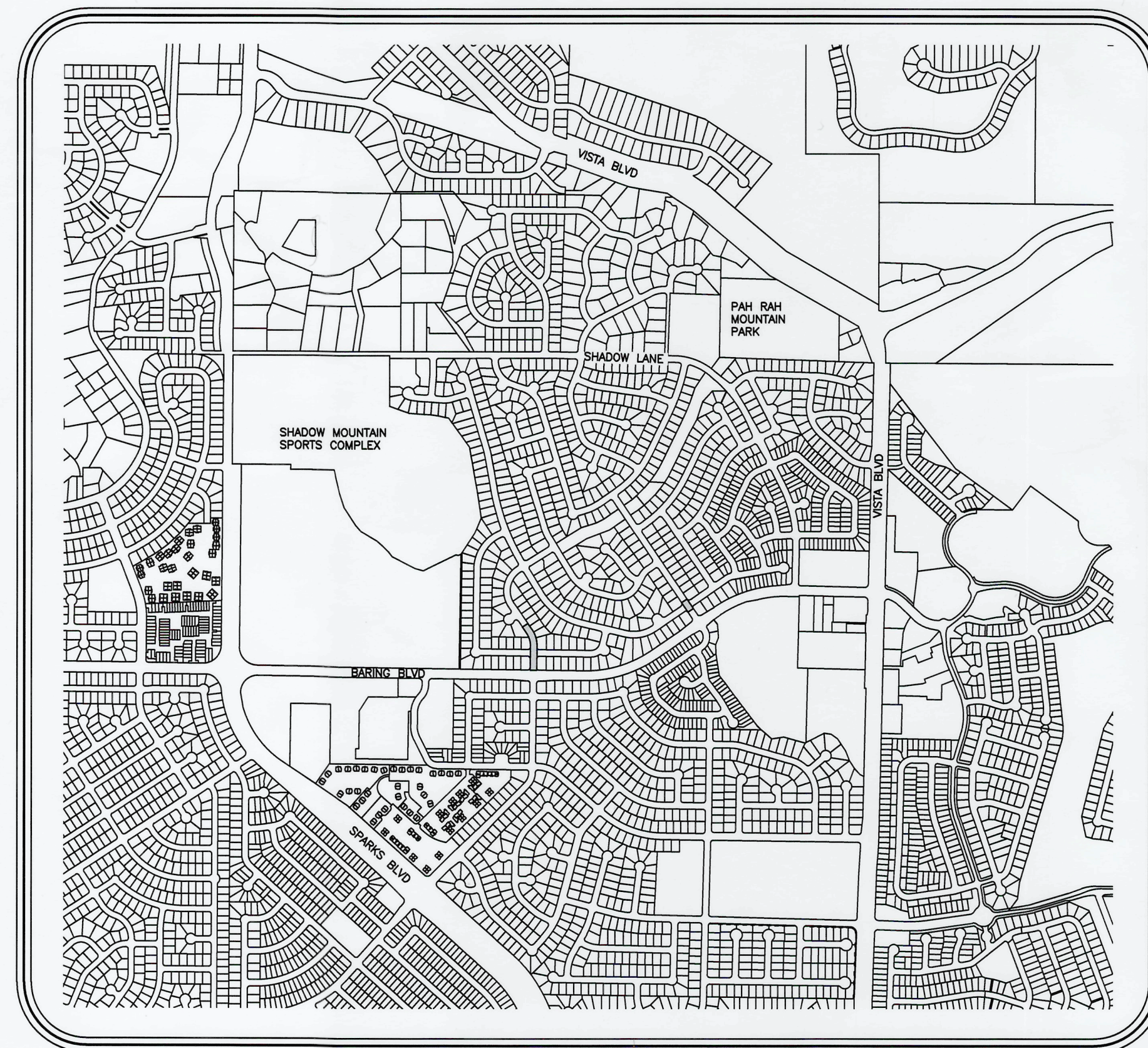

VICINITY MAP

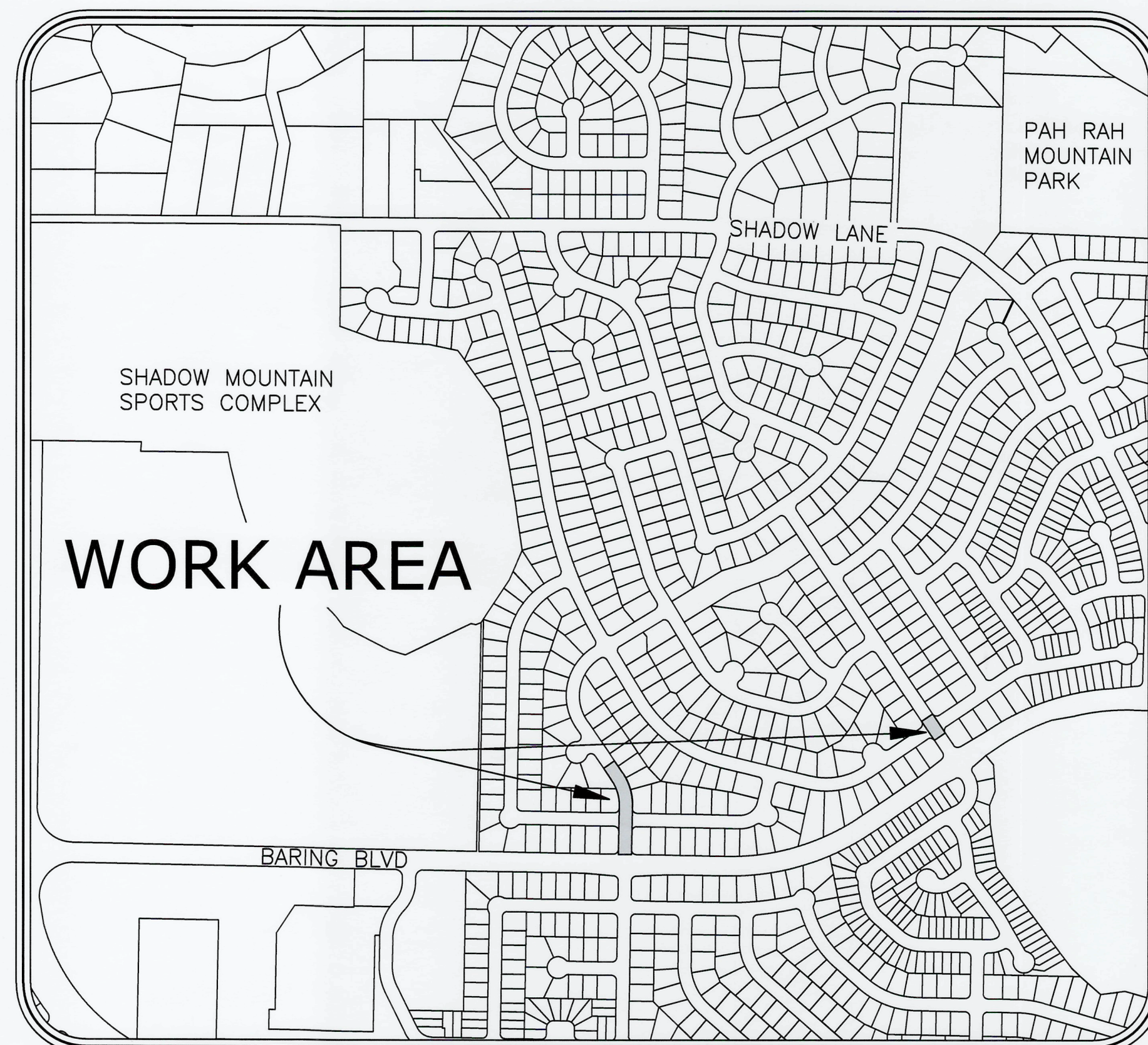

SITE PLAN



683 EDISON WAY - RENO, NEVADA 89502
PH 775-771-5554 / FX 775-357-8421

SHEET INDEX

- C-1 TITLE SHEET
- C-2 SPRINGLAND PLAN & PROFILE
- C-3 ROUND MOUNTAIN PLAN
- C-4 DETAIL SHEET
- C-5 DETAIL SHEET

ABBREVIATIONS

AC ASPHALT CEMENT	LP LOW POINT
BC BEGINNING OF CURVE	M.D.D. MAXIMUM DRY DENSITY
BF BOTTOM OF FOOTING	MIN. MINIMUM
BFC BACK FACE OF CURB	MPOC MID POINT OF CURVE
BVC BEGINNING OF VERTICAL CURVE	PI POINT OF INTERSECTION
CB CATCH BASIN	PCC POINT OF COMPOUND CURVATURE
CL CENTERLINE	PRC POINT OF REVERSE CURVATURE
DI DROP INLET	PVC POLYVINYL CHLORIDE
ELEV. ELEVATION	R RADIUS
EC END OF CURVE	REF. REFERENCE
EP EDGE OF PAVEMENT	RET. RETURN
EVC END OF VERTICAL CURVE	RCP REINFORCED CONCRETE PIPE
EX EXISTING	RT. RIGHT
(e) EXISTING	R/W RIGHT OF WAY
E ELECTRIC	SD STORM DRAIN
FF FINISH FLOOR	SS SANITARY SEWER
FFC FRONT FACE OF CURB	SF SQUARE FEET
FG FINISH GRADE	SSMH SANITARY SEWER MANHOLE
FH FIRE HYDRANT ASSEMBLY	SDMH STORM DRAIN MANHOLE
FL FLOW LINE	S SLOPE
FO FIBER OPTICS/COMMUNICATION	STA. STATION
G GAS	TC TOP OF CURB
GB GRADE BREAK	TB TEST BORING
HORIZ. HORIZONTAL	VC VERTICAL CURB
IE INVERT ELEVATION	VPI VERTICAL POINT OF INTERSECTION
LAT. LATERAL	W WATER
LT. LEFT	WM WATER METER
LF LINEAR FEET	

APPROVED BY: *Amber Sosa* DATE: 2-4-2025
AMBER SOSA, P.E.
CITY ENGINEER

APPROVED BY: *Gary K. Guzelis* DATE: 2/1/25
GARY K. GUZELIS, P.E.
AXION ENGINEERING

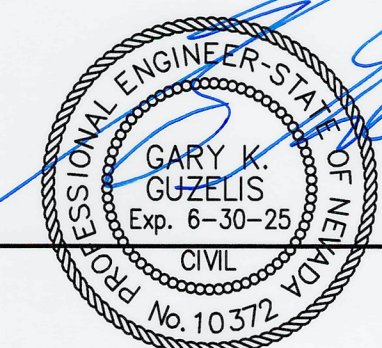

TITLE SHEET

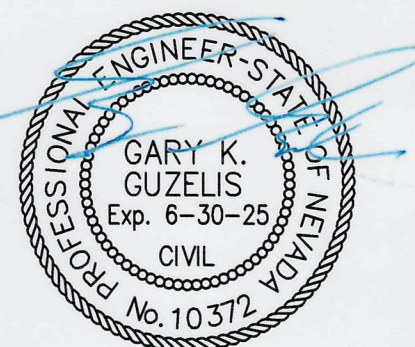

**SEWER IMPROVEMENT PLANS FOR
SPRINGLAND DRIVE CIP5
SPARKS, NEVADA**

revisions

NO.	DESCRIPTION

drawn: GKG
checked: GKG
date: JANUARY 2025
scale:
project no: 22038

C-1

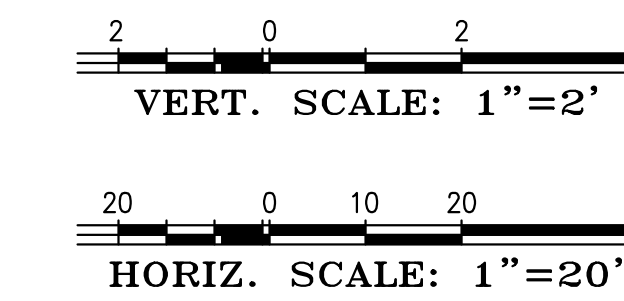
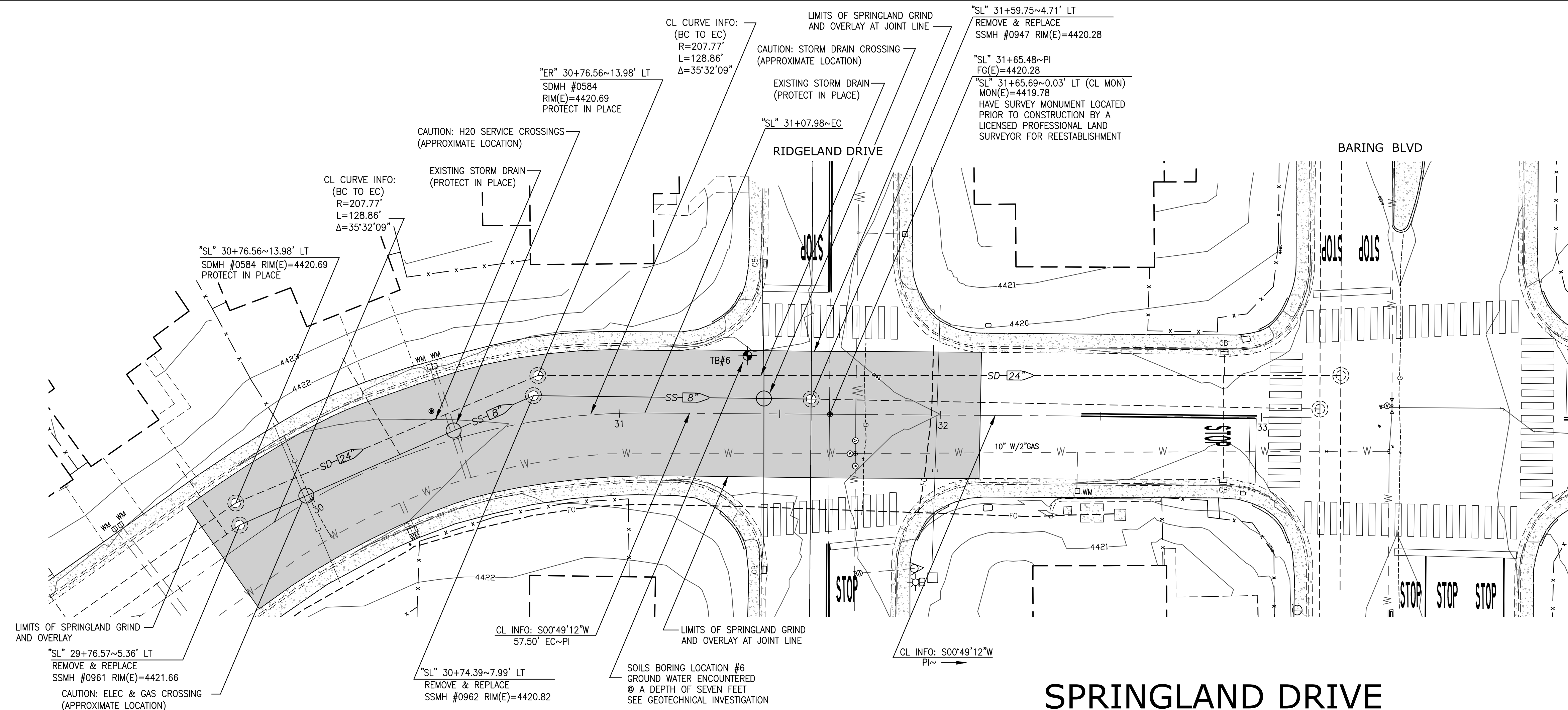

- LEGEND**
- SS-18 SANITARY SEWER MAIN (DASHED IF EXISTING)
 - SD-12 STORM DRAIN MAIN (DASHED IF EXISTING)
 - MANHOLE (DASHED IF EXISTING)
 - A.C. PAVING AREA
 - CONCRETE SIDEWALK
 - CATCH BASIN
 - FIRE HYDRANT ASSEMBLY
 - 12" W WATER AND GAS MAIN (DASHED IF EXISTING)
 - 4500 EXISTING CONTOUR LINE
 - VALVE
 - SEWER LATERAL
 - SURVEY MONUMENT
 - STREET LIGHT

NOTE:
TRENCH SAWCUT LIMITS TO BE DETERMINED BY CONTRACTOR.

SPRINGLAND DRIVE

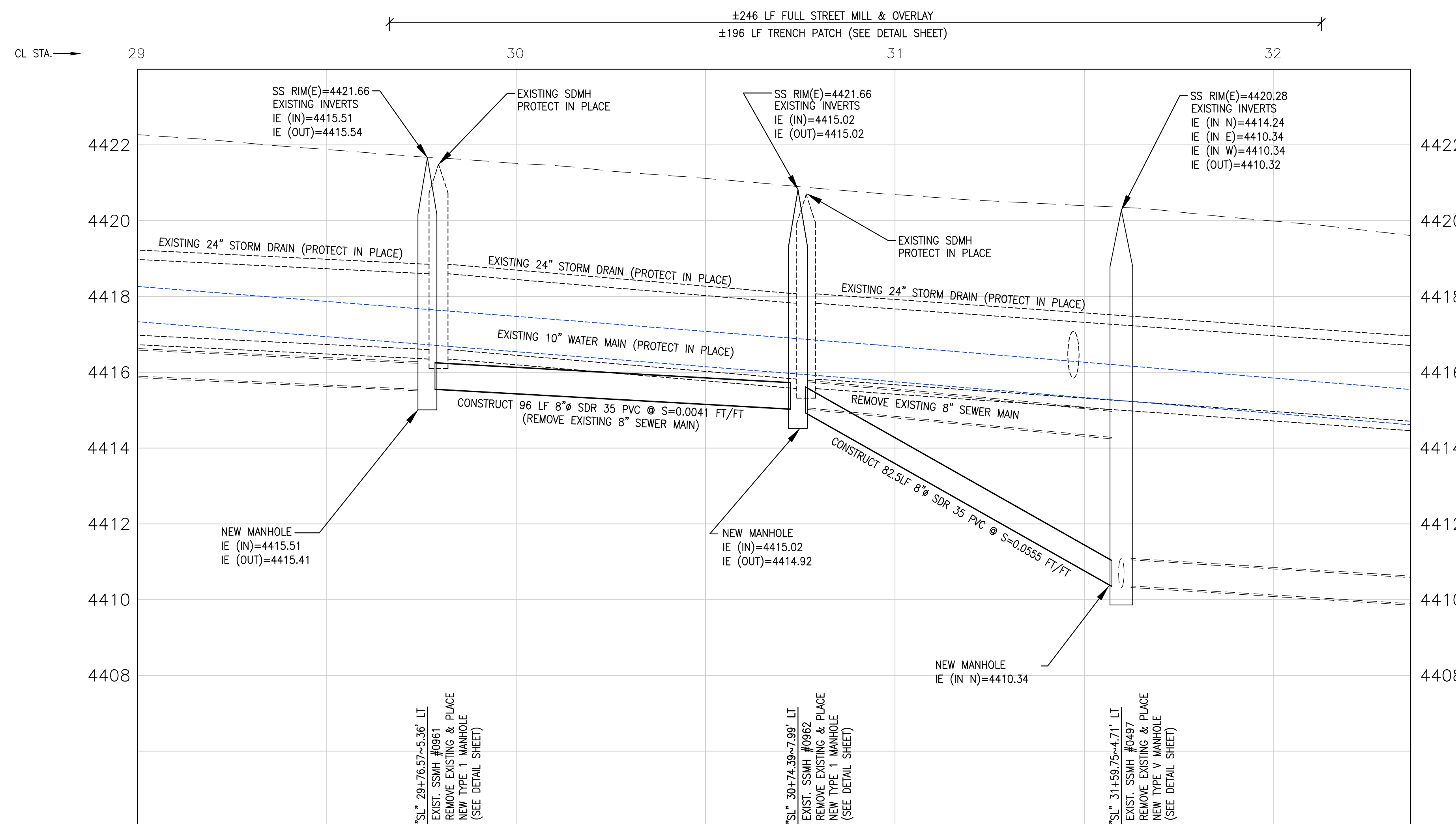

NOTE:
PROTECT IN PLACE ALL EXISTING STORM DRAIN, WATER MAIN AND UTILITY FACILITIES THROUGH THE COURSE OF CONSTRUCTION.

SEWER IMPROVEMENT PLANS FOR SPRINGLAND DRIVE CIP5

SPARKS, NEVADA

revisions	

drawn: GKG
checked: GKG
date: JANUARY 2025
scale: 1"=20'
project no: 22038

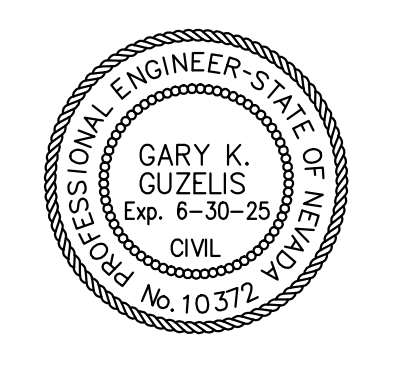

N:\Axion Engineering\Projects\AEC\City of Sparks\Sparks, CIP 5 Springland Drawings\Revised 2024\CIP 5 Base.dwg

**SEWER IMPROVEMENT PLANS FOR
SPRINGLAND DRIVE CIP5**
SPARKS, NEVADA

revisions	drawn:	checked:	date:	scale:	project no:
	GKG	GKG	JANUARY 2025	1"=20'	22038

N:\Axion Engineering\Projects\AE\City of Sparks\Sparks, CIP-5 Springland\Drawings\Revised 2024\CIP-5 Base.dwg

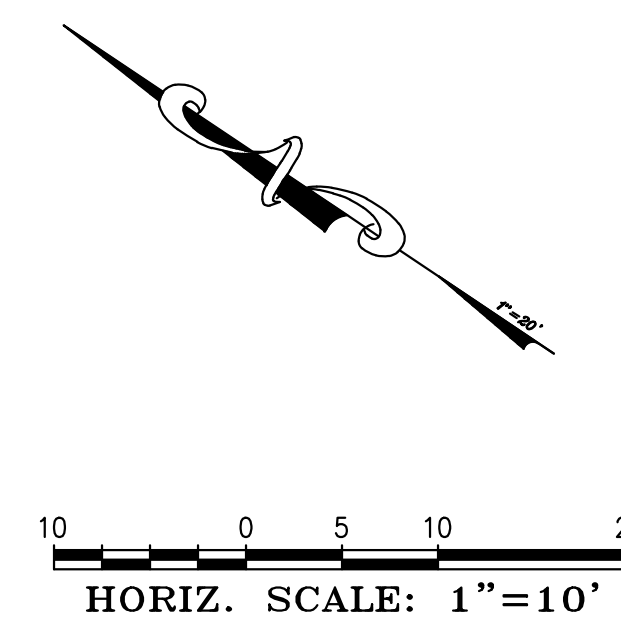
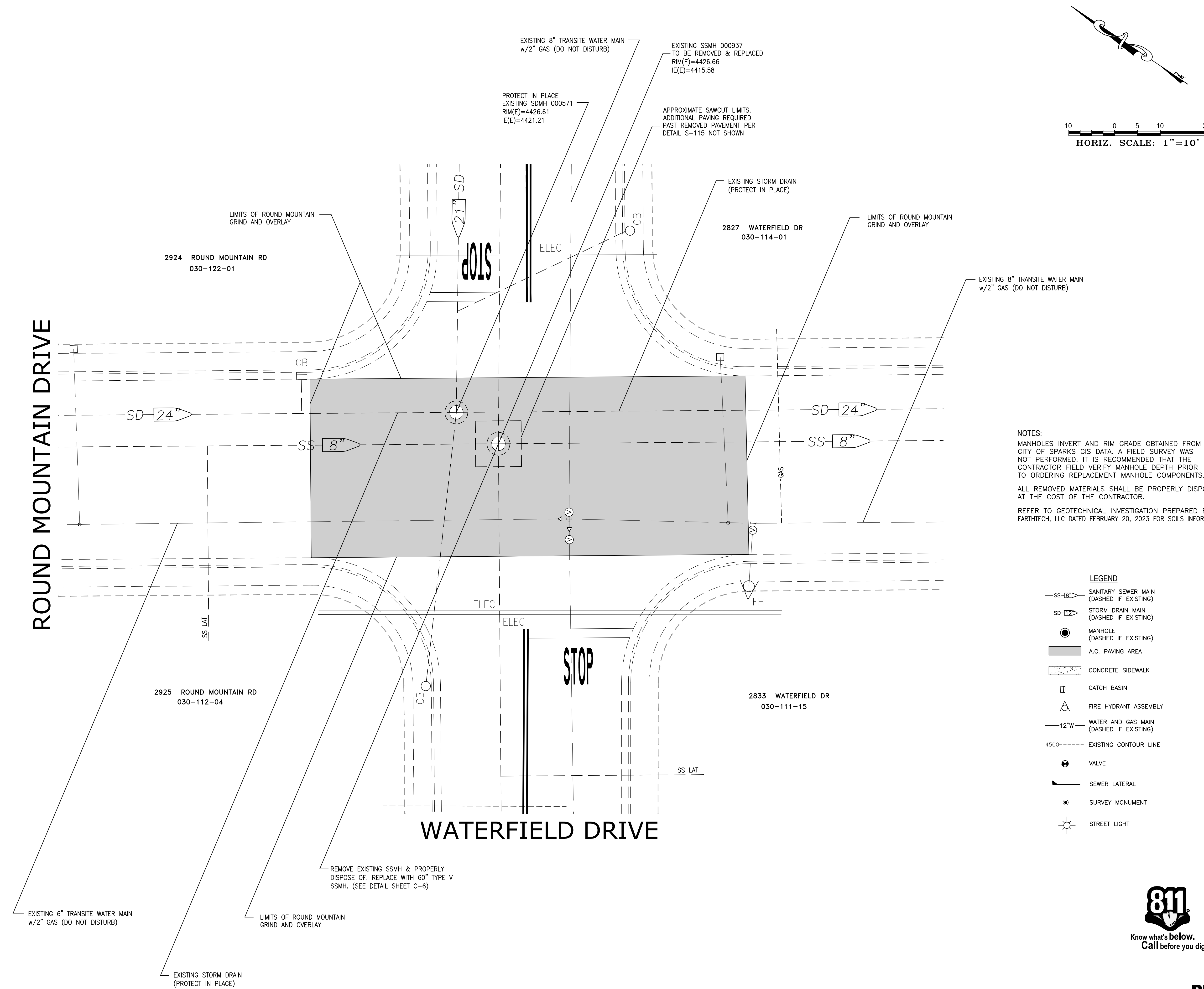

NOTES:
MANHOLES INVERT AND RIM GRADE OBTAINED FROM CITY OF SPARKS GIS DATA. A FIELD SURVEY WAS NOT PERFORMED. IT IS RECOMMENDED THAT THE CONTRACTOR FIELD VERIFY MANHOLE DEPTH PRIOR TO ORDERING REPLACEMENT MANHOLE COMPONENTS.
ALL REMOVED MATERIALS SHALL BE PROPERLY DISPOSED AT THE COST OF THE CONTRACTOR.
REFER TO GEOTECHNICAL INVESTIGATION PREPARED BY EARTHTECH, LLC DATED FEBRUARY 20, 2023 FOR SOILS INFORMATION.

- LEGEND**
- SS-8" SANITARY SEWER MAIN (DASHED IF EXISTING)
 - SD-24" STORM DRAIN MAIN (DASHED IF EXISTING)
 - MANHOLE (DASHED IF EXISTING)
 - A.C. PAVING AREA
 - ▨ CONCRETE SIDEWALK
 - CATCH BASIN
 - △ FIRE HYDRANT ASSEMBLY
 - 12"W WATER AND GAS MAIN (DASHED IF EXISTING)
 - 4500--- EXISTING CONTOUR LINE
 - VALVE
 - SEWER LATERAL
 - SURVEY MONUMENT
 - ☀ STREET LIGHT



PLAN

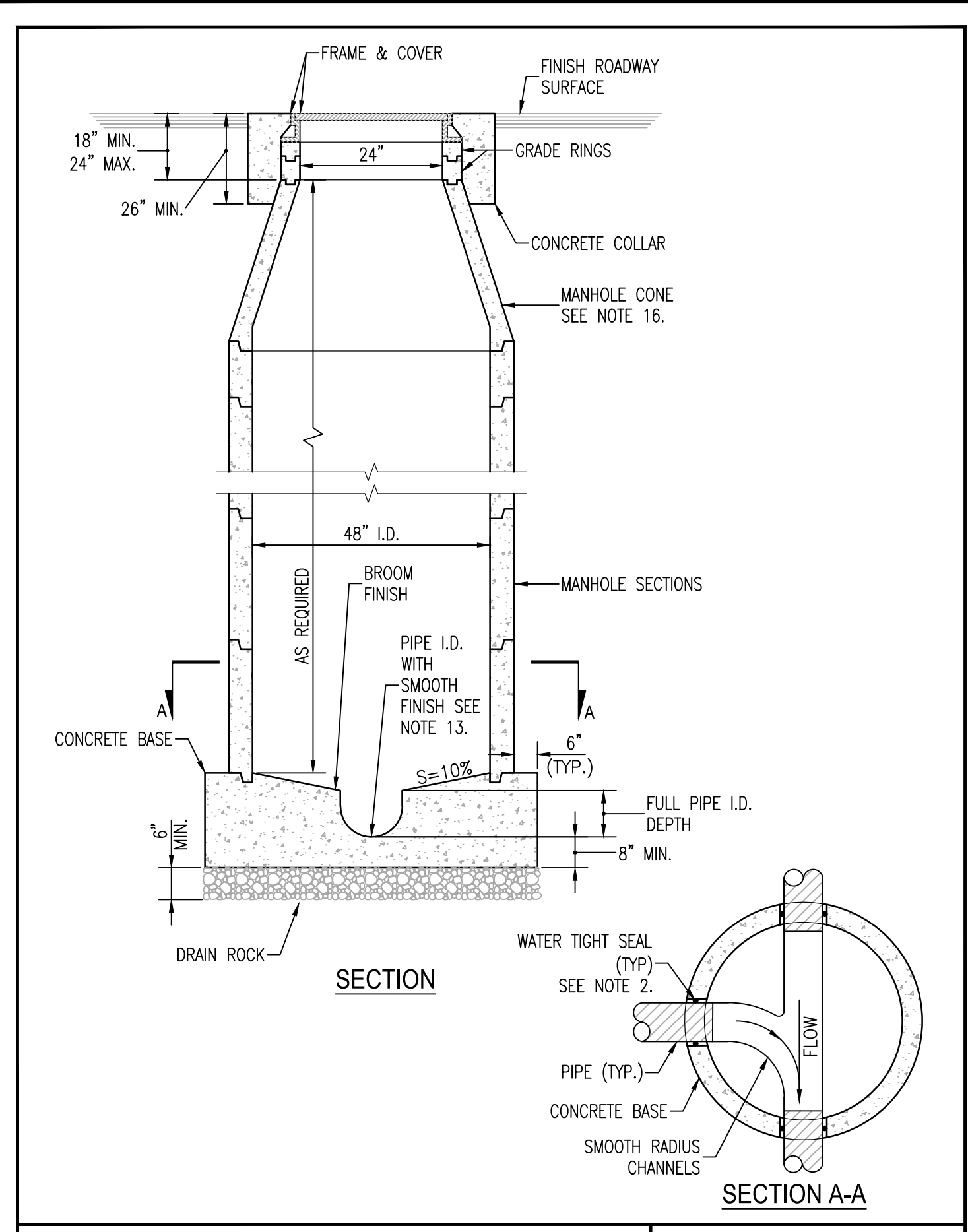

STANDARD DETAILS FOR PUBLIC WORKS CONSTRUCTION DRAWING No. S-206A
City of Sparks MANHOLE TYPE I S-206A
 APPROVED BY: JE DATE: 1/2020

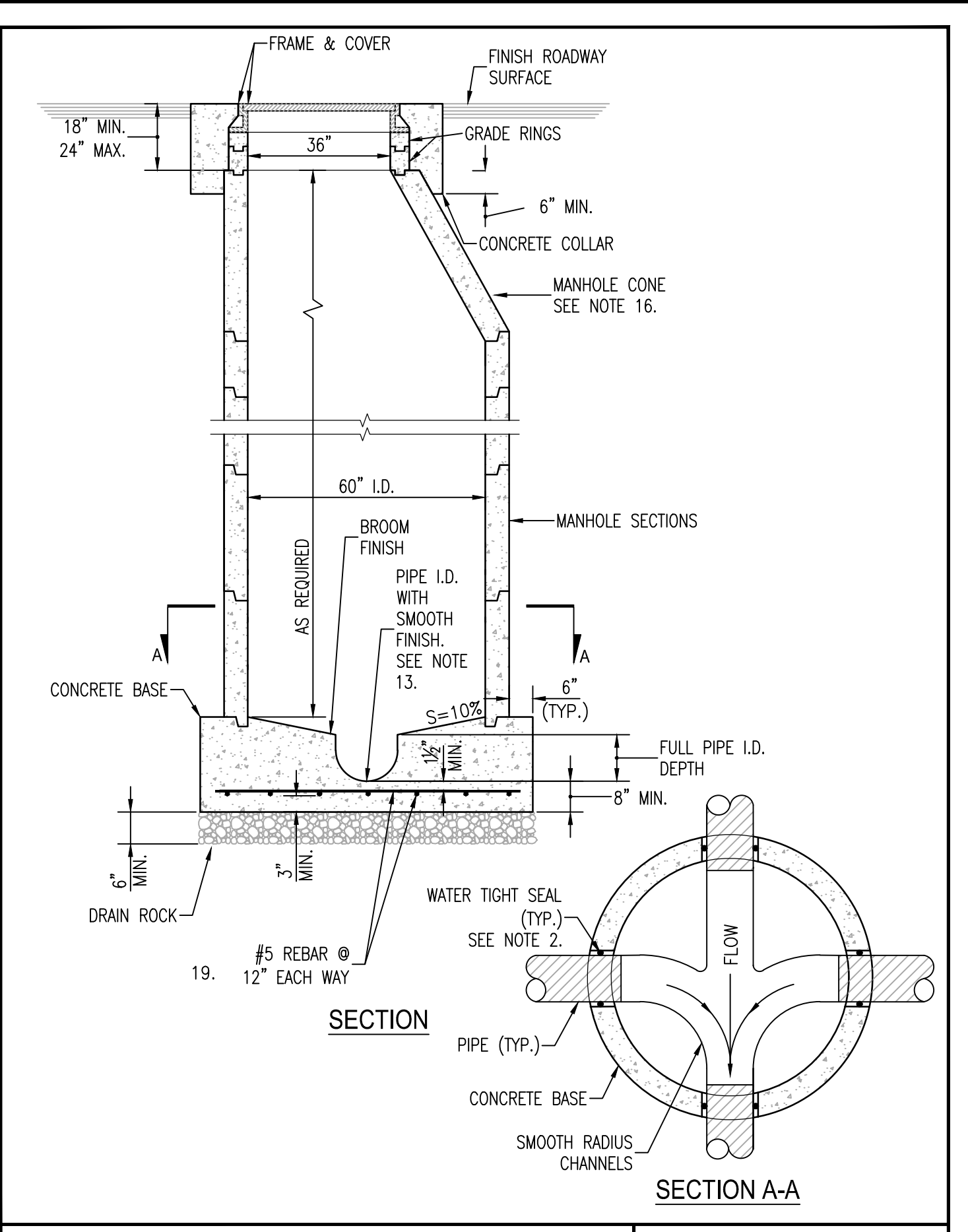

STANDARD DETAILS FOR PUBLIC WORKS CONSTRUCTION DRAWING No. S-206B
City of Sparks MANHOLE TYPE V S-206B
 APPROVED BY: JE DATE: 1/2020

- NOTES:
- SEWER LATERALS SHALL HAVE A MINIMUM PIPE DIAMETER OF 4-INCHES.
 - ALL PLASTIC PIPE USED FOR SEWER SERVICE LATERAL CONSTRUCTION SHALL BE SOLID WALL AND SHALL MEET THE REQUIREMENTS OF D-2412, HAVE A MINIMUM STIFFNESS OF 46 PSI AS DEFINED BY THE REQUIREMENTS OF ASTM D-3034.
 - SERVICE LATERALS SHALL HAVE A MINIMUM SLOPE OF 1/4-INCH PER FOOT UNLESS OTHERWISE APPROVED BY THE CITY ENGINEER.
 - SEWER LATERALS SHALL HAVE A MINIMUM COVER OF 36-INCHES IN THE PUBLIC RIGHT-OF-WAY AND IN EASEMENTS UNLESS OTHERWISE APPROVED BY THE CITY ENGINEER. THE DEFINITION OF "COVER" IS THE DISTANCE FROM THE TOP OF PIPE TO FINISHED GRADE.
 - USE OF SEWER SERVICE TAP SADDLE CONNECTIONS SHALL NOT BE ALLOWED FOR NEW SEWER MAIN CONSTRUCTION. WHEN A TAP SADDLE CONNECTION IS TO BE USED ON AN EXISTING SEWER MAIN, IT SHALL BE A WYE SADDLE AND BE INSTALLED PER DETAIL S-212C.
 - SEWER LATERALS SHALL HAVE A CLEANOUT INSTALLED BETWEEN SIDEWALK AND RIGHT-OF-WAY. A G5 BOX CLEARLY MARKED "SEWER" SHALL BE INSTALLED OVER THE TOP OF THE CLEANOUT RISER CAP PIPE.
 - SEWER LATERALS SHALL NOT BE CONNECTED DIRECTLY TO OR WITHIN 5-FEET OF A MANHOLE STRUCTURE.
 - EXISTING SEWER LATERALS SHALL BE CUT BACK TO SOUND MATERIAL FOR COUPLING. PLACE 6-INCH THICK CONCRETE PAD UNDER CONNECTION.
 - SEWER LATERAL CONNECTION SHALL BE STABILIZED WITH APPROVED MATERIAL FOLLOWING INSTALLATION. CONNECTION TO CITY SEWER MAIN MUST BE INSPECTED BY THE CITY PRIOR TO BACKFILL.
 - NO LATERAL CONNECTIONS SHALL BE MADE DIRECTLY TO A SANITARY SEWER "INTERCEPTOR" UNLESS APPROVED BY THE CITY ENGINEER.
 - SEWER LATERALS SHALL NOT BE CONNECTED TO A SEWER MAIN UNLESS THE CONNECTION POINT IS BETWEEN TWO MANHOLE STRUCTURES.
 - EACH INDIVIDUAL PARCEL SHALL HAVE A MINIMUM OF ONE SEWER LATERAL. TWO OR MORE PARCELS SHALL NOT SHARE ONE SEWER LATERAL.
 - SANITARY SEWER LATERAL IDENTIFICATION AND LOCATING REQUIREMENTS SHALL BE PER SPARKS MUNICIPAL CODE 17.16.130 (SMC 17.16.130).
 - DISCONTINUANCE OF USE OF AN EXISTING SEWER LATERAL REQUIRES ABANDONMENT OF THE LATERAL. CUT, REMOVE 1-FOOT OF EXISTING LATERAL AND CAP BOTH ENDS OF THE EXISTING SEWER LATERAL TO BE ABANDONED WITHIN 6-INCHES OF THE SEWER MAIN. ABANDONMENT MUST BE INSPECTED BY CITY PRIOR TO BACKFILL.
 - PROPERTY OWNER SHALL BE RESPONSIBLE FOR OPERATION, MAINTENANCE AND REPAIR OF THE SEWER LATERAL WITHIN THE PUBLIC RIGHT-OF-WAY PER SPARKS MUNICIPAL CODE.

STANDARD DETAILS FOR PUBLIC WORKS CONSTRUCTION DRAWING No. S-212B
City of Sparks NOTES - SANITARY SEWER LATERAL S-212B
 APPROVED BY: JE DATE: 1/2020

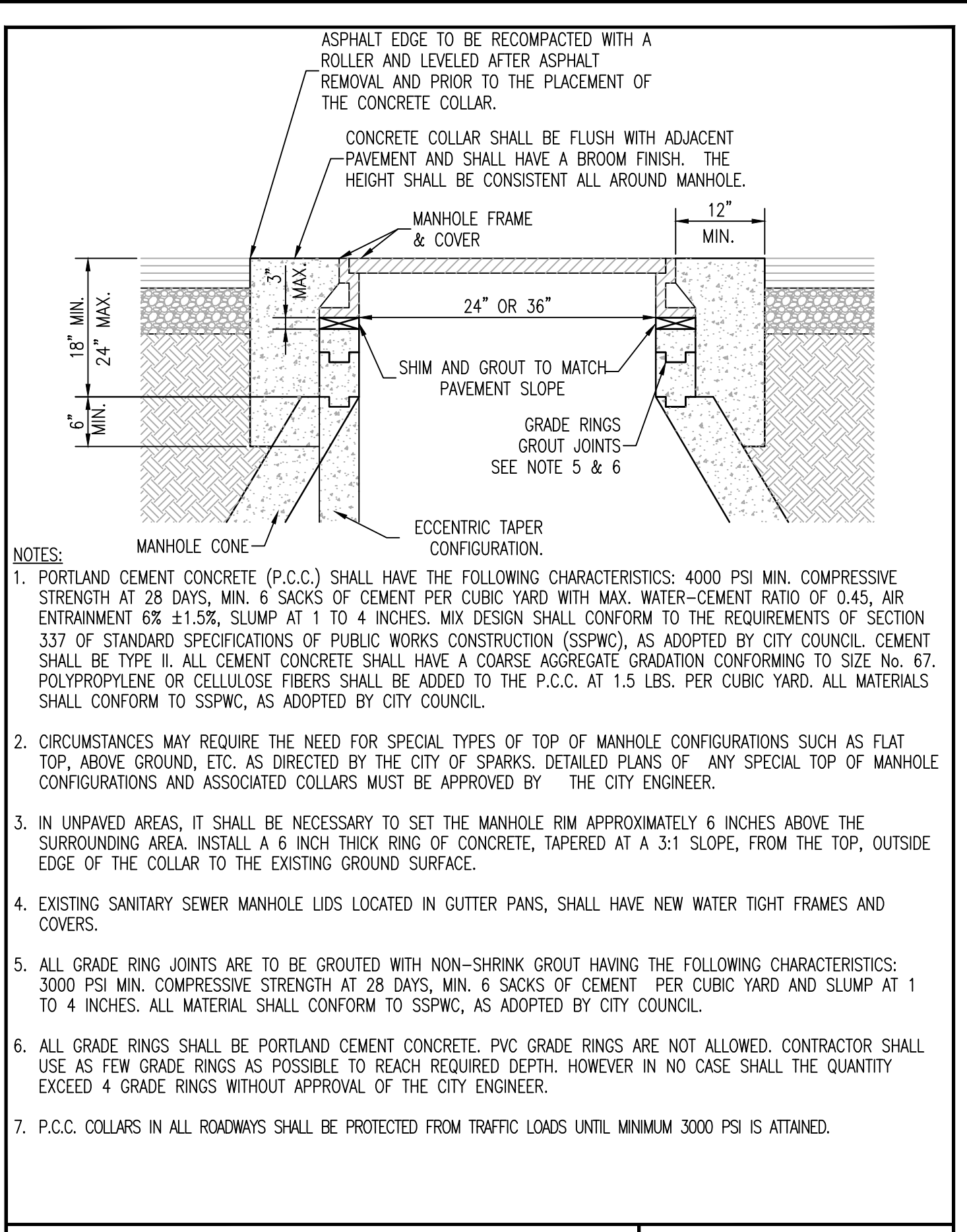

STANDARD DETAILS FOR PUBLIC WORKS CONSTRUCTION DRAWING No. S-210A
City of Sparks MANHOLE COLLAR S-210A
 APPROVED BY: JE DATE: 1/2020

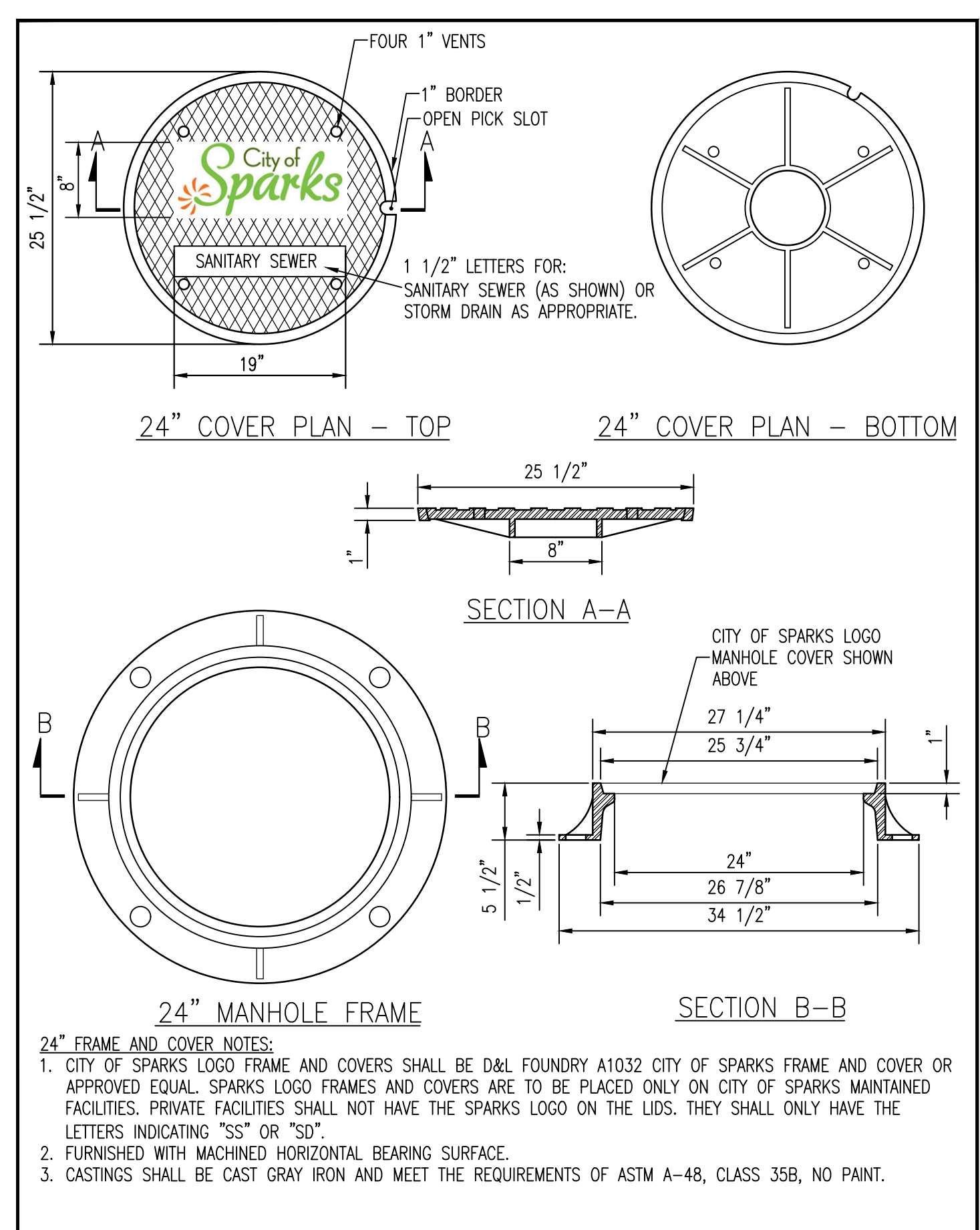

STANDARD DETAILS FOR PUBLIC WORKS CONSTRUCTION DRAWING No. S-209A
City of Sparks 24" MANHOLE FRAME & COVER S-209A
 APPROVED BY: JE DATE: 2/2020

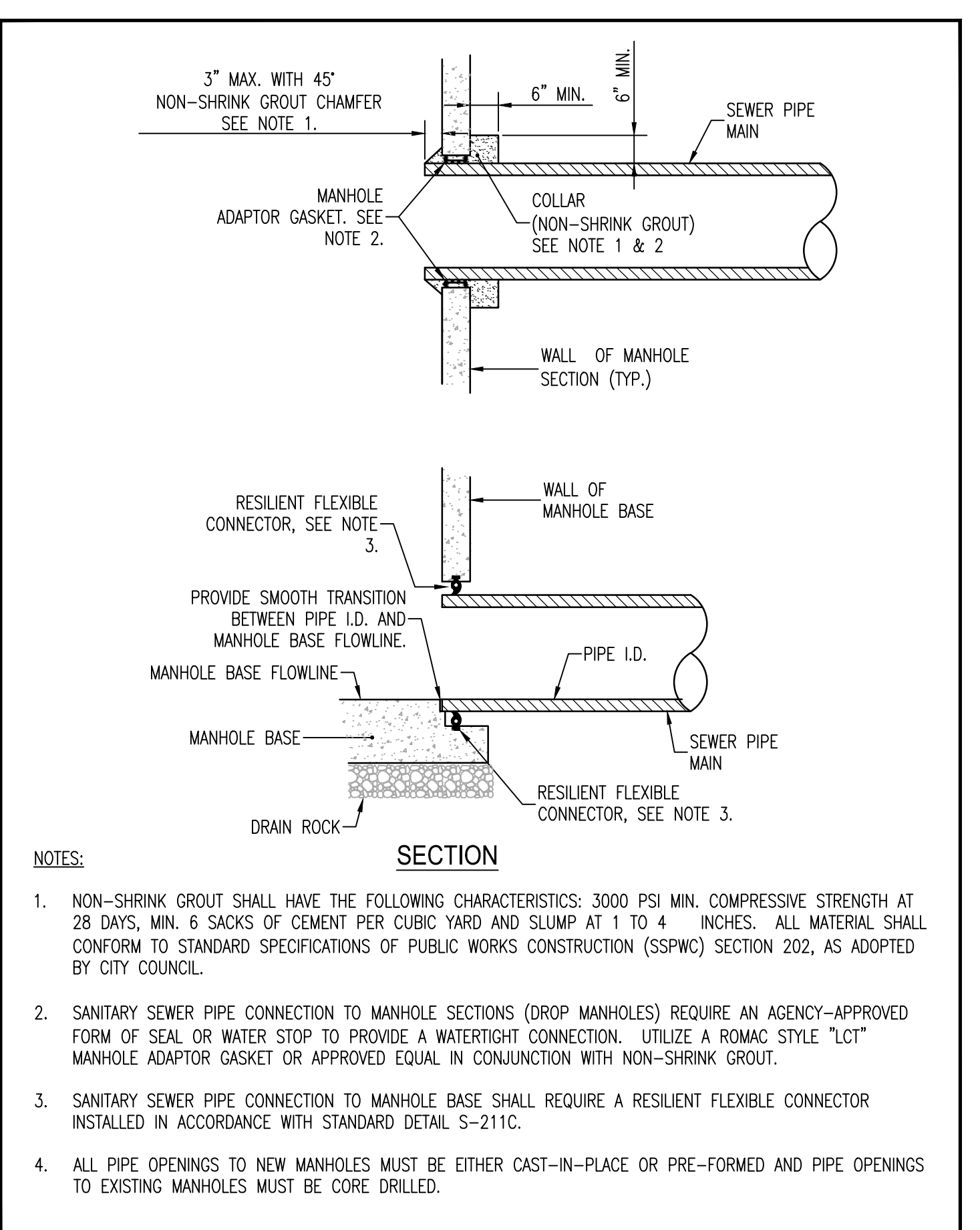

STANDARD DETAILS FOR PUBLIC WORKS CONSTRUCTION DRAWING No. S-211A
City of Sparks SANITARY SEWER PIPE TO MANHOLE CONNECTION S-211A
 APPROVED BY: JE DATE: 1/2020

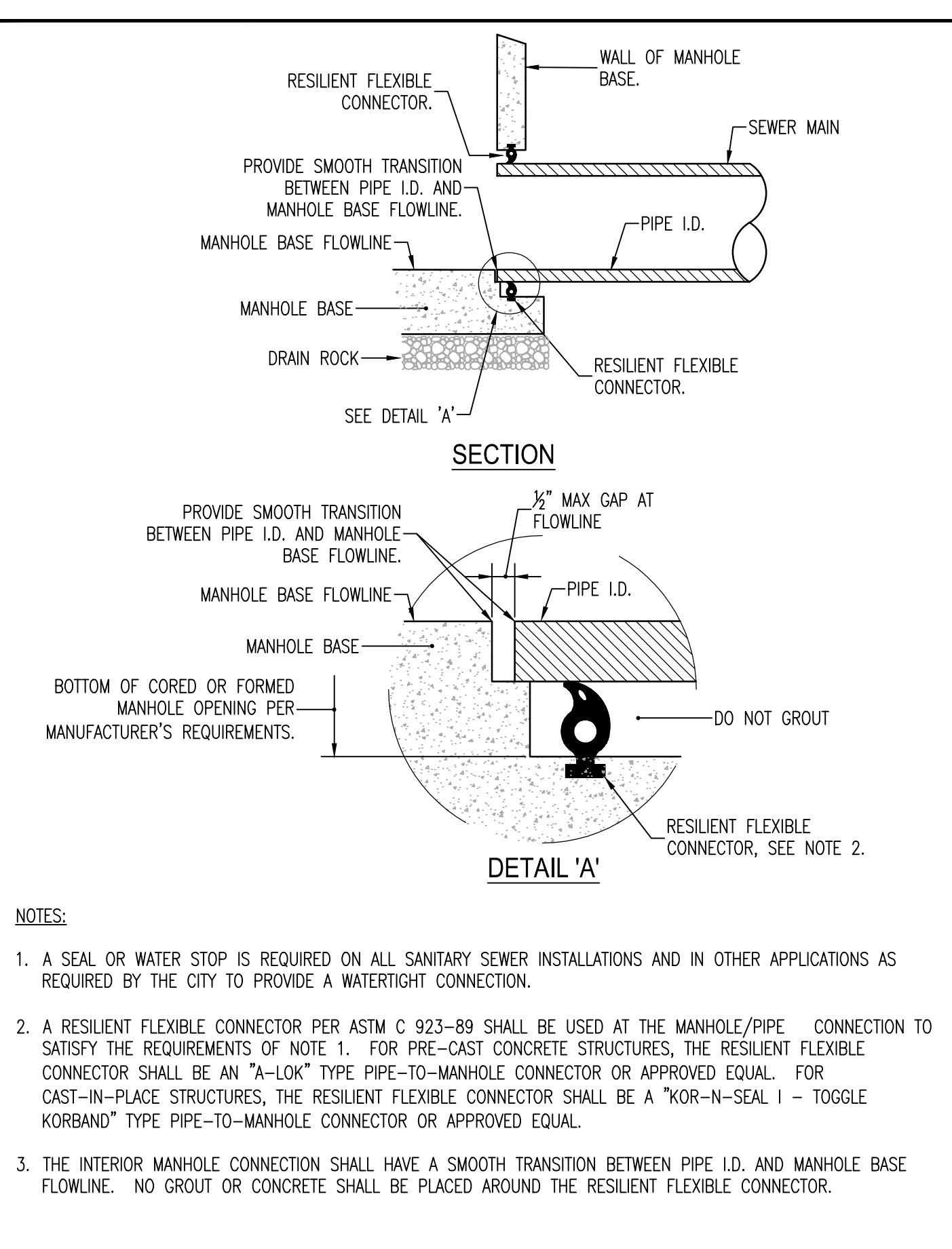

STANDARD DETAILS FOR PUBLIC WORKS CONSTRUCTION DRAWING No. S-211C
City of Sparks RESILIENT FLEXIBLE CONNECTOR S-211C
 APPROVED BY: JE DATE: 1/2020

- NOTES:
- A SEAL OR WATER STOP IS REQUIRED ON ALL SANITARY SEWER INSTALLATIONS AND IN OTHER APPLICATIONS AS REQUIRED BY THE CITY TO PROVIDE A WATERTIGHT CONNECTION.
 - A RESILIENT FLEXIBLE CONNECTOR PER ASTM C 923-89 SHALL BE USED AT THE MANHOLE/PIPE CONNECTION TO SATISFY THE REQUIREMENTS OF NOTE 1. FOR PRE-CAST CONCRETE STRUCTURES, THE RESILIENT FLEXIBLE CONNECTOR SHALL BE AN "A-LOK" TYPE PIPE-TO-MANHOLE CONNECTOR OR APPROVED EQUAL. FOR CAST-IN-PLACE STRUCTURES, THE RESILIENT FLEXIBLE CONNECTOR SHALL BE A "KOR-N-SEAL 1 - TOGGLE KORBAND" TYPE PIPE-TO-MANHOLE CONNECTOR OR APPROVED EQUAL.
 - THE INTERIOR MANHOLE CONNECTION SHALL HAVE A SMOOTH TRANSITION BETWEEN PIPE I.D. AND MANHOLE BASE FLOWLINE. NO GROUT OR CONCRETE SHALL BE PLACED AROUND THE RESILIENT FLEXIBLE CONNECTOR.

DETAIL SHEET

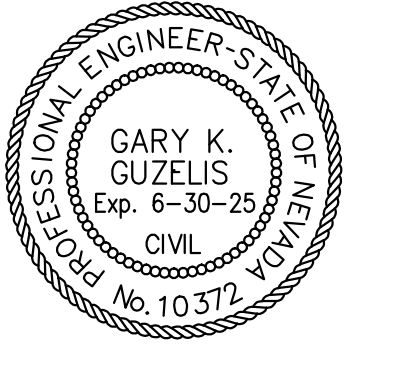

SEWER IMPROVEMENT PLANS FOR
SPRINGLAND DRIVE CIP5
 SPARKS, NEVADA

revisions	

drawn: GKG
 checked: GKG
 date: JANUARY 2025
 scale:
 project no: 22038

SECTION A-A

SIDE VIEW

NOTES:

- EXISTING SEWER MAINS SHALL BE CORE DRILLED UTILIZING A DRILL GUIDE FOR A WYE SADDLE AND A CORE DRILL WITH A LENGTH EXCEEDING THE LATERAL DIAMETER, INSERT-A-DRILL ID175, & EXTRA LONG HOLE SAW OR APPROVED EQUAL. DIAMOND CORE BITS SHALL BE USED ON NON-PVC MAINS.
- SERVICE TAP SADDLES SHALL BE INSERT-A-TEE OR APPROVED EQUAL. A ROMAC STYLE "CB" SEWER SADDLE OR APPROVED EQUAL MAY BE USED ON EXISTING SEWER MAINS ONLY WHEN MAIN IS NOT PVC.
- SADDLES SHALL BE INSTALLED AT 45 DEGREES TO MAIN AS SHOWN IN SECTION A-A. IN NO CASE SHALL A LATERAL CONNECTING TO THE EXISTING SEWER MAIN BE LOCATED DIRECTLY ON TOP OF THE PIPE, NOR SHALL IT MATCH THE FLOWLINE OF THE PIPE.
- USE INSERT-A-TEE OR APPROVED EQUAL.

STANDARD DETAILS FOR PUBLIC WORKS CONSTRUCTION	DRAWING No.
SANITARY SEWER TAP SADDLE	S-212C
APPROVED BY: JE DATE: 1/2020	

NOTES:

- ALL MATERIALS AND INSTALLATION PROCEDURES SHALL BE IN ACCORDANCE WITH STANDARD SPECIFICATIONS FOR PUBLIC WORKS CONSTRUCTION (SSPWC), AS ADOPTED BY CITY COUNCIL.
- BEDDING MATERIAL SHALL CONFORM TO OWNING-UTILITY COMPANY REQUIREMENTS AS APPROVED BY THE CITY OF SPARKS. FOR CITY-OWNED UTILITIES, BEDDING MATERIAL SHALL BE CLASS A OR C, COMPACTED TO MINIMUM 90% RELATIVE COMPACTION. MATERIALS SHALL CONFORM TO SSPWC SECTION 200, AS ADOPTED BY CITY COUNCIL.
- CLASS C BEDDING REQUIRES INSTALLATION OF GEOTEXTILE FABRIC BETWEEN PIPE ZONE AND BACKFILL MATERIAL. GEOTEXTILE FABRIC SHALL BE MIRAFI 180N OR APPROVED EQUAL.
- BACKFILL MATERIAL SHALL BE TYPE 2, CLASS B OR CLASS E AND COMPACTED TO MINIMUM 90% RELATIVE COMPACTION. MATERIALS SHALL CONFORM TO SSPWC SECTION 200, AS ADOPTED BY CITY COUNCIL.
- ALL EXCAVATIONS SHALL CONFORM TO THE LATEST O.S.H.A. REQUIREMENTS.
- EXISTING PIPE TO BE ABANDONED SHALL BE GROUT FILLED OR COMPLETELY REMOVED.
- MINIMUM BACKFILL DEPTH REQUIREMENT IS FOR TRENCHING IN EXISTING PAVED STREETS. TRENCHING FOR NEW DEVELOPMENT WHERE STREETS HAVE NOT YET BEEN CONSTRUCTED, BACKFILL MATERIAL SHALL BE TYPE 2, CLASS B OR CLASS E AND COMPACTED TO MINIMUM 90% RELATIVE COMPACTION. MATERIALS SHALL CONFORM TO SSPWC SECTION 200, AS ADOPTED BY CITY COUNCIL.

STANDARD DETAILS FOR PUBLIC WORKS CONSTRUCTION	DRAWING No.
TRENCH EXCAVATION/BACKFILL	S-117
APPROVED BY: JE DATE: 1/2020	

NOTES:

- FERROUS METAL OVER MONUMENT FOR RECOVERY BY DIP NEEDLE OR MAGNETIC INSERT IN CAP.
- 1 1/2" MIN. NONFERROUS CAP WITH PROFESSIONAL LAND SURVEYOR NO. PERMANENTLY ATTACHED PRIOR TO PLACEMENT. PRE-PUNCHED CAPS SHALL NOT BE PERMITTED.
- 5/8" METALLIC SHAFT (SMOOTH SHAFTS TO BE DEFORMED).
- PORTLAND CEMENT CONCRETE (P.C.C.) SHALL HAVE THE FOLLOWING CHARACTERISTICS: 4000 PSI MIN. COMPRESSIVE STRENGTH AT 28 DAYS, MIN. 6 SACKS OF CEMENT PER CUBIC YARD WITH MAX. WATER-CEMENT RATIO OF 0.45, AIR ENTRAINMENT 6% ±1.5%, SLUMP AT 1 TO 4 INCHES. MIX DESIGN SHALL CONFORM TO THE REQUIREMENTS OF SECTION 337 OF STANDARD SPECIFICATIONS OF PUBLIC WORKS CONSTRUCTION (SSPWC), AS ADOPTED BY CITY COUNCIL. CEMENT SHALL BE TYPE II. ALL CEMENT CONCRETE SHALL HAVE A COARSE AGGREGATE GRADATION CONFORMING TO SIZE NO. 67. POLYPROPYLENE OR CELLULOSE FIBERS SHALL BE ADDED TO THE P.C.C. AT 1.5 LBS. PER CUBIC YARD. ALL MATERIALS SHALL CONFORM TO SSPWC, AS ADOPTED BY CITY COUNCIL.
- P.C.C. COLLARS IN ALL ROADWAYS SHALL BE PROTECTED FROM TRAFFIC LOADS UNTIL MINIMUM 3000 PSI IS ATTAINED.

STANDARD DETAILS FOR PUBLIC WORKS CONSTRUCTION	DRAWING No.
MONUMENTS	S-118
APPROVED BY: JE DATE: 1/2020	

NOTES:

- 4" TYPE 3, 50 BLOW, 3% AIR VOID BITUMINOUS PLANTMIX PG64-28NV ASPHALTIC PAVEMENT. AGGREGATES SHALL BE PRE-MARINATED WITH LIME PER NDOT SPECIFICATIONS. RECYCLED ASPHALT PAVEMENT (RAP) UP TO 15% WILL BE ALLOWED; HOWEVER ALL VIRGIN AGGREGATES WILL BE SUBJECT TO LIME PRE-MARINATING PER NDOT SPECIFICATIONS. AC PAVING SHALL BE PLACED IN TWO LIFTS.
- MINIMUM DESIGN LIFE OF STRUCTURAL SECTION = 20 YEARS.
- MINIMUM CORRECTED SUBGRADE (R) VALUE = 30.
- PAVEMENT DESIGN BASED ON EQUIVALENT SINGLE AXLE LOAD OF 145,000 LBS.
- ANY DISTURBED LANDSCAPING OR OTHER SURFACE OR SUBSURFACE IMPROVEMENTS SHALL BE RESTORED TO EQUAL OR BETTER CONDITION.

STANDARD DETAILS FOR PUBLIC WORKS CONSTRUCTION	DRAWING No.
MILL & OVERLAY	S-115
APPROVED BY: JE DATE: 1/2020	

NOTES:

- AN EXCAVATION/ENCROACHMENT PERMIT MUST BE OBTAINED FROM CITY OF SPARKS PRIOR TO CUTTING ANY PUBLIC RIGHT-OF-WAY.
- IF SAW CUT IS WITHIN 2 FEET OF AN EXISTING PAVEMENT EDGE OR EXISTING PAVEMENT PATCH, REMOVE EXISTING PAVEMENT TO THAT EDGE AND REPLACE ENTIRE SECTION.
- ALL PERMANENT PATCH REPLACEMENT REQUIREMENTS ARE MINIMUM WIDTHS ONLY AND INCLUDES ALL AREAS WHERE THE ASPHALT PAVEMENT HAS BEEN UNDERMINED. THE CITY ENGINEER MAY REQUIRE WIDER PATCH SECTIONS OR OTHERWISE ALTER THESE REQUIREMENTS.
- AGGREGATE BASE MATERIAL UNDER BITUMINOUS PAVEMENT PATCH SHALL BE TYPE 2, CLASS B CRUSHED AGGREGATE BASE. MATERIALS SHALL CONFORM TO SSPWC SECTION 200, AS ADOPTED BY CITY COUNCIL.
- CONTRACTOR SHALL BE RESPONSIBLE FOR REPLACEMENT OF LOOP DETECTORS, ADJUSTMENT OF UTILITIES AND SURVEY MONUMENTS TO GRADE AND INSTALLATION OF PERMANENT PAVEMENT MARKINGS.
- FOR P.C.C. CURB REPLACEMENT, SAW CUT EXISTING PAVEMENT 18 INCHES MIN. FROM GUTTER LIP LINE, REMOVE AND REPLACE PAVEMENT TO SAW CUT EDGES. CONCRETE MAY BE POURED NEAT AGAINST EXISTING EDGE OF ASPHALT IF APPROVED BY CITY ENGINEER.
- TRANSVERSE PATCHES SHALL INCLUDE A GRIND AND OVERLAY WHEREVER THERE ARE MULTIPLE PATCHES WITHIN 30 FEET OF EACH OTHER. 2" MINIMUM FOR RESIDENTIAL, COLLECTORS & INDUSTRIALS. 3" MINIMUM FOR ARTERIALS.
- LONGITUDINAL PATCHES SHALL INCLUDE GRIND AND OVERLAY TO THE LANE LINES (BIKE, PARKING, OR TRAVEL). 2" MINIMUM FOR RESIDENTIAL, COLLECTORS & INDUSTRIALS. 3" MINIMUM FOR ARTERIALS.
- DRIVEWAY & INTERSECTION LIMITS TO BE DETERMINED BY STREET CUT COORDINATOR.

STANDARD DETAILS FOR PUBLIC WORKS CONSTRUCTION	DRAWING No.
PERMANENT BITUMINOUS PAVEMENT PATCH	S-115
APPROVED BY: JE DATE: 1/2020	

NOTES:

- 4" TYPE 3, 50 BLOW, 3% AIR VOID BITUMINOUS PLANTMIX PG64-28NV ASPHALTIC PAVEMENT. AGGREGATES SHALL BE PRE-MARINATED WITH LIME PER NDOT SPECIFICATIONS. RECYCLED ASPHALT PAVEMENT (RAP) UP TO 15% WILL BE ALLOWED; HOWEVER ALL VIRGIN AGGREGATES WILL BE SUBJECT TO LIME PRE-MARINATING PER NDOT SPECIFICATIONS. AC PAVING SHALL BE PLACED IN TWO LIFTS.
- MINIMUM DESIGN LIFE OF STRUCTURAL SECTION = 20 YEARS.
- MINIMUM CORRECTED SUBGRADE (R) VALUE = 30.
- PAVEMENT DESIGN BASED ON EQUIVALENT SINGLE AXLE LOAD OF 145,000 LBS.
- ANY DISTURBED LANDSCAPING OR OTHER SURFACE OR SUBSURFACE IMPROVEMENTS SHALL BE RESTORED TO EQUAL OR BETTER CONDITION.

STANDARD DETAILS FOR PUBLIC WORKS CONSTRUCTION	DRAWING No.
PAVEMENT SECTION	S-115
APPROVED BY: JE DATE: 1/2020	

GENERAL NOTES

ALL CONSTRUCTION AND MATERIALS SHALL CONFORM TO THE BOOK "STANDARD SPECIFICATIONS FOR PUBLIC WORKS CONSTRUCTION" (2012 EDITION-REV 8), AND THE "STANDARD DETAILS FOR PUBLIC WORKS CONSTRUCTION", AS ADOPTED AND MODIFIED BY THE CITY OF SPARKS AND DISTRIBUTED BY WASHOE COUNTY, INCLUDING ANY ADDITIONS OR MODIFICATIONS THAT ARE SET FORTH IN THE DRAWINGS OR SPECIFICATIONS.

THE CONTRACTOR SHALL ASSUME SOLE AND COMPLETE RESPONSIBILITY FOR JOB SITE CONDITIONS DURING THE COURSE OF CONSTRUCTION FOR THIS PROJECT, INCLUDING SAFETY OF ALL PERSONS AND PROPERTY; THAT THIS REQUIREMENT SHALL APPLY CONTINUOUSLY, AND NOT BE LIMITED TO NORMAL WORKING HOURS.

THE CONTRACTOR SHALL BE RESPONSIBLE FOR ALL EXCAVATION AND SHORING PROCEDURES AND CONFORM TO THE LATEST OSHA REQUIREMENTS.

THE CONTRACTOR SHALL MAINTAIN AN ON-GOING DUST CONTROL PROGRAM, INCLUDING WATERING OF OPEN AREAS, IN ORDER TO CONFORM WITH THE LATEST FEDERAL, STATE, AND COUNTY AIR POLLUTION REGULATIONS.

THE CONTRACTOR SHALL BE RESPONSIBLE FOR DAILY REMOVAL OF ALL CONSTRUCTION MATERIALS SPILLED ON PAVED STREETS, ON-SITE OR OFF-SITE. AT THE CLOSE OF EACH DAY, THE CONTRACTOR SHALL INSPECT THE SITE FOR ANY DEBRIS OR TRASH AND PROPERLY DISPOSE OF IT.

THE CONTRACTOR SHALL NOTIFY THE DESIGN PROFESSIONAL, ALL GOVERNING AGENCIES HAVING JURISDICTION OVER THE WORK, UTILITY COMPANIES, TELEPHONE COMPANIES, CABLE TELEVISION COMPANIES, AND ANY OTHER ENTITY IMPACTED BY THE WORK 48 HOURS PRIOR TO BEGINNING CONSTRUCTION. THE CONTRACTOR SHALL GIVE 48 HOURS PRIOR NOTICE FOR ALL CONSTRUCTION STAKING AND INSPECTIONS REQUIRED DURING CONSTRUCTION.

THE CONTRACTOR SHALL OBTAIN AND PAY FOR ALL NECESSARY PERMITS AND FEES REQUIRED FOR CONSTRUCTION.

THE CONTRACTOR SHALL BE RESPONSIBLE FOR ALL CONSTRUCTION SIGNING, BARRICADES, AND TRAFFIC DELINEATION TO CONFORM TO THE STATE OF NEVADA, DEPARTMENT OF TRANSPORTATION "NEVADA WORK ZONE TRAFFIC CONTROL MANUAL" AND THE MANUAL ON UNIFORM TRAFFIC CONTROL DEVICES (MUTCD), LATEST EDITION.

THE CONTRACTOR SHALL PROTECT FROM DAMAGE EXISTING UTILITY STRUCTURES ON AND AROUND THE SITE INCLUDING, BUT NOT LIMITED TO, PAVEMENT, CURB AND GUTTER, SIDEWALK, LANDSCAPING, IRRIGATION LINES, SIGNAGE, STORM AND SANITARY SEWERS, UTILITIES, TELEPHONE, TRAFFIC CONTROL, AND CABLE TELEVISION. THE CONTRACTOR SHALL ASSUME SOLE RESPONSIBILITY FOR THE REPAIR AND/OR REPLACEMENT OF ANY IMPROVEMENTS (NEW OR EXISTING) DAMAGED THROUGHOUT THE COURSE OF CONSTRUCTION EITHER AS A DIRECT RESULT OF THE ACTIVITIES OR THE FAILURE TO ADEQUATELY PROTECT THE IMPROVEMENT.

THE CONTRACTOR SHALL, DURING THE COURSE OF THE PROJECT, MAINTAIN RECORD DRAWINGS INDICATING BY DIMENSION AND DESCRIPTION ANY FACILITY CONSTRUCTED CONTRARY TO THAT SHOWN ON THE DRAWINGS OR DESCRIBED IN THE SPECIFICATIONS. AT THE END OF CONSTRUCTION, THE RECORD DRAWINGS SHALL BE TURNED OVER TO THE ENGINEER.

PRIOR TO THEIR INCORPORATION INTO THE WORK, THE CONTRACTOR SHALL SUBMIT FOR THE ENGINEER'S APPROVAL SHOP DRAWINGS AND MATERIAL SPECIFICATIONS FOR ALL MATERIALS TO BE USED ON THE PROJECT.

ANY DAMAGED ASPHALT OR CONCRETE BEYOND THAT SHOWN ON THE PLANS WILL BE THE CONTRACTOR'S RESPONSIBILITY TO REPLACE.

REFER TO GEOTECHNICAL INVESTIGATION PREPARED BY EARTHTECH, LLC DATED FEBRUARY 20, 2023 FOR SOILS INFORMATION.

STANDARD DETAILS FOR PUBLIC WORKS CONSTRUCTION	DRAWING No.
GENERAL NOTES	S-115
APPROVED BY: JE DATE: 1/2020	

revisions	
drawn:	GKG
checked:	GKG
date:	JANUARY 2025
scale:	
project no:	22038