



RENO • NEVADA
J & A DESIGN STUDIO
 PO BOX 6780
 RENO, NV 89513
 PH: (775) 507-4041
 gjameson@jadesignreno.com

SPARKS MARINA INCLUSIVE PLAYGROUND IMPROVEMENT PROJECT

CITY OF SPARKS, NEVADA

CITY OF SPARKS

431 Prater Way Sparks, NV 89431
 Ph: 775-353-2345

CITY OF SPARKS OFFICIALS

Ron Smith	Mayor
Donald Abbott	Council Member Ward 1
Ed Lawson	Council Member Ward 2
Paul Anderson	Council Member Ward 3
Charlene Bybee	Council Member Ward 4
Kristopher Dahir	Council Member Ward 5
Neil C. Krutz	City Manager

DESIGNED FOR:

City of Sparks
 431 Prater Way
 Sparks, NV 89431

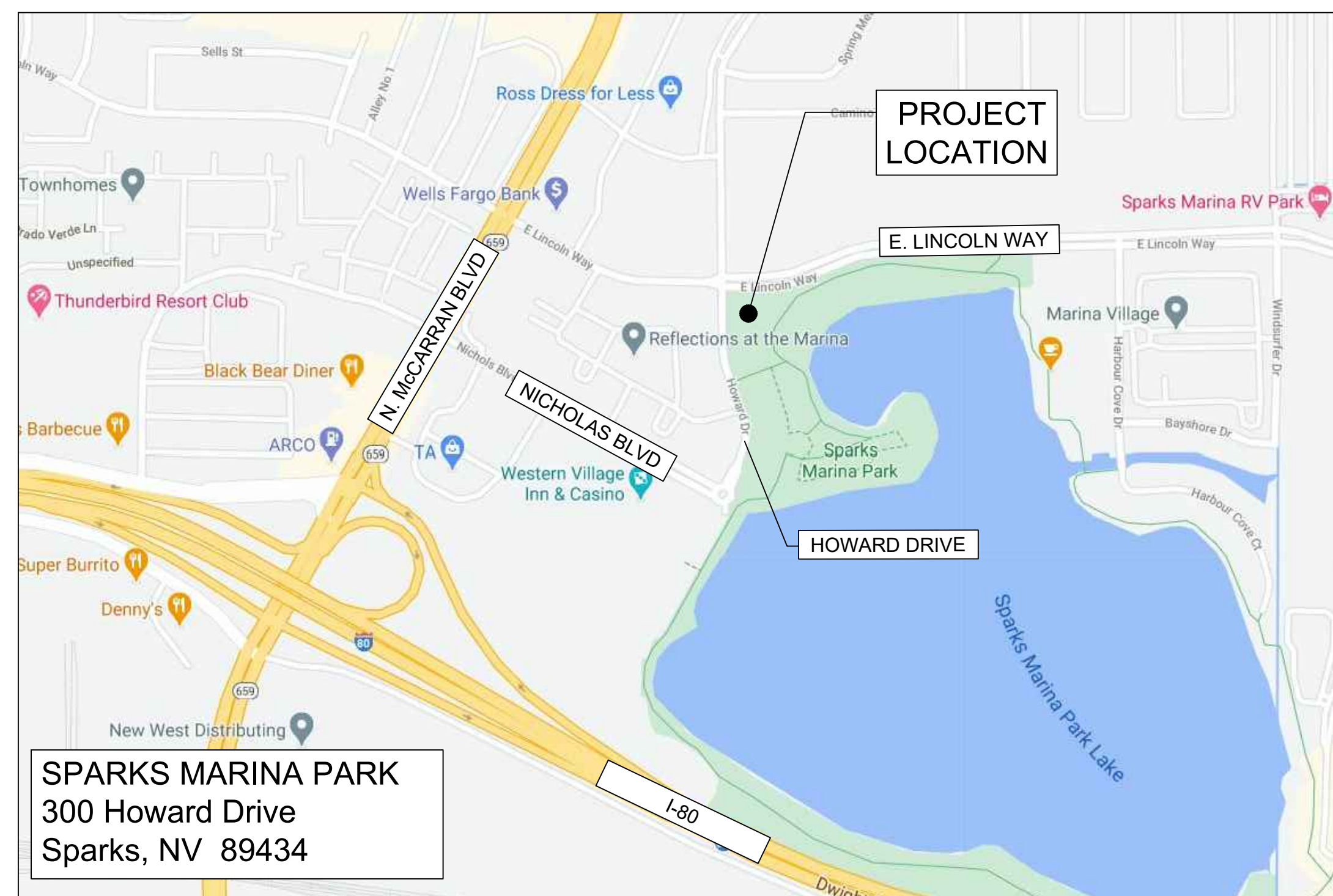

SHEET INDEX

- L1 TITLE SHEET
- L2 EXISTING CONDITIONS AND DEMOLITION
- L3 EXISTING CONDITIONS AND DEMOLITION
- L4 PLAYGROUND IMPROVEMENT PLAN
- L5 PLAYGROUND IMPROVEMENT PLAN
- L6 GRADING AND DRAINAGE PLAN
- L7 DETAILS SHEET
- L8 DETAILS SHEET

LANDSCAPE ARCHITECT AND CPSI

GREIG JAMESON, ASLA & PLA #980
 CPSI # 41232-0421
 J & A DESIGN STUDIO
 PO BOX 6780
 RENO, NV 89513
 gjameson@jadesignreno.com

INCLUSIVE PLAYGROUND CONSULTANT

Mara Kaplan
 Let Kids Play!
 1463 Greystone Drive
 Pittsburgh, PA 15206
 mara@letkidsplay.com

SPARKS MARINA INCLUSIVE
 PLAYGROUND
 IMPROVEMENT PROJECT

TITLE PAGE

DRAFTED: G&J
 REVIEWED: G&J
 J & A JOB NUMBER:
 17-105-06

PLAN SET:
 FOR BIDDING ONLY

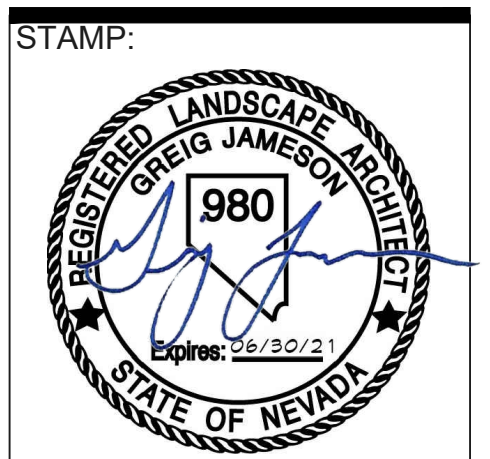

PLAN DATE: 05/12/2021

REVISIONS:

#	DATE

SCALE: N.T.S.
 SHEET:

L1
 of 8

TONY PEHLE
 ACTING DIRECTOR PARKS AND RECREATION DEPARTMENT

DATED: _____

100%
 CONSTRUCTION SET
 05/12/2021



Let Kids Play!
Because every child deserves to play



J & A DESIGN STUDIO
RENO • NEVADA
PO BOX 6780
RENO, NV 89513
PH: (775) 507-4041
gjameson@jadesignreno.com

CITY OF SPARKS

431 Prater Way Sparks, NV 89431
PH: 775-353-2345

**SPARKS MARINA INCLUSIVE
PLAYGROUND
IMPROVEMENT PROJECT**
EXISTING CONDITIONS AND
DEMOLITION PLAN

DRAFTED: G&J REVIEWED: G&J

J & A JOB NUMBER:
17-105-06

PLAN SET:
FOR BIDDING ONLY



PLAN DATE: 05/12/2021

REVISIONS:

#	DATE

SCALE: 1:10
SHEET:

L2
of 8

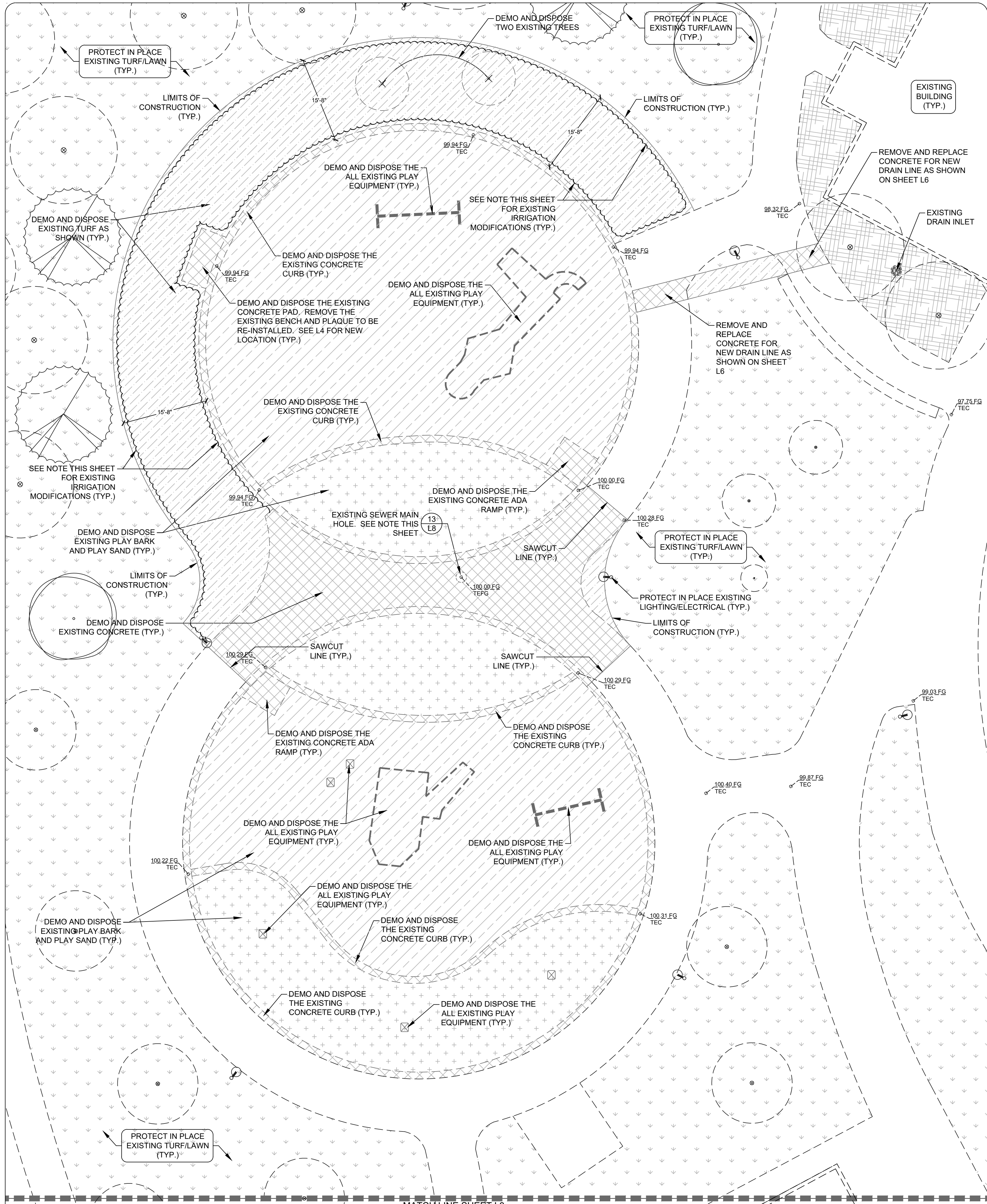

- DEMOLITION LEGEND:**
- FG - EXISTING FINISH GRADE
 - TEC - TOP OF EXISTING CONCRETE
 - FG - EXISTING FINISH GRADE
 - TEAC - TOP OF EXISTING ASPHALT PAVEMENT
 - FG - EXISTING FINISH GRADE
 - TEFG - TOP OF EXISTING FINISH GRADE (VARIOUS SURFACES)

- EXISTING TURF/LAWN: PROTECT IN PLACE
- NO HATCH: EXISTING CONCRETE SIDEWALK: PROTECT IN PLACE
- EXISTING ORNAMENTAL LANDSCAPE AREA: PROTECT IN PLACE
- EXISTING PLAY SAND SAFETY SURFACE: DEMO AND DISPOSE OF ALL OF THE PLAY SAND DOWN TO THE SUBGRADE SOILS.
- EXISTING PLAY BARK SAFETY SURFACE: DEMO AND DISPOSE OF ALL OF THE PLAY BARK DOWN TO THE SUBGRADE SOILS.
- EXISTING CONCRETE DEMO: DEMO AND DISPOSE OF ALL OF THE EXISTING CONCRETE AS SHOWN.
- EXISTING TURF/LAWN: DEMO AND DISPOSE TO THE DEPTH AS NEEDED FOR THE PROPOSED SIDEWALK
- EXISTING TREES: PROTECT IN PLACE

- EXISTING IRRIGATION MODIFICATIONS:**
- CONTRACTOR TO TURN ON AND MARK ALL EXISTING IRRIGATION COMPONENTS PRIOR TO START OF ANY DEMOLITION.
 - CONTRACTOR TO MARK ALL EXISTING HEADS AND DOCUMENT ON AS-BUILT DRAWINGS.
 - CONTRACTOR TO MODIFY, RELOCATE, OR REPAIR ANY EXISTING IRRIGATION ENSURING HEAD TO HEAD COVERAGE FOR THE NEW TURF LIMITS.
 - SEE SHEET L4 FOR NEW CONCRETE LIMITS. CONTRACTOR TO MODIFY EXISTING HEAD LOCATION AND SPRAY IRRIGATION FOR THE NEW CONCRETE LIMITS. CONTRACTOR TO ENSURE HEAD TO HEAD COVERAGE AT THE COMPLETION OF ALL IRRIGATION MODIFICATIONS FOR THE NEW LAYOUT.
 - INSTALL NEW SLEEVING AS NEEDED FOR THE NEW LAYOUT.
 - CONTRACTOR TO VISIT THE SITE AND COORDINATE ALL EXISTING IRRIGATION INFORMATION THAT WILL BE NEEDED PRIOR TO BID SUBMISSION.

- EXISTING UTILITIES AND SEWER MANHOLE:**
- CONTRACTOR TO PERFORM A STORMWATER AND SEWER DISCOVERY FOR THE AREA UNDER THE PROPOSED PLAYGROUND AREA PRIOR TO START OF ANY CONSTRUCTION.
 - CONTRACTOR TO CALL AND PERFORM AN '811' DIGS ON THE SITE PRIOR TO START OF ANY CONSTRUCTION.
 - CONTRACTOR TO MARK ALL STORMWATER, SEWER, ELECTRICAL, WATER AND OTHER VARIOUS UTILITIES ON THE AS-BUILT DRAWINGS.
 - CONTRACTOR TO LOWER THE EXISTING MANHOLE COVER AS SHOWN ON THIS SHEET. SEE DETAIL 13 ON SHEET L8.

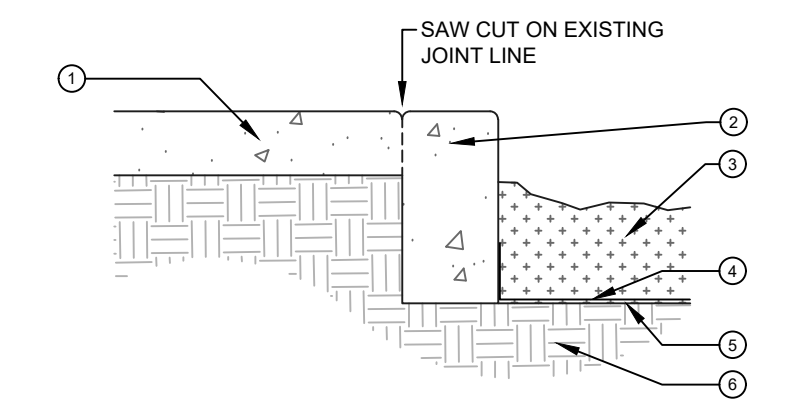

01 EXISTING CURB DEMOLITION

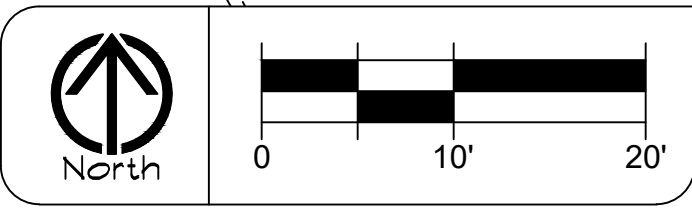

100%
CONSTRUCTION SET
05/12/2021

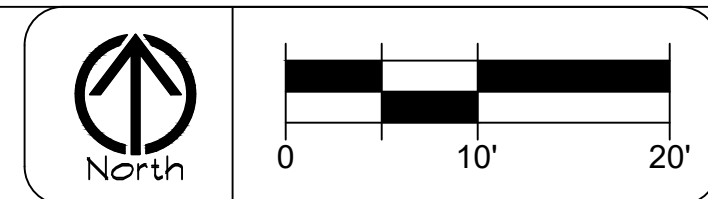
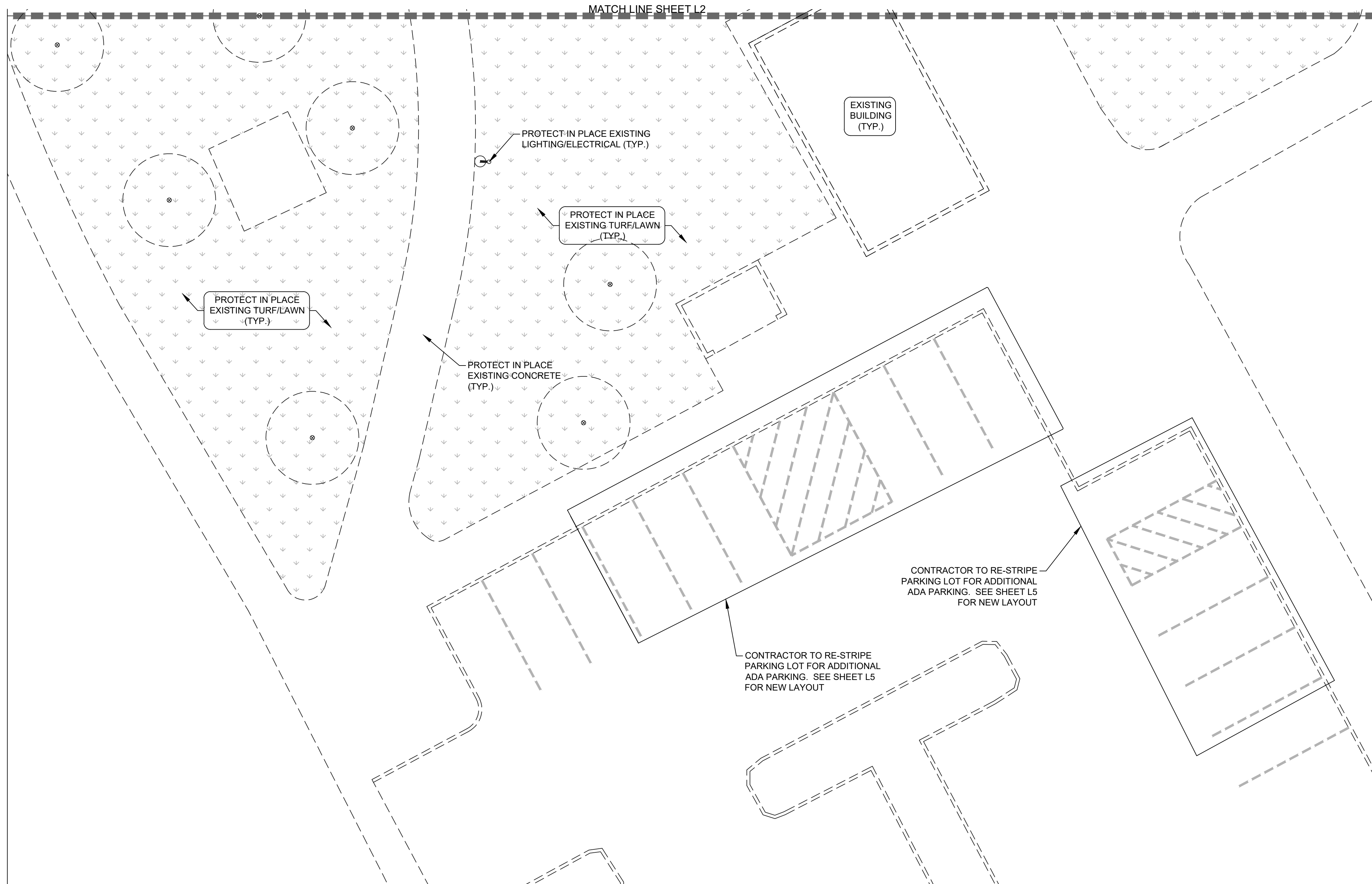

RENO • NEVADA
J & A DESIGN STUDIO
 PO BOX 6780
 RENO, NV 89513
 PH: (775) 507-4041
 gjameson@jadesignreno.com

CITY OF SPARKS

431 Prater Way Sparks, NV 89431
 PH: 775-353-2945

**SPARKS MARINA INCLUSIVE
 PLAYGROUND
 IMPROVEMENT PROJECT**
 EXISTING CONDITIONS AND
 DEMOLITION PLAN

DRAFTED: G&J
 REVIEWED: G&J

J & A JOB NUMBER:
 17-105-06

PLAN SET:
 FOR BIDDING ONLY

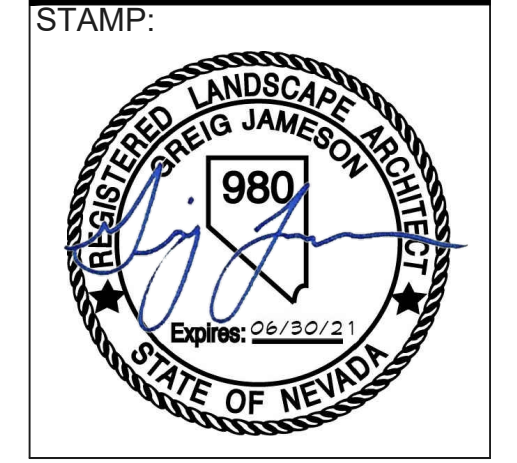

PLAN DATE: 05/12/2021

REVISIONS:

#	DATE

SCALE: 1:10
 SHEET:

100%
 CONSTRUCTION SET
 05/12/2021

L3
 of 8

**SPARKS MARINA INCLUSIVE
PLAYGROUND
IMPROVEMENT PROJECT**
PLAYGROUND IMPROVEMENT PLAN

DRAFTED: G&J
REVIEWED: G&J
J & A JOB NUMBER:
17-105-06

PLAN SET:
FOR BIDDING ONLY

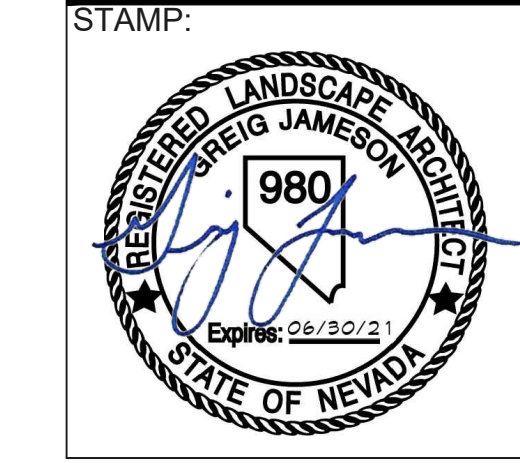

PLAN DATE: 05/12/2021

REVISIONS:

#	DATE

SCALE: 1:10
SHEET:

L4
of 8

PLAYGROUND IMPROVEMENT LEGEND:

- EXISTING TURF/LAWN: PROTECT IN PLACE
- NO HATCH
- EXISTING CONCRETE SIDEWALK: PROTECT IN PLACE
- EXISTING ORNAMENTAL LANDSCAPE AREA: PROTECT IN PLACE
- A1 PLAY EQUIPMENT: FURNISH AND INSTALL PLAYWORLD SPARKS MARINA CUSTOM LAYOUT #20-2476A AS AVAILABLE FROM BIG "T" RECREATION. CONTRACTOR TO FURNISH AND INSTALL THE CUSTOM LAYOUT OPTION 1 AND INSTALL PER ASTM AND MANUFACTURER SPECIFICATIONS.
- B1 MIRACLE MUSEUM: FURNISH AND INSTALL MIRACLE MUSEUM GRAND GALLERY #4534BD. BOLT DOWN ON CONCRETE PAD. AS AVAILABLE FROM MIRACLE RECREATION EQUIPMENT COMPANY. CONTRACTOR TO INSTALL PER MANUFACTURER RECOMMENDATIONS.
- B2 MIRACLE MUSEUM: FURNISH AND INSTALL MIRACLE MUSEUM MOMENTUM CORRIDOR #4535BD. BOLT DOWN ON CONCRETE PAD. AS AVAILABLE FROM MIRACLE RECREATION EQUIPMENT COMPANY. CONTRACTOR TO INSTALL PER MANUFACTURER RECOMMENDATIONS.
- B3 MIRACLE MUSEUM: FURNISH AND INSTALL MIRACLE MUSEUM DYNAMICS LAB #4533BD. BOLT DOWN ON CONCRETE PAD. AS AVAILABLE FROM MIRACLE RECREATION EQUIPMENT COMPANY. CONTRACTOR TO INSTALL PER MANUFACTURER RECOMMENDATIONS.
- B4 MIRACLE MUSEUM: FURNISH AND INSTALL MIRACLE MUSEUM ODYSSEY HALL #4532BD. BOLT DOWN ON CONCRETE PAD AS AVAILABLE FROM MIRACLE RECREATION EQUIPMENT COMPANY. CONTRACTOR TO INSTALL PER MANUFACTURER RECOMMENDATIONS.
- C1 QUIET GROVE: FURNISH AND INSTALL QUIET GROVE AS AVAILABLE FROM PARK PRO PLAYGROUNDS. CONTRACTOR TO INSTALL PER MANUFACTURER RECOMMENDATIONS.
- RUBBER TILE FALL SAFETY SURFACE: 80FSURFACES, DURASAFE PREMIUM SERIES, 2' X 2' INTERLOCKING RUBBER TILES. COLOR TO BE 'SANDY LANE' WITH A 10' RATED MAXIMUM FALL HEIGHT (5.00' HEIGHT). CONTRACTOR TO PROVIDE 2% EXTRA AND TURN OVER TO CITY OF SPARKS AT THE COMPLETION OF CONSTRUCTION.
- PROPOSED CONCRETE: INSTALL PER DETAILS AND SPECIFICATIONS
- PROPOSED TURF/LAWN: CONTRACTOR TO FURNISH AND INSTALL NEW SOD TO MATCH EXISTING TURF. INSTALL A TWO-INCH (2") MINIMUM DEPTH OF DOUBLE MIX TOPSOIL AND TILL INTO THE TOP SIX-INCHES (6") OF NATIVE SOIL PRIOR TO SOD INSTALLATION.
- D1 SHADE SHELTER: 16' x 16' FABRIC SHADE SHELTER. CONTRACTOR TO FURNISH SUPERIOR SHADE, 10' ENTRANCE HEIGHT, SINGLE POST 16' x 16' SQUARE SHADE SHELTER, IN-GROUND MOUNT WITH GLIDE ELBOW (OR APPROVED EQUAL). COLOR TO BE SELECTED BY OWNER FROM STANDARD COLOR GUIDE AT TIME OF PURCHASING. (DETAIL 01, L6)
- D2 SHADE SHELTER: 12' x 12' FABRIC SHADE SHELTER. CONTRACTOR TO FURNISH SUPERIOR SHADE, 10' ENTRANCE HEIGHT, SINGLE POST 12' x 12' SQUARE SHADE SHELTER, IN-GROUND MOUNT WITH GLIDE ELBOW (OR APPROVED EQUAL). COLOR TO BE SELECTED BY OWNER FROM STANDARD COLOR GUIDE AT TIME OF PURCHASING. (DETAIL 01, L6)
- D3 6' BENCH WITH BACK: FURNISH AND INSTALL UPBEAT FURNISHINGS BENCH, D1027COM-ULTRA, COMMEMORATIVE BENCH, SURFACE MOUNT (OR APPROVED EQUAL). COLOR TO BE SELECTED BY OWNER FROM STANDARD COLOR LIST PRIOR TO PURCHASING. CONTRACTOR TO LOCATE ALL BENCHES OUTSIDE OF THE PLAY EQUIPMENT USE ZONE (TYP.).

- 8' ADA PICNIC TABLE: FURNISH AND INSTALL UPBEAT FURNISHINGS, ANOVA 8' RECTANGULAR PERFORATES STEEL ADA TABLE, PORTABLE FRAME. CONTRACTOR TO INSTALL "T"-BOLT IN THE CONCRETE AND CHAIN THE TABLE INTO PLACE. COLOR TO BE SELECTED BY OWNER FROM STANDARD COLOR LIST PRIOR TO PURCHASING.
- 10' ADA PICNIC TABLE: FURNISH AND INSTALL THE PARK CATALOG, 10' HEAVY DUTY ADA SPLIT SHELTER PICNIC TABLE (OR APPROVED EQUAL). CONTRACTOR TO INSTALL "T"-BOLT IN THE CONCRETE AND CHAIN THE TABLE INTO PLACE. COLOR TO BE SELECTED BY OWNER FROM STANDARD COLOR LIST PRIOR TO PURCHASING.
- TRASH RECEPTACLE: FURNISH AND INSTALL WABASH VALLEY, URBANSCAPE "E" STYLE, 32 GALLON TRASH RECEPTACLE WITH LINER, ASH DOME TOP LID, SURFACE MOUNT AND ROUND PERFORATION STYLE BODY (OR APPROVED EQUAL). COLOR TO BE SELECTED BY OWNER FROM STANDARD COLOR LIST PRIOR TO PURCHASING.

PLANTING LEGEND:

SYMBOL	QTY	SCIENTIFIC NAME/COMMON NAME	SIZE
DECIDUOUS TREES			
	2	Acer x freemanii 'Jeffersred' - Autumn Blaze Maple	2-1/2" cal.
	3	Prunus virginiana 'Canada Red' - Canada Red Chokecherry	2-1/2" cal.

CONTRACTOR TO FURNISH AND INSTALL FIVE (5) 2-1/2" CALIPER DECIDUOUS TREES AND FIELD LOCATE THE TREES IN THE EXISTING TURF AREA. FINAL LOCATION TO BE SET AND APPROVED BY CITY OF SPARKS REPRESENTATIVE PRIOR TO INSTALLATION OF TREES.

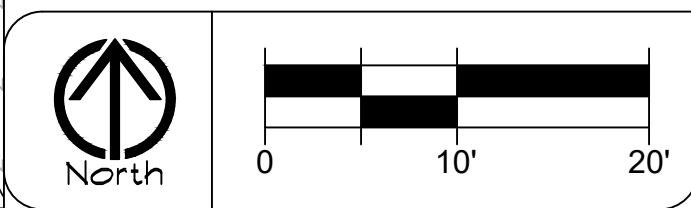

100%
CONSTRUCTION SET
05/12/2021

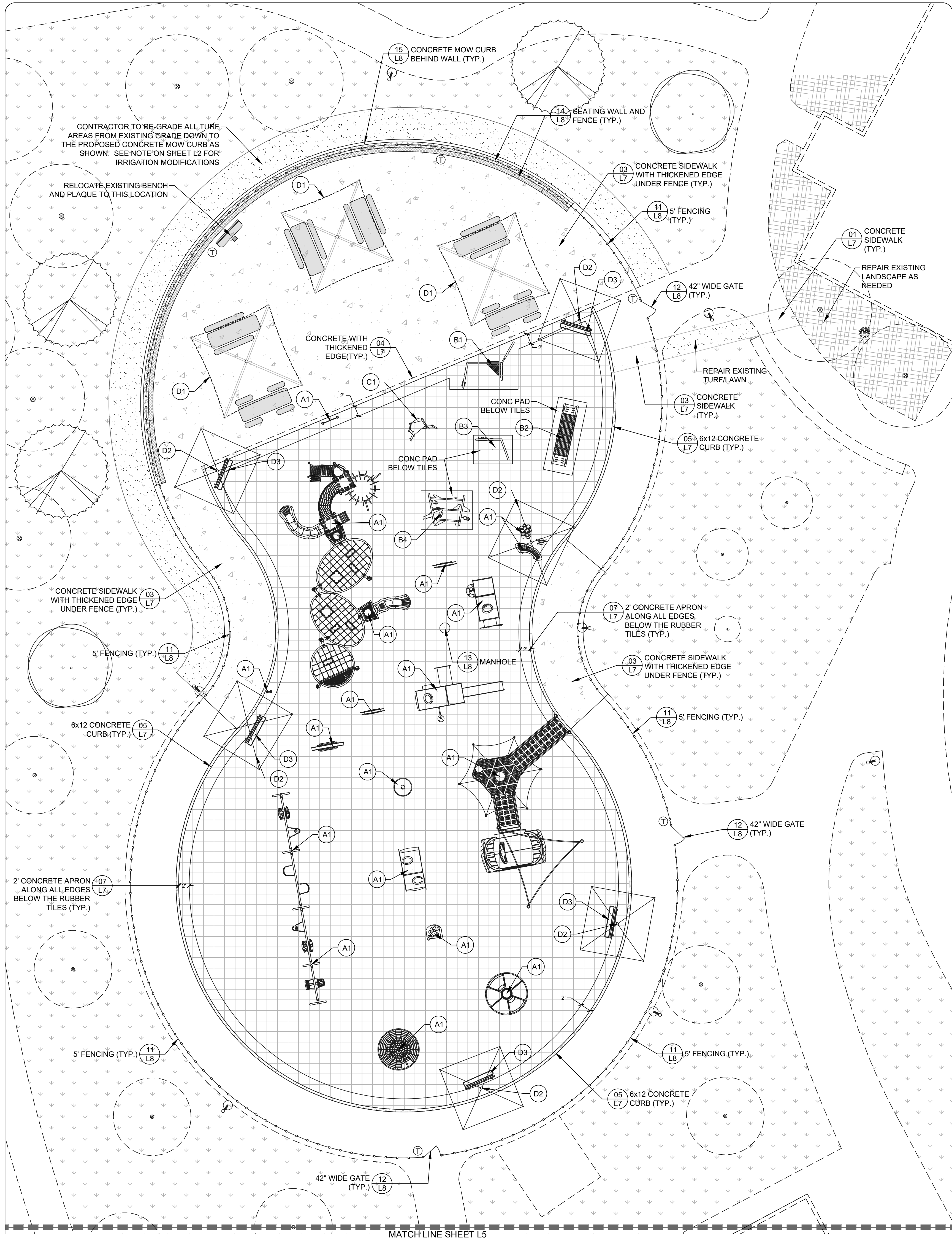



RENO • NEVADA
J & A DESIGN STUDIO
 PO BOX 6780
 RENO, NV 89513
 PH: (775) 507-4041
 gjameson@jadesignreno.com

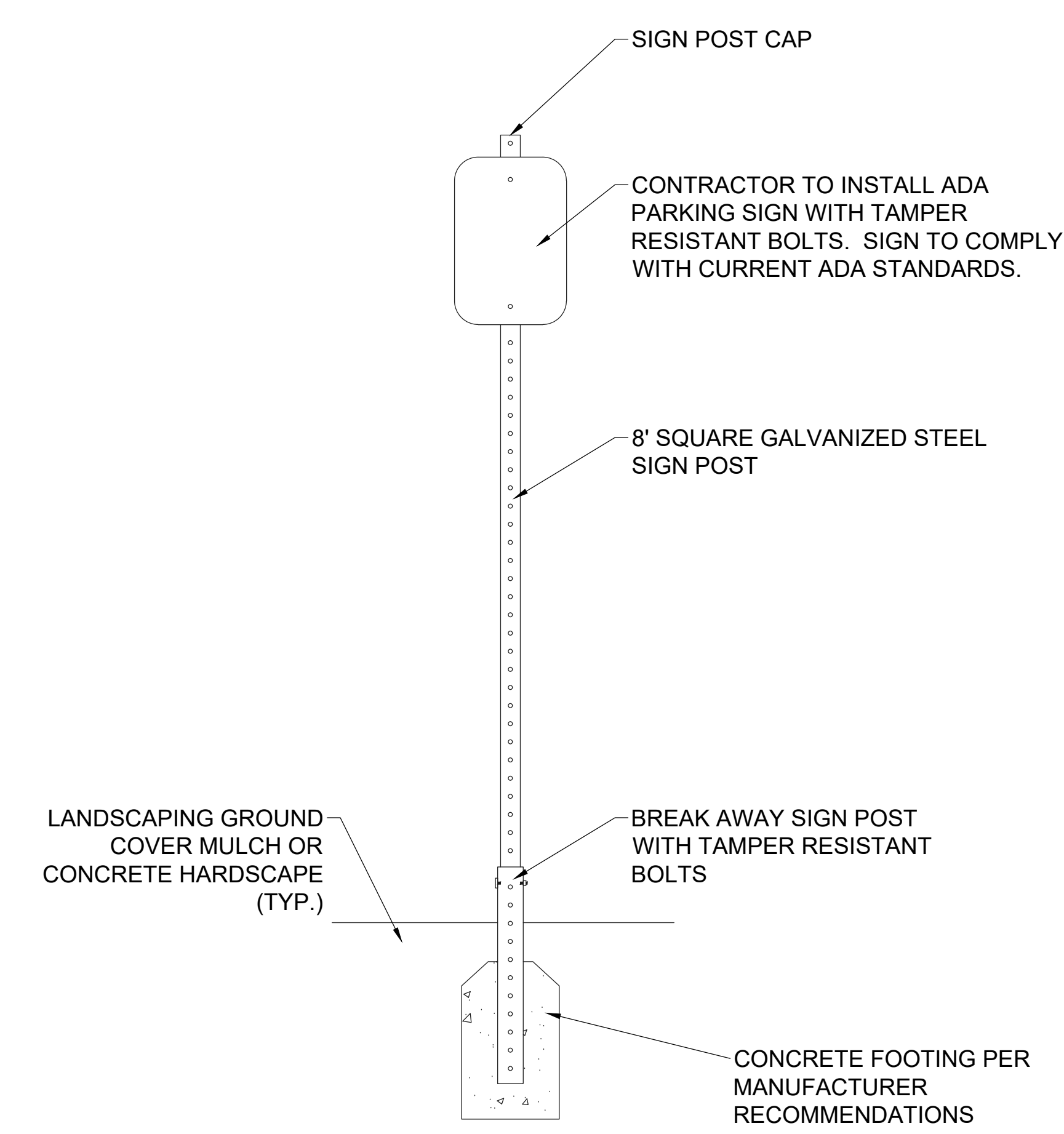
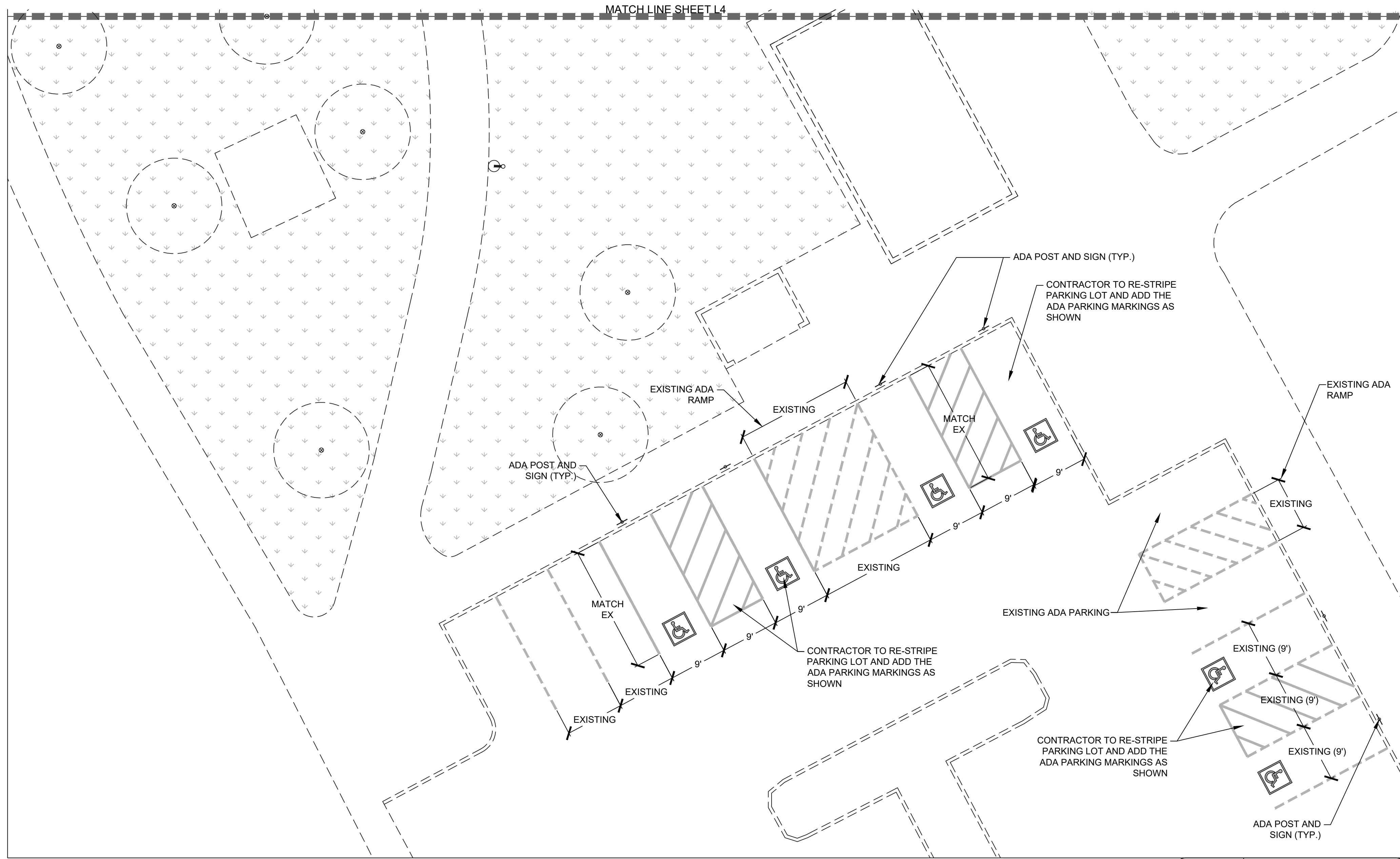

GENERAL NOTES:

- ALL WORK SHALL BE COMPLETED IN COMPLIANCE WITH THE LATEST EDITION OF THE MOST CURRENT ORANGE BOOK STANDARDS.
- INSTALLATION OF PLAYGROUND EQUIPMENT AND/OR PROTECTIVE FALL SAFETY SURFACE TO CONFORM TO ALL PLAY AREA SAFETY RECOMMENDATIONS PER THE LATEST ADA DESIGN STANDARDS, CONSUMER PRODUCT SAFETY COMMISSION, AND ASTM STANDARDS.
 - 2010 ADA STANDARDS FOR ACCESSIBLE DESIGN
 - U.S. CONSUMER PRODUCT SAFETY COMMISSION - "PUBLIC PLAYGROUND SAFETY HANDBOOK"
 - ASTM F1292-17 IMPACT ATTENUATION OF SURFACING MATERIALS WITHIN THE USE ZONE OF PLAYGROUND EQUIPMENT
 - ASTM F1951-17 TEST METHOD FOR ACCESSIBILITY ON SAFETY SURFACING FOR PLAYGROUNDS
 - ASTM F2223-17 GUIDE FOR ASTM STANDARDS ON PLAYGROUND SURFACING

IT IS THE RESPONSIBILITY OF THE CONTRACTOR TO OBSERVE AND VERIFY ALL CONDITIONS PRIOR TO INSTALLATION OF FALL SAFETY PROTECTIVE SURFACING. ANY DISCREPANCIES ARE TO BE BROUGHT TO THE ATTENTION OF THE CITY PRIOR TO INSTALLATION AND SHALL BE CORRECTED BY THE CONTRACTOR PRIOR TO FINAL LAYOUT OF FALL SAFETY PROTECTIVE SURFACING. ANY DISCREPANCIES NOT CORRECTED WILL BE THE RESPONSIBILITY OF THE CONTRACTOR TO CORRECT AT NO ADDITIONAL COST TO CITY OF SPARKS.

PLAY EQUIPMENT NOTES:

- ALL PLAY EQUIPMENT INSTALLATION AND/OR REPAIRS SHALL BE INSTALLED BY A CURRENT NEVADA LICENSED CONTRACTOR THAT HOLDS A CURRENT C25 LICENSE FOR PLAYGROUND INSTALLATIONS.
- INSTALL ALL PLAYGROUND EQUIPMENT OR REPLACEMENT PARTS PER MANUFACTURERS SPECIFICATIONS AND INSTALLATION GUIDELINES.
- CONTRACTOR TO NOTIFY CITY OF SPARKS REPRESENTATIVE OF FINAL PLAYGROUND USE ZONE LAYOUT 48 HOURS PRIOR TO CONCRETE INSTALLATION FOR REVIEW AND APPROVAL. IF THERE IS NO WRITTEN APPROVAL FROM A CITY OF SPARKS REPRESENTATIVE AND ANY DISCREPANCIES ARE FOUND, IT WILL BE THE RESPONSIBILITY OF THE CONTRACTOR TO REMEDY THE ITEMS AT NO EXPENSE TO THE CITY.
- SEE PROJECT SPECIFICATIONS FOR ADDITIONAL NOTES.
- ALL NEW PLAY EQUIPMENT WILL BE PURCHASED AND INSTALLED BY THE CONTRACTOR. CONTRACTOR TO COORDINATE UNLOADING, STORAGE AND INSTALLATION AS PART OF THE SCOPE OF WORK.

FALL SAFETY PROTECTIVE SURFACE NOTES:

- RUBBER TILE FALL SAFETY PROTECTIVE SURFACE SHALL BE INSTALLED PER SURFACES RESILIENT INTERLOCKING RUBBER TILE MANUFACTURER'S SPECIFICATIONS, RECOMMENDATIONS, AND SAFETY INSTRUCTIONS.
- DO NOT APPLY ADHESIVE AND TILES TO CONCRETE WHEN THE CONCRETE SURFACE TEMPERATURES OR ATMOSPHERE TEMPERATURE ARE LESS THAN THE RECOMMENDED TEMPERATURE PER MANUFACTURER'S SPECIFICATIONS.
- IT IS RECOMMENDED THAT ALL PROPOSED PLAY EQUIPMENT, FALL SAFETY PROTECTIVE SURFACE, AND EQUIPMENT USE ZONES BE INSPECTED BY A CERTIFIED PLAYGROUND SAFETY INSPECTOR (CPSI) DURING ALL STAGES OF CONSTRUCTION TO ENSURE THAT THE PLAYGROUND WILL CONFORM TO ALL ASTM AND CPSC STANDARDS.
- PLAYGROUND MUST CONFORM TO STANDARDS AND A FINAL PLAYGROUND SAFETY AUDIT MUST BE COMPLETED PRIOR TO ACCEPTANCE BY CITY OF SPARKS (SEE FINAL INSPECTION NOTE).

GENERAL CONCRETE NOTES:

- BASE AGGREGATE:**
 - CONTRACTOR TO FIELD VERIFY EXISTING SUBGRADE SOILS FOLLOWING PLAY BARK SAFETY SURFACE REMOVAL. CONTRACTOR TO ENSURE A 4" MINIMUM DEPTH OF COMPACTED BASE AGGREGATE UNDER ALL CONCRETE. EXCAVATE ADDITIONAL SUBGRADE SOILS IF NEEDED TO MEET THE 4" MINIMUM DEPTH. IF THE EXISTING SUBGRADE DEPTH REQUIRES ADDITIONAL FILL MATERIAL, CONTRACTOR SHALL INSTALL TYPE II BASE AGGREGATE AS REQUIRED TO FILL THE AREAS TO MEET PROPOSED ELEVATIONS. INSTALL BASE AGGREGATE IN 4" LIFTS AND COMPACT TO 95% RELATIVE COMPACTION.
- GENERAL CONCRETE:**
 - MIX DESIGN IS THE SAME FOR ALL CONCRETE WORK.
 - SEE CONCRETE SPECIFICATION SECTION FOR ADDITIONAL INFORMATION.
 - ALL REMOVED CONCRETE SHALL BE PROPERLY DISPOSED OF LEGALLY OFF-SITE.
 - CURE SHALL CONFORM TO SSPC (LATEST EDITION).
 - EXPANSION JOINTS TO BE INSTALLED ON ALL CONCRETE FLATWORK PER CITY OF SPARKS CURRENT STANDARDS.

SIDEWALK CONCRETE NOTES:

- FINISH CONCRETE TO BE BROOM FINISH FOR CONCRETE SIDEWALK AND CONCRETE SIDEWALK WITH THICKENED EDGE. DO NOT INSTALL BROOM FINISH ON CONCRETE PAD BELOW RUBBER TILE PROTECTIVE SURFACING.
- PLAYGROUND CONCRETE NOTES:**
 - ALLOW CONCRETE TO CURE FOR A MINIMUM OF 14 DAYS (OR PER MANUFACTURER'S SPECIFICATIONS) BEFORE PLACEMENT OF TILES OR TILE ADHESIVE APPLICATION.
 - FOR CONCRETE FLATWORK BELOW RUBBER TILE FALL SAFETY PROTECTIVE SURFACE, SAW CUT OR TROWEL JOINTS 1" DEEP (7" TO 8" ON CENTER). SEE CONCRETE PAD CONTROL JOINT DETAIL.
 - INSTALL SIKATLEX SELF SEALING CONCRETE SEALANT IN ALL CONCRETE JOINTS ON THE CONCRETE FLATWORK LOCATED BELOW THE RUBBER TILE FALL SAFETY SURFACE.
 - FINISH CONCRETE ON FLATWORK UNDER RUBBER TILE FALL SAFETY PROTECTIVE SURFACE TO BE SMOOTH TROWEL FINISH. DO NOT BROOM FINISH.
 - INSTALL PLASTIC SHEETING AROUND ALL PLAY EQUIPMENT POSTS OR COMPONENTS THAT MAY ENCOUNTER CONCRETE SPLASH. PRIOR TO CONCRETE INSTALLATION.
 - WASH ALL CONCRETE SPLASH AND DUST FROM THE EQUIPMENT UPON COMPLETION.
 - SEE CONCRETE SPECIFICATIONS SECTION FOR ADDITIONAL INFORMATION.

GENERAL DIMENSIONING NOTES:

- LAYOUT OF PLAY AREA PROTECTIVE FALL SAFETY SURFACE TO CONFORM TO ALL PLAY AREA SAFETY RECOMMENDATIONS PER THE FOLLOWING LATEST ADA DESIGN STANDARDS, CONSUMER PRODUCT SAFETY COMMISSION, AND ASTM STANDARDS.
 - 2010 ADA STANDARDS FOR ACCESSIBLE DESIGN
 - U.S. CONSUMER PRODUCT SAFETY COMMISSION - "PUBLIC PLAYGROUND SAFETY HANDBOOK"
 - ASTM F1292-17 IMPACT ATTENUATION OF SURFACING MATERIALS WITHIN THE USE ZONE OF PLAYGROUND EQUIPMENT
 - ASTM F1951-17 TEST METHOD FOR ACCESSIBILITY ON SAFETY SURFACING FOR PLAYGROUNDS
 - ASTM F2223-17 GUIDE FOR ASTM STANDARDS ON PLAYGROUND SURFACING

IT IS THE RESPONSIBILITY OF THE CONTRACTOR TO OBSERVE AND VERIFY ALL CONDITIONS PRIOR TO INSTALLATION OF FALL SAFETY PROTECTIVE SURFACING. ANY DISCREPANCIES ARE TO BE BROUGHT TO THE ATTENTION OF THE CITY PRIOR TO INSTALLATION AND SHALL BE CORRECTED BY THE CONTRACTOR PRIOR TO FINAL LAYOUT OF FALL SAFETY PROTECTIVE SURFACING. ANY DISCREPANCIES NOT CORRECTED WILL BE THE RESPONSIBILITY OF THE CONTRACTOR TO CORRECT AT NO ADDITIONAL COST TO CITY OF SPARKS.

FINAL COMPLETION PLAYGROUND SAFETY AUDIT:

UPON COMPLETION OF THE PROJECT AND BEFORE FINAL APPROVAL BY CITY OF SPARKS, THE CONTRACTOR IS TO PROVIDE A WRITTEN, COMPREHENSIVE PLAYGROUND SAFETY AUDIT (WITH PICTURES) BY CERTIFIED PLAYGROUND SAFETY INSPECTOR AND DELIVER THE AUDIT TO CITY OF SPARKS. THE PLAYGROUND SAFETY AUDIT MUST BE COMPLETED BY A 3RD (OUTSIDE) PARTY. THE CONTRACTOR MAY NOT CONDUCT AND PROVIDE THEIR OWN AUDIT.

- COMPREHENSIVE SAFETY AUDIT IS TO INCLUDE ALL OF THE FOLLOWING ITEMS:**
 - IDENTIFICATION OF ALL EXISTING PLAYGROUND COMPONENTS.
 - IDENTIFICATION OF ALL COMPLIANT PLAYGROUND COMPONENTS WITH CURRENT ASTM STANDARDS NOTED/DEFINED FOR EACH COMPLIANT COMPONENT. INCLUDES PICTURES OF ALL COMPLIANT ITEMS.
 - IDENTIFICATION OF ALL NON-COMPLIANT PLAYGROUND COMPONENTS WITH CURRENT ASTM STANDARDS NOTED/DEFINED FOR EACH NON-COMPLIANT COMPONENT. INCLUDES DETAILED PICTURES OF ALL NON-COMPLIANT COMPONENTS.
 - DETERMINATION AND DEFINITION OF HAZARD PRIORITY RATING FOR ALL NON-COMPLIANT CONDITIONS.
 - ESTABLISH REPAIR, REMOVAL, OR REPLACEMENT RECOMMENDATIONS FOR EACH NON-COMPLIANT CONDITIONS BASED ON INJURY POTENTIAL.

IT IS THE RESPONSIBILITY OF THE CONTRACTOR TO ENSURE THAT ALL PLAYGROUND IMPROVEMENTS CONFORM TO ALL ASTM STANDARDS AND CONFORM TO A COMPREHENSIVE SAFETY AUDIT SHOWING THAT THE PLAYGROUND HAS ACHIEVED A "STANDARD OF CARE". IT IS THE RESPONSIBILITY OF THE CONTRACTOR TO BRING ANY NON-COMPLIANT CONDITIONS TO THE ATTENTION OF CITY OF SPARKS THAT ARE NOT OR WERE NOT COVERED WITHIN THE PLAYGROUND IMPROVEMENT PACKAGE. IF ANY DISCREPANCIES ARE DISCOVERED OR OCCUR IT WILL BE THE RESPONSIBILITY OF THE CONTRACTOR TO REMEDY ALL ITEMS AT NO ADDITIONAL COST TO CITY OF SPARKS.

GENERAL GRADING NOTES:

- CONTRACTOR TO SLOPE ALL CONCRETE FLATWORK AND RUBBER TILE SURFACE AT A MINIMUM SLOPE OF 1.5% (OR AS SPECIFIED) TO ALL DRAIN INLETS AND DRAIN CATCH BASINS.
- CONTRACTOR TO SLOPE THE SCH 40 PVC DRAIN PIPE MINIMUM 1.0% TO THE DRAIN INLET LOCATION.

01 ADA POST AND SIGN

CITY OF SPARKS
 431 Prater Way Sparks, NV 89431
 PH: 775-353-2945

SPARKS MARINA INCLUSIVE
 PLAYGROUND
 IMPROVEMENT PROJECT
 PLAYGROUND IMPROVEMENT PLAN

DRAFTED: G&J
 REVIEWED: G&J
 J & A JOB NUMBER:
 17-105-06

PLAN SET:
 FOR BIDDING ONLY

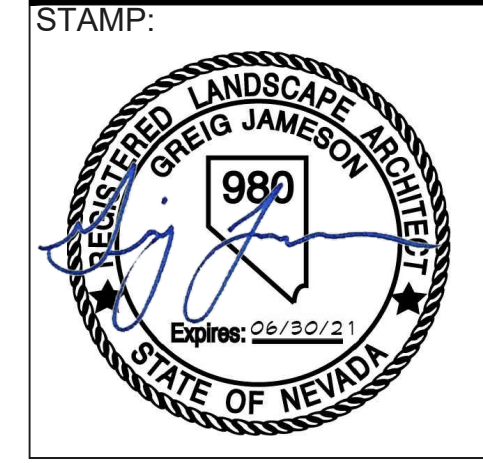

PLAN DATE: 05/12/2021

#	DATE

SCALE: 1:10
 SHEET:

100%
 CONSTRUCTION SET
 05/12/2021

L5
 of 8

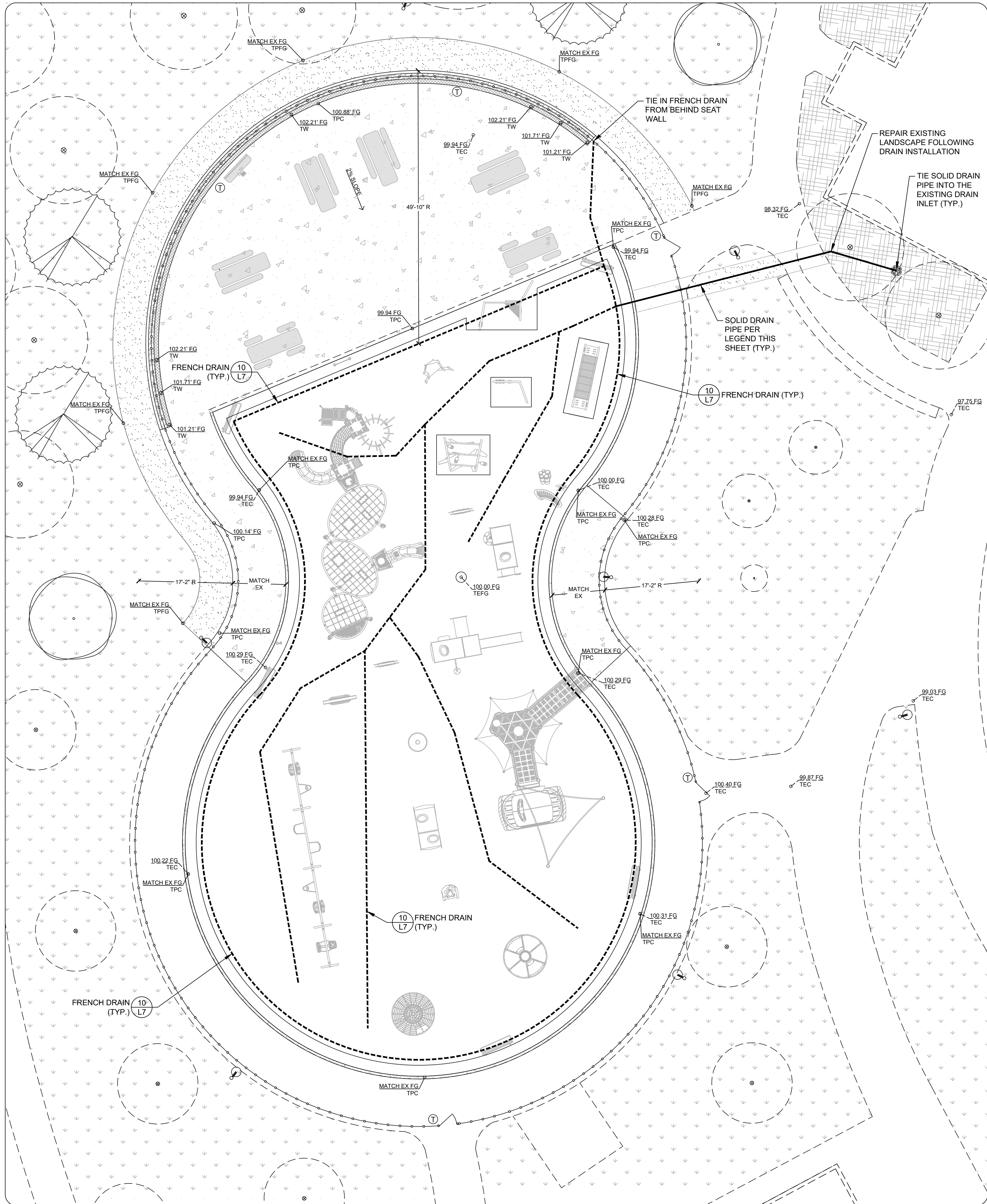

GRADING AND DRAINAGE LEGEND:

- 0.00' FG TEC FG - EXISTING FINISH GRADE
TEC - TOP OF EXISTING CONCRETE
- 0.00' FG TET FG - EXISTING FINISH GRADE
TET - TOP OF EXISTING TURF/LAWN
- 0.00' FG TPC FG - PROPOSED FINISH GRADE
TPC - TOP OF PROPOSED CONCRETE
- 0.00' FG TPS FG - PROPOSED FINISH GRADE
TPS - TOP OF PLAY SURFACE (RUBBER TILES FG)
- 0.00' TPFG PROPOSED TOP OF DRAIN SUMP
TPFG - TOP OF PROPOSED FINISH GRADE
- 0.00' FG TW PROPOSED TOP WALL FINISH GRADE
TW - TOP OF WALL
- FRENCH DRAIN: CONTRACTOR TO FURNISH AND INSTALL 4" ADS PERFORATED DRAIN PIPE WITH 1-1/2" DRAIN ROCK BACKFILL. WRAP ALL SIDES OF THE FRENCH DRAIN WITH LANDSCAPE FABRIC. INSTALL PIPE WITH MINIMUM 1.0% SLOPE TO DRAIN SUMP LOCATION.
- SOLID DRAIN PIPE: CONTRACTOR TO FURNISH AND INSTALL 4" PVC SCHEDULE 40 SOLID DRAIN PIPE AS SHOWN. INSTALL PIPE WITH MINIMUM 1.0% SLOPE TO DRAIN SUMP LOCATION.

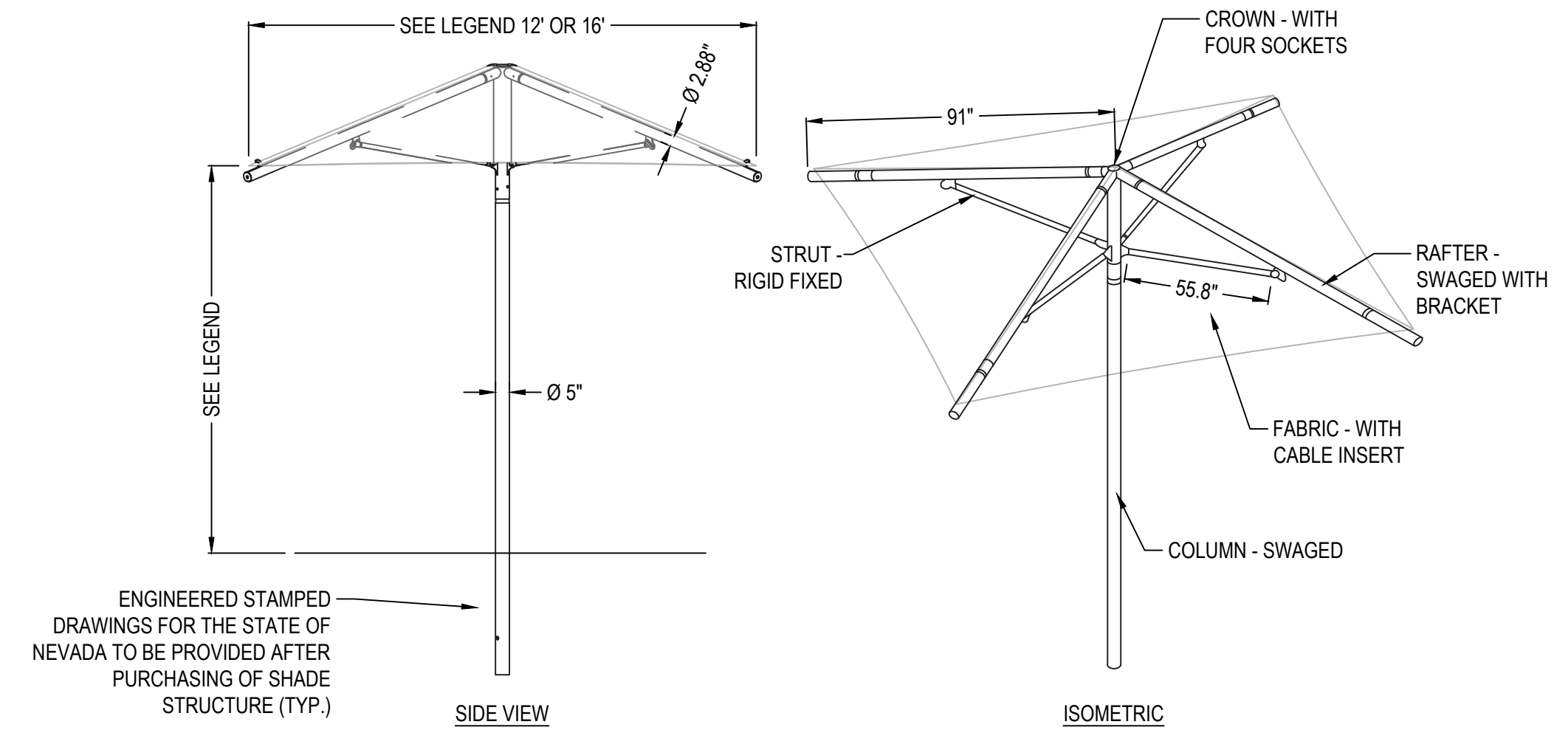

- NOTES:**
- SEE SKYSPAN WEBSITE FOR FRAME AND CANOPY COLOR OPTIONS.
 - INSTALLATION TO BE COMPLETED IN ACCORDANCE WITH MANUFACTURER'S SPECIFICATIONS.
 - DO NOT SCALE DRAWING.
 - THIS DRAWING IS INTENDED FOR USE BY ARCHITECTS, ENGINEERS, CONTRACTORS, CONSULTANTS AND DESIGN PROFESSIONALS FOR PLANNING PURPOSES ONLY. THIS DRAWING MAY NOT BE USED FOR CONSTRUCTION.
 - ALL INFORMATION CONTAINED HEREIN WAS CURRENT AT THE TIME OF DEVELOPMENT BUT MUST BE REVIEWED AND APPROVED BY THE PRODUCT MANUFACTURER TO BE CONSIDERED ACCURATE.
 - CONTRACTOR'S NOTE: FOR PRODUCT AND COMPANY INFORMATION VISIT www.CADdetails.com/info AND ENTER REFERENCE NUMBER 4148-042.

01 BASE BID: 12' AND 16' SHADE STRUCTURE

**SPARKS MARINA INCLUSIVE
PLAYGROUND
IMPROVEMENT PROJECT**

GRADING AND DRAINAGE

DRAFTED: GSJ REVIEWED: GSJ

J & A JOB NUMBER:
17-105-06

PLAN SET:
FOR BIDDING ONLY

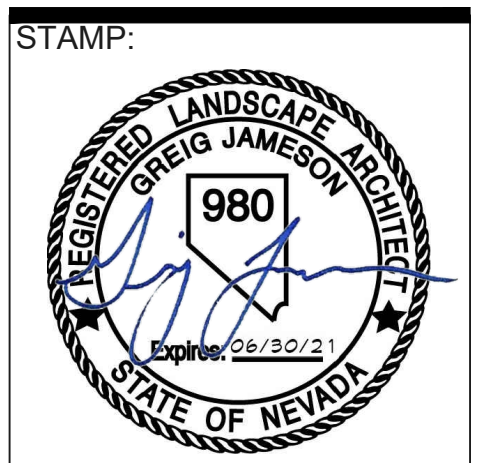

PLAN DATE: 05/12/2021

REVISIONS:

#	DATE

SCALE: 1:10
SHEET:

100%
CONSTRUCTION SET
05/12/2021

L6
of 8

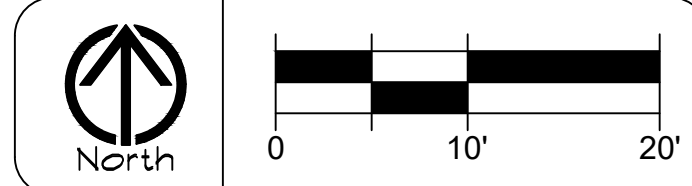

SECTION A-A

PLAN

NOTES:

1. PORTLAND CEMENT CONCRETE (P.C.C.) SHALL HAVE THE FOLLOWING CHARACTERISTICS: 4000 PSI MIN. COMPRESSIVE STRENGTH AT 28 DAYS, MIN. 6 SACKS OF CEMENT PER CUBIC YARD WITH MAX. WATER-CEMENT RATIO OF 0.45, AIR ENTRAINMENT 6% ±1.5%, SLUMP AT 1 TO 4 INCHES. MIX DESIGN SHALL CONFORM TO THE REQUIREMENTS OF SECTION 337 OF STANDARD SPECIFICATIONS OF PUBLIC WORKS CONSTRUCTION (SSPWC), AS ADOPTED BY CITY COUNCIL. CEMENT SHALL BE TYPE II. ALL CEMENT CONCRETE SHALL HAVE A COARSE AGGREGATE GRADATION CONFORMING TO SIZE No. 57. POLYPROPYLENE OR CELLULOSE FIBERS SHALL BE ADDED TO THE P.C.C. AT 1.5 LBS. PER CUBIC YARD. ALL MATERIALS SHALL CONFORM TO SSPWC, AS ADOPTED BY CITY COUNCIL.
2. AGGREGATE BASE MATERIAL UNDER SIDEWALKS SHALL BE TYPE 2, CLASS B CRUSHED AGGREGATE BASE. MATERIALS SHALL CONFORM TO SSPWC SECTION 200, AS ADOPTED BY CITY COUNCIL.
3. SIDEWALK WIDTH "W" SHALL BE 4 FT MIN. WITH 60" PASSING SPACE EVERY 200' ON RESIDENTIAL STREETS AND 6 FT MIN. ON COLLECTOR AND ARTERIAL STREETS.
4. WEAKENED PLANE JOINTS SHALL BE CONSTRUCTED AT 5 FT INTERVALS AND ACCORDANCE WITH SECTION 312 OF THE SSPWC, AS ADOPTED BY CITY COUNCIL.
5. ALL ADJACENT CONCRETE REMOVAL SHALL BE TO NEAT SAW CUT LINES AT RIGHT ANGLES TO NEW SIDEWALK. DOWEL INTO EXISTING ADJACENT CONCRETE SIDEWALK WITH A MINIMUM OF TWO (2) No. 4 REINFORCEMENT BARS EQUALLY SPACED ACROSS WIDTH "W". DOWELS SHALL PENETRATE A MINIMUM OF 4" INTO EXISTING CONCRETE.
6. SIDEWALKS SHALL NOT BE POURED MONOLITHICALLY WITH CURBS.
7. TUNNELING AND/OR BORING IS NOT ALLOWED.

STANDARD DETAILS FOR PUBLIC WORKS CONSTRUCTION	DRAWING No.
SIDEWALK DETAIL	S-103
	APPROVED BY: JE DATE: 1/2020

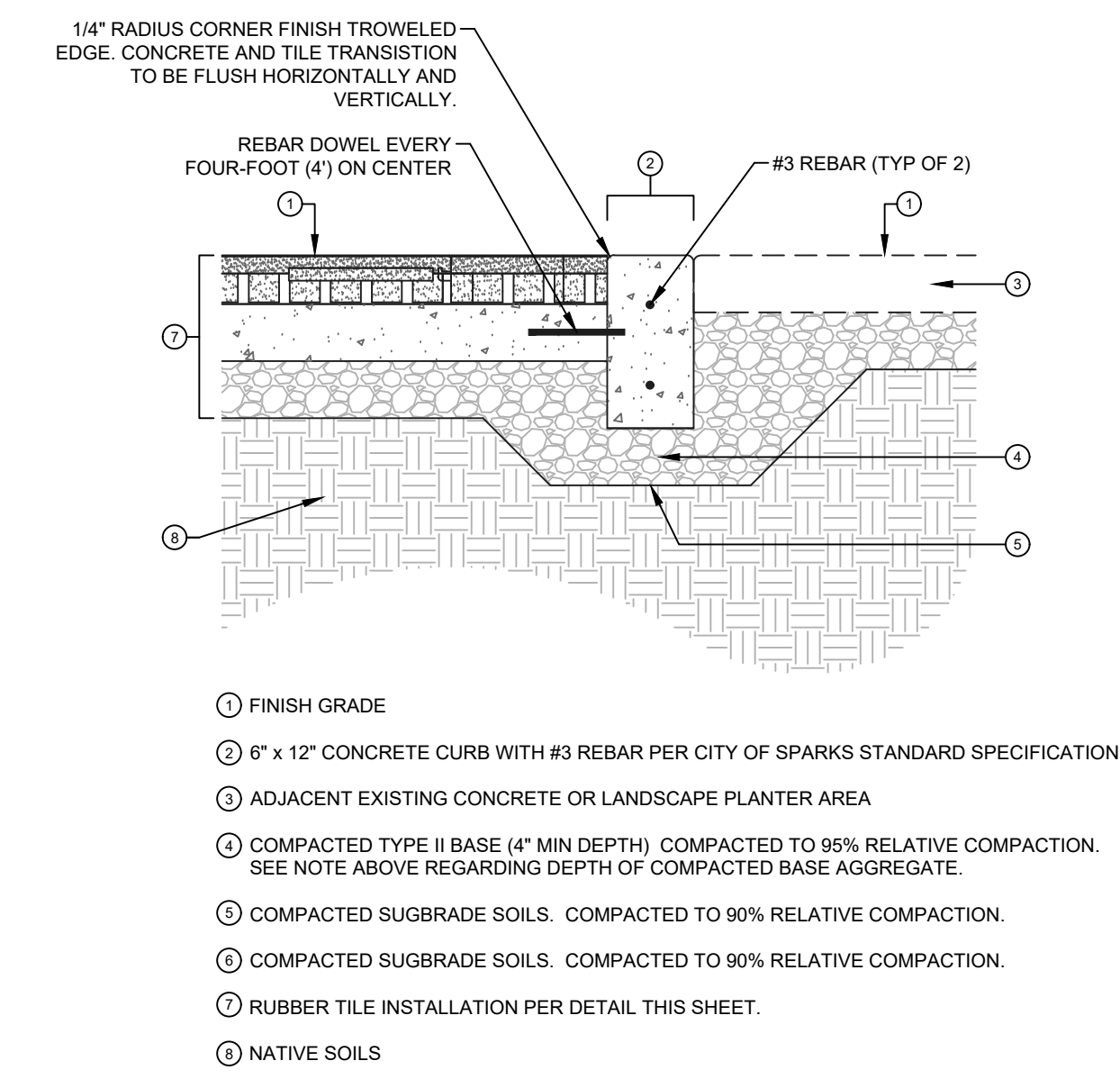
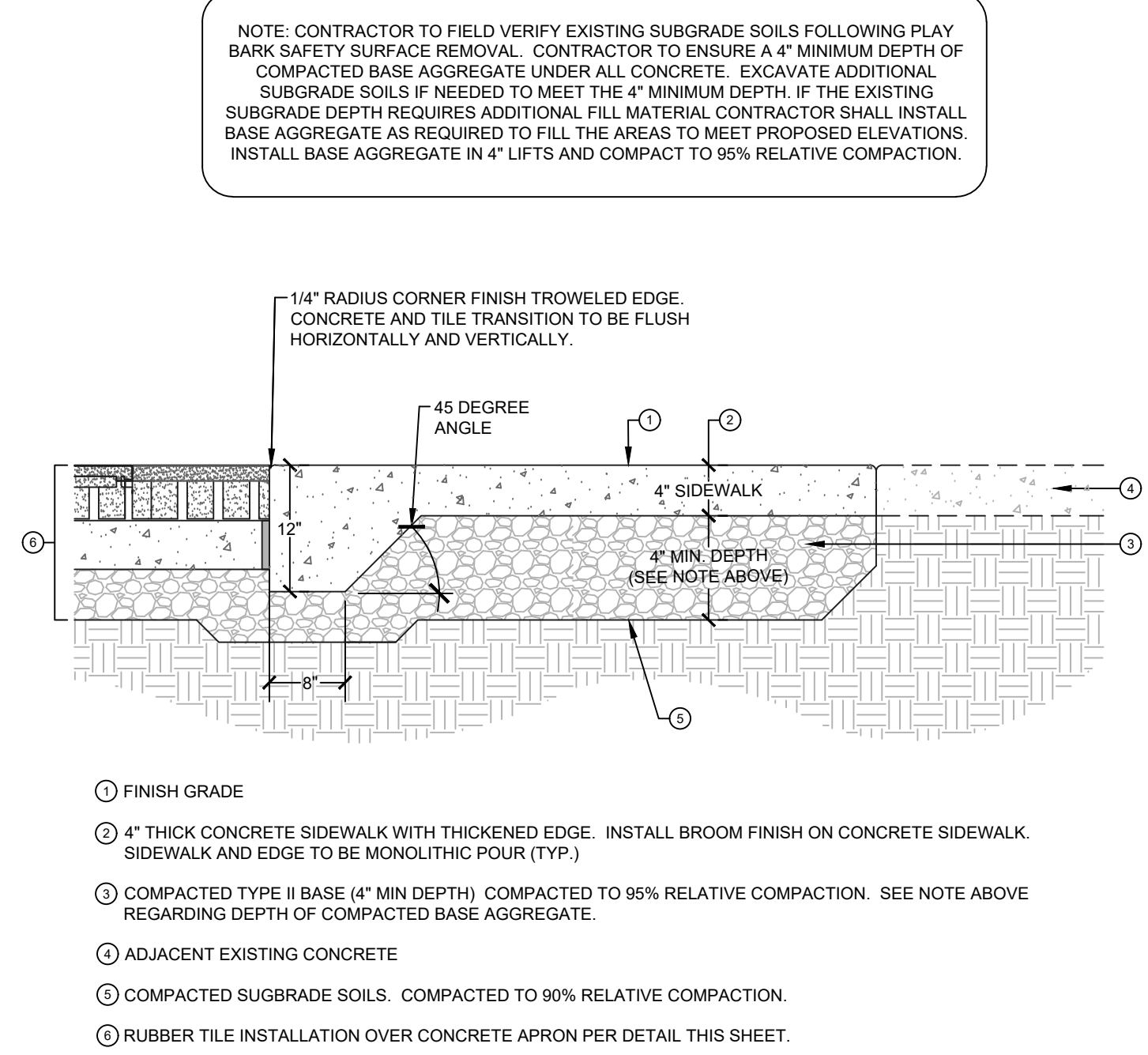
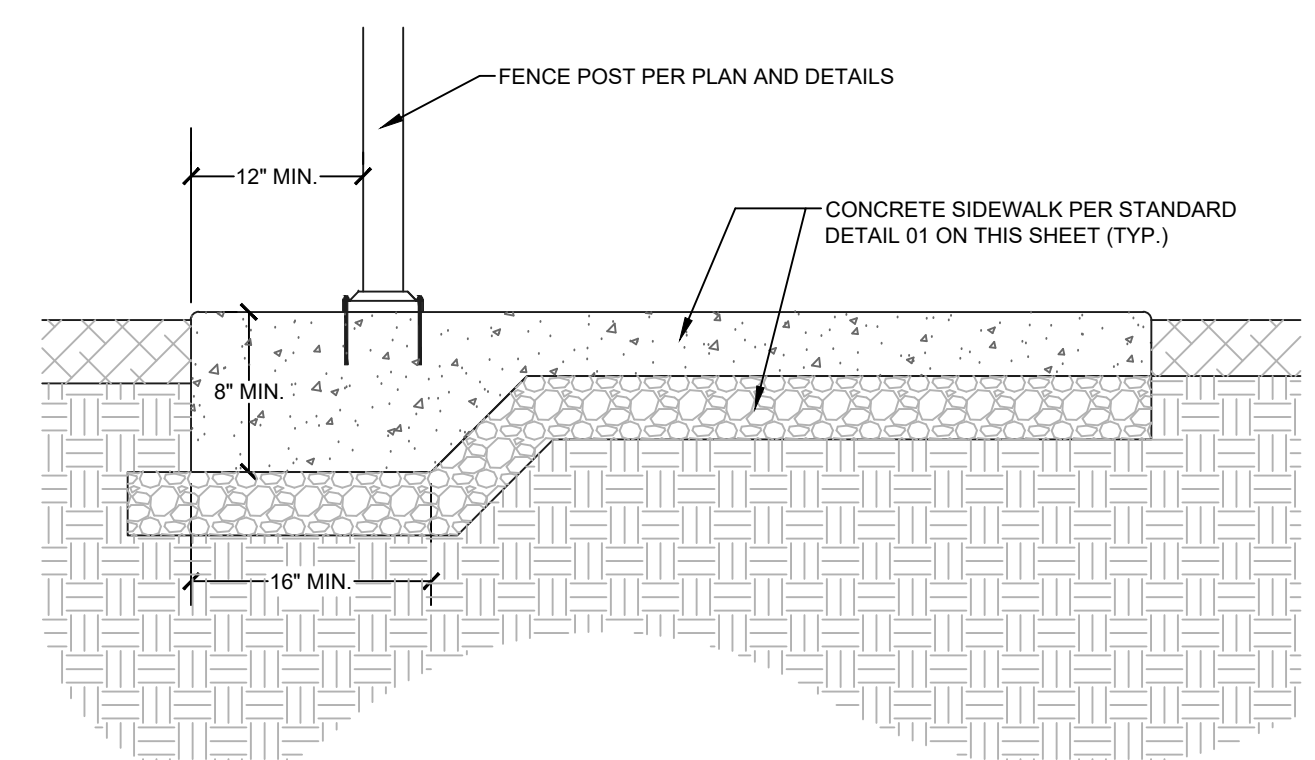

02 CONCRETE SIDEWALK (STANDARD)

03 CONCRETE SIDEWALK THICKENED EDGE (UNDER FENCE)

04 CONCRETE SIDEWALK THICKENED EDGE (RUBBER TILES)

05 6x12 CONCRETE CURB

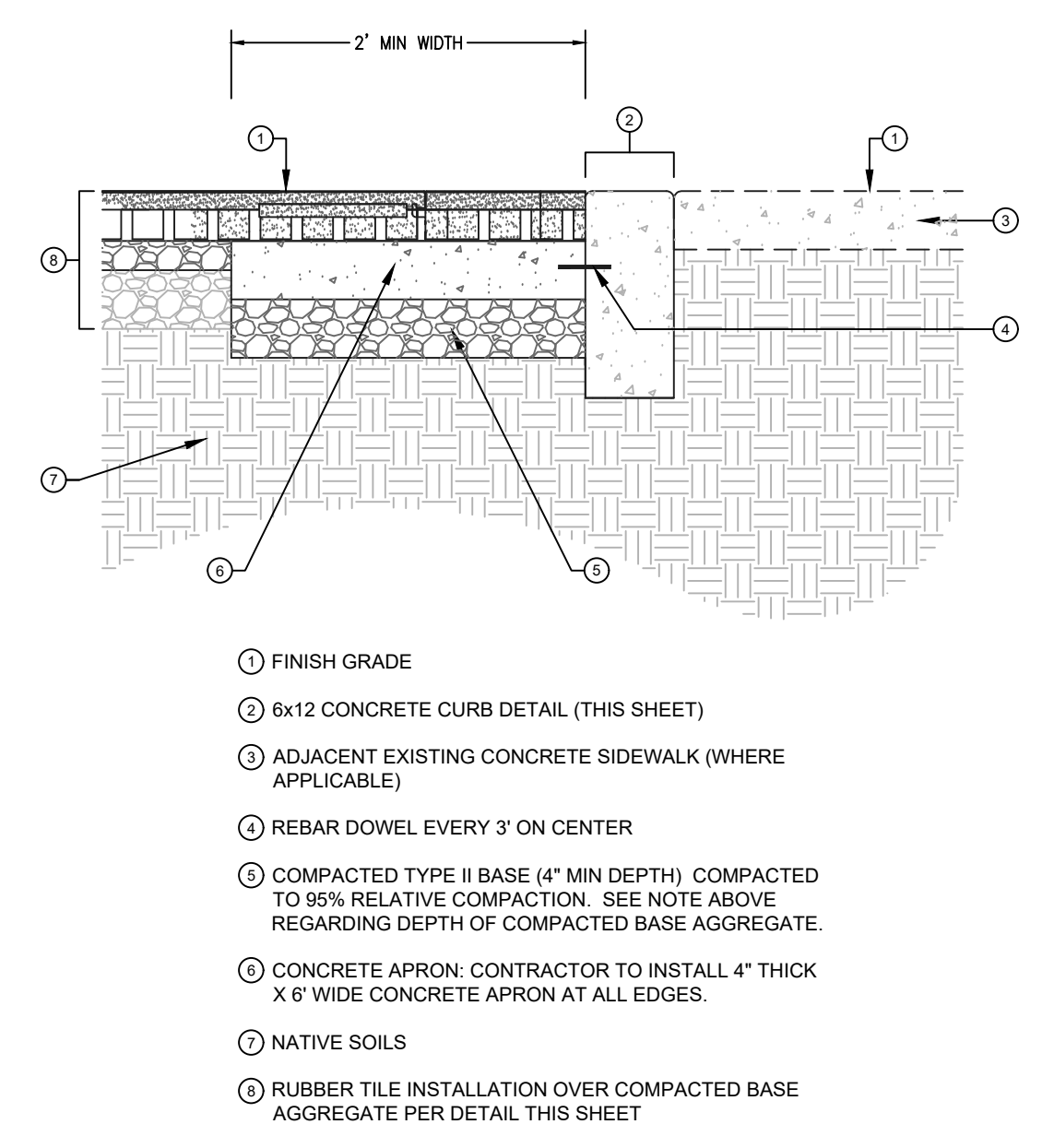
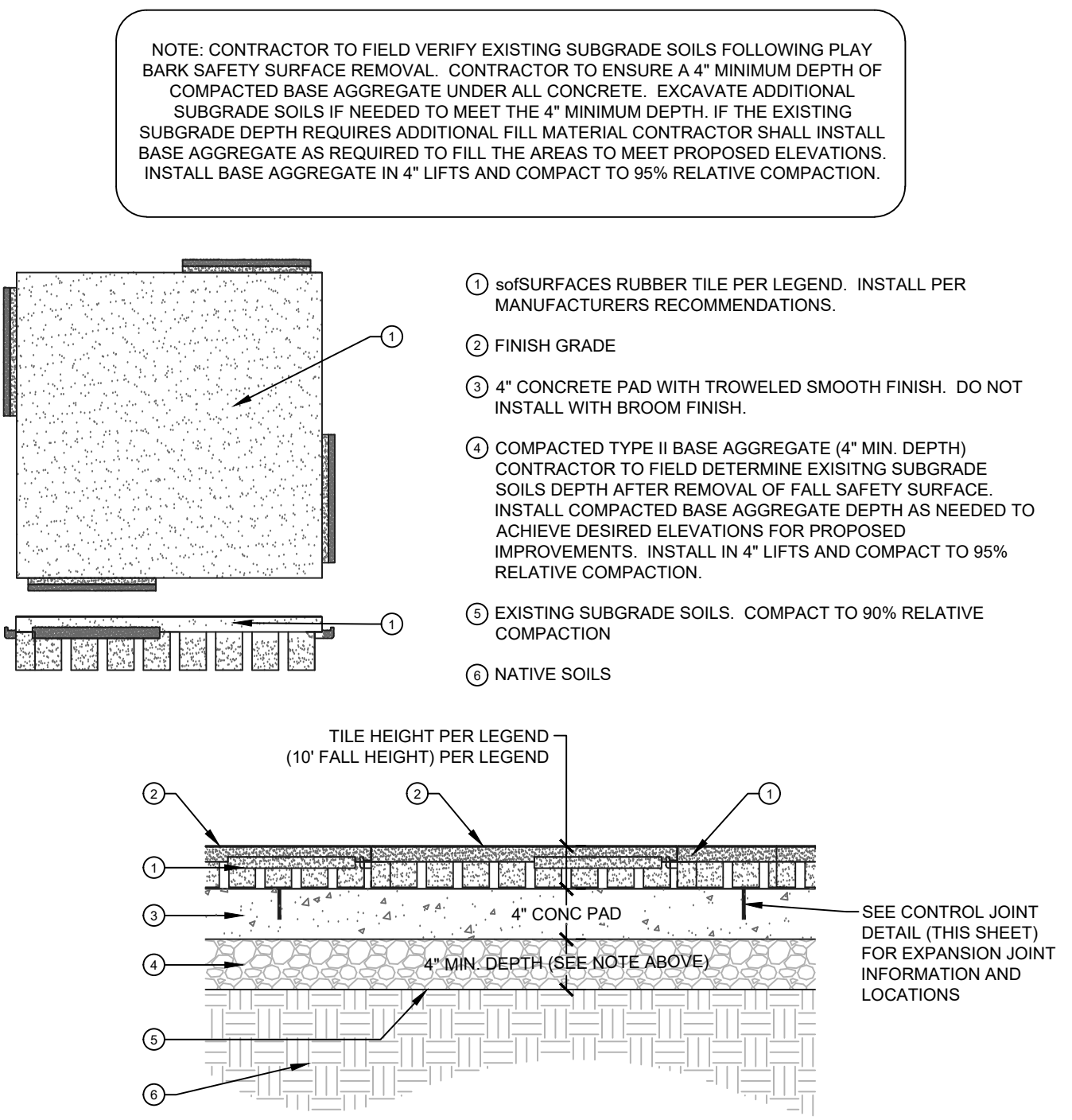

08 RUBBER TILES OVER BASE AGGREGATE

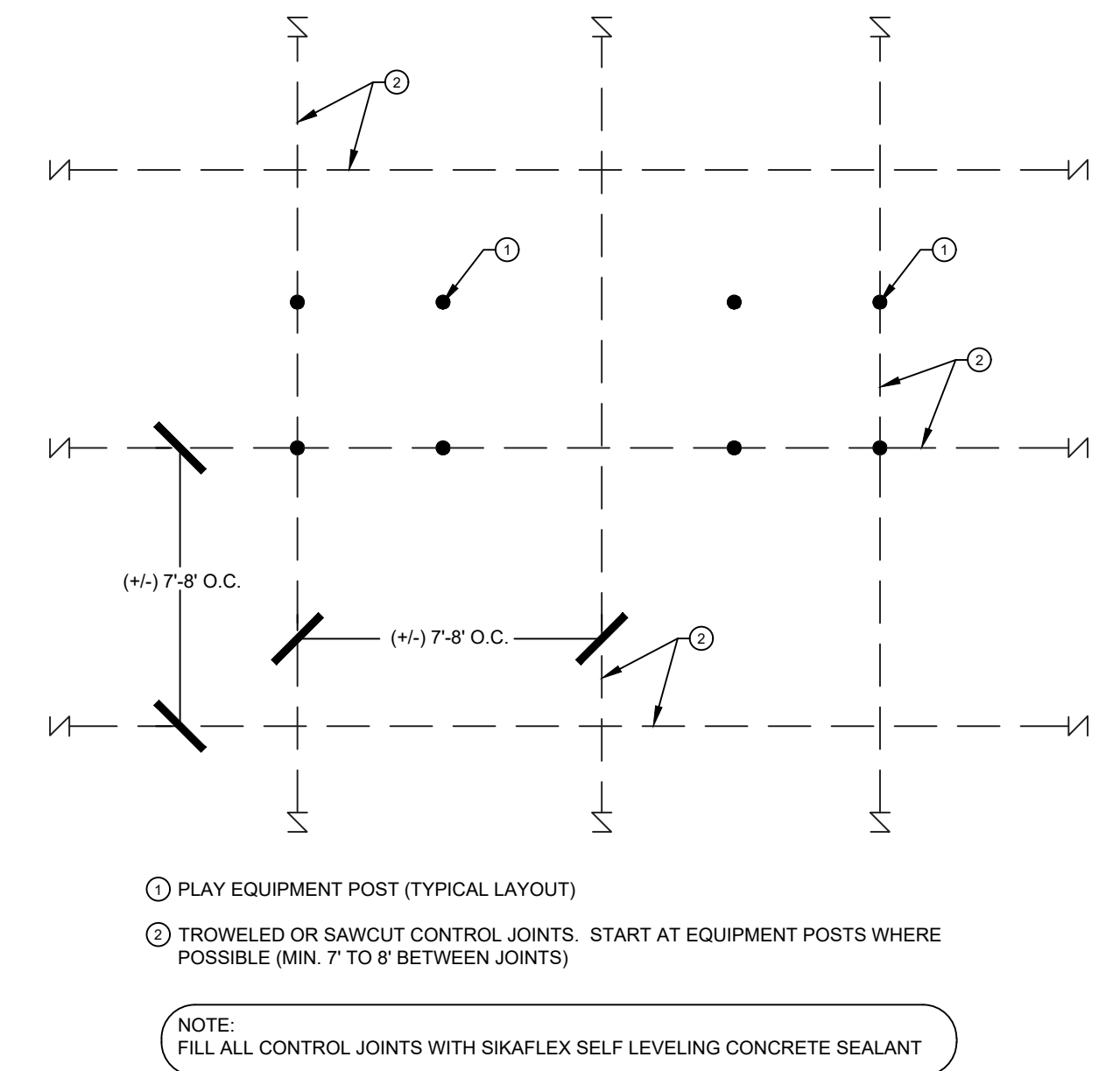

09 CONCRETE APRON CONTROL JOINT

FRENCH DRAIN UNDER CONCRETE APRON

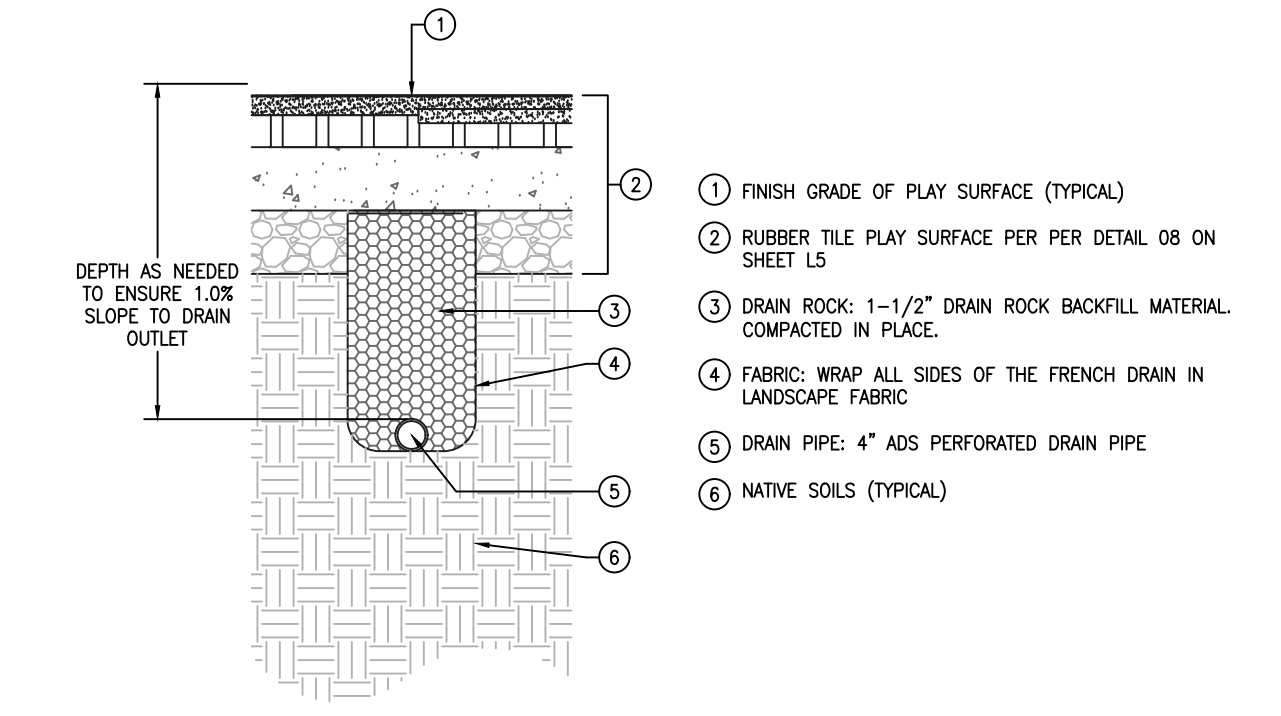

FRENCH DRAIN (IN BASE AGGREGATE AREA)

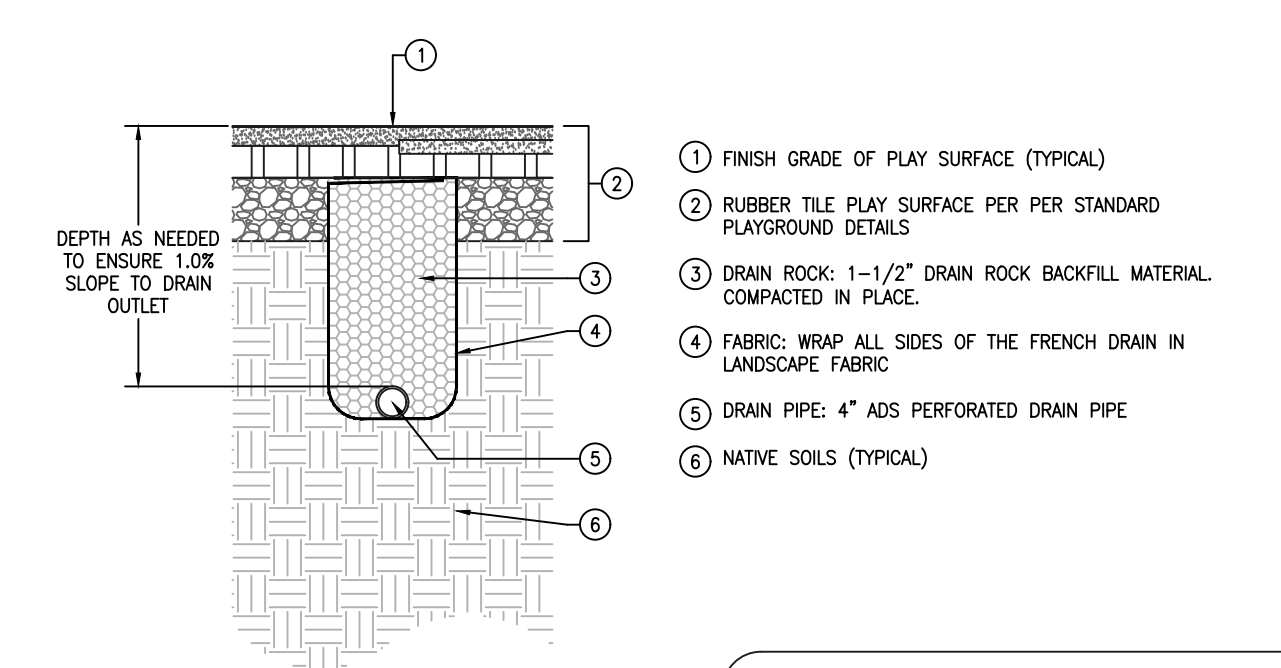

10 FRENCH DRAIN

06 RUBBER TILES ON CONCRETE

07 2' CONCRETE APRON

CITY OF SPARKS

SPARKS MARINA INCLUSIVE PLAYGROUND IMPROVEMENT PROJECT

431 Prater Way Sparks, NV 89431
 PH: 775-353-2345

DETAILS SHEET

DRAFTED: G&J
 REVIEWED: G&J
 J & A JOB NUMBER: 17-105-06

PLAN SET: FOR BIDDING ONLY

STAMP: GREG JAMESON, LICENSED LANDSCAPE ARCHITECT, STATE OF NEVADA, License No. 980, Expires: 06/30/21

PLAN DATE: 05/12/2021

REVISIONS:	#	DATE

SCALE: N.T.S.
 SHEET:

100%
 CONSTRUCTION SET
 05/12/2021

L7
 of 8

Commercial 4" O.C. Post Spacing Chart

POST SIZE	BETWEEN POSTS	POST O.C.
2 1/2"	92 1/8"	94 5/8"

FENCE POST OVER EXISTING CONCRETE:

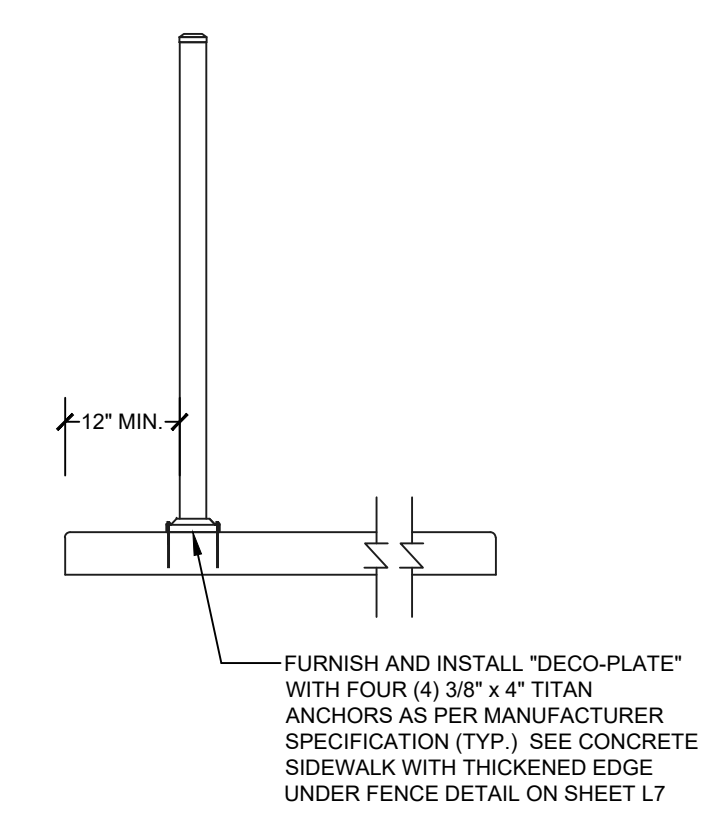

FENCE POST OVER NEW CONCRETE:

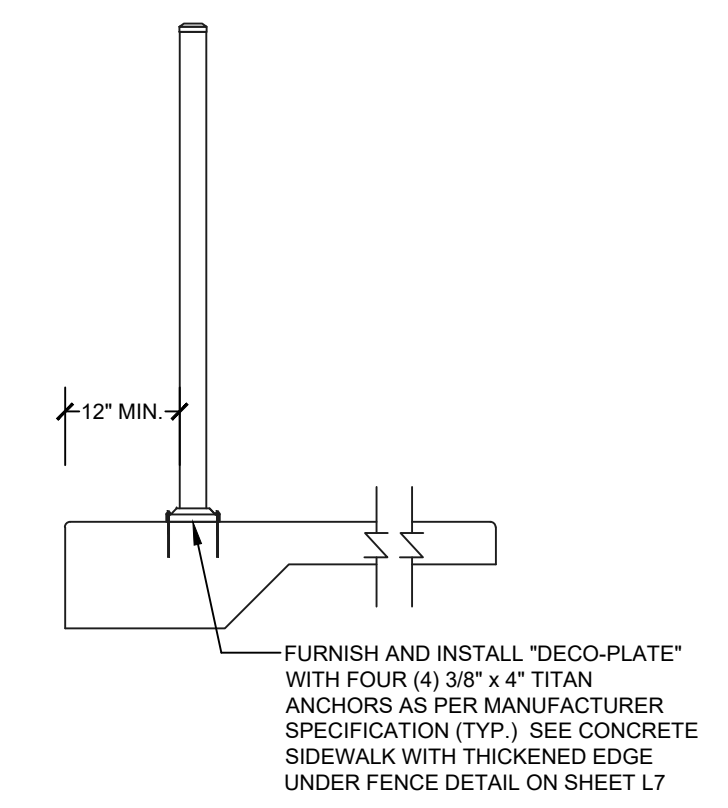

NOTE: GATES ARE TO BE INSTALLED SO THAT THEY SWING OUTWARD WITH PANIC HARDWARE ON THE INSIDE FOR FIRE EGRESS

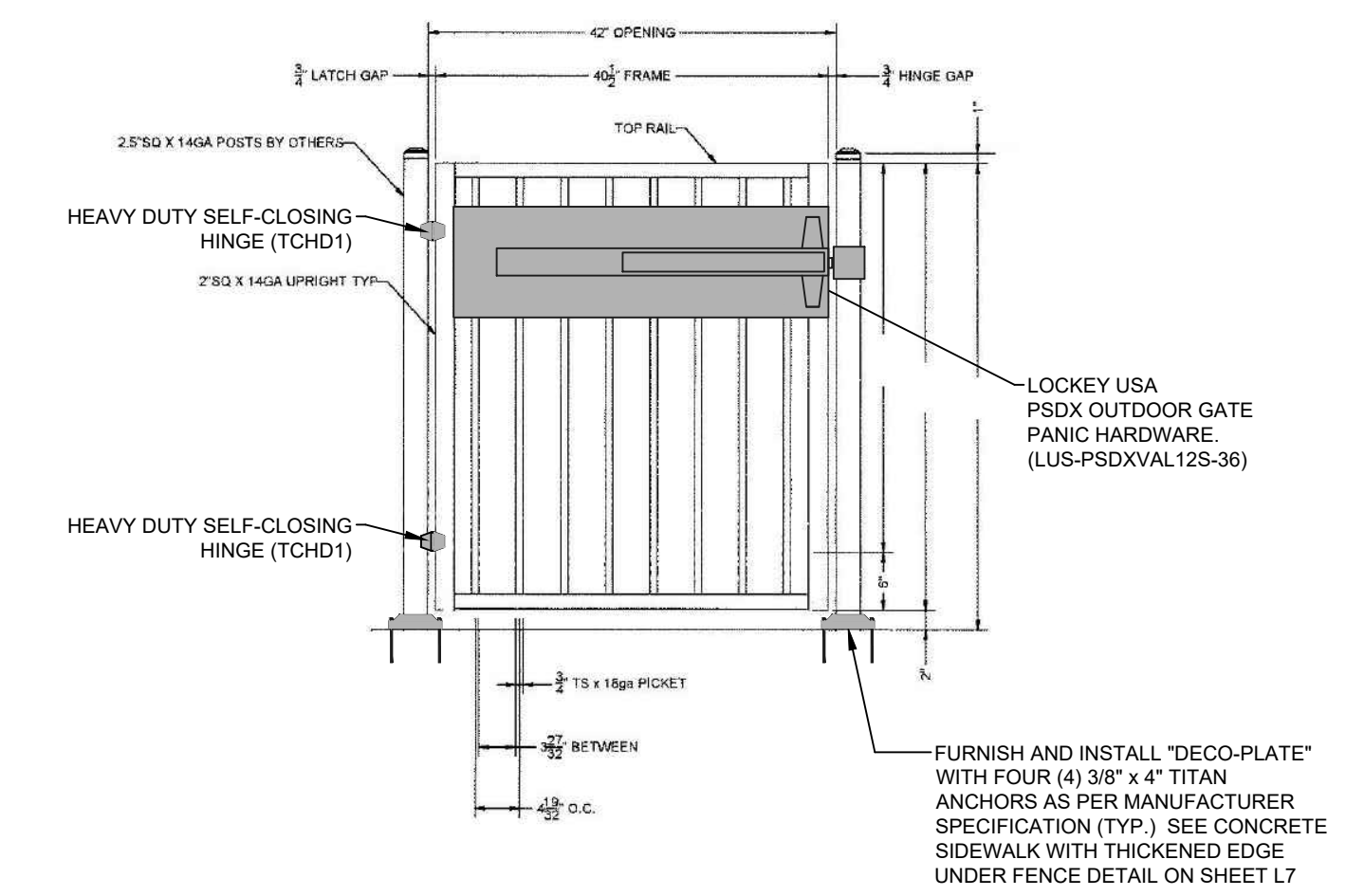

CONTRACTOR TO FURNISH AND INSTALL 5' TALL HEAVY REGAL GATE WITH BOTTOM RAIL AS SHOWN. COLOR TO BE BLACK.

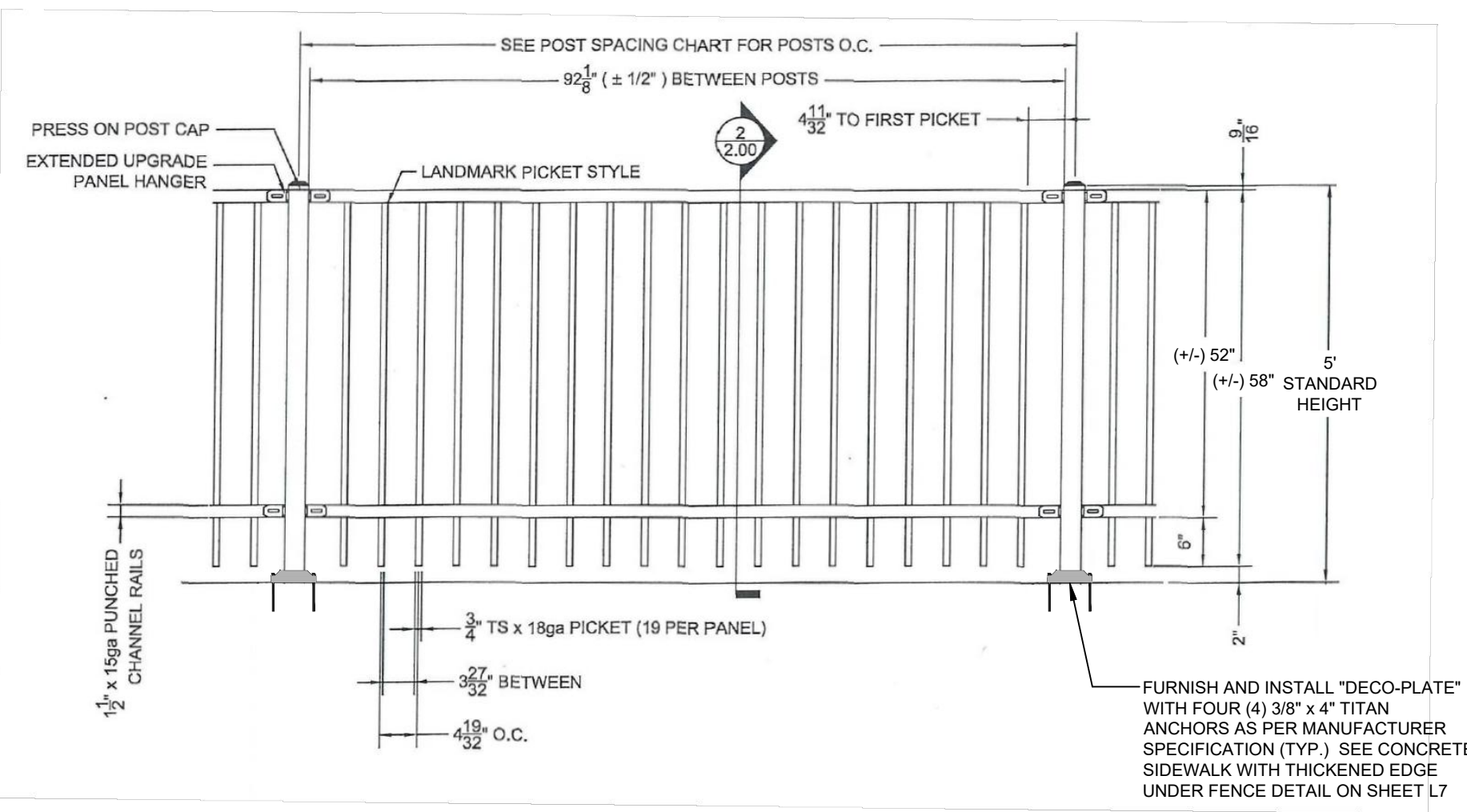
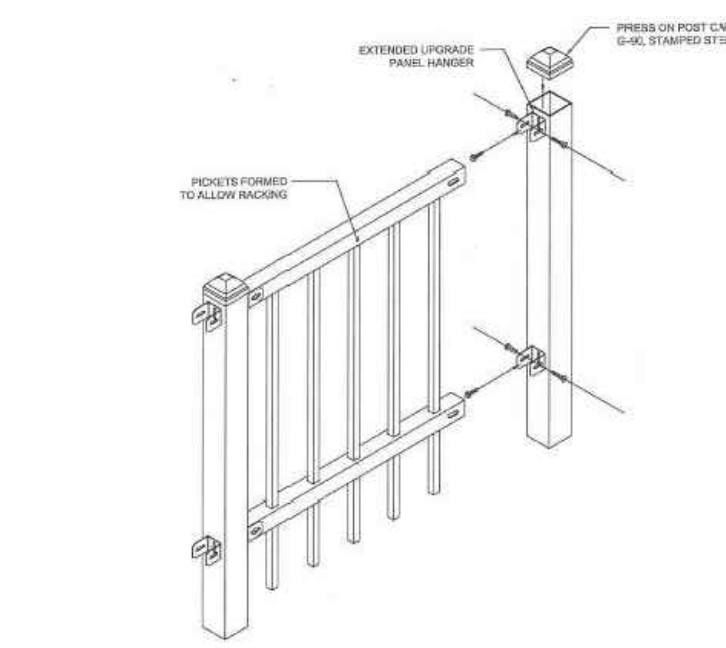

CONTRACTOR TO FURNISH AND INSTALL 5' TALL, BETAFENE USA, COMMERCIAL LANDMARK FENCING AS SHOWN. COLOR TO BE BLACK.

11 STANDARD 5' FENCING

12 STANDARD 42" WIDE x 5' TALL GATE

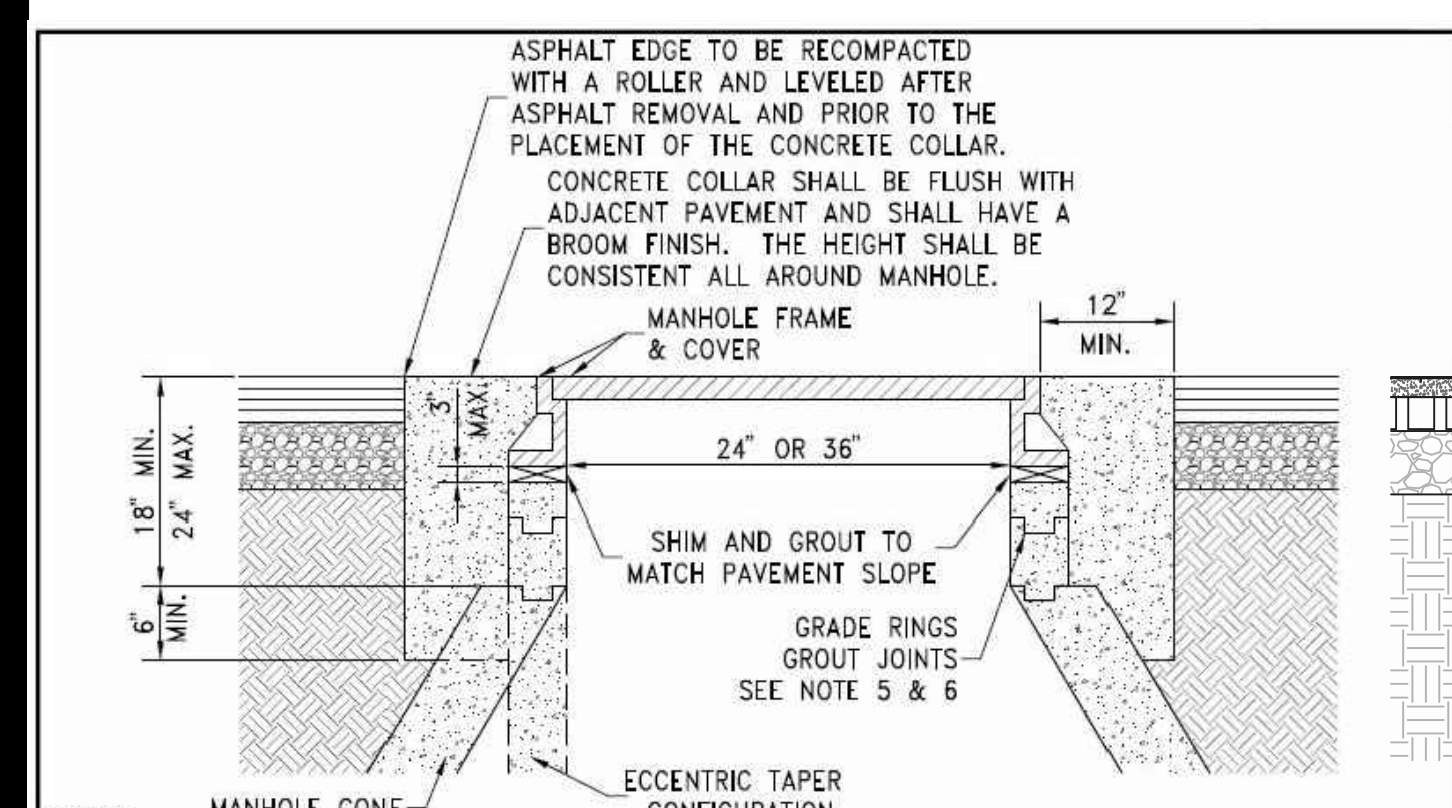

- NOTES:
1. PORTLAND CEMENT CONCRETE (P.C.C.) SHALL HAVE THE FOLLOWING CHARACTERISTICS: 4000 PSI MIN. COMPRESSIVE STRENGTH AT 28 DAYS, MIN. 6 SACKS OF CEMENT PER CUBIC YARD WITH MAX. WATER-CEMENT RATIO OF 0.45, AIR ENTRAINMENT 6% ± 1.5%, SLUMP AT 1 TO 4 INCHES. MIX DESIGN SHALL CONFORM TO THE REQUIREMENTS OF SECTION 337 OF STANDARD SPECIFICATIONS OF PUBLIC WORKS CONSTRUCTION (SSPWC), AS ADOPTED BY CITY COUNCIL. CEMENT SHALL BE TYPE II. ALL CEMENT CONCRETE SHALL HAVE A COARSE AGGREGATE GRADATION CONFORMING TO SIZE NO. 67. POLYPROPYLENE OR CELLULOSE FIBERS SHALL BE ADDED TO THE P.C.C. AT 1.5 LBS. PER CUBIC YARD. ALL MATERIALS SHALL CONFORM TO SSPWC, AS ADOPTED BY CITY COUNCIL.
 2. CIRCUMSTANCES MAY REQUIRE THE NEED FOR SPECIAL TYPES OF TOP OF MANHOLE CONFIGURATIONS SUCH AS FLAT TOP, ABOVE GROUND, ETC. AS DIRECTED BY THE CITY OF SPARKS. DETAILED PLANS OF ANY SPECIAL TOP OF MANHOLE CONFIGURATIONS AND ASSOCIATED COLLARS MUST BE APPROVED BY THE CITY ENGINEER.
 3. IN UNPAVED AREAS, IT SHALL BE NECESSARY TO SET THE MANHOLE RIM APPROXIMATELY 6 INCHES ABOVE THE SURROUNDING AREA. INSTALL A 6 INCH THICK RING OF CONCRETE, TAPERED AT A 3:1 SLOPE, FROM THE TOP, OUTSIDE EDGE OF THE COLLAR TO THE EXISTING GROUND SURFACE.
 4. EXISTING SANITARY SEWER MANHOLE LIDS LOCATED IN GUTTER PANS, SHALL HAVE NEW WATER TIGHT FRAMES AND COVERS.
 5. ALL GRADE RING JOINTS ARE TO BE GROUTED WITH NON-SHRINK GROUT HAVING THE FOLLOWING CHARACTERISTICS: 3000 PSI MIN. COMPRESSIVE STRENGTH AT 28 DAYS, MIN. 6 SACKS OF CEMENT PER CUBIC YARD AND SLUMP AT 1 TO 4 INCHES. ALL MATERIAL SHALL CONFORM TO SSPWC, AS ADOPTED BY CITY COUNCIL.
 6. ALL GRADE RINGS SHALL BE PORTLAND CEMENT CONCRETE. PVC GRADE RINGS ARE NOT ALLOWED. CONTRACTOR SHALL USE AS FEW GRADE RINGS AS POSSIBLE TO REACH REQUIRED DEPTH. HOWEVER IN NO CASE SHALL THE QUANTITY EXCEED 4 GRADE RINGS WITHOUT APPROVAL OF THE CITY ENGINEER.
 7. P.C.C. COLLARS IN ALL ROADWAYS SHALL BE PROTECTED FROM TRAFFIC LOADS UNTIL MINIMUM 3000 PSI IS ATTAINED.

STANDARD DETAILS FOR PUBLIC WORKS CONSTRUCTION	DRAWING No.
MANHOLE COLLAR	S-210A
APPROVED BY: JE	DATE: 1/2020

13 STANDARD MANHOLE

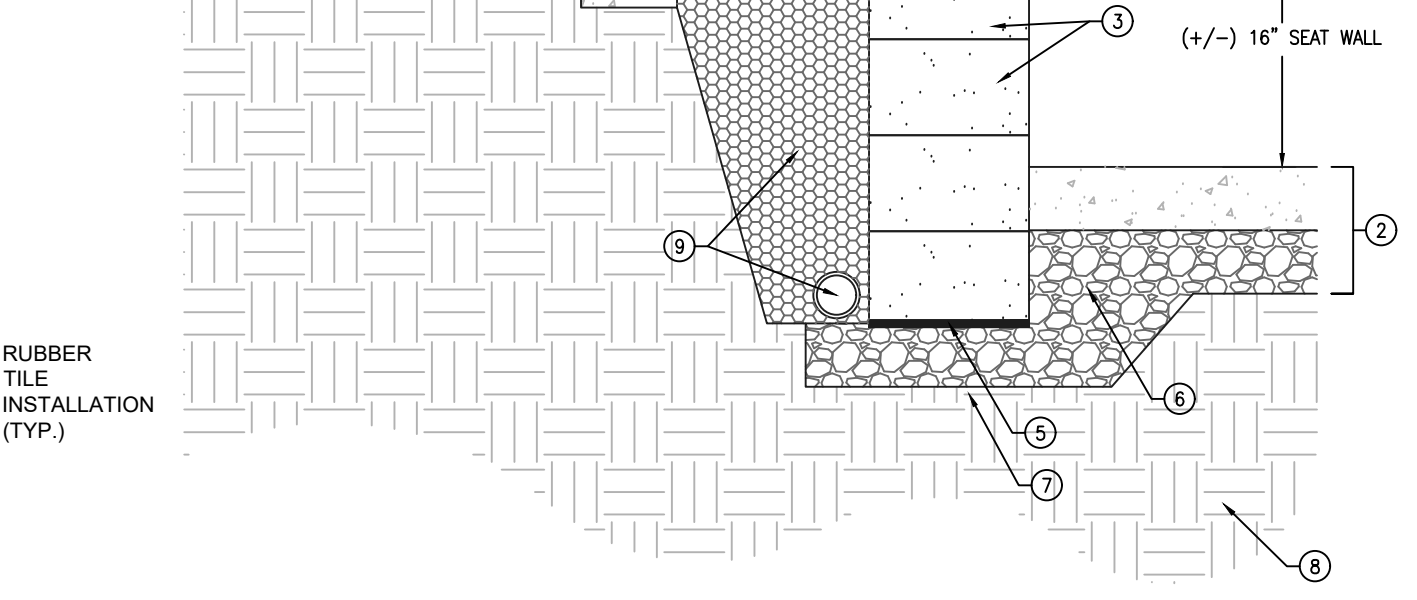
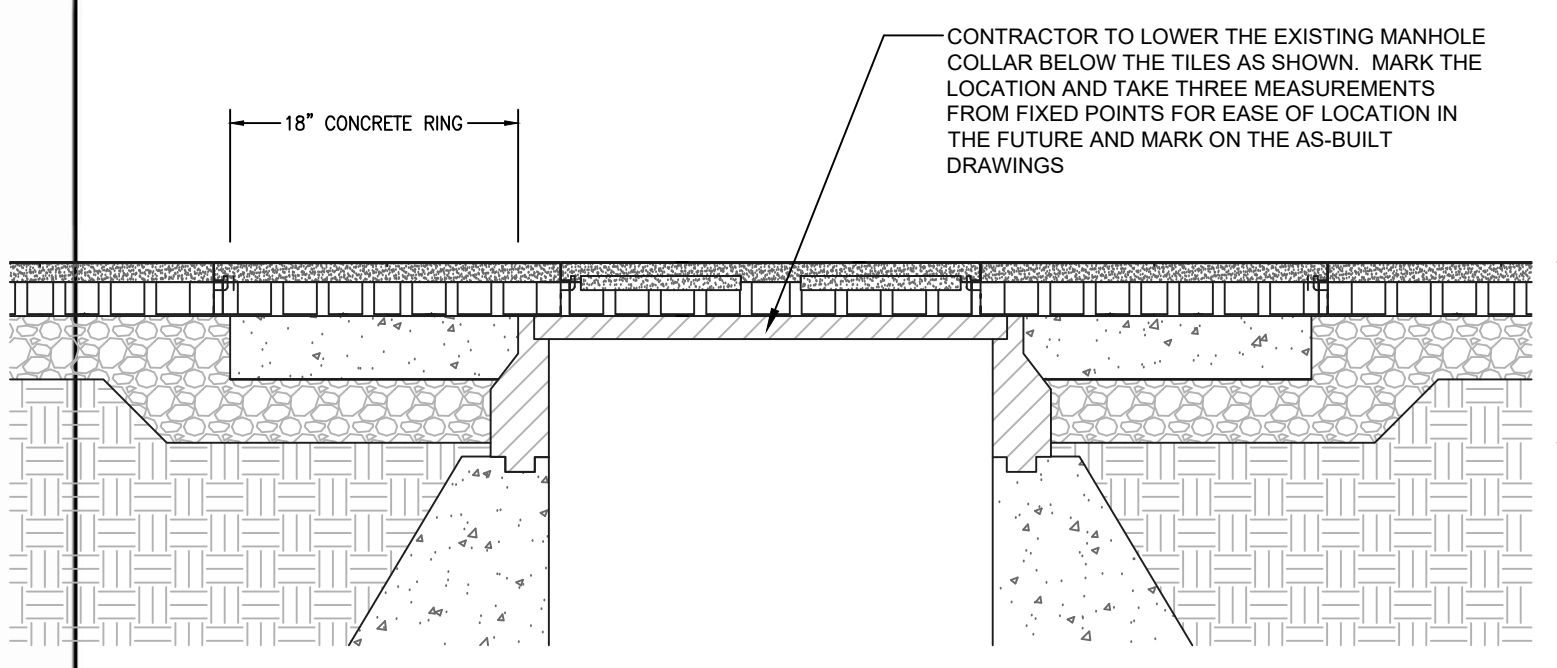

- 1 FINISH GRADE OF THE EXISTING TURF (TYP.)
- 2 CONCRETE SIDEWALK PER DETAIL 02/03, SHEET L7
- 3 KEystone COUNTRY MANOR FREE STANDING BLOCK WALL. COLOR AND TYPE OF BLOCK WALL TO MATCH EXISTING SITE BLOCK WALL.
- 4 FREE STANDING BLOCK WALL CAP. COLOR AND TYPE TO MATCH KEystone MANOR BLOCK.
- 5 LEVELING SAND: 1/2" MIN. DEPTH OF WASHED MORTAR SAND FOR LEVELING
- 6 TYPE II COMPACTED BASE AGGREGATE. COMPACTED TO 95% RELATIVE COMPACTION. 4" MINIMUM DEPTH REQUIRED
- 7 COMPACTED NATIVE SUB-GRADE SOILS. COMPACTED TO 90% - 95% RELATIVE COMPACTION
- 8 NATIVE SOIL (TYPICAL)
- 9 FRENCH DRAIN PER DETAIL ON SHEET L7. CONTRACTOR TO COORDINATE FRENCH DRAIN INSTALLATION AROUND THE SLEEVEIT FENCE POST SLEEVE AS SHOWN.
- 10 SLEEVEIT FENCE POST SLEEVE INSTALLED AS PER FENCE CONTRACTOR RECOMMENDED SPACING
- 11 CONCRETE MOW CURB PER DETAIL 15 THIS SHEET
- 12 RIVER ROCK: 3" MINUS RIVER ROCK GROUND COVER MULCH WITH FABRIC UNDER THE FENCE

- 1 FINISH GRADE
- 2 6x6 EXTRUDED CONCRETE CURBING
- 3 GROUND COVER MULCH PER LANDSCAPE PLAN AND LEGEND
- 4 TYPE II COMPACTED BASE AGGREGATE. COMPACTED TO 95% RELATIVE COMPACTION. 4" MINIMUM DEPTH REQUIRED.
- 5 COMPACTED NATIVE SUB-GRADE SOILS. COMPACTED TO 90% - 95% RELATIVE COMPACTION
- 6 NATIVE SOILS
- 7 TURF, SEED OR SOO PER LANDSCAPE PLAN AND LEGEND

100%
CONSTRUCTION SET
05/12/2021

14 BLOCK SEATING WALL AND FRENCH DRAIN

15 6x6 CONCRETE MOW CURB