



ADDENDUM #2
JACK REVIGLIO MEMORIAL PARK
BID # 20/21-013 / PWP # WA-2021-168
BIDS DUE NO LATER THAN: 1:45 PM ON MARCH 10, 2021
PUBLIC BID OPENING: 2:00 PM ON MARCH 10, 2021

This addendum is to notify all potential proposers of clarifications made to the Bid documents as stated below.

COVID-19 Precautions – Due to the City’s response to the COVID-19 virus and associated reduction in staff, in-person staff availability is limited. Bidders wishing to physically deliver their bids on the bid due date shall note that the Purchasing Office will receive bids in the lobby of City Hall beginning at 1PM on March 10th. Bids are due no later than 1:45PM. Bids may also be delivered to the Purchasing Department physical dropbox/mailbox, also located in the lobby of City Hall.

1. Bid Item Schedule – The original Bid Item Schedule found on Pages 5-9 of the original Bid Book shall be replaced by the revised Bid Item Schedule contained in this Addendum.
2. Bid Item Clarifications – The original Bid Item Clarifications found on Pages 51-56 of the original Bid Book shall be replaced with the revised Bid Item Clarifications contained in this Addendum.
3. RFI question responses:
 - a. In Section 28 of the Special Conditions it states, “Bidder shall provide proof of certification and a list, with contact information, of a minimum of three (3) similar playground installations completed by the qualified playground installer within the last five (5) years prior to award of the contract.”
There is a similar statement in Section 29. Can you please clarify who needs to submit this information (low bidder only?) and confirm this information does not have to be submitted with the bid?
 - i. **Answer:** Low bidder shall supply the requested information noted in Special Provisions Sections 28 and 29 prior to award of the contract. This information does **NOT** need to be submitted with the bid package.
 - b. Regarding Apprenticeship, is this project categorized as horizontal or vertical?
 - i. **Answer:** This project shall be classified as vertical construction.

- c. Is there going to be any type of drainage underneath the alt tile installation?
 - i. **Answer:** Contractor shall provide a French drain at the perimeter edge of the concrete apron per attached revised Sheet L7. Refer to the plan and the added details E and F for the design of the French drain system. See revised Bid Item Schedule and Bid Item Clarifications A1.0.
- d. The shade shelter is specified to be an RCP Shelters SLF-SG24-04. No such model appears to exist. Please clarify the model of shade shelter required.
 - i. **Answer:** The model number changed during the bidding process. The RCP Shelters, Inc. steel shade structure new model number is TS-SQ24-04. The Reference Chart on the attached revised Sheet L2, has been revised to reference the new model number.
- e. On the specifications for landscape, it says 1 year maintenance for all planted areas. Does this include grass/sod? Also, is this a maintenance period or a warranty?
 - i. **Answer:** The intent of the one-year maintenance/warranty period is to ensure the plants/trees/shrubs and irrigation of the park is turned over in good condition at end of the one-year period. The Contractor shall be responsible for ensuring the proper precipitation rates are in place in conjunction with the irrigation schedules. Irrigation shall be in good working condition at the end of the one-year maintenance period. Shrubs, trees, and grass/sod during shall be in healthy condition at end of the one-year maintenance/warranty period. Bidders shall **NOT** include the mowing, trimming, and site cleanup in Bid Item Clarification 41. See the attached revised Bid Item Clarifications.

Please note and adjust your bid according to the revisions, additions, deletions, clarifications or modifications as presented on this Addendum #2, which are made a part of this bid. NOTE: To avoid disqualification, this Addendum 2 (and any other addenda) must be signed by an authorized representative of the bidding firm in the space provided and must be submitted with your firm's sealed proposal. Failure to return this addendum, duly signed, may be cause for rejection of the bid. ALL ADDENDA SHOULD BE SIGNED AND PLACED IN SEQUENTIAL ORDER AND ATTACHED TO THE FRONT OF THE BID PACKAGE, COMPLETE WITH ALL REQUIRED DOCUMENTS.

CONTRACTOR BUSINESS NAME

Dan Marran, C.P.M., CPPO
Contracts and Risk Manager

X _____
Authorized Signature

March 5, 2021

Printed Name of Person Signing

CITY OF SPARKS
BID ITEM SCHEDULE-REVISED BY ADDENDUM #2
BID NUMBER 20/21-013 PWP# WA-2021-168

BID TITLE: Jack Reviglio Memorial Park

PRICES must be valid for 90 calendar days after the bid opening.

COMPLETION of this project is expected **PURSUANT TO CONTRACT DOCUMENTS.**

BIDDER acknowledges receipt of _____ Addenda.

Bidder Name

(signature)

Jack Reviglio Memorial Park Area Base Bid

Item No.	Quantity	Unit	Description	Unit Price	Total Price
1.0	1	LS	Mobilization/Demobilization, per lump sum.	\$ _____ /LS	\$ _____
2.0	1	LS	SWPP/Erosion Control, complete in place, per lump sum.	\$ _____ /LS	\$ _____
3.0	5,784	SY	Clearing and Grubbing, per square yard.	\$ _____ /SY	\$ _____
4.0	100	CY	Remove and Replace Unclassified and unsuitable material (Contingent Item), complete in place, per cubic yard.	\$ _____ /CY	\$ _____
5.0	1,590	CY	Earthwork and Grading, complete in place, per cubic yard.	\$ _____ /CY	\$ _____
6.0	1,050	CY	Export of excess cut materials, per cubic yard.	\$ _____ /CY	\$ _____
7.0	1	EA	Construct the Detention Pond Outlet Structure, complete in place, per each.	\$ _____ /EA	\$ _____
8.0	56	LF	Install the SDR-35 PVC Storm Drain piping, complete in place, per lineal foot.	\$ _____ /LF	\$ _____
9.0	1	LS	Install the Irrigation Service tap, water meter, backflow assembly and enclosure, complete in place, per lump sum.	\$ _____ /LS	\$ _____
10.0	40	LF	Install the CTS PE water line pipe for the irrigation service, complete in place, per lineal foot.	\$ _____ /LF	\$ _____
11.0	1	EA	Install the sidewalk cross drain, complete in place, per each.	\$ _____ /EA	\$ _____
12.0	5,200	SF	Construct PCC Vehicular Maintenance Path, complete and in place, per square ft.	\$ _____ /SF	\$ _____

Jack Reviglio Memorial Park Area Base Bid (Continued)

Item No.	Quantity	Unit	Description	Unit Price	Total Price
13.0	4,850	SF	Construct the PCC Pedestrian Sidewalk complete and in place per square foot.	\$ _____ /SF	\$ _____
14.0	50	LF	Construct the PCC Curb and Gutter, complete in place, per lineal foot.	\$ _____ /LF	\$ _____
15.0	2	EA	Construct the PCC Driveway Apron, complete in place, per each.	\$ _____ /EA	\$ _____
16.0	450	SF	Construct the Plantmix Bituminous Pavement Patch, complete in place, per square foot.	\$ _____ /SF	\$ _____
17.0	1	LS	Install Rip Rap, complete in place, per lump sum.	\$ _____ /LS	\$ _____
18.0	1	LS	Install the commercial underground irrigation system (excluding the point of connection), complete in place, per lump sum.	\$ _____ /LS	\$ _____
19.0	9	EA	Furnish and install the 2-1/2" caliper deciduous trees, complete in place, per each.	\$ _____ /EA	\$ _____
20.0	8	EA	Furnish and install the 10' minimum height evergreen trees, complete in place, per each.	\$ _____ /EA	\$ _____
21.0	78	EA	Furnish and install the assorted 5-gallon-shrubs, complete in place, per each.	\$ _____ /EA	\$ _____
22.0	7,050	SF	Furnish and install the DG mulch, complete in place, per square foot.	\$ _____ /SF	\$ _____
23.0	175	LF	Construct the 6" x 6" concrete mow curb, complete in place, per lineal foot.	\$ _____ /LF	\$ _____
24.0	19,988	SF	Furnish and install the sod/lawn soil amendments, complete in place, per square foot.	\$ _____ /SF	\$ _____
25.0	19,988	SF	Furnish and install the sod, complete in place, per square foot.	\$ _____ /SF	\$ _____
26.0	1	LS	Furnish and install revegetation treatments, complete in place, per lump sum.	\$ _____ /LS	\$ _____
27.0	285	LF	Construct the PCC sidewalk with thickened edge around play areas, complete in place, per lineal foot.	\$ _____ /LF	\$ _____

Jack Reviglio Memorial Park Area Base Bid (Continued)

Item No.	Quantity	Unit	Description	Unit Price	Total Price
28.0	95	LF	Construct the PCC Play Curb, complete in place, per lineal foot.	\$ _____ /LF	\$ _____
29.0	3,200	SF	Construct the PCC flatwork (Playground areas), complete in place, per square foot.	\$ _____ /SF	\$ _____
30.0	2	EA	Construct the PCC ADA ramps into the playground areas, complete in place, per each.	\$ _____ /EA	\$ _____
31.0	1	LS	Install the (owner purchased and provided) playground equipment, complete in place, per lump sum.	\$ _____ /LS	\$ _____
32.0	1	LS	Construct the playground drainage components, complete in place, per lump sum.	\$ _____ /LS	\$ _____
33.0	4,620	SF	Furnish and install the 16" depth of engineered play bark with fabric, complete in place, per square foot.	\$ _____ /SF	\$ _____
34.0	4	EA	Furnish and install the benches, complete in place, per each.	\$ _____ /EA	\$ _____
35.0	1	EA	Furnish and install the ADA picnic table, complete in place, per each.	\$ _____ /EA	\$ _____
36.0	3	EA	Furnish and install the standard picnic tables complete and in place per each.	\$ _____ /EA	\$ _____
37.0	3	EA	Furnish and install the dog cleaning stations, complete in place, per each.	\$ _____ /EA	\$ _____
38.0	2	EA	Furnish and install the fold-down bollards, complete in place, per each.	\$ _____ /EA	\$ _____
39.0	2	EA	Install the City provided City of Sparks Rules on breakaway posts, complete in place, per each.	\$ _____ /EA	\$ _____
40.0	1	LS	Construct the electrical improvements, complete in place, per lump sum.	\$ _____ /LS	\$ _____
41.0	12	MO	Provide a 1-year maintenance period as specified, complete in place, per month.	\$ _____ /MO	\$ _____
42.0	1	LS	Comprehensive playground audit for both play structures as specified, complete in place, per lump sum.	\$ _____ /LS	\$ _____

Jack Reviglio Memorial Park Area Base Bid (Continued)

Item No.	Quantity	Unit	Description	Unit Price	Total Price
43.0	1	FA	Force Account	\$ <u>20,000.00</u>	\$ <u>20,000.00</u>

<p>Total Jack Reviglio Memorial Park Base Bid Price</p> <p>\$ _____</p> <p>_____</p> <p>(written total bid price)</p>	<p>\$ _____</p>
---	-----------------

**Jack Reviglio Memorial Park Area
Alternate A – Rubber Tile Play Surface**

Item No.	Quantity	Unit	Description	Unit Price	Total Price
A1.0	4,620	SF	Furnish and install French Drain, subgrade preparation and base aggregate, complete in place, per square foot.	\$ _____ /SF	\$ _____
A1.1	1,056	SF	Construct the PCC apron (Playground areas), complete in place, per square foot.	\$ _____ /SF	\$ _____
A1.2	4,620	SF	Furnish and install 2' x 2' rubber tile interlocking playground surface, complete in place, per square foot.	\$ _____ /SF	\$ _____
A1.3	1	LS	DEDUCTION: Deduct for not installing playground bark fall safety material with fabric, PCC ADA ramps, and Playground footings and any other associated work that will not be included if alternative option A is approved.	\$ _____ /LS	\$ _____

<p>Total Jack Reviglio Memorial Alternate A Price</p> <p>\$ _____</p> <p>_____</p> <p>(written total price)</p>	<p>\$ _____</p>
---	-----------------

**Jack Reviglio Memorial Park Area
Alternate B – Shade Shelter**

Item No.	Quantity	Unit	Description	Unit Price	Total Price
B1.0	1	EA	Furnish and install the Shade Shelter, complete in place, per each.	\$ _____ /EA	\$ _____

Total Jack Reviglio Memorial Park Alternate B Price	
\$ _____	

(written total price)	\$ _____

Bid Schedule Notes:

1. City of Sparks reserves the right and privilege to accept or reject any or all bids or parts thereof, based solely on the judgment of representatives of the City of Sparks.
2. See Bid Item Clarifications.
3. Total base bid shall include Force Account Item #43 in the total base bid amount.
4. Bids shall be evaluated and awarded using the Total Base Bid amount. The City shall have the right to award one or all the Additive Alternates, if so deems, to the bidder providing the lowest "Base Bid" amount.

BID ITEM CLARIFICATIONS – REVISED BY ADDENDUM #2
JACK REVIGLIO MEMORIAL PARK
BID # 20/21-013 / PWP # WA-2021-168

BASE BID SCOPE OF WORK DESCRIPTIONS:

- 1.0 MOBILIZATION/DEMobilIZATION: Shall include (but not limited to) all mobilization, demobilization of equipment, all personnel, tools, site amenities, and all other items necessary for successful completion of the project based on all construction documentation, complete in place. This bid item shall include all permit fees, bonding and contract costs not included or specified in any other bid item.

- 2.0 SWPP AND EROSION CONTROL: Shall include (but not limited to) all Storm Water Prevention and Erosion Control installations, personnel, tools, site amenities, and all other items necessary for successful completion of the project based on all construction documentation, complete in place.

- 3.0 CLEARING AND GRUBBING: Shall include (but not limited to) all equipment, personnel, tools, materials, and all other items necessary to complete the related clearing of the site and grubbing that is to be completed as specified, complete in place.

- 4.0 REMOVE UNCLASSIFIED AND UNSUITABLE MATERIAL: Shall include (but not limited to) all equipment, personnel, tools, materials, and all other items necessary for the demolition, removal, and disposal of the unclassified or unsuitable materials as specified. Bid item to include backfill with select material, complete in place.

This item shall be considered a contingent item. The quantity indicated in the bid schedule represents no actual estimate, is nominal only, and may be greatly increased or decreased or reduced to zero. The increase or reduction of this quantity, as compared with that contained in the bid schedule, shall not constitute a basis for claim by the Contractor for extra payment or changed conditions.

- 5.0 EARTHWORK AND GRADING: Shall include (but not limited to) all equipment, personnel, tools, materials, and all other items necessary to complete the related earthwork and grading that is to be completed on the site as specified, complete in place.

- 6.0 EXPORT OF CUT MATERIALS: Shall include (but not limited to) all equipment, personnel, tools, materials, and all other items necessary to complete the exporting of materials and legal disposal of all items related to the earthwork and grading that is to be completed on the site as specified, complete in place.

- 7.0 DETENTION POND OUTLET: Shall include (but not limited to) all equipment, personnel, tools, materials, and all other items necessary to complete the construction of the detention pond outlet as shown on the plans, complete in place.

- 8.0 SDR-35 PVC STORM DRAINPIPE: Shall include (but not limited to) all equipment, personnel, tools, materials, and all other items necessary to furnish and install the 12-inch SDR-35 PVC storm drainpipe as specified. This bid item will include all sidewalk and curb removal, asphalt removal,

trench excavations, pipe bedding, pipe installation, backfill bedding, backfill and compaction, complete in place.

- 9.0 IRRIGATION SERVICE TAP, METER AND BACKFLOW: Shall include (but not limited to) all equipment, personnel, tools, materials, and all other items necessary to furnish/install the 1-inch irrigation service tap with Corp Stop, the water meter, the backflow assembly and the backflow enclosure as shown on the plans, complete in place.
- 10.0 CTS PE WATER LINE PIPE (IRRIGATION SERVICE): Shall include (but not limited to) all equipment, personnel, tools, materials, and all other items necessary to furnish/install the 1-inch CTS PE irrigation water line piping as shown. This bid item will include all trench excavations, pipe bedding, pipe installation, backfill bedding, backfill and compaction, complete in place.
- 11.0 SIDEWALK CROSS DRAINS: Shall include (but not limited to) all equipment, personnel, tools, materials, and all other items necessary to furnish/install the sidewalk cross drains as shown on the plans, complete in place.
- 12.0 PCC VEHICLE MAINTENANCE PATH: Shall include (but not limited to) all equipment, personnel, tools, materials, and all other items necessary to install the PCC Vehicular Maintenance Path as specified. This bid item will include the purchasing, installation, and compaction of the specified depth of base aggregate, complete in place.
- 13.0 PCC PEDESTRIAN SIDEWALK: Shall include (but not limited to) all equipment, personnel, tools, materials, and all other items necessary to install the PCC Pedestrian Sidewalk as specified. This bid item will include the purchasing, installation, and compaction of the specified depth of base aggregate, complete in place.
- 14.0 PCC CURB AND GUTTER: Shall include (but not limited to) all equipment, personnel, tools, materials, and all other items necessary to install the PCC Curb and Gutter as specified. This bid item will include the purchasing, installation, and compaction of the specified depth of base aggregate, complete in place.
- 15.0 PCC DRIVEWAY APRON: Shall include (but not limited to) all equipment, personnel, tools, materials, and all other items necessary to install the PCC Driveway Apron as specified. This bid item will include the purchasing, installation, and compaction of the specified depth of base aggregate, complete in place.
- 16.0 BITUMINOUS PLANTMIX: Shall include (but not limited to) all equipment, personnel, tools, materials, and all other items necessary for the installation of the Bituminous Plantmix as shown on the plans. This bid item will include the purchase, installation, and compaction of the specified depth of base aggregate, complete in place.
- 17.0 RIP RAP: Shall include (but not limited to) all equipment, personnel, tools, materials, and all other items necessary to furnish and install a 12" minimum depth of 6-inch Rip Rap as shown. This bid item shall include fine grading of the areas, area clean-up, spoils removal, and pre-emergent application, complete in place.

- 18.0 COMMERCIAL IRRIGATION: Shall include (but not limited to) all equipment, personnel, tools, materials, and all other items necessary to furnish/install the commercial underground irrigation system, existing irrigation modifications in the existing turf roadway planter area, new irrigation wiring, new irrigation controller and any other work associated with any new irrigation improvements as specified in the construction plans and documentation, complete in place. Note: this bid item does NOT include the irrigation point of connection as detailed in bid item 9.0.
- 19.0 2-1/2-INCH DECIDUOUS TREES: Shall include (but not limited to) all equipment, personnel, tools, materials, and all other items necessary to install the 2-1/2-inch deciduous trees as specified in the plans. This bid item shall include the walk-on bark mulch tree rings. The project coordinator shall view and approve all trees and shrubs prior to purchasing them.
- 20.0 10-FOOT EVERGREEN TREES: Shall include (but not limited to) all equipment, personnel, tools, materials, and all other items necessary to install the 10-foot evergreen trees as specified. This bid item shall include the walk-on bark mulch tree rings. The project coordinator shall view and approve all trees and shrubs prior to purchasing them.
- 21.0 5-GALLON SHRUBS: Shall include (but not limited to) all equipment, personnel, tools, materials, and all other items necessary to install all 5-gallon shrubs as shown on the plans. This bid item shall include the walk-on bark mulch watering basin rings, complete in place. The project coordinator shall view and approve all trees and shrubs prior to purchasing them.
- 22.0 DG GROUND COVER MULCH: Shall include (but not limited to) all equipment, personnel, tools, materials, and all other items necessary to furnish and install a 4" minimum depth of Decomposed Granite ground cover mulch as specified. This bid item shall include fine grading of landscape areas, planter area clean-up, spoils removal, pre-emergent application and DG mulch installation as specified in the plans, complete in place. Note: this bid item does not include landscape fabric.
- 23.0 CONCRETE MOW CURB: Shall include (but not limited to) all equipment, personnel, tools, materials, and all other items necessary to furnish and install the 6-inch by 6-inch concrete mow curb as specified in the plans, complete in place.
- 24.0 SOD/LAWN SOIL AMENDMENTS: Shall include (but not limited to) all equipment, personnel, tools, materials, and all other items necessary to furnish and install the sod/turf soil amendments as specified. This bid item shall include all fine grading, ripping/tilling, all soil amendments as specified (sheet L6, Sod numbers 13 through 19), installation, tilling of soil amendments into native soils, removal of spoils and laser grading as specified on the plans, complete in place.
- 25.0 SOD INSTALLATION: Shall include (but not limited to) all equipment, personnel, tools, materials, and all other items necessary to furnish and install the sod as specified in the plans. This bid item shall include the purchasing, delivery, unloading and installation of the sod, complete in place.
- 26.0 REVEGETATION TREATMENT AREAS: Shall include (but not limited to) all equipment, personnel, tools, materials, and all other items necessary to furnish and install the Revegetation Treatments as specified in the plans, complete in place.

- 27.0 PCC CONCRETE THICKENED SIDEWALK EDGE (AROUND PLAY AREAS): Shall include (but not limited to) all equipment, personnel, tools, materials, and all other items necessary to install the PCC thickened concrete edge around the play areas, as shown in the plans. This bid item will include the purchasing, installation, and compaction of the specified depth of base aggregate, complete in place.
- 28.0 PCC CONCRETE PLAY CURB: Shall include (but not limited to) all equipment, personnel, tools, materials, and all other items necessary to install the PCC concrete play curb, as shown. This bid item will include the purchasing, installation, and compaction of the specified depth of base aggregate, complete in place.
- 29.0 PCC CONCRETE FLATWORK (PLAYGROUND): Shall include (but not limited to) all equipment, personnel, tools, materials, and all other items necessary to install the PCC concrete flat work around the playground areas as specified in the plans. This bid item will include the purchasing, installation, and compaction of the specified depth of base aggregate, complete in place.
- 30.0 PCC CONCRETE ADA RAMPS (INTO PLAYGROUNDS): Shall include (but not limited to) all equipment, personnel, tools, materials, and all other items necessary to install the PCC concrete ADA ramps into the play areas as shown. This bid item will include the purchasing, installation, and compaction of the specified depth of base aggregate, complete in place.
- 31.0 PLAYGROUND EQUIPMENT (OWNER PROVIDED): Shall include (but not limited to) all equipment, personnel, tools, materials, and all other items necessary to install the (owner purchased and provided) play equipment as specified. **NOTE: This bid item shall include (but not limited to) initial delivery offloading at the maintenance yard (near 6400 Vista Blvd) at Golden Eagle Regional Park (GERP), inventory of playground equipment at the yard, and delivery from the GERP maintenance yard to the construction site, unloading of play equipment and then all associated work required for the installation as specified in the plans, complete in place. Refer to bid document Appendix for proposed playground equipment provided by the City.**
- 32.0 PLAYGROUND DRAINAGE: Shall include (but not limited to) all equipment, personnel, tools, materials, and all other items necessary to furnish and install the playground drainage components as specified in the plans, complete in place.
- 33.0 ENGINEERED WOOD FIBER PLAYGROUND BARK: Shall include (but not limited to) all equipment, personnel, tools, materials, and all other items necessary to furnish and install the 16-inch minimum depth of engineered wood play bark as shown. This bid item shall include fine grading of playground areas, area clean-up and spoils removal, pre-emergent application, landscape fabric above the subgrade soils and play bark installation as specified in the plans, complete in place.
- 34.0 BENCH WITH BACK: Shall include (but not limited to) all equipment, personnel, tools, materials, and all other items necessary to furnish and install the bench with back as specified in the plans, complete in place. This bid item will include purchasing, shipping, unloading, storage, delivery to site, layout, site furnishing installation, concrete pad (sheet L25) and surface mounting as shown in the plans.

- 35.0 ADA PICNIC TABLE: Shall include (but not limited to) all equipment, personnel, tools, materials, and all other items necessary to furnish and install the ADA picnic table as specified. This bid item will include purchasing, shipping, unloading, storage, delivery to site, layout, and site furnishing installation, complete in place.
- 36.0 STANDARD PICNIC TABLE: Shall include (but not limited to) all equipment, personnel, tools, materials, and all other items necessary to furnish and install the ADA picnic table as specified in the plans. This bid item will include purchasing, shipping, unloading, storage, delivery to site, layout, and site furnishing installation, complete in place.
- 37.0 DOG CLEANING STATION: Shall include (but not limited to) all equipment, personnel, tools, materials, and all other items necessary to furnish and install the dog cleaning stations as specified in the plans, complete in place. This bid item will include purchasing, shipping, unloading, storage, delivery to site, layout, footing excavation, site furnishing installation, and concrete footings.
- 38.0 FOLD DOWN BOLLARDS: Shall include (but not limited to) all equipment, personnel, tools, materials, and all other items necessary to furnish and install the fold down bollards as specified in the plans, complete in place. This bid item will include purchasing, shipping, unloading, storage, delivery to site, layout, footing excavation, site furnishing installation, and concrete footings.
- 39.0 CITY OF SPARKS RULES SIGN: Shall include (but not limited to) all equipment, personnel, tools, materials, and all other items necessary to furnish and install the breakaway signage as shown on the plans, complete in place. Note: City of Sparks will provide the sign and the contractor will install the sign.
- 40.0 ELECTRICAL IMPROVEMENTS: Shall include (but not limited to) all equipment, personnel, tools, materials, and all other items necessary to furnish and install all of the site electrical as specified on the plans, complete in place. This bid item to include all trench excavations, electrical conduit bedding material, backfill bedding, backfill and compaction, electrical components, lighting standards, all electrical conduit, electrical wiring, irrigation controller electrical components, all associated splash pad electrical components and all other associate electrical as specified in the plans, complete in place.
- 41.0 1-YEAR MAINTENANCE PERIOD: The intent of the one-year maintenance/warranty period is to ensure the plants/trees/shrubs and irrigation of the park is turned over in good condition at the end of the one-year period. The Contractor shall be responsible for ensuring the proper precipitation rates are in place in conjunction with the irrigation schedules. Irrigation shall be in good working condition at the end of the one-year maintenance period. Shrubs, trees, and grass/sod shall be in healthy condition at end of the one-year maintenance/warranty period. Bidders shall **NOT** include the mowing, trimming, and site cleanup in this Bid Item.
- 42.0 COMPREHENSIVE PLAYGROUND AUDIT: Shall include (but not limited to) all equipment, personnel, tools, site amenities, and all other items necessary for successful completion of a comprehensive playground safety audit performed by a Certified Playground Safety Inspector as specified in the plans, complete in place.

43.0 FORCE ACCOUNT: A force account has been established for this project and shall be included in each bid. The force account will be utilized only as necessary for extra work authorized and approved in advance by the City of Sparks representative as per Special Provision Section 23.

ALTERNATE BID OPTION A – RUBBER TILE PLAY SURFACE:

A1.0 PLAYGROUND SUBGRADE PREPARATION AND BASE AGGREGATE: Shall include (but not limited to) all equipment, personnel, tools, site amenities, and all other items necessary for successful completion of the French drain system as noted on revised sheet L7, the subgrade compaction to ninety percent (90%) relative compaction, furnish/installation of various depths of the Type II base aggregate, fine grading of base aggregate and base aggregate compaction completed in four-inch (4”) lifts to ninety-five percent (95%) relative compaction, complete in place.

A1.1 PCC CONCRETE APRON UNDER RUBBER TILES: Shall include (but not limited to) all equipment, personnel, tools, materials, and all other items necessary to install the PCC concrete apron shown under the rubber tiles, as specified. This bid item will NOT include the purchasing, installation, and compaction of the specified depth of base aggregate as specified in bid item 41.0 ‘Subgrade Preparation and Aggregate Base’.

A1.2 RUBBER TILE PLAYGROUND SURFACE: Shall include (but not limited to) all equipment, personnel, tools, materials, and all other items necessary to furnish and install the 2’x2’ interlocking rubber tile playground surface as specified on the plans, complete in place.

A1.3 DEDUCTION FOR REMOVAL OF PLAY BARK FROM SCOPE OF WORK: Shall include removing (but not limited to) the cost of bid item number thirty-two (32) “PCC CONCRETE ADA RAMPS (INTO PLAYGROUNDS)” and bid item number thirty-three (35) “ENGINEERED WOOD FIBER PLAYGROUND BARK”, the playground concrete footings and any other associated work if the alternative bid option A is accepted, complete in place.

ALTERNATE BID OPTION B – SHADE SHELTER:

B1.0 SHADE SHELTER: Shall include (but not limited to) all equipment, personnel, tools, materials, and all other items necessary to furnish and install the twenty-four-foot (24’) metal shade structure as specified, complete in place. This bid item will include purchasing, shipping, stamped engineered drawings, unloading, storage, delivery to site, layout, footing excavation, site furnishing installation, concrete footings, and electrical receptacle and lighting modifications (coordinate with City Representative), complete in place.

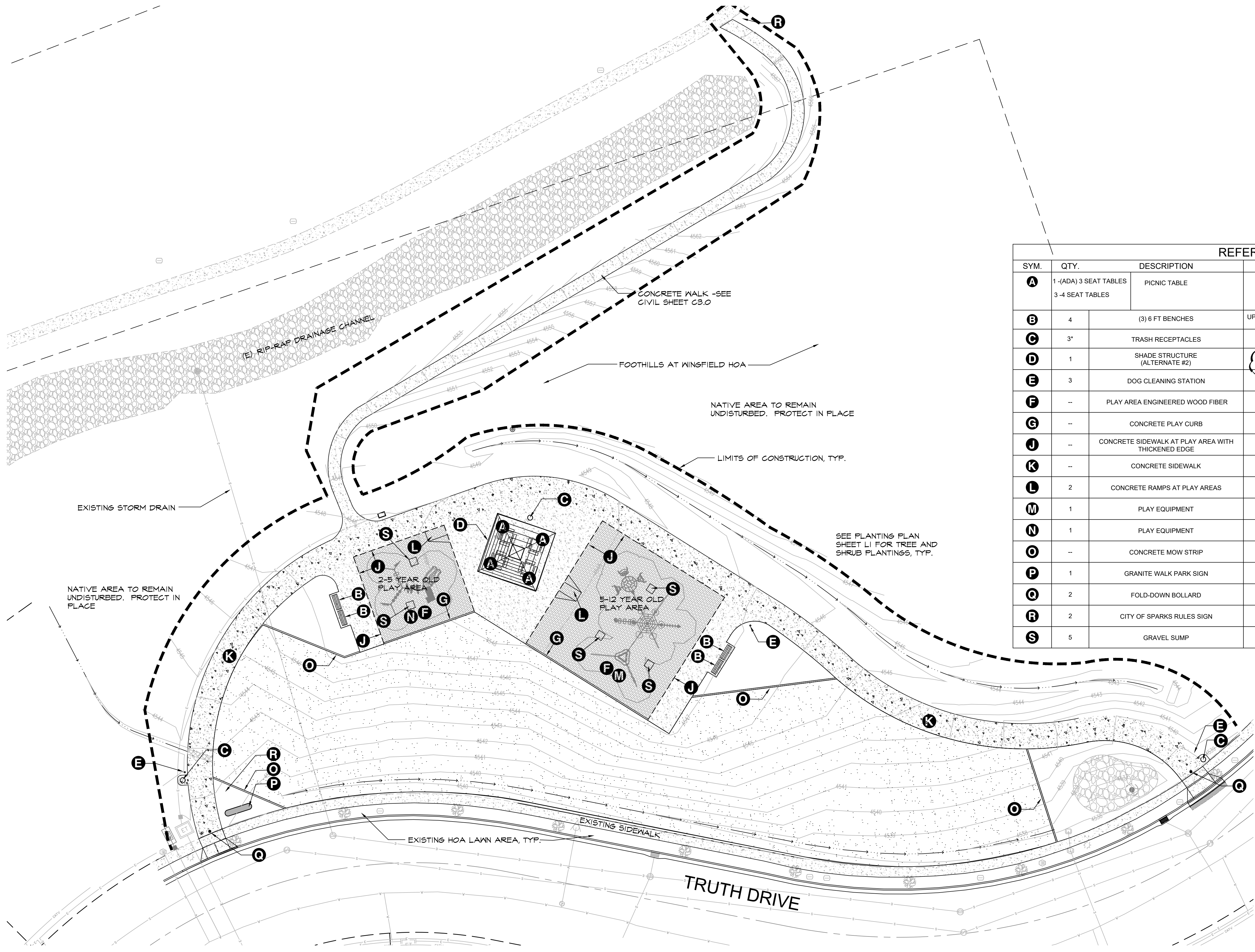

REFERENCE CHART				
SYM.	QTY.	DESCRIPTION	MFG/MODEL NUMBER	COLOR
A	1-(ADA) 3 SEAT TABLES 3-4 SEAT TABLES	PICNIC TABLE	UPBEAT SITE FURNISHINGS - 1-EXPANDED STEEL 3 SEAT ADA TABLE # D2016 3-EXPANDED STEEL 4 SEAT TABLE #F2015	BROWN SEAT AND BACK BLACK FRAME/POST
B	4	(3) 6 FT BENCHES	UPBEAT SITE FURNISHINGS - VICTORY 6' EXPANDED STEEL BENCH SM # D1062	BROWN SEAT AND BACK BLACK FRAME/POST
C	3*	TRASH RECEPTACLES	CITY OF SPARKS TO PROVIDE AND INSTALL	-
D	1	SHADE STRUCTURE (ALTERNATE #2)	RCP SHELTERS, INC. STEEL SHADE STRUCTURE TS-SQ24-04	TBD
E	3	DOG CLEANING STATION	POOPY POUCH PP-DSP-3R200	GREEN
F	--	PLAY AREA ENGINEERED WOOD FIBER	PER DETAIL SHEET	-
G	--	CONCRETE PLAY CURB	PER DETAIL 11/L15	FLOAT FINISH
J	--	CONCRETE SIDEWALK AT PLAY AREA WITH THICKENED EDGE	PER DETAIL 10/L15	-
K	--	CONCRETE SIDEWALK	PER CIVIL DETAILS	-
L	2	CONCRETE RAMPS AT PLAY AREAS	PER DETAIL 12/L15	-
M	1	PLAY EQUIPMENT	SELECTED AND PURCHASED BY CITY COORDINATE WITH PROJECT MANAGER	-
N	1	PLAY EQUIPMENT	SELECTED AND PURCHASED BY CITY COORDINATE WITH PROJECT MANAGER	-
O	--	CONCRETE MOW STRIP	PER DETAIL 8/L15	-
P	1	GRANITE WALK PARK SIGN	STONEHENGE SIGNS, INC. (BY OTHERS)	-
Q	2	FOLD-DOWN BOLLARD	TRAFFICGUARD DOUBLE POST HINGED BOLLARD	SAFETY YELLOW
R	2	CITY OF SPARKS RULES SIGN	SUPPLIED BY CITY, INSTALLED BY CONTRACTOR ON TRAFFIC RATED UNISTRUT COORDINATE LOCATION WITH PROJECT MANAGER	-
S	5	GRAVEL SUMP	PER DETAIL 13/L15	-

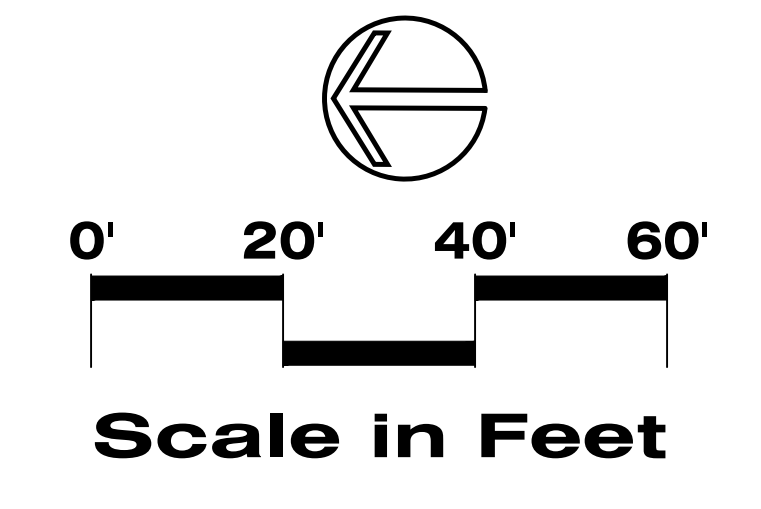

BID/CONSTRUCTION SET REFERENCE PLAN
JACK REVIGLIO MEMORIAL PARK
 CITY OF SPARKS

No.	Revision Date

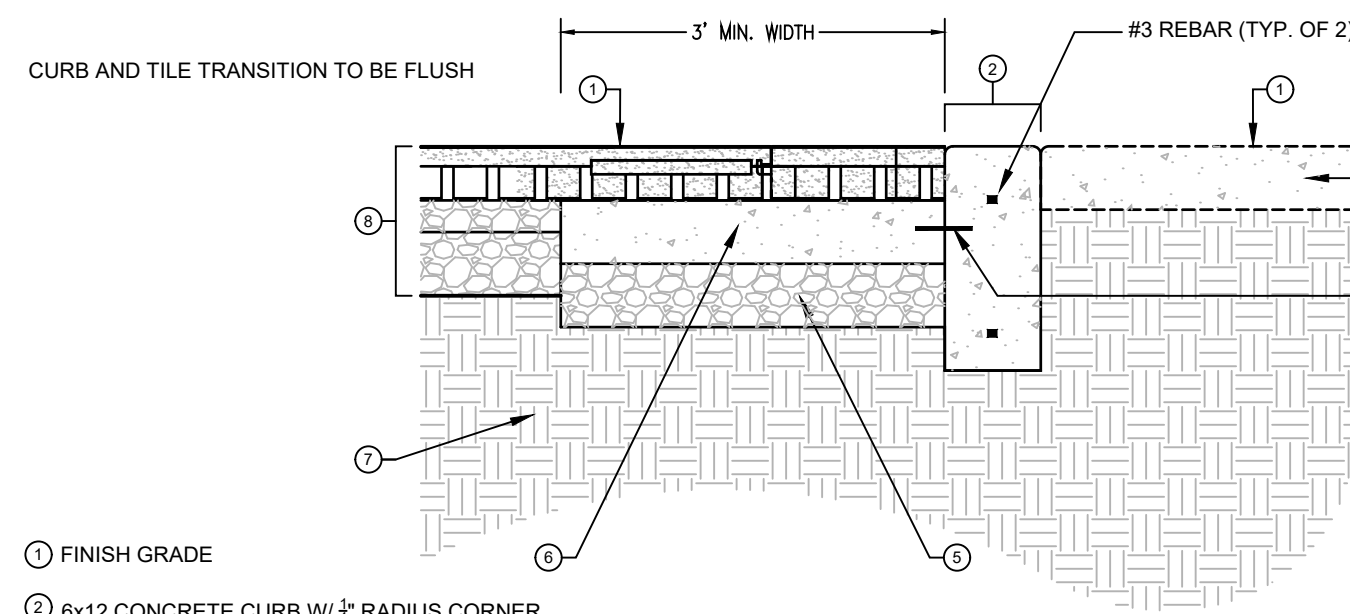

- ① FINISH GRADE
- ② 6x12 CONCRETE CURB W/ 2" RADIUS CORNER
- ③ ADJACENT EXISTING CONCRETE SIDEWALK (WHERE APPLICABLE)
- ④ REBAR DOWEL EVERY 3' ON CENTER
- ⑤ COMPACTED TYPE II BASE (4" MIN DEPTH) COMPACTED TO 95% RELATIVE COMPACTION. SEE NOTE ABOVE REGARDING DEPTH OF COMPACTED BASE AGGREGATE.
- ⑥ CONCRETE APRON: CONTRACTOR TO INSTALL 4" THICK X 3' WIDE CONCRETE APRON AT ALL EDGES. W/ CONTROL JOINTS EVERY 5' AND MATCH CURB OR SW CONTROL JOINTS
- ⑦ COMPACTED SUBGRADE SOILS, COMPACTED TO 90% RELATIVE COMPACTION (NATIVE SOILS)
- ⑧ RUBBER TILE INSTALLATION OVER COMPACTED BASE AGGREGATE PER DETAIL THIS SHEET

A 6x12 CONCRETE CURB AT 3' CONCRETE APRON

NOTE: CONTRACTOR TO ENSURE A 4" MINIMUM DEPTH OF COMPACTED BASE AGGREGATE UNDER ALL CONCRETE. EXCAVATE ADDITIONAL SUBGRADE SOILS IF NEEDED TO MEET THE 4" MINIMUM DEPTH. IF THE EXISTING SUBGRADE DEPTH REQUIRES ADDITIONAL FILL MATERIAL CONTRACTOR SHALL INSTALL BASE AGGREGATE AS REQUIRED TO FILL THE AREAS TO MEET PROPOSED ELEVATIONS. INSTALL BASE AGGREGATE IN 4" LIFTS AND COMPACT TO 95% RELATIVE COMPACTION.

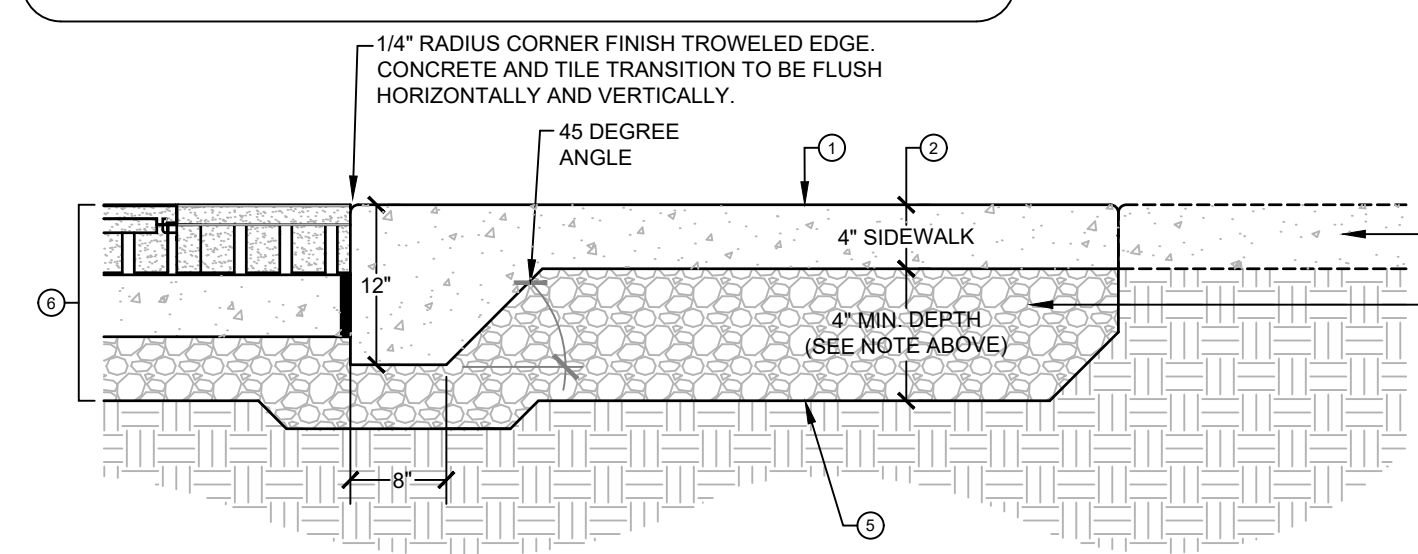

- ① FINISH GRADE
- ② 4" THICK CONCRETE SIDEWALK WITH THICKENED EDGE. INSTALL BROOM FINISH ON CONCRETE SIDEWALK SIDEWALK AND EDGE TO BE MONOLITHIC POUR (TYP.)
- ③ COMPACTED TYPE II BASE (4" MIN DEPTH) COMPACTED TO 95% RELATIVE COMPACTION. SEE NOTE ABOVE REGARDING DEPTH OF COMPACTED BASE AGGREGATE.
- ④ ADJACENT EXISTING CONCRETE
- ⑤ COMPACTED SUBGRADE SOILS. COMPACTED TO 90% RELATIVE COMPACTION.
- ⑥ RUBBER TILE INSTALLATION OVER CONCRETE APRON PER DETAIL A THIS SHEET.

B CONCRETE SIDEWALK THICKENED EDGE (RUBBER TILES)

NOTE: CONTRACTOR TO ENSURE A 4" MINIMUM DEPTH OF COMPACTED BASE AGGREGATE UNDER ALL CONCRETE. EXCAVATE ADDITIONAL SUBGRADE SOILS IF NEEDED TO MEET THE 4" MINIMUM DEPTH. IF THE EXISTING SUBGRADE DEPTH REQUIRES ADDITIONAL FILL MATERIAL CONTRACTOR SHALL INSTALL BASE AGGREGATE AS REQUIRED TO FILL THE AREAS TO MEET PROPOSED ELEVATIONS. INSTALL BASE AGGREGATE IN 4" LIFTS AND COMPACT TO 95% RELATIVE COMPACTION.

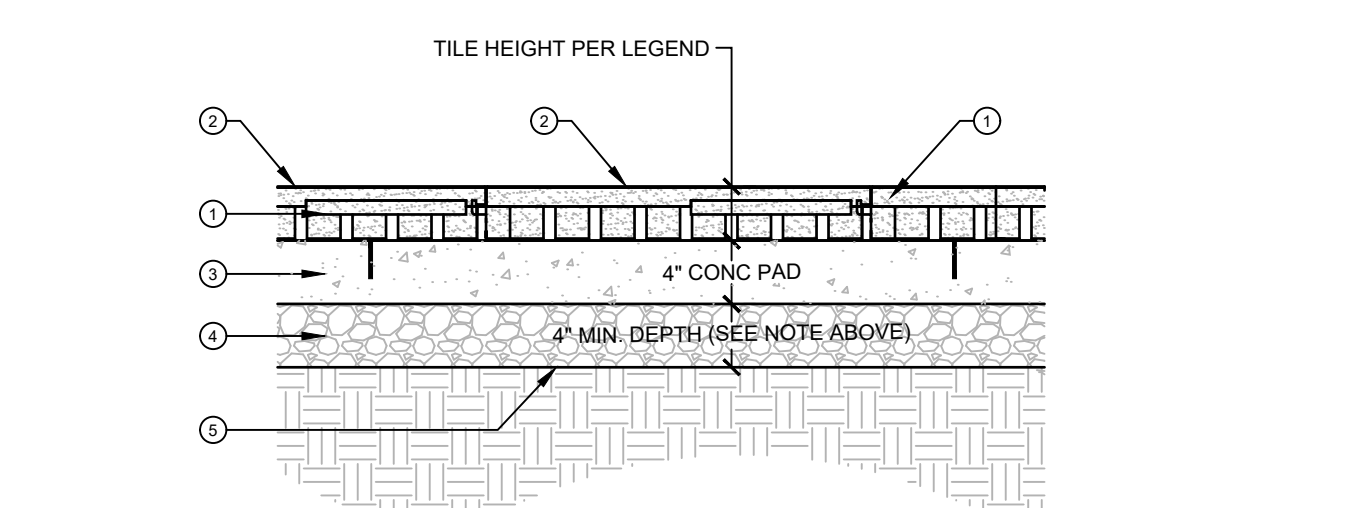
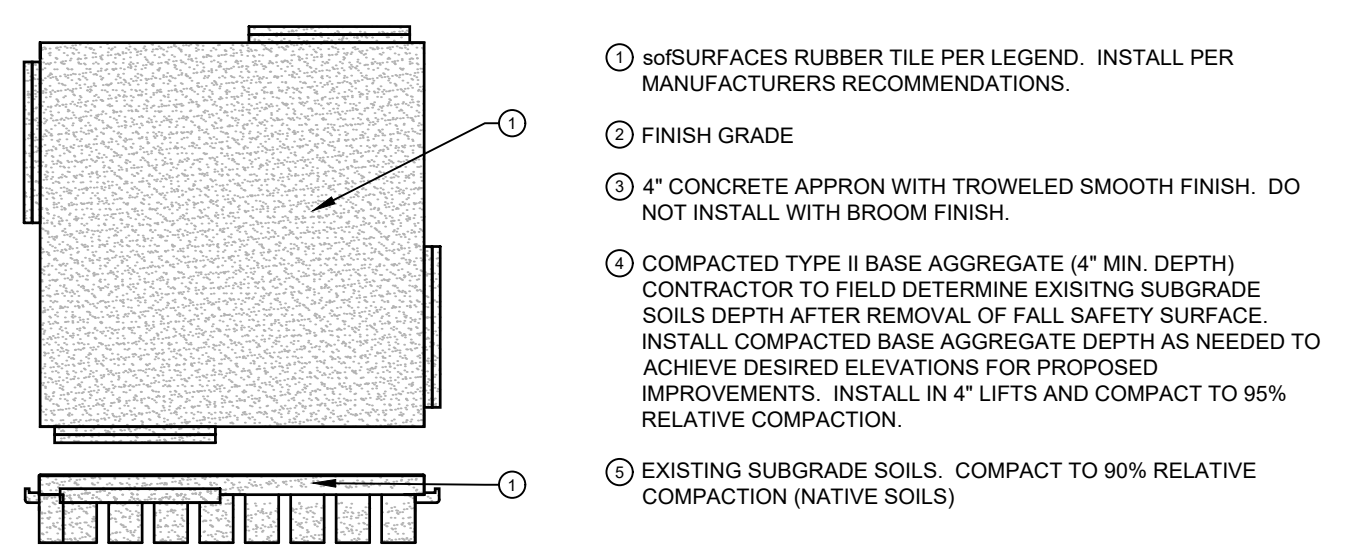

C RUBBER TILES ON CONCRETE APRON

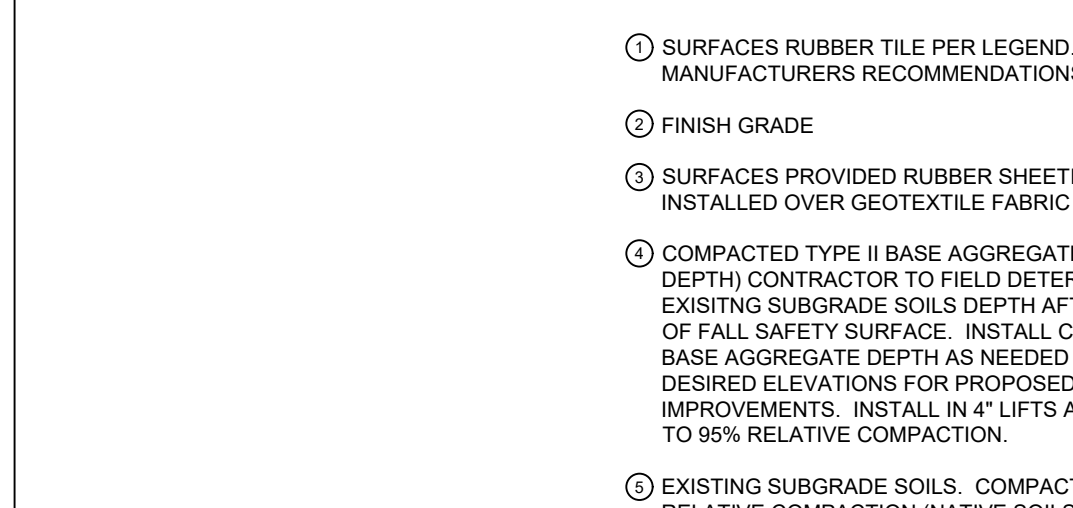
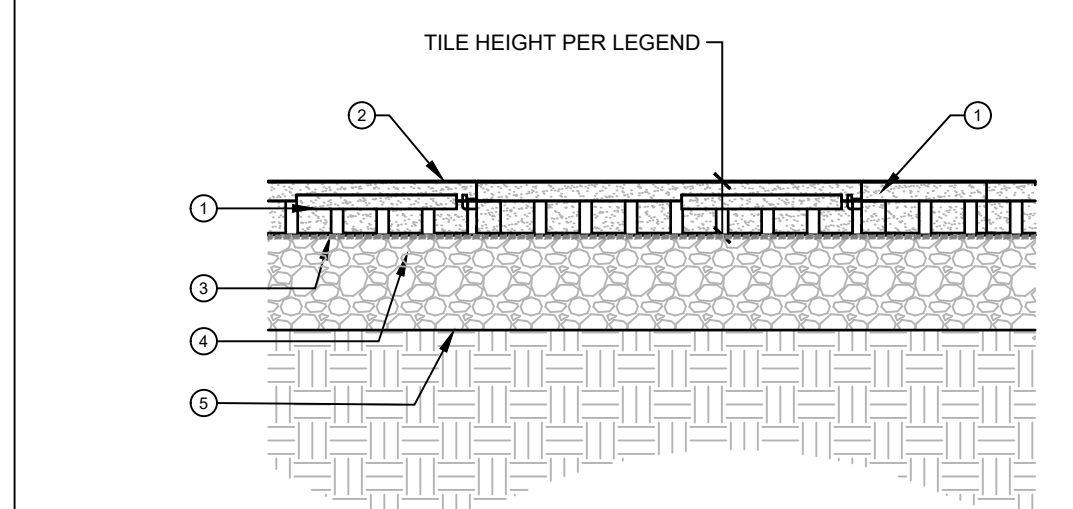
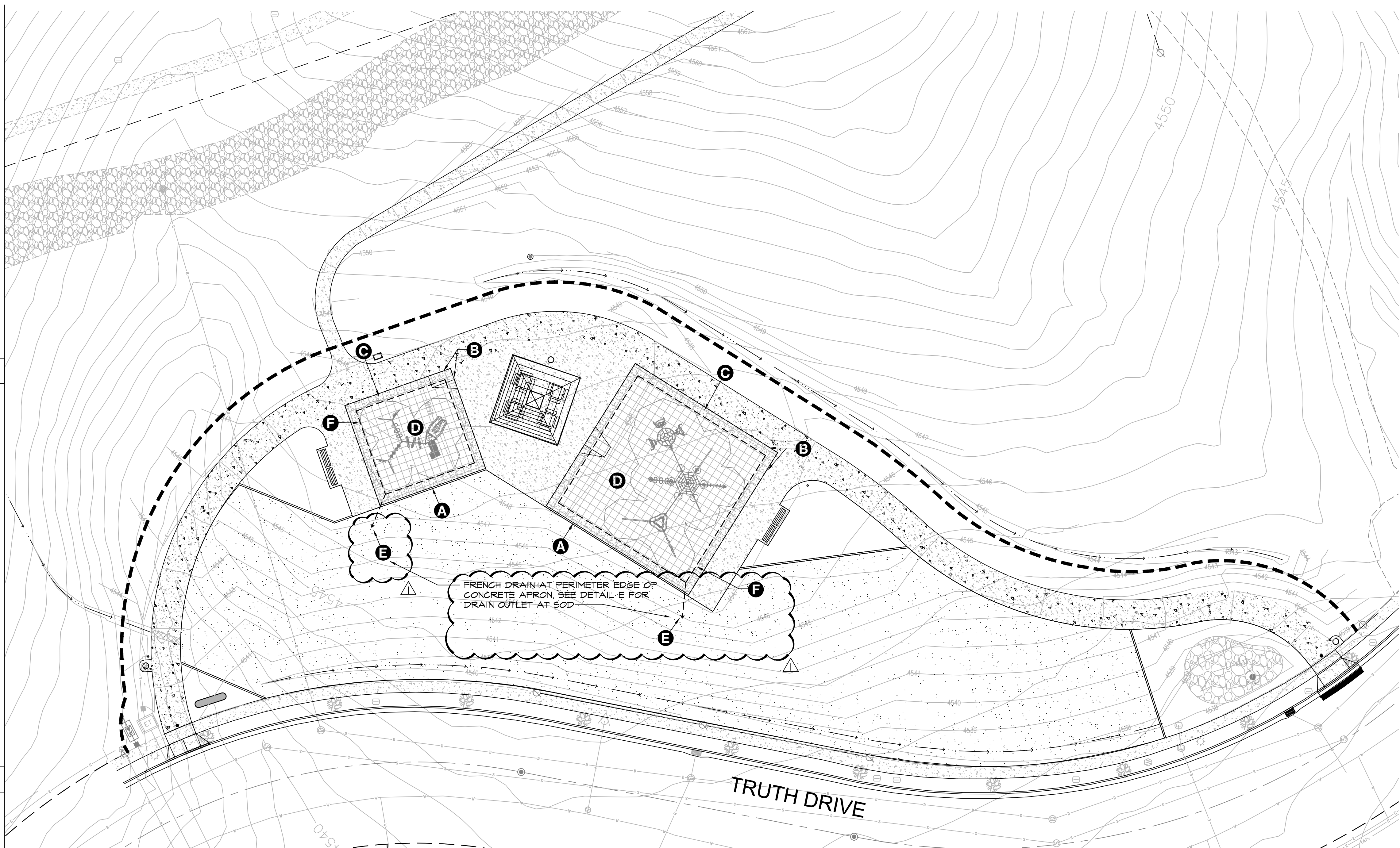

D RUBBER TILES OVER BASE AGGREGATE

E DRAIN OUTLET DETAIL

F FRENCH DRAIN

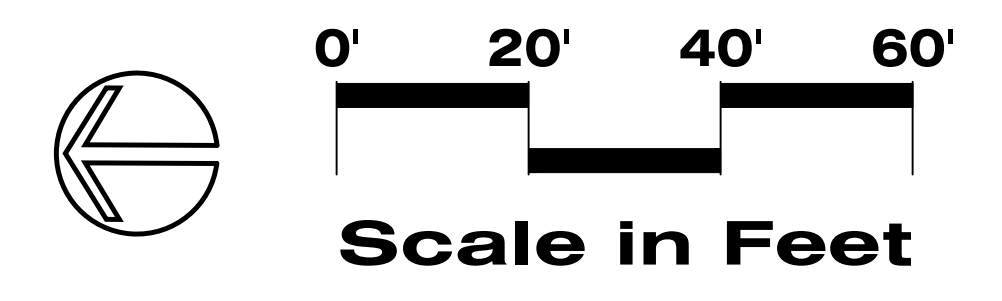

BID/CONSTRUCTION SET ALTERNATE #1
JACK REVIGLIO MEMORIAL PARK
 CITY OF SPARKS
 Washoe County
 Nevada

No.	Revision Date
1	3/5/21
RFI #:	
LA No.:	251-501-06-10
Designed:	LE
Drawn:	LE
Checked:	RWH
Date:	11/06/20